

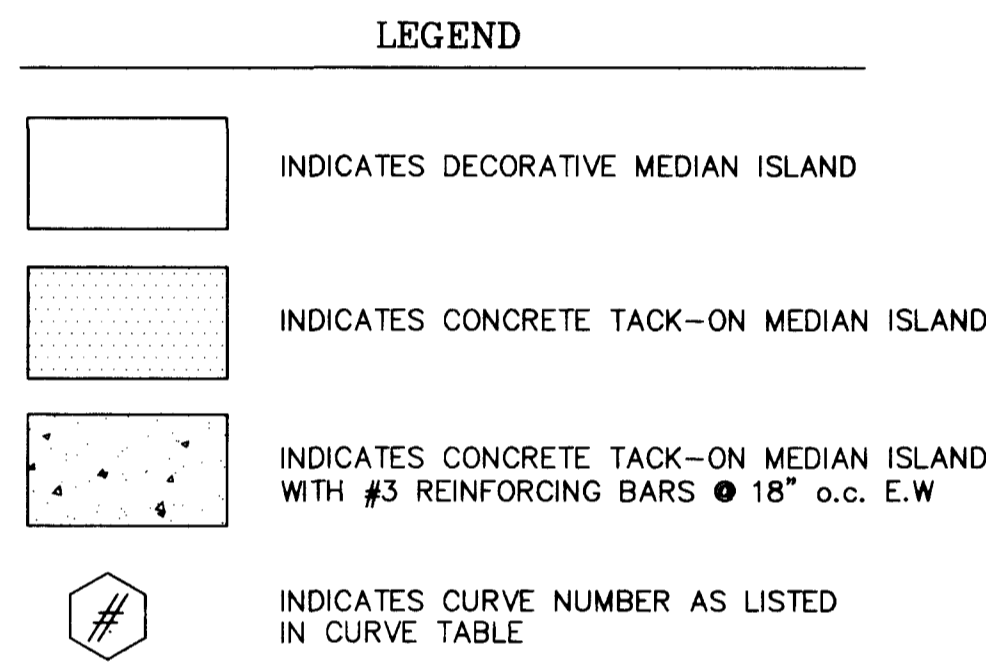

(E) INDICATES EASTERN AVE. STATIONING  
(W) INDICATES WASHINGTON AVE. STATIONING

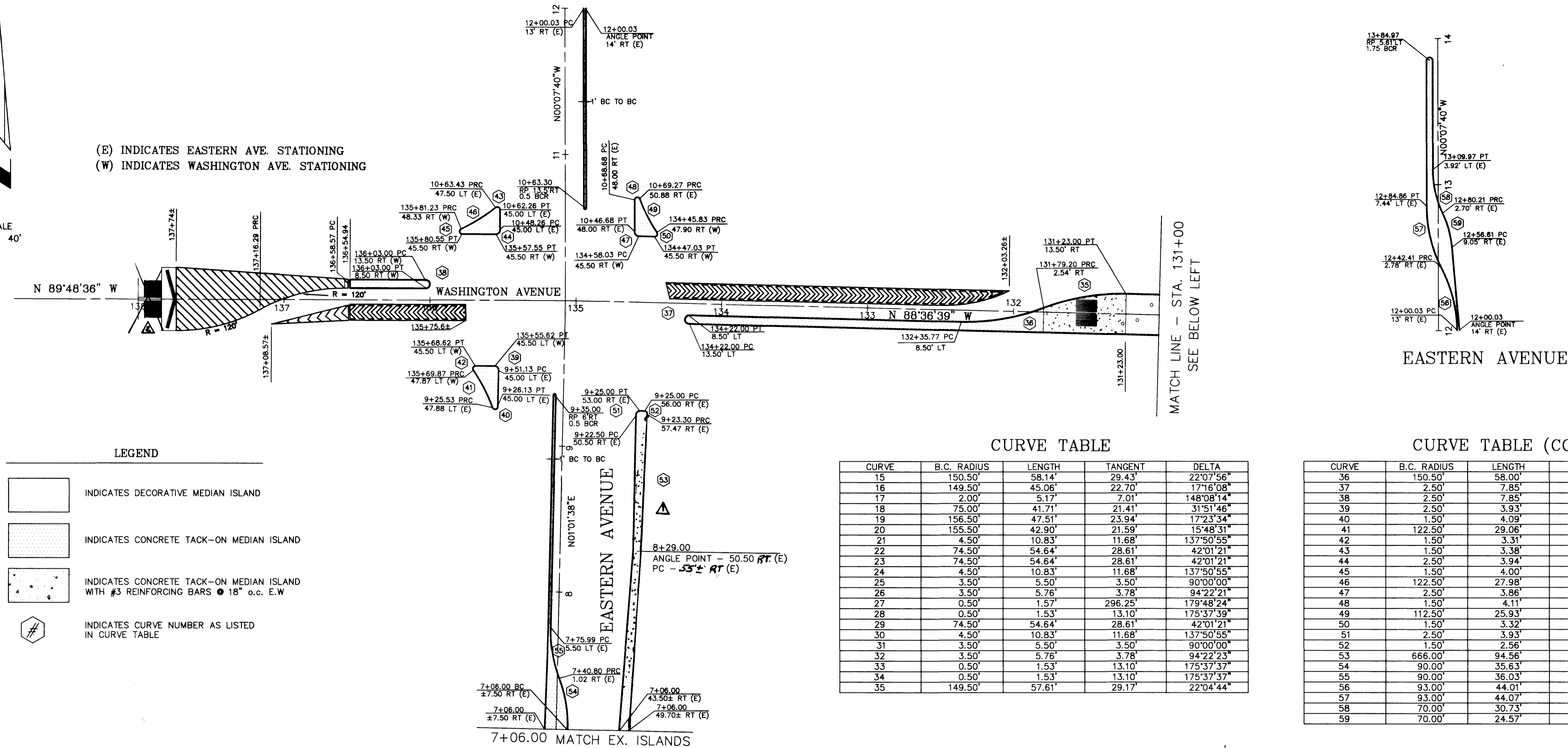

CURVE TABLE

CURVE	B.C. RADIUS	LENGTH	TANGENT	DELTA
15	150.50'	58.14'	29.43'	22°07'56"
16	149.50'	45.06'	22.70'	17°16'08"
17	2.00'	5.17'	7.01'	148°08'14"
18	75.00'	41.71'	21.41'	31°51'46"
19	156.50'	47.51'	23.94'	17°23'34"
20	155.50'	42.90'	21.59'	15°48'31"
21	4.50'	10.83'	11.68'	137°50'55"
22	74.50'	54.64'	28.61'	42°01'21"
23	74.50'	54.64'	28.61'	42°01'21"
24	4.50'	10.83'	11.68'	137°50'55"
25	3.50'	5.50'	3.50'	90°00'00"
26	3.50'	5.76'	3.78'	94°22'23"
27	0.50'	1.57'	296.25'	179°48'24"
28	0.50'	1.53'	13.10'	175°37'39"
29	74.50'	54.64'	28.61'	42°01'21"
30	4.50'	10.83'	11.68'	137°50'55"
31	3.50'	5.50'	3.50'	90°00'00"
32	3.50'	5.76'	3.78'	94°22'23"
33	0.50'	1.53'	13.10'	175°37'39"
34	0.50'	1.53'	13.10'	175°37'39"
35	149.50'	57.61'	29.17'	22°04'44"

CURVE TABLE (CONT'D)

CURVE	B.C. RADIUS	LENGTH	TANGENT	DELTA
36	150.50'	58.00'	29.36'	22°04'44"
37	2.50'	7.85'	---	180°00'00"
38	2.50'	7.85'	---	180°00'00"
39	2.50'	3.93'	2.50'	90°00'00"
40	1.50'	4.09'	7.16'	156°20'23"
41	122.50'	29.06'	14.60'	13°35'27"
42	1.50'	3.31'	2.96'	126°17'35"
43	1.50'	3.38'	3.16'	129°12'52"
44	2.50'	3.94'	2.51'	90°19'04"
45	1.50'	4.00'	6.18'	152°42'37"
46	122.50'	27.98'	14.05'	13°05'12"
47	2.50'	3.86'	2.43'	88°28'59"
48	1.50'	4.11'	7.33'	156°52'31"
49	112.50'	25.93'	13.02'	131°22'23"
50	1.50'	3.32'	2.98'	126°38'11"
51	2.50'	3.93'	2.50'	90°00'00"
52	1.50'	2.56'	1.72'	97°41'31"
53	666.00'	94.56'	47.36'	08°08'07"
54	90.00'	35.63'	18.05'	22°40'48"
55	90.00'	36.03'	18.26'	22°56'13"
56	93.00'	44.01'	22.42'	27°06'44"
57	93.00'	44.07'	22.46'	27°09'14"
58	70.00'	30.73'	15.62'	25°09'20"
59	70.00'	24.57'	12.71'	20°06'44"

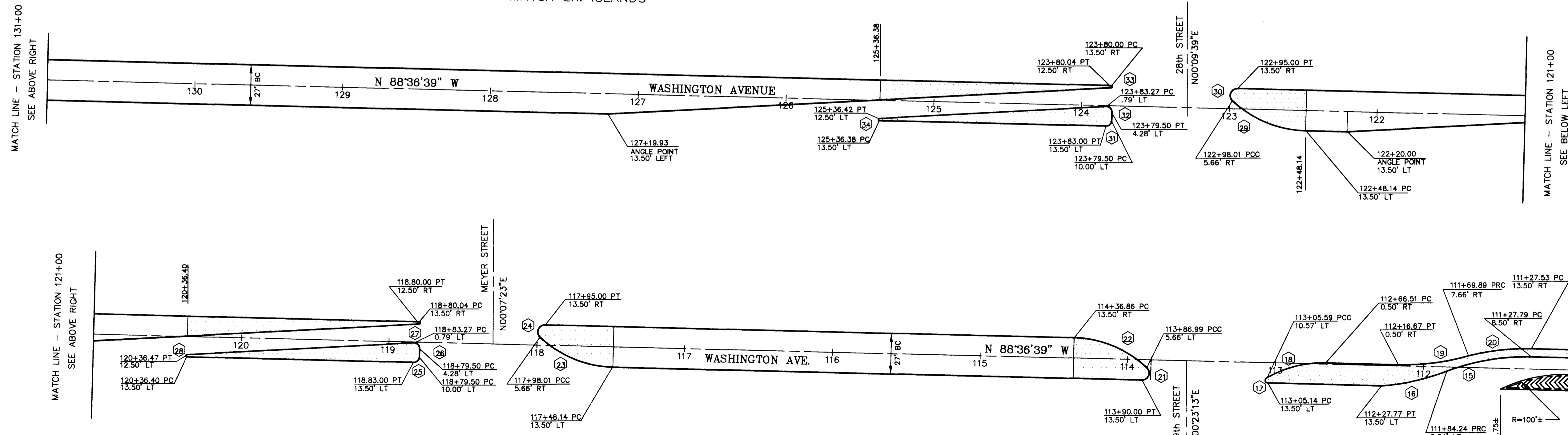

RECORD DRAWING  
These Record Drawings have been prepared based on information provided by others. The Engineer has not verified the accuracy of such information and shall not be responsible for any errors or omissions which may be incorporated herein as a result.

REVISIONS

No.	Date	Description
1		Revised Median Island
2		Added Deleted Steel Point Curves

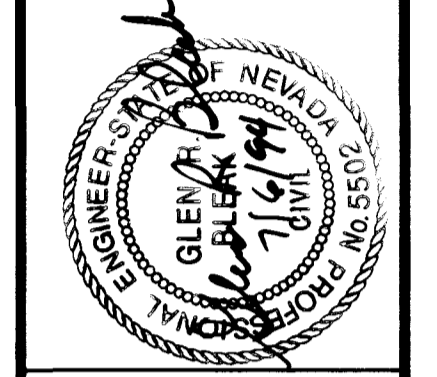

DESIGNED: JML/BB  
DRAWN: JML/BB  
CHECKED: RB  
JOB NO.: 383-9-91  
SCALE: AS NOTED  
HORIZ. AS NOTED  
VERT. AS NOTED

1055 EAST TROPICANA  
SUITE 800  
LAS VEGAS, NEVADA 89119  
(702)798-1007

PROJECT: CITY OF LAS VEGAS  
WASHINGTON AVENUE CONVEYANCE SYSTEM  
DESCRIPTION: MEDIAN ISLAND GEOMETRY  
STA. 111+00 TO 137+74.00

SHEET R-9  
32 OF 39

