

SCALE: 1" = 40'
 FILE: 99263C-UDWG PP-C502 XR-263C51TE

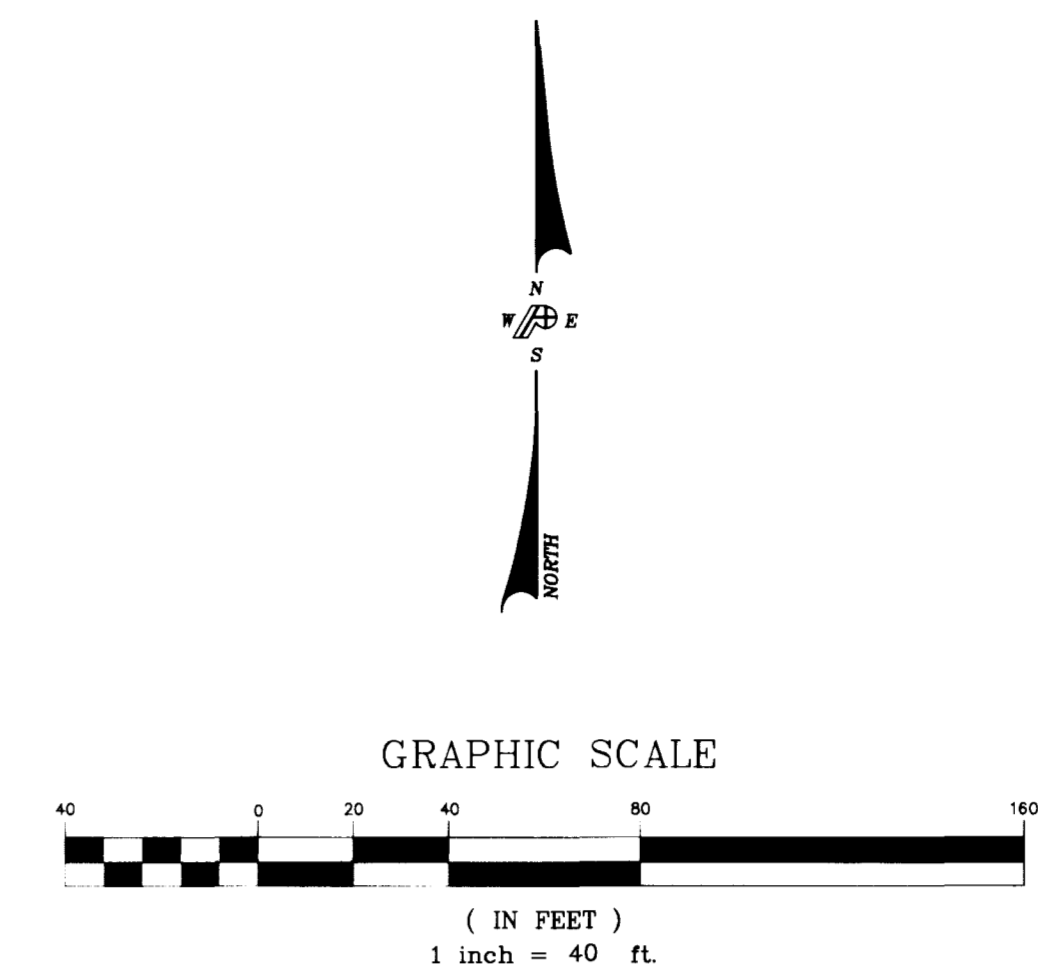
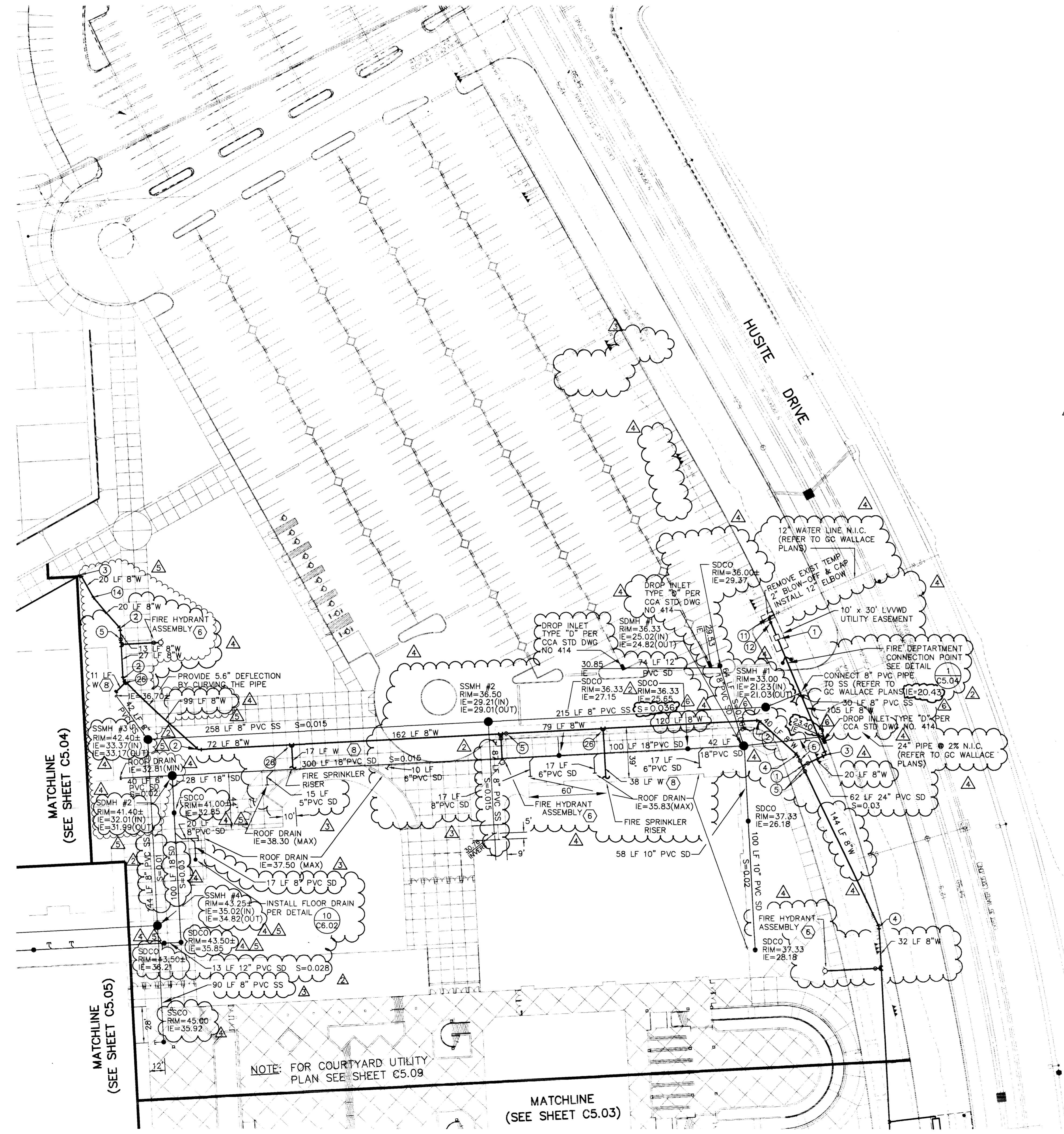

WATER KEYNOTES:

- ① INSTALL 8" DOUBLE CHECK DETECTOR ASSEMBLY IN ACCORDANCE WITH UNIFORM DESIGN AND CONSTRUCTION STANDARD (UDACS) PLATE NO. 20B.
- ⑤ CONSTRUCT 3", 6", 10" AND 12" CLASS 150 DR18 WATER LINES IN ACCORDANCE WITH LVVWD UTILITY STANDARDS.
- ⑥ CONSTRUCT 6" LATERAL, VALVE AND FIRE HYDRANT ASSEMBLY PER CLARK COUNTY AREA USD NO. 516.
- ⑦ ALL WATER LINES SHALL BE BACKFILLED IN ACCORDANCE WITH UDACS PLATES NO. 6A - 6C AS APPLICABLE.
- ⑧ THE FIRE SAFETY CONTRACTOR IS RESPONSIBLE FOR ESTABLISHING THE SIZE OF PIPING THAT IS REQUIRED TO CONNECT THE FIRE WATER LOOP TO THE FIRE SPRINKLER RISER.

MANHOLES:

INSTALL STORM DRAIN MANHOLES(SDMH) AND SANITARY SEWER MANHOLES(SSMH) PER "DESIGN STANDARDS FOR WASTEWATER COLLECTION SYSTEMS" STANDARD DRAWINGS SD-1 OR SD-10 AS NECESSARY (TYP).

WATER LINE DEPTH:

THE BOTTOM OF THE 8" WATER LINE SUPPLYING THE FIRE HYDRANTS AND SPRINKLER RISERS, AND 6" LATERALS ARE TO BE PLACED AT A DEPTH OF 3'-6" (TYP), SIX INCH WATER LINES ARE TO BE PLACED AT A DEPTH OF 4'-6" (TYP), THREE INCH WATER LINE IS TO BE PLACED AT A DEPTH OF 2'-6" (TYP), AND ONE INCH WATER LINE IS TO BE PLACED AT A DEPTH OF 2'-6" (TYP), WITH RESPECT TO THE FINISHED GRADE. SEE GRADING PLANS FOR ELEVATIONS.

THRUST BLOCKS:

THRUST BLOCKS ARE REQUIRED AT ALL CAPS, VALVES, REDUCERS, TEES, AND FITTINGS TO CHANGE THE PIPE DIRECTION, AND SHALL BE INSTALLED IN ACCORDANCE WITH "UNIFORM DESIGN STANDARDS FOR WATER DISTRIBUTION SYSTEMS" PLATE NO. 5 FOR ALL LOCATIONS WHERE THE SOIL BEARING CAPACITY IS 3000 PSF OR GREATER. SPECIAL THRUST BLOCK DESIGN BY A NRE FOR EACH INSTALLATION IS REQUIRED IF ALLOWABLE SOIL BEARING CAPACITY IS LESS THAN 3000 PSF. THRUST BLOCKS ARE REQUIRED ALSO AT GATE VALVES AND REDUCERS, AND SHALL BE INSTALLED IN ACCORDANCE WITH UDACS PLATE NO. 3.

DISCLAIMER:

EXISTING UTILITY LOCATIONS SHOWN HEREON ARE APPROXIMATE ONLY. IT SHALL BE THE CONTRACTOR'S RESPONSIBILITY TO DETERMINE THE EXACT HORIZONTAL AND VERTICAL LOCATION OF ALL EXISTING UNDERGROUND UTILITIES PRIOR TO COMMENCING CONSTRUCTION. NO REPRESENTATION IS MADE THAT ALL EXISTING UTILITIES ARE SHOWN HEREON. THE ENGINEER ASSUMES NO RESPONSIBILITY FOR UTILITIES NOT SHOWN OR UTILITIES NOT SHOWN IN THEIR PROPER LOCATION.

NOTES:

- 1. ALL ONSITE STORM DRAIN FACILITIES MUST BE PRIVATELY OWNED AND MAINTAINED.
- 2. PVC MAY BE USED IN PLACE OF CAST IRON FOR THE SANITARY SEWER AT THE CONTRACTOR'S DISCRETION.

[Signature]
 LAS VEGAS VALLEY WATER DISTRICT DATE 8/19/96

DOMESTIC WATER AND FIRE PROTECTION SERVICE WILL NOT BE AVAILABLE UNTIL COMPLETION OF THE 3205 ZONE WATER FACILITIES IN HUSITE DRIVE DURING NOVEMBER 1996.

NOTE:
 ALL ON-SITE SEWERS ARE PRIVATELY OWNED AND MAINTAINED

Call before you Dig.
 1-800-227-2600

REVISIONS			
REV	DESCRIPTION	DATE	BY
△	SHEET UPDATE	05-10-96	RCP
△	PER CLV PW FLOOD - CONTROL	05-14-96	DRF
△	GENERAL SHEET REVISION AND REVISIONS		JMY
△	PER LVVWD COMMENTS	06.03.96	
△	PER CCSN BUILDING DESIGN	08-01-96	SPA
△	PER COORDINATION OF G.C WALLACE FINAL DWGS.		SPA
△	PER CLV COMMENTS	08-30-96	DRF

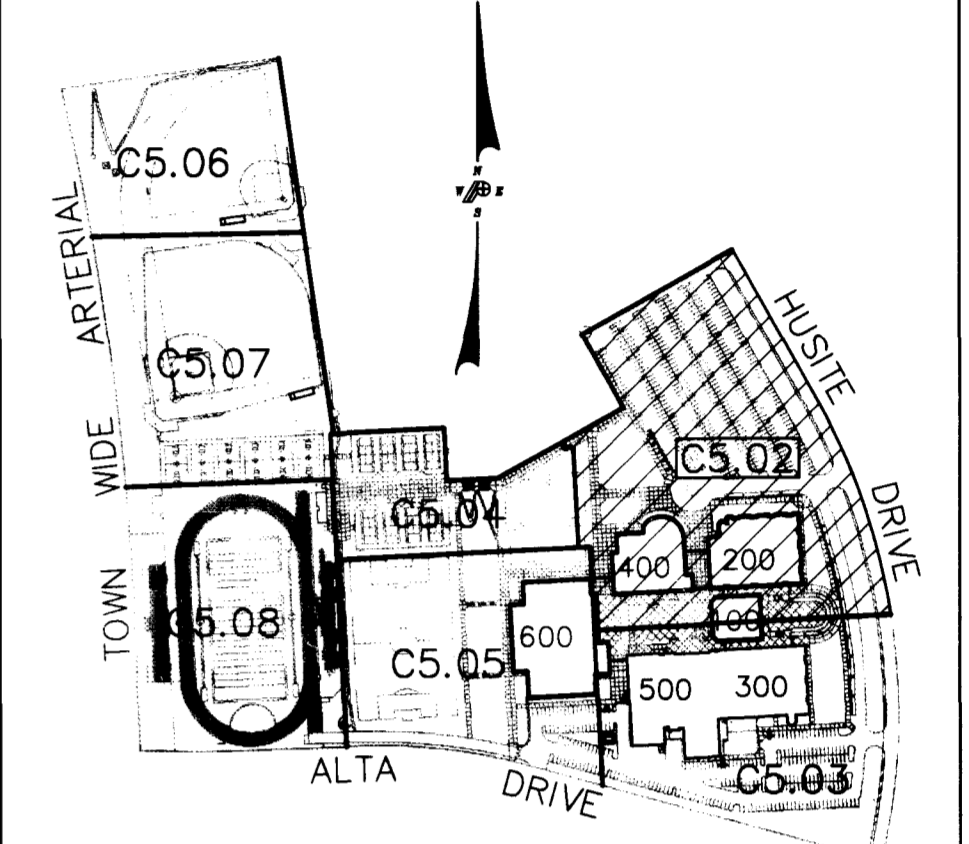

KEY PLAN

Professional Engineer Seal for Craig Marshall, State of Nevada, License No. 8771. Project No. 95263C.

PROJECT NO. 0846
 DATE 4.16.96
 DRAWN BY RCP/SPA
 CHECKED BY CLM
 SUBMITTED BID SET
 FILE PROJECT NO. 95263C

POGEMEYER DESIGN GROUP
 ARCHITECTS
 200 NORTH TRINITY WAY, LAS VEGAS, NEVADA, 89102 (702) 256-9100

TATE & SNYDER ARCHITECTS
 709 VALLE VERDE COURT
 HENDERSON NEVADA 89014
 (702) 456.3000

CLARK COUNTY SCHOOL DISTRICT
 CONSTRUCTION MANAGEMENT DEPARTMENT 4628 S. PEARL STREET 799-7600 LAS VEGAS, NEVADA 89121

ALTA/HUALAPAI HIGH SCHOOL
 LAS VEGAS NEVADA

UTILITY PLAN - AREA A

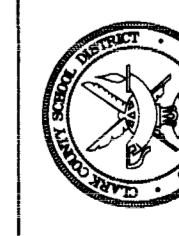

SHEET NO.

C5.02

7/15-93

3032

