

MATCH LINE
STA 516+00
SEE SHEET C4.03

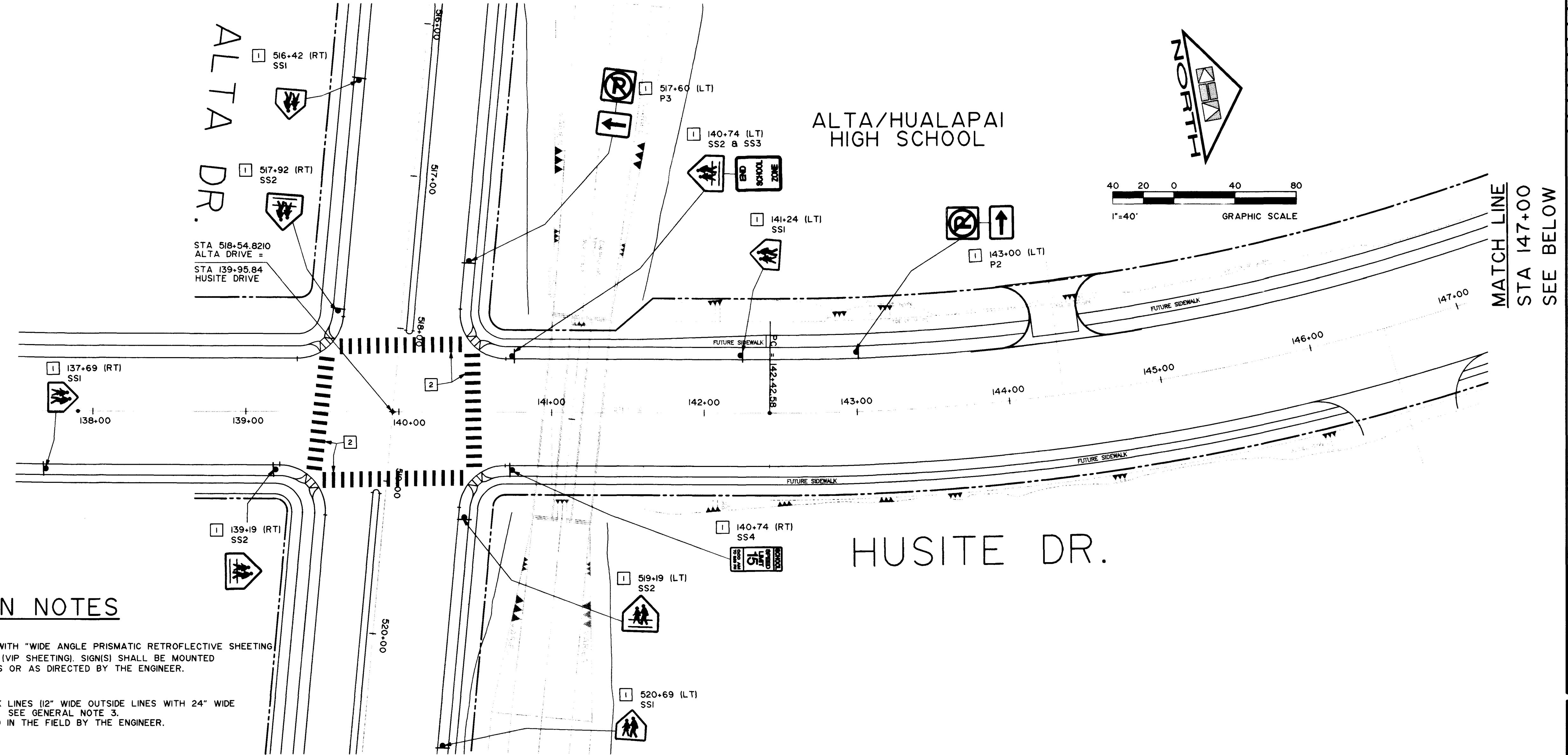

CONSTRUCTION NOTES

- 1 PROVIDE AND INSTALL NEW SIGNS WITH "WIDE ANGLE PRISMATIC RETROREFLECTIVE SHEETING FOR VISUAL IMPACT PERFORMANCE" (VIP SHEETING). SIGNS SHALL BE MOUNTED PER MANUFACTURERS SPECIFICATIONS OR AS DIRECTED BY THE ENGINEER.
- 2 INSTALL COLD POLYMER CROSSWALK LINES 1/2" WIDE OUTSIDE LINES WITH 24" WIDE TRANSVERSE LINES SPACED 6' O.C. SEE GENERAL NOTE 3. EXACT LOCATION TO BE DETERMINED IN THE FIELD BY THE ENGINEER.

ALTA/HUALAPAI
HIGH SCHOOL

MATCH LINE
STA 147+00
SEE ABOVE

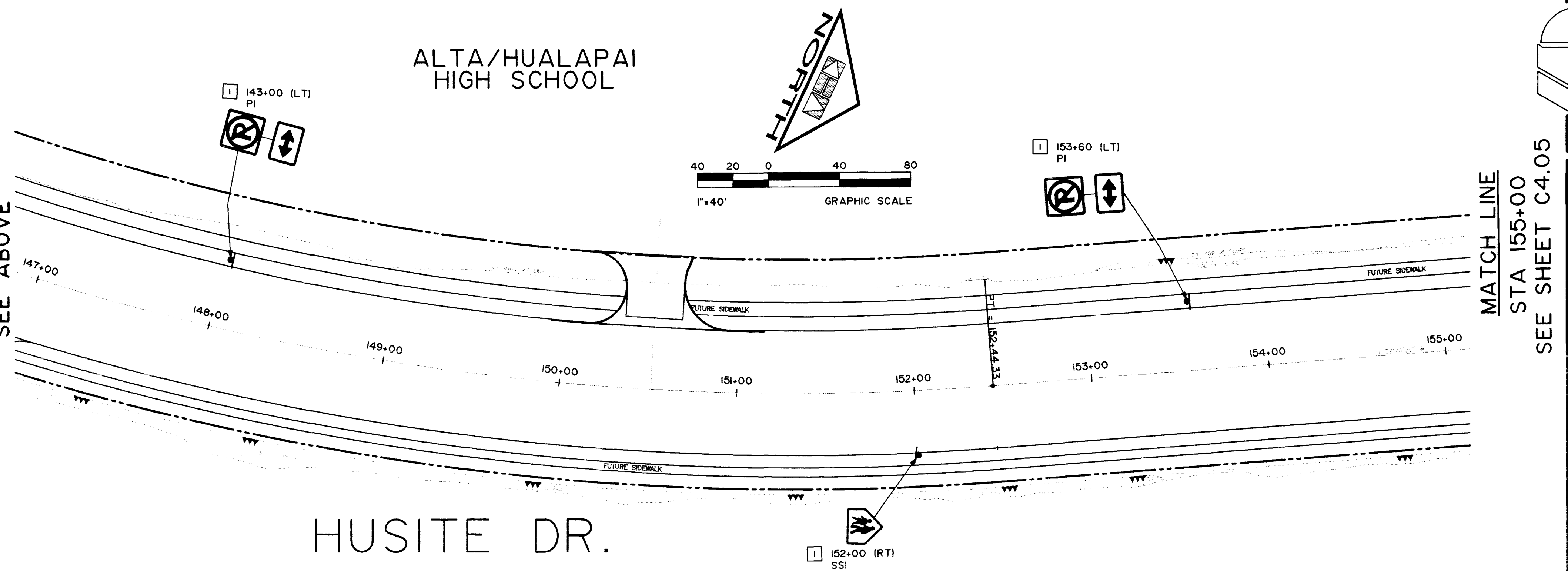

MATCH LINE
STA 155+00
SEE SHEET C4.05

SCALE: 1"=40'
FILE: K:\09205500\SCH-2A.DWG

Avoid cutting underground utility lines. It's costly.
Call before you Dig.
1-800-227-2600
UNDERGROUND SERVICE ALERT (USA)

REVISIONS			
REV	DESCRIPTION	DATE	BY
Δ	SHEET ADDED	5.9.96	CPT
	SHEET REISSUED PER		
Δ	CITY OF LAS VEGAS COMMENTS	7.3.96	CPT

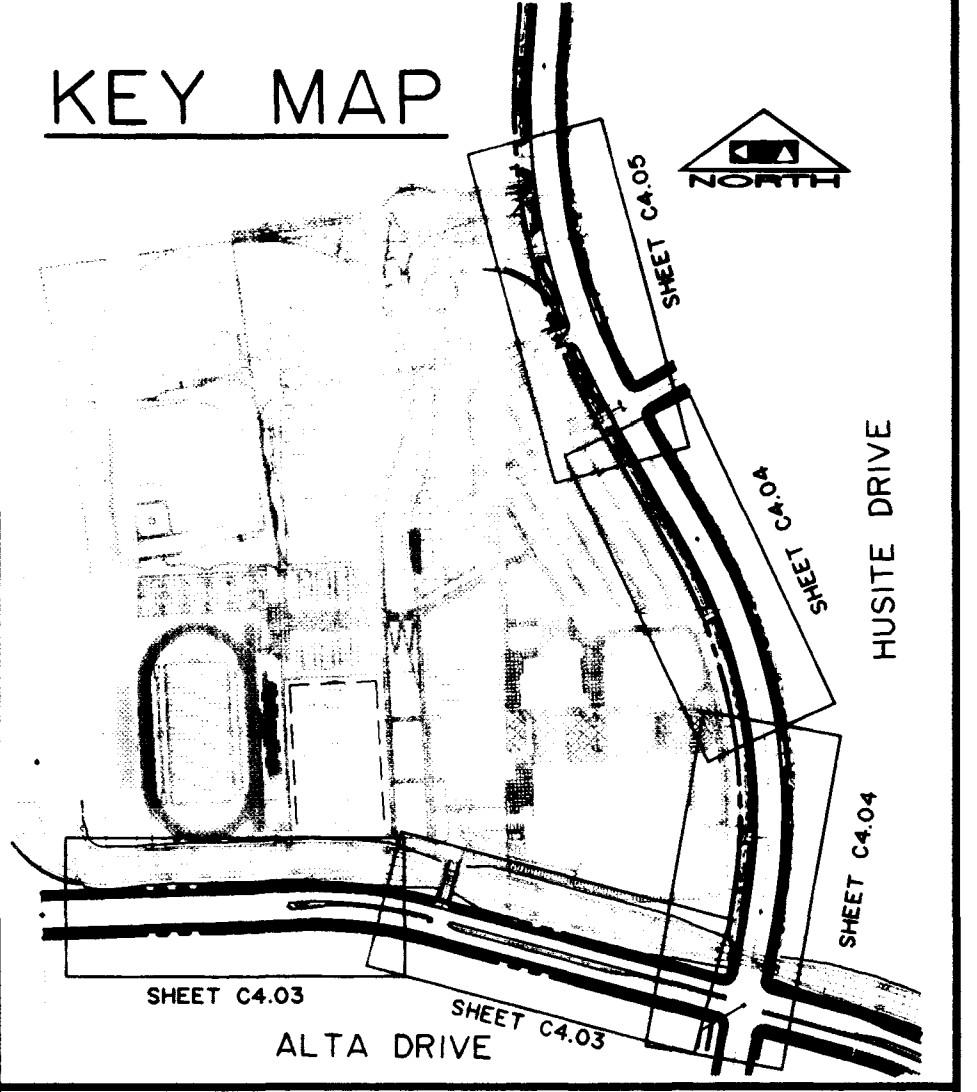

Kimley-Horn and Associates, Inc.
Las Vegas, Nevada © 1996

Professional Engineer Seal for Carson P. Turner, License No. 11759, State of Nevada. Includes project details: PROJECT NO. 0946, DATE 4.16.96, DRAWN BY CPT, CHECKED BY, SUBMITTAL, and BIDSET # 09205501.

POGGEMEYER DESIGN GROUP
PLANNERS, ENGINEERS, SURVEYORS
2801 NORTH TOWANA WAY, LAS VEGAS, NEVADA 89128 (702) 262-9100

TATE & SNYDER ARCHITECTS
709 VALLE VERDE COURT
HENDERSON NEVADA 89014
(702) 456.3000

CLARK COUNTY SCHOOL DISTRICT
CONSTRUCTION MANAGEMENT DEPARTMENT 4828 S. PEARL STREET 799-7600 LAS VEGAS, NEVADA 89121

PROJECT: ALTA/HUALAPAI HIGH SCHOOL
LAS VEGAS, NEVADA

SCHOOL SAFETY SIGNING

SHEET NO. **C 4.04**
23 OF 40

3035

7/5-98

MATCH LINE
STA 0+00
SEE SHEET C4.03

ALTA
DR. 618

ALTA/HUALAPAI
HIGH SCHOOL

MATCH LINE
STA 1+00
SEE BELOW

HUSITE DR.

CONSTRUCTION NOTES

- 1. ALL CONSTRUCTION SHALL BE IN ACCORDANCE WITH THE LATEST EDITIONS OF THE STANDARD SPECIFICATIONS FOR HIGHWAY CONSTRUCTION, AS APPLICABLE.
- 2. THE CONTRACTOR SHALL BE RESPONSIBLE FOR OBTAINING ALL NECESSARY PERMITS AND APPROVALS FROM THE APPROPRIATE AGENCIES.

ALTA/HUALAPAI
HIGH SCHOOL

MATCH LINE
STA 0+00
SEE ABOVE

MATCH LINE
STA 0+00
SEE SHEET C4.03

HUSITE DR.

REVISIONS	
NO.	DESCRIPTION



Engineering
BY: [Signature]
DATE: [Date]

PROJECT NO.	
DATE	
SCALE	

ARCHITECTS

THE WILLE VOIGT COURT
HENNINGSON NEVADA 89014
(702) 481-2000

CLARK COUNTY SCHOOL DISTRICT

ALTA/HUALAPAI HIGH SCHOOL
LAS VEGAS NEVADA

SCHOOL SAFETY SIGNAGE



REVISED: 11/15/11