

SCALE: 1/4"=40'
 FILE: K:\09205500\SCH-2.DWG

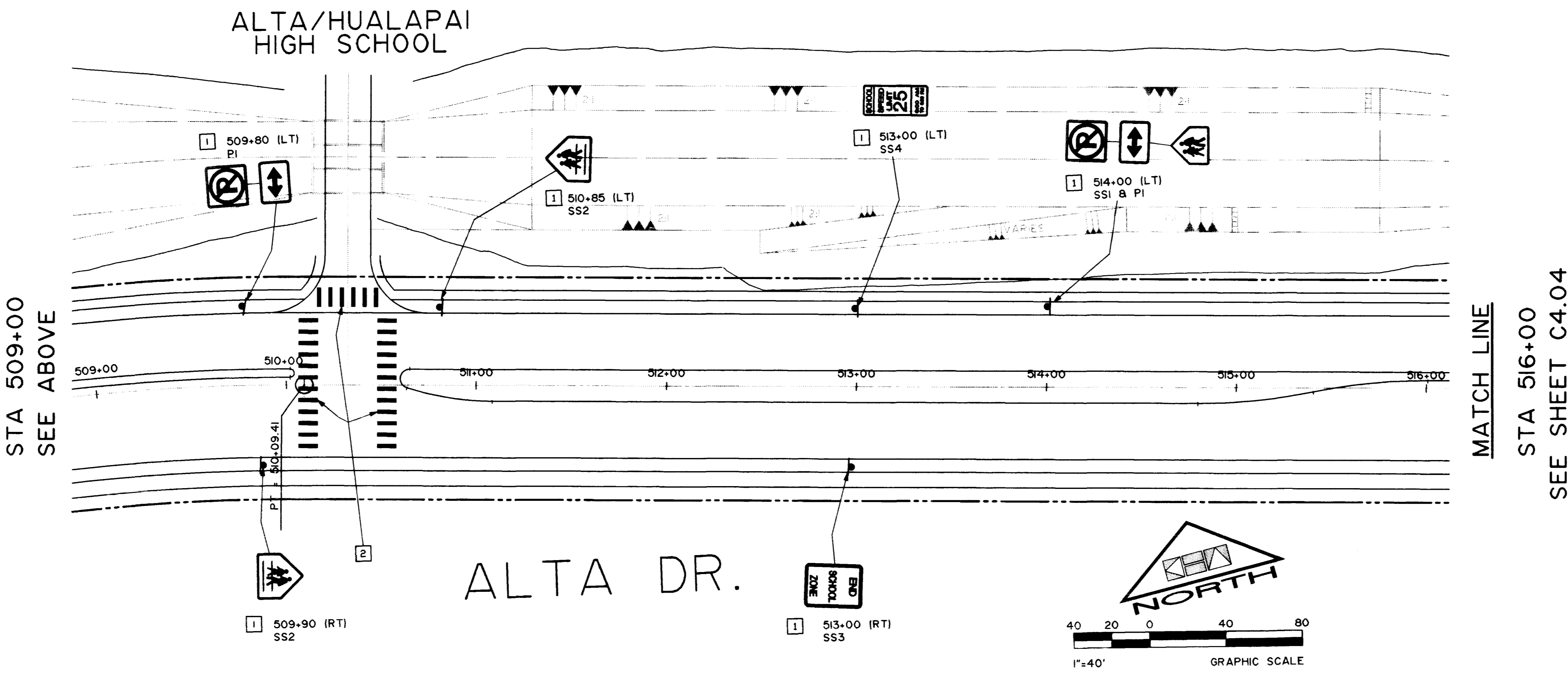

CONSTRUCTION NOTES

- 1 PROVIDE AND INSTALL NEW SIGN(S) WITH "WIDE ANGLE PRISMATIC RETROREFLECTIVE SHEETING FOR VISUAL IMPACT PERFORMANCE" (VIP SHEETING). SIGN(S) SHALL BE MOUNTED PER MANUFACTURERS SPECIFICATIONS OR AS DIRECTED BY THE ENGINEER.
- 2 INSTALL COLD POLYMER CROSSWALK LINES 1/2" WIDE OUTSIDE LINES WITH 24" WIDE TRANSVERSE LINES SPACED 6" O.C.) SEE GENERAL NOTE 3. EXACT LOCATION TO BE DETERMINED IN THE FIELD BY THE ENGINEER.

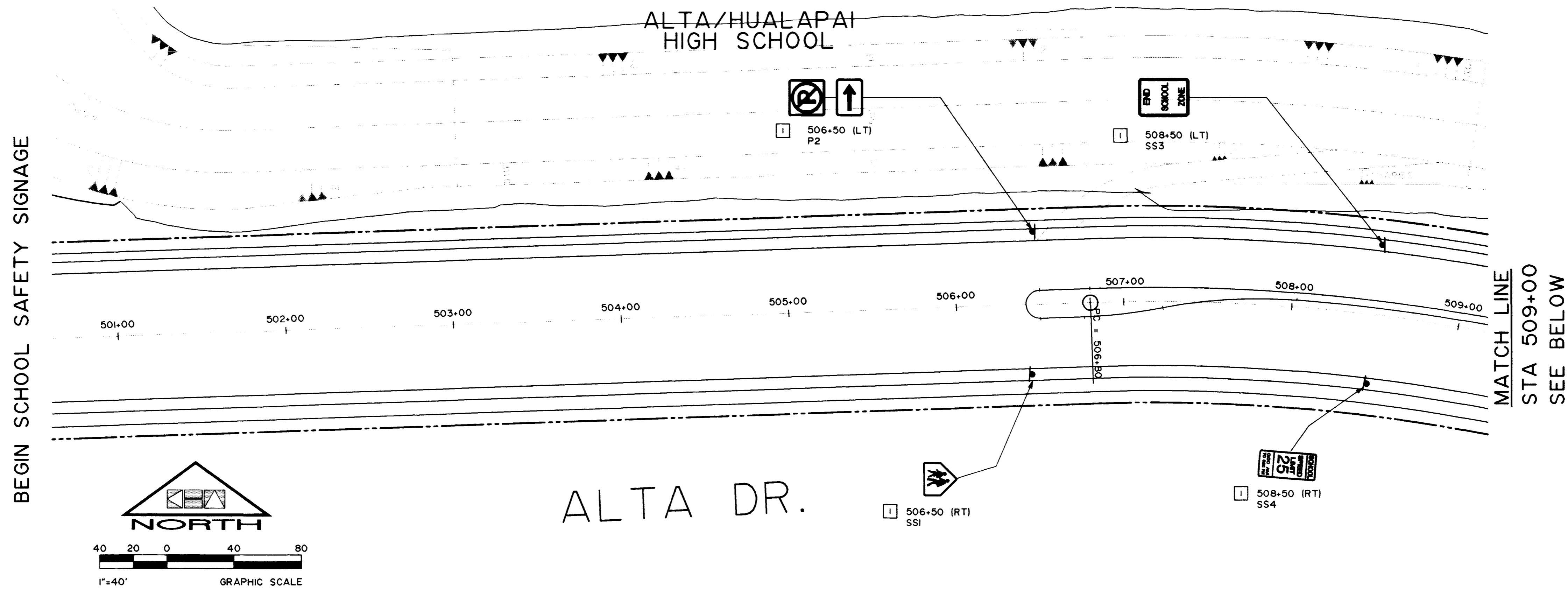

REVISIONS			
REV	DESCRIPTION	DATE	BY
1	SHEET ADDED	5.9.96	CPT
2	SHEET REISSUED PER		
3	CITY OF LAS VEGAS COMMENTS	7.3.96	CPT

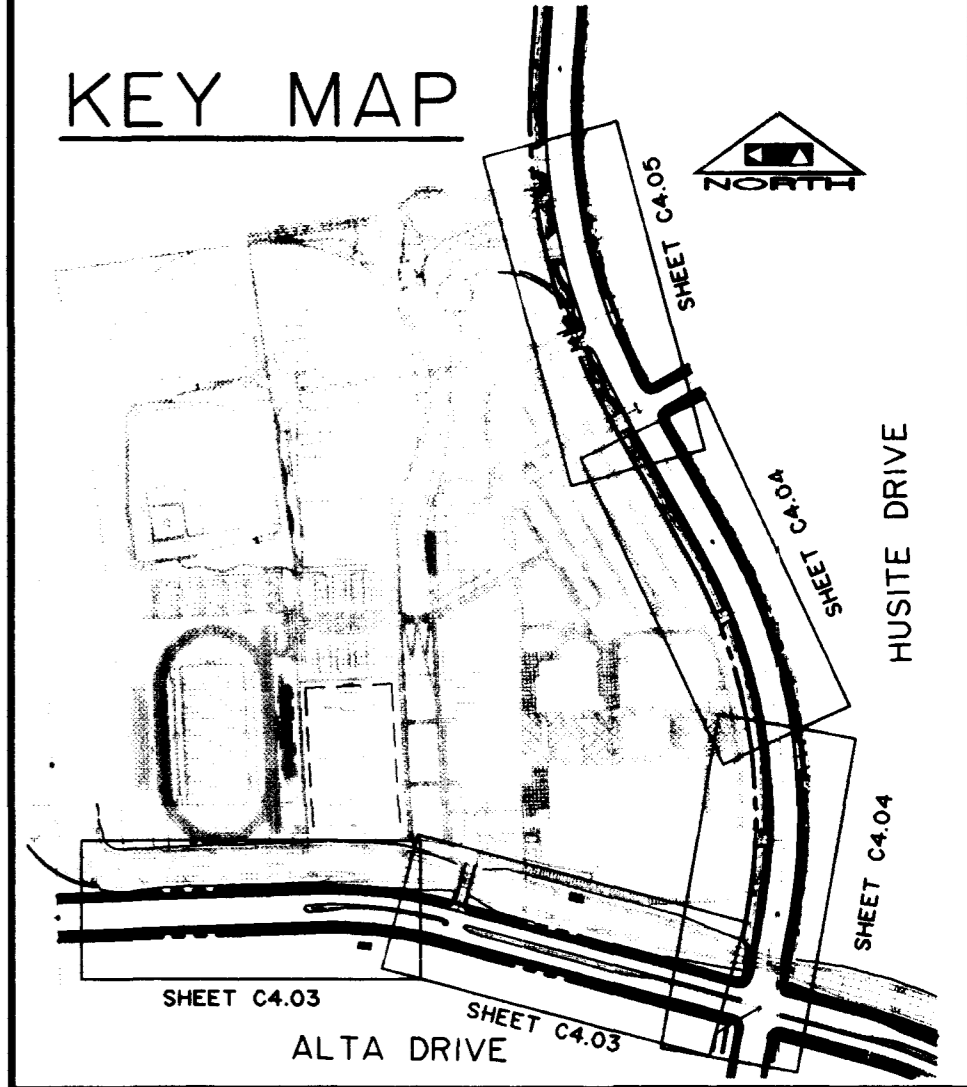

Kimley-Horn and Associates, Inc.
 Las Vegas, Nevada © 1996

Professional Engineer Seal for CARSON P. TURNER, No. 11753. Includes project number 0846, date 4.16.96, and drawing title SCHOOL SAFETY SIGNING.

POGGEMEYER DESIGN GROUP
 200 NORTH TULSA AVE., LAS VEGAS, NEVADA 89108
 PROJECT: ALTA/HUALAPAI HIGH SCHOOL

TATE & SINDER ARCHITECTS
 709 VALLE VERDE COURT
 HENDERSON NEVADA 89014
 (702) 456.3000

CLARK COUNTY SCHOOL DISTRICT
 CONSTRUCTION MANAGEMENT DEPARTMENT 4828 S. PEARL STREET 799-7600 LAS VEGAS, NEVADA 89121

ALTA/HUALAPAI HIGH SCHOOL
 LAS VEGAS, NEVADA

SCHOOL SAFETY SIGNING

SHEET NO. **C 4.03**
 22 OF 40

