

WEST REGENA AVENUE (PUBLIC) SEE SHEET 7

EULA STREET (PUBLIC) PLAN

SCALE: HORIZ. 1" = 30'

WEST AZURE DRIVE (PUBLIC) SEE SHEET 9

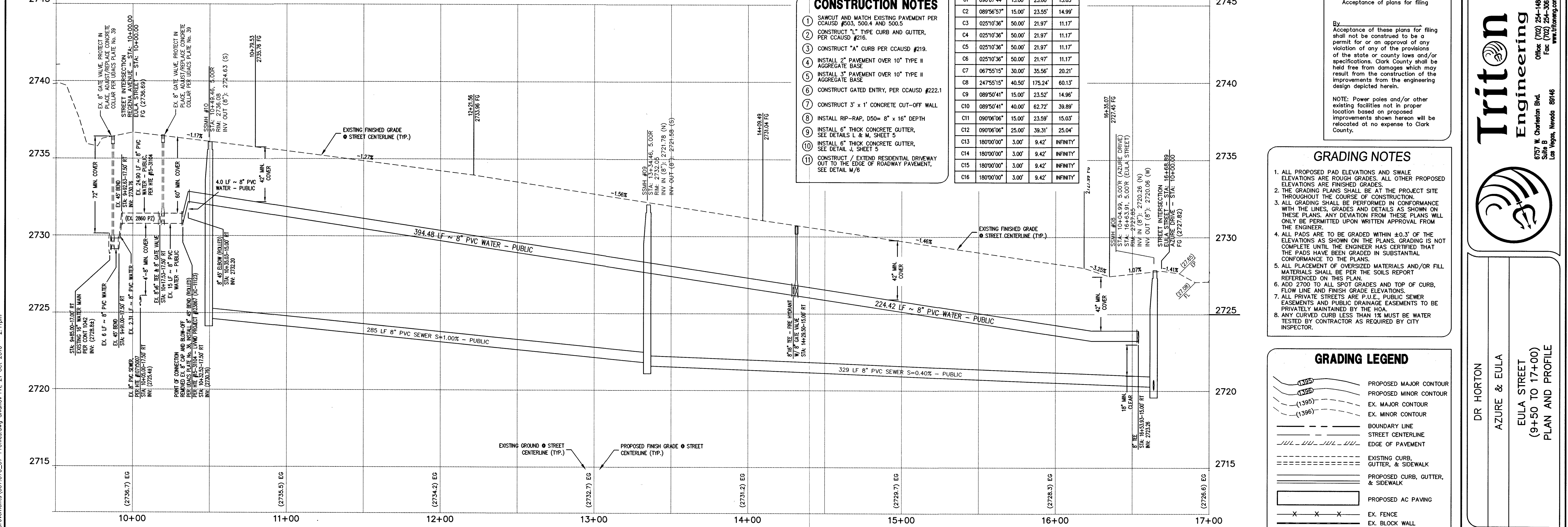

CURVE TABLE

CURVE	DELTA	RADIUS	LENGTH	TANGENT
C1	090°07'44"	15.00'	23.60'	15.03'
C2	089°56'57"	15.00'	23.55'	14.99'
C3	025°10'36"	50.00'	21.97'	11.17'
C4	025°10'36"	50.00'	21.97'	11.17'
C5	025°10'36"	50.00'	21.97'	11.17'
C6	025°10'36"	50.00'	21.97'	11.17'
C7	067°55'15"	30.00'	35.56'	20.21'
C8	247°55'15"	40.50'	175.24'	60.15'
C9	089°50'41"	15.00'	23.52'	14.96'
C10	089°50'41"	40.00'	62.72'	39.89'
C11	090°06'06"	15.00'	23.59'	15.03'
C12	090°06'06"	25.00'	39.31'	25.04'
C13	180°00'00"	3.00'	9.42'	INFINITY
C14	180°00'00"	3.00'	9.42'	INFINITY
C15	180°00'00"	3.00'	9.42'	INFINITY
C16	180°00'00"	3.00'	9.42'	INFINITY

- CONSTRUCTION NOTES**
- SAW CUT AND MATCH EXISTING PAVEMENT PER CCAUSD #503, 500.4 AND 500.5
 - CONSTRUCT "L" TYPE CURB AND GUTTER, PER CCAUSD #216.
 - CONSTRUCT "A" CURB PER CCAUSD #219.
 - INSTALL 2" PAVEMENT OVER 10" TYPE II AGGREGATE BASE
 - INSTALL 3" PAVEMENT OVER 10" TYPE II AGGREGATE BASE
 - CONSTRUCT GATED ENTRY, PER CCAUSD #222.1
 - CONSTRUCT 3' x 1' CONCRETE CUT-OFF WALL
 - INSTALL RIP-RAP, D50 = 8" x 16" DEPTH
 - INSTALL 6" THICK CONCRETE GUTTER, SEE DETAILS L & M, SHEET 5
 - INSTALL 6" THICK CONCRETE GUTTER, SEE DETAIL J, SHEET 5
 - CONSTRUCT / EXTEND RESIDENTIAL DRIVEWAY OUT TO THE EDGE OF ROADWAY PAVEMENT, SEE DETAIL M/6

FOR CLARK COUNTY JURISDICTION ONLY

CLARK COUNTY
DEPARTMENT OF PUBLIC WORKS
DEVELOPMENT REVIEW
Acceptance of plans for filing

By: _____
Acceptance of these plans for filing shall not be construed to be a permit for or an approval of any violation of any of the provisions of the state or county laws and/or specifications. Clark County shall be held free from damages which may result from the construction of the improvements from the engineering design depicted herein.

NOTE: Power poles and/or other existing facilities not in proper location based on proposed improvements shown hereon will be relocated at no expense to Clark County.

- GRADING NOTES**
- ALL PROPOSED PAD ELEVATIONS AND SWALE ELEVATIONS ARE ROUGH GRADES. ALL OTHER PROPOSED ELEVATIONS ARE FINISHED GRADES.
 - THE GRADING PLANS SHALL BE AT THE PROJECT SITE THROUGHOUT THE COURSE OF CONSTRUCTION.
 - ALL GRADING SHALL BE PERFORMED IN CONFORMANCE WITH THE LINES, GRADES AND DETAILS AS SHOWN ON THESE PLANS. ANY DEVIATION FROM THESE PLANS WILL ONLY BE PERMITTED UPON WRITTEN APPROVAL FROM THE ENGINEER.
 - ALL PADS ARE TO BE GRADED WITHIN ±0.3' OF THE ELEVATIONS AS SHOWN ON THE PLANS. GRADING IS NOT COMPLETE UNTIL THE ENGINEER HAS CERTIFIED THAT THE PADS HAVE BEEN GRADED IN SUBSTANTIAL CONFORMANCE TO THE PLANS.
 - ALL PLACEMENT OF OVERSIZED MATERIALS AND/OR FILL MATERIALS SHALL BE PER THE SOILS REPORT REFERENCED ON THIS PLAN.
 - ADD 2700 TO ALL SPOT GRADES AND TOP OF CURB, FLOW LINE AND FINISH GRADE ELEVATIONS.
 - ALL PRIVATE STREETS ARE P.U.E., PUBLIC SEWER EASEMENTS AND PUBLIC DRAINAGE EASEMENTS TO BE PRIVATELY MAINTAINED BY THE HOA.
 - ANY CURVED CURB LESS THAN 1% MUST BE WATER TESTED BY CONTRACTOR AS REQUIRED BY CITY INSPECTOR.

- GRADING LEGEND**
- PROPOSED MAJOR CONTOUR
 - PROPOSED MINOR CONTOUR
 - EX. MAJOR CONTOUR
 - EX. MINOR CONTOUR
 - BOUNDARY LINE
 - STREET CENTERLINE
 - EDGE OF PAVEMENT
 - EXISTING CURB, GUTTER, & SIDEWALK
 - PROPOSED CURB, GUTTER, & SIDEWALK
 - PROPOSED AC PAVING
 - EX. FENCE
 - EX. BLOCK WALL
 - PROPOSED RETAINING WALL
 - TOP OF FOOTING
 - APPROX. WALL LENGTH
 - TOP OF RETAINING WALL
 - PROPOSED SCARP

EULA STREET (PUBLIC) PROFILE

SCALE: HORIZ. 1" = 30'
VERT. 1" = 3'

GRAPHIC SCALE

(IN FEET)
1 inch = 30 ft.

BASIS OF BEARING
NORTH 89°53'26" WEST, BEING THE BEARING OF THE SOUTH LINE OF THE NORTHWEST QUARTER (NW 1/4) OF THE NORTHWEST QUARTER (NW 1/4) OF SECTION 30, TOWNSHIP 19 SOUTH, RANGE 60 EAST, M.D.M., CLARK COUNTY, NEVADA, AS SHOWN ON THAT CERTAIN MAP ON FILE IN THE CLARK COUNTY RECORDER'S OFFICE IN FILE 107, PAGE 31 OF SURVEYS.

BENCHMARK
CITY OF LAS VEGAS BENCHMARK: 6LV99 25NE66
A RIVET AND PLATE IN THE TOP OF CURB AT THE NORTH SIDE OF AZURE DRIVE, NEAR CHURCH, 330'+/- WEST OF HUALAPAI WAY.
ELEVATION=839.830 METERS (NAVD'88)
ELEVATION=2755.34 US SURVEY FEET (NAVD'88)

APPROVED FOR CONSTRUCTION

DR HORTON
AZURE & EULA
EULA STREET
(9+50 TO 17+00)
PLAN AND PROFILE

PROFESSIONAL ENGINEER - STATE OF NEVADA
JAMES M. PEARCE
Exp. 12-31-17
CIVIL
No. 9552

SHEET **8** OF 17
C.L.V. DWG.# 63459

DATE: 10/11/16 PROJECT NO.: 122399

10755045

HTE#16-35402

DATE: 10/16/2016
DRAWN BY: J. PEARCE
DESIGNED BY:
CHECKED BY:
NO. DESCRIPTION
SCALE: 1" = 30'
DATE

Triton Engineering
Office: (702) 254-1480
Suite B, Charleston Blvd., Las Vegas, Nevada 89146
Fax: (702) 254-3062
www.tritoneng.com