

IMPROVEMENT PLANS FOR CENTENNIAL HILLS REHABILITATION HOSPITAL LAS VEGAS, NV

6166 NORTH DURANGO DR.

CENTENNIAL HILLS CENTER

A PORTION OF LOT 1A, AS SHOWN ON FILE IN FILE 193, PAGE 44 OF RECORDS OF SURVEY. SAID LOT 1A DEFINED IN DEED RECORDED 20141219:0002355 OF OFFICIAL RECORDS IN THE OFFICE OF THE CLARK COUNTY RECORDER, NEVADA. THE LOT FOR THIS PROPOSED DEVELOPMENT HAS NOT BEEN CREATED AS OF AUGUST, 2015. A.P.N.: 125-29-512-005

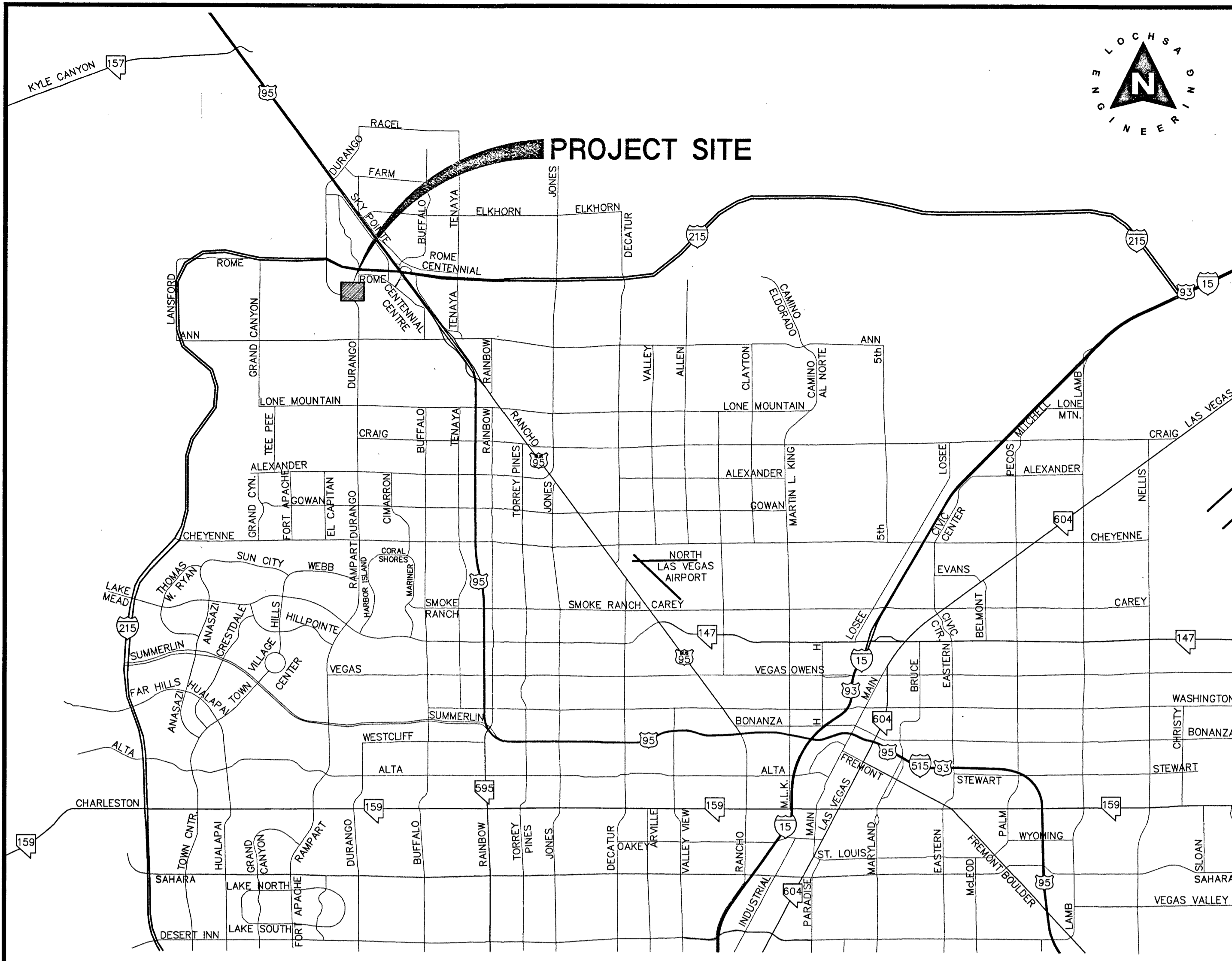
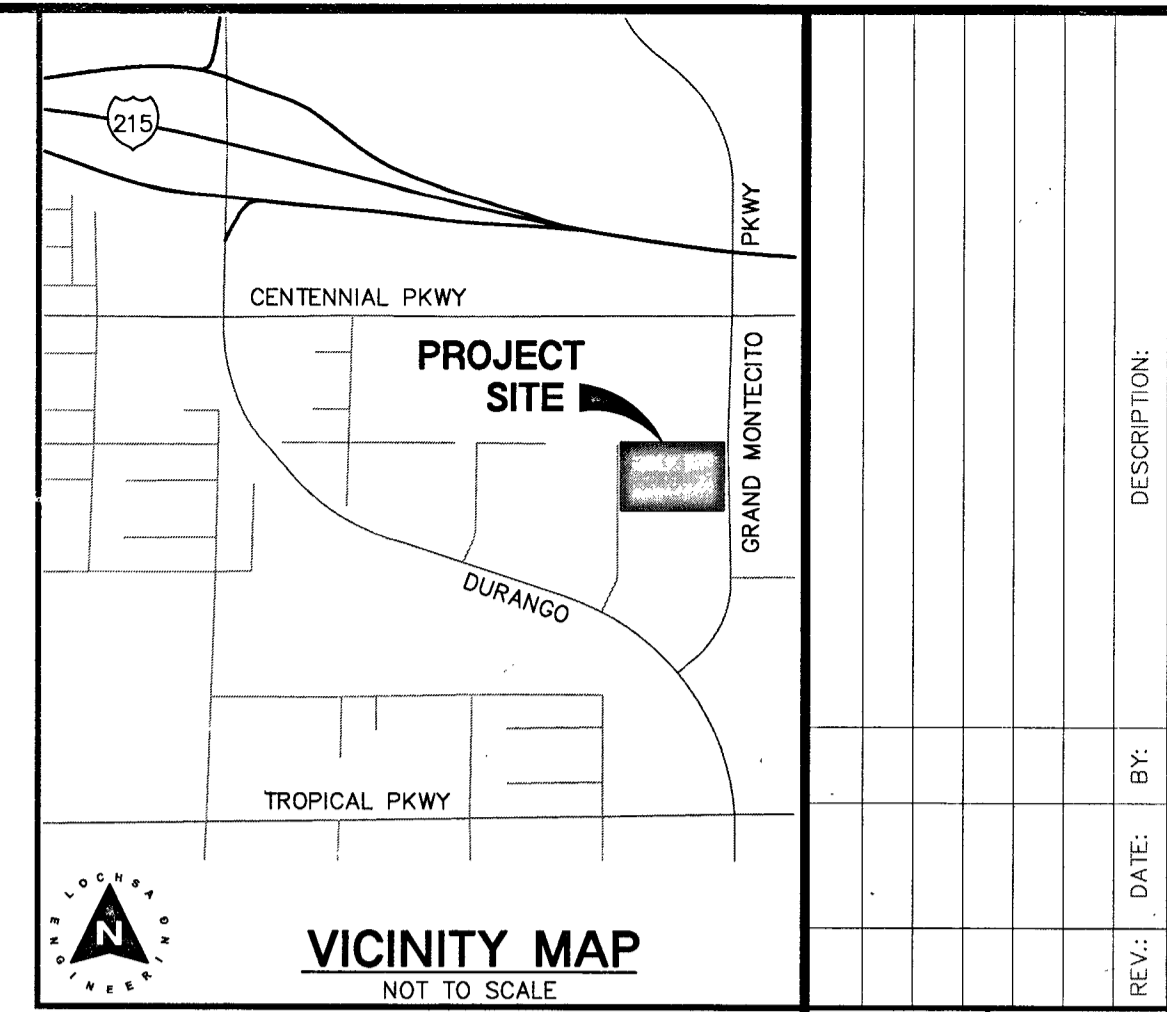

REV #	REVISION DESCRIPTION	SHEET(S)	APPD BY	DATE APPD
1	REVISED SEWER PER PLUMB. PLANS. ADDED PROP. WATER LINES. ADD ISOLATION VALVES, AND REPLACE PADS FOR DUAL 4" BACKFLOWS, PIPING, ENCLOSURES DUE TO DAMAGE DURING CONSTRUCTION AS REQUIRED BY LVMO.	C2.01	J.M.	11/31/17

ABBREVIATIONS

ABAN	ABANDON	INV	INVERT
ABP	ABANDON IN PLACE	ISL	ISLAND
AGG	AGGREGATE	JR	JUNCTION BOX
ALT	ALTERNATE	LOC	LENGTH OF CURB
ANODE	ANODE, GAS	LT	LEFT
ACP	ASBESTOS CEMENT PIPE	LF	LINEAR FEET
ACR	ASPHALTIC CONCRETE	LWVD	LAS VEGAS VALLEY WATER DISTRICT
AVE	AVENUE	MH	MANHOLE
BC	BACK OF CURB	MAX	MAXIMUM
BCR	BACK OF CURB RADIUS	MIN	MINIMUM
BVC	BEGINNING OF VERTICAL CURVE	MON	MONOLITHIC
BM	BENCHMARK	N/O	NORTH OF
BNRY LINE	BOUNDARY LINE	NOT TO SCALE	NOT TO SCALE
CATV	CABLE TELEVISION	OC	ON CENTER
C-C	CENTER TO CENTER	OG	OPEN-GRADED PAVEMENT, ORIGINAL GROUND
CL	CENTERLINE	PVMT	PAVEMENT
CBC	CITY OF BOULDER CITY	PI	POINT OF INTERSECTION
CLV	CITY OF LAS VEGAS	PRC	POINT OF REVERSE CURVE
COH	CITY OF HENDERSON	PC	POINT OF CURVE
CM	CITY OF MESQUITE	PT	POINT OF TANGENCY
CNVL	CITY OF NORTH LAS VEGAS	PCC	POINT OF COMPOUND CURVE
CC	CLARK COUNTY	PCC, CONC	PORTLAND CEMENT CONCRETE
CCWRD	CLARK COUNTY WATER RECLAMATION DISTRICT	PP	POWER POLE
CO	CLEAN OUT, SEWER	P	POWER
COMM	COMMERCIAL	PL	PROPERTY LINE
CONC, PCC	CONCRETE	PROP	PROPOSED
CONST	CONSTRUCTION OR CONSTRUCT	PULL BOX	PULL BOX
COR	CORNER	RP	RADIUS POINT
CMP	CORRUGATED METAL PIPE	R	RADIUS
CSAP	CORRUGATED STEEL ARCH PIPE	RR	RAILROAD
CSP	CORRUGATED STEEL PIPE	REIN	REINFORCED
C&G	CURB & GUTTER	RC	REINFORCED CONCRETE
CP	CAST IRON PIPE	RCB	REINFORCED CONCRETE BOX
COL	COLUINN	RCPP	REINFORCED CONCRETE PIPE
CU YD, CY	CUBIC YARD	RELOC	RELOCATE
CU FT, CF	CUBIC FOOT	RT	RIGHT
CULV	CULVERT	R/W	RIGHT-OF-WAY
CF	CURB FACE	R	ROAD
DEPT	DEPARTMENT	RS	SANITARY SEWER
DIA	DIAMETER	SHT	SHEET
DWY	DRAINAGE	S/O	SOUTH OF
DI	DROP INLET	SW	WEST SIDE
EJOM	EASEMENT	SQ FT, SF	SQUARE FOOT
E/O	EAST OF	SQ YD, SY	SQUARE YARD
EP	EDGE OF PAVEMENT	STA	STATION
EO	EDGE OF OIL	SHP	STEEL HIGHPRESSURE PIPE
E	ELECTRIC	SD	STORM DRAIN
EM	ELECTRIC METER	STD	STANDARD
ELEV	ELEVATION	STRUC	STRUCTURAL OR STRUCTURE
EMBK	EMBANKMENT	SURV	SURVEY
EGR	END OF CURB RETURN	ST	STREETLIGHT
EC	END OF CURVE	TL	TELEPHONE
EBS	CATHODE PROTECTION BOND STATION	TEMP	TEMPORARY
ETS	CATHODE PROTECTION TEST STATION	TBA	TO BE ADJUSTED
EV	END OF VERTICAL CURVE	TR	TO BE REMOVED
EXIST	EXISTING	TC	TOP OF CURB
FT	FEET/FOOT	TP	TOP OF PIPE
FG	FINISH GRADE	TS	TRAFFIC SIGNAL
FA	FIRE ALARM	TSI	TRAFFIC SIGNAL INTERCONNECT
FH	FIRE HYDRANT	TRANS	TRANSITION
FL	FLOW LINE	TR	TYPICAL
GLV	GLAVANIZED	UG	UNDERGROUND
GM	GAS METER	VAR	VARIABLE
GR	GAS PRESSURE REGULATOR	VERT	VERTICAL
PL-G	PLASTIC GAS	VC	VERTICAL CURVE
SG	STEEL GAS	VG	VALLEY CUTTER
VCP	GRADE BREAK	W	WATER
GUT	GUTTER	WM	WATER METER
HDWL	HEADWALL	W/O	WEST OF
IN	INCH	YD	YARD
INT	INTERSECTION		

DEVELOPER

CENTENNIAL HILLS MOB OWNERS, LLC
 6861 DONALD ROSS ROAD
 PALM BEACH GARDENS, FL 33418
 CONTACT: ROBERT SINA
 PHONE: 561-627-8725

OWNER

CENTENNIAL HILLS MOB OWNERS, LLC
 6861 DONALD ROSS ROAD
 PALM BEACH GARDENS, FL 33418
 CONTACT: ROBERT SINA
 PHONE: 561-627-8725

UTILITY PROVIDERS

WATER:	LAS VEGAS VALLEY WATER DISTRICT
SEWER:	CITY OF LAS VEGAS
GAS:	SOUTHWEST GAS CORPORATION
ELECTRIC:	NV ENERGY
TELEPHONE:	CENTURYLINK
CABLE TV:	COX COMMUNICATIONS LAS VEGAS, INC.
TRASH:	REPUBLIC SILVER STATE DISPOSAL SERVICE

APPROVALS

	8-2-16
ALLEN PAVELKA, P.E., #9029 CITY ENGINEER	DATE
APPROVAL OF THESE PLANS IS LIMITED TO THOSE IMPROVEMENTS CONSTRUCTED IN THE DEDICATED RIGHT-OF-WAY AND/OR DEDICATED EASEMENTS. THIS APPROVAL DOES NOT AUTHORIZE THE CONSTRUCTION OF ANY IMPROVEMENTS THAT DEVIATE FROM ADOPTED STANDARDS AND/OR SPECIFICATIONS, EXCEPT THOSE SPECIFICALLY LISTED UNDER DEVIATIONS FROM STANDARD. THE ENGINEER SHALL RESOLVE ANY DEVIATION OTHER THAN THOSE LISTED IN DEVIATIONS FROM STANDARDS IN FAVOR OF THE UNIFORM STANDARDS DRAWINGS AND SPECIFICATIONS CLARK COUNTY AREA, NEVADA.	
	8-1-16
CHRIS KNIGHT, DIRECTOR BUILDING AND SAFETY	DATE
NOTE: THIS PLAN CONFORMS TO THE APPLICABLE STANDARDS OF THE PLANNING DEPARTMENT.	
	5/18/16
LAS VEGAS FIRE AND RESCUE	DATE
	7/20/16
LAS VEGAS VALLEY WATER-DISTRICT ENGINEERING SERVICES MANAGER PROJECT 124189-SHEETS C1.01, C1.02, C2.01	DATE
	4-28-16
SOUTHWEST GAS CORPORATION	DATE
	4-22-16
NV ENERGY	DATE
NV ENERGY ACKNOWLEDGES THAT WE HAVE RECEIVED YOUR PLANS AND WILL PROVIDE SERVICE TO ALL ELECTRICAL NEEDS ASSOCIATED WITH THIS PROJECT. NV ENERGY RESERVES THE RIGHT TO ADDRESS ANY EXISTING OR FUTURE CONFLICTS ONCE THE FINAL DESIGN IS COMPLETED. THE NEW SERVICE AND THE RESOLUTION OF ANY CONFLICTS WILL BE ACCOMPLISHED PURSUANT TO THE NEVADA PUBLIC UTILITY COMMISSION'S RULES AND REGULATIONS.	
	4-28-16
COX COMMUNICATIONS LAS VEGAS, INC.	DATE
	4-27-16
CENTRAL TELEPHONE COMPANY D.B.A. CENTURYLINK	DATE
THE AFFIXED CENTURYLINK APPROVAL DOES NOT ASSUME OR GUARANTEE LIABILITY FOR KNOWN OR UNKNOWN CONFLICTS WITH EXISTING OR PROPOSED IMPROVEMENTS. RESOLUTION OF ANY CONFLICT WILL BE ACCOMPLISHED PURSUANT TO LOCAL ORDINANCES, NEVADA REVISED STATUTES AND/OR PUBLIC UTILITY COMMISSION RULES AND REGULATIONS.	

SHEET INDEX

Sheet Title	Sheet
General	
1 COVER SHEET	C1.01
2 GENERAL NOTES	C1.02
3 Utility Plans	
SHEET 1	C2.01
4 Grading Plans	
SHEET 1	C3.01
5 Horizontal Control Plans	
SHEET 1	C4.01
6 Detail Sheets	
SHEET 1	C6.01

GENERAL SITE INFORMATION

NOTE:
ALL LOCATIONS OF UTILITIES SHOWN ARE APPROXIMATE

NOTE:
LOCHSA ENGINEERING ASSUMES NO RESPONSIBILITY FOR EXISTING UTILITY LOCATIONS AND ELEVATIONS. THE UTILITIES SHOWN ON THIS PLAN ARE FROM THE BEST AVAILABLE INFORMATION. IT IS THE CONTRACTOR'S RESPONSIBILITY TO FIELD VERIFY THE LOCATION AND ELEVATION OF ALL UTILITIES, INCLUDING BUT NOT LIMITED TO, THE WATER, FIRE, SANITARY SEWER, STORM SEWER, TELEPHONE, POWER, GAS, AND IRRIGATION LINES PRIOR TO THE COMMENCEMENT OF CONSTRUCTION. IF CONFLICT EXISTS IN THE FIELD, THE CONTRACTOR IS TO NOTIFY THE PROJECT ARCHITECT, OWNER'S REPRESENTATIVE AND THE PROJECT ENGINEER IMMEDIATELY.

SAFETY ALERT
Call before you dig
Avoid cutting underground utility lines. It's costly.

Call Before You Overhead
Call before you dig
UnderGround

AP.N.:
125-29-512-005

BASIS OF BEARINGS:
THE EAST LINE OF THE NORTHEAST QUARTER (NE 1/4) OF THE NORTHEAST QUARTER (NE 1/4) SECTION 29, TOWNSHIP 19 SOUTH, RANGE 60 EAST, M.D.M., CITY OF LAS VEGAS, CLARK COUNTY, NEVADA, AS SHOWN ON THAT MAP ON FILE IN BOOK 139 OF PLATS, PAGE 48, CLARK COUNTY RECORDER'S OFFICE, SAID LINE BEARS: NORTH 00° 27' 37" WEST.

BENCHMARK:
CITY OF LAS VEGAS MONUMENT ID: 14LV9029NE6 RIVET & PLATE IN TOP OF CURB 150' NW OF 1/16 CORNER, IRRIGATION LINES PRIOR TO THE COMMENCEMENT OF WEST SIDE OF GRAND MONTECITO PKWY. BETWEEN NORTH DURANGO AND WEST CENTENNIAL PKWY.

NAVD 88 = 2478.82 FEET
= 755.546 METERS

1-702-432-5300
1-702-227-2929
1-800-227-2800

LEGEND	DESCRIPTION:	CONTOUR LINES	EDGE OF PAVEMENT	"A" TYPE CURBS	"L" TYPE CURBS	WALLS	FENCES	AC PAVEMENT	CONCRETE	SPOT ELEVATIONS	SIGNS	MANHOLE W/ DESCRIPTION	MANHOLE DESCRIPTIONS	FIRE HYDRANTS	GAZE VALVES	REDUCERS	CLEAN OUTS	UTILITY BOX OR VAULT	BACKWATER VALVES	120W HPS STREETLIGHTS	200W HPS STREETLIGHTS	250W HPS STREETLIGHTS
CL OR SURVEY LINE	EXISTING: (2210)	---	---	---	---	---	---	---	---	12.34	12.34	12.34	12.34	12.34	12.34	12.34	12.34	12.34	12.34	12.34	12.34	12.34
PROPERTY LINE	PROPOSED: (2122)	---	---	---	---	---	---	---	---	12.34	12.34	12.34	12.34	12.34	12.34	12.34	12.34	12.34	12.34	12.34	12.34	12.34
ROW LINE		---	---	---	---	---	---	---	---	12.34	12.34	12.34	12.34	12.34	12.34	12.34	12.34	12.34	12.34	12.34	12.34	12.34

6945 South Jones Blvd
 Suite 100
 Las Vegas, NV 89118
 Phone: (702) 253-8317
 Fax: (702) 253-8317
 www.lochsa.com

Lochsa
 ENGINEERING

CENTENNIAL HILLS REHABILITATION HOSPITAL
 LAS VEGAS, NV

GENERAL COVER SHEET

PROJECT No.: 151113
 DATE: 03/11/16
 SCALE: AS SHOWN
 DRAWN BY: MH
 DESIGNED BY: CP/MH
 CHECKED BY: TE

SHEET No.: 04-20-2016
 SHEET 1 OF 6
 C1.01
 CLV No.: 107V6665 TH 63059