

MATCHLINE
SEE SHEET 3
FOR CONTINUATION

MATCHLINE - SEE SHEET 5
FOR CONTINUATION

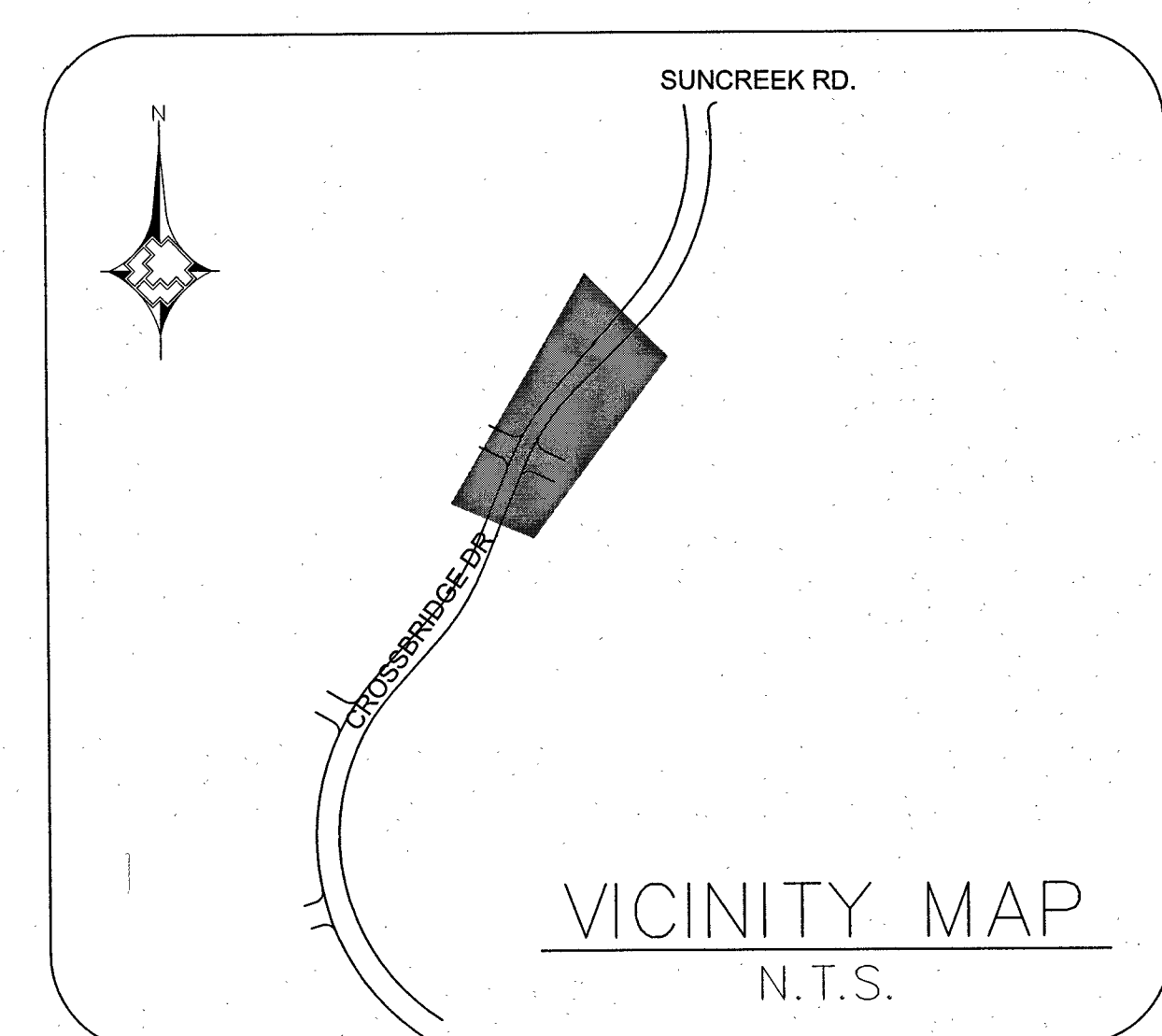
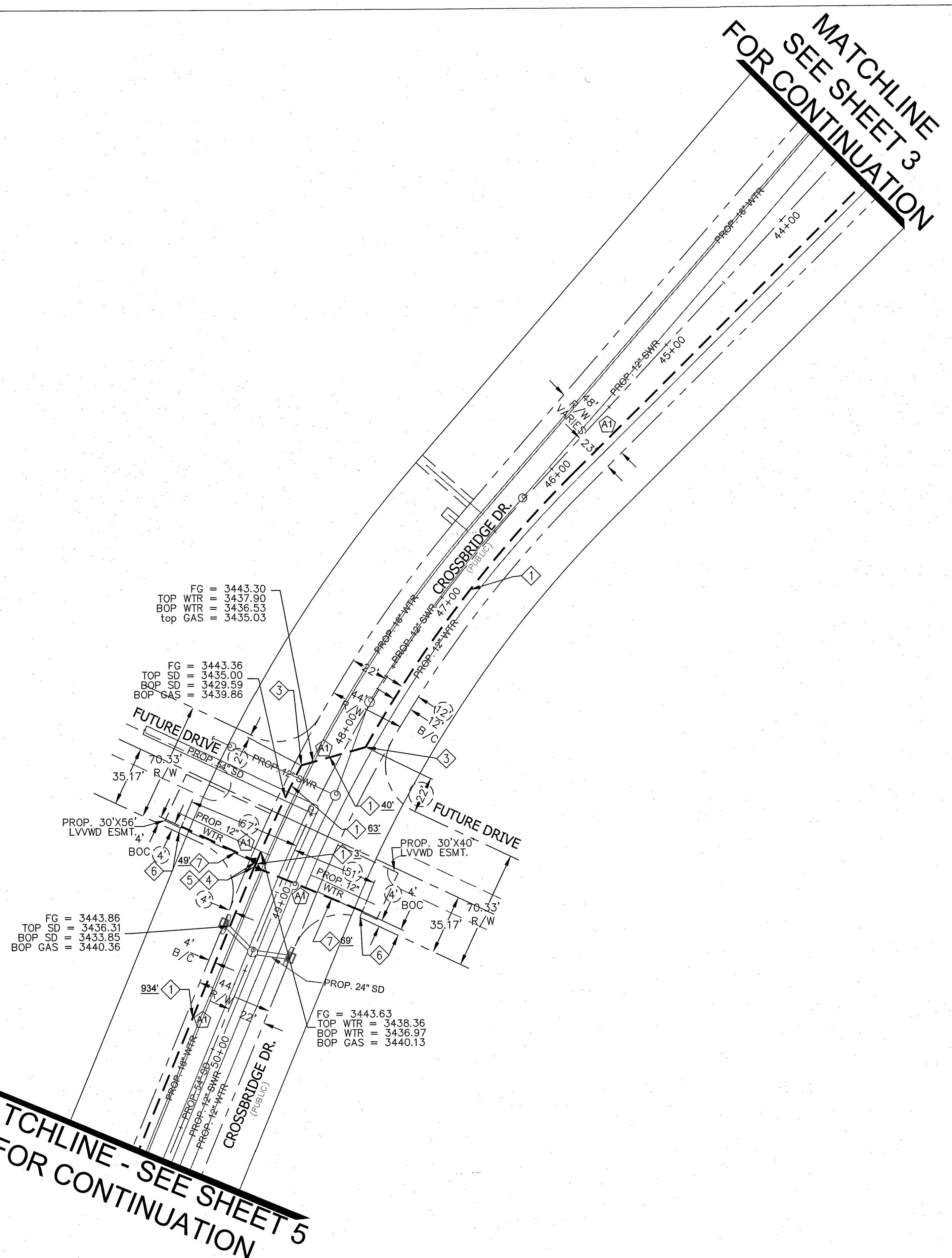

LEGEND:

- EXISTING GAS LINE
- GAS LINE TO BE ABANDONED
- EXISTING GAS SERVICE
- PROPOSED MAIN GAS LINE (NEW)
- PROPOSED SERVICE LATERAL (NEW)
- PROPOSED SERVICE LINE (NEW)
- RIGHT OF WAY LINE
- STREET CENTERLINE
- PROPERTY LINE
- BACK OF CURB
- MATCHLINE
- EASEMENT
- EXISTING ANODELESS RISER
- EXISTING ANODE RISER
- EXISTING GAS LIGHT
- EXISTING GAS VALVE
- SAWCUT & PATCH

RTC NOTES:
PAVEMENT REPAIR SHALL CONFORM TO RTC STANDARD(S):
A1 503



1. _____ 2. _____ 3. _____ 4. _____ NO. DESCRIPTION BY DATE APPVD.		AS-BUILT DRAWING-PRESSURE TEST DATA PIPE DIA. _____ TEST MEDIUM <input type="checkbox"/> AIR <input type="checkbox"/> GAUGE PIPE LENGTH _____ <input type="checkbox"/> NITROGEN <input type="checkbox"/> CHART PIPE TYPE _____ <input type="checkbox"/> WATER GAUGE/ MIN. DURATION _____ <input type="checkbox"/> SOAP PRESS REC SNM TEST PRES. (PSIG) _____ START _____ END _____ TIME _____ DATE _____ PERFORMED BY _____		VISUAL INSPECTION CERTIFICATION I HAVE VISUALLY INSPECTED ALL HEATED FUSIONS, SOLWELD CEMENT, MECHANICAL JOINTS, AND WELDS THAT I HAVE PERFORMED NAME _____ DATE _____ INSPECTOR _____ FOREMAN _____ REVIEWED BY SEE SHEET 2		CONSTRUCTION ISOLATION AREA ISO_21 DIST_323 W.R. NO. 3131360		ENGINEER/TECH: PAMELA KENNEDY ACCOUNT REP: SHANTE ANDERSON PROJECT CONTACT: CHRIS ANDERSON SHEET NO: 4 OF 7 DWN. BY: ZONE ENG SCALE: 1" = 40' DATE: 6/6/16 PHONE: 702-365-2364 PHONE: 702-528-8596 PHONE: DATE: 6/6/16 APPVD. BY:	
REVISIONS		SEE SHEET 2		PERMIT INFORMATION CITY OF LAS VEGAS TAX CODE 02-0200		LOCATION T20S R59E SEC 33 M.D.M. ATLAS #/TILE # x561y514 x561y512		TITLE SUMMERLIN VILLAGE 24 CROSSBRIDGE UNIT 2 107V6535 H# 62303	

