

THIS AREA INTENTIONALLY LEFT BLANK

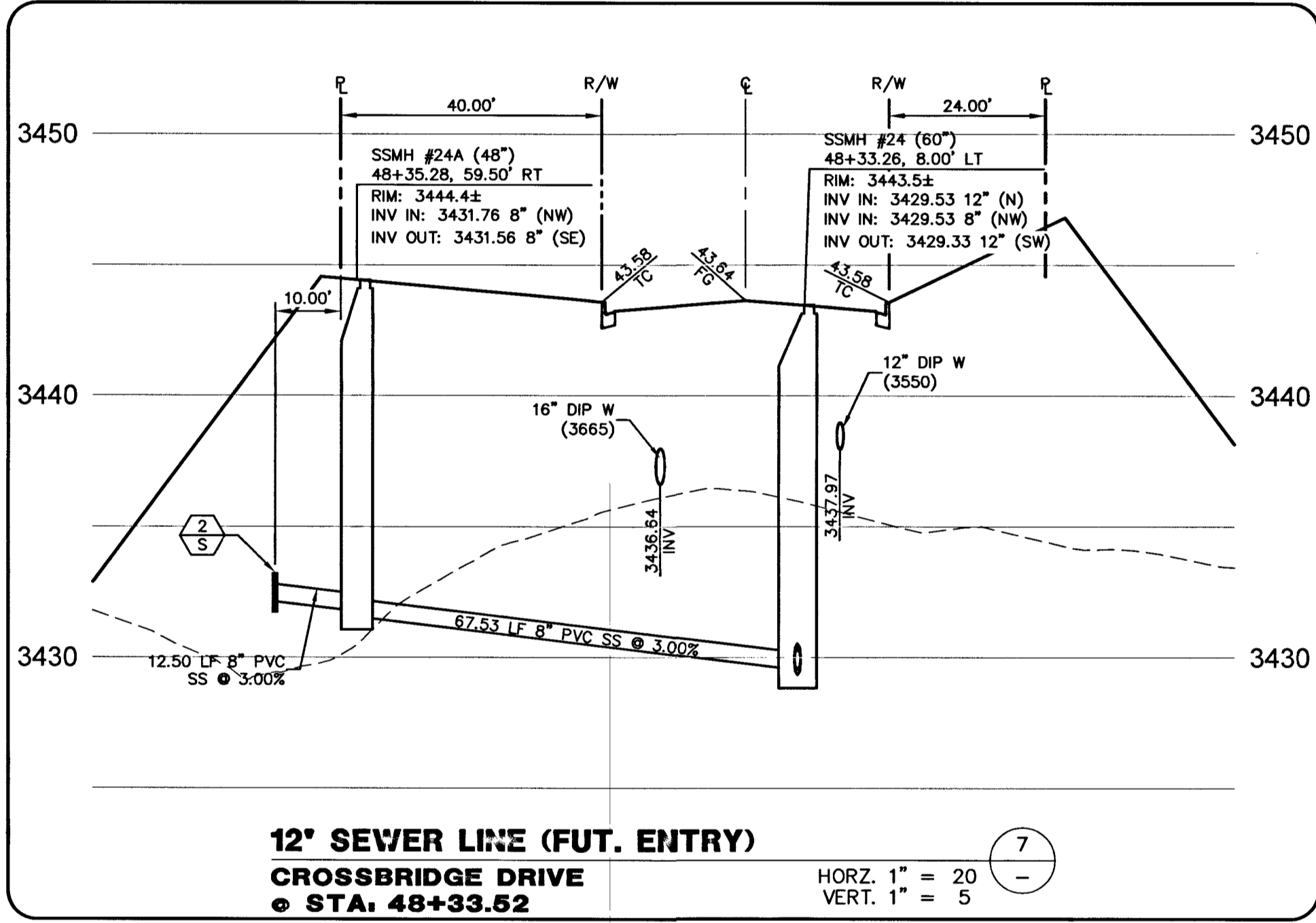

THIS AREA INTENTIONALLY LEFT BLANK

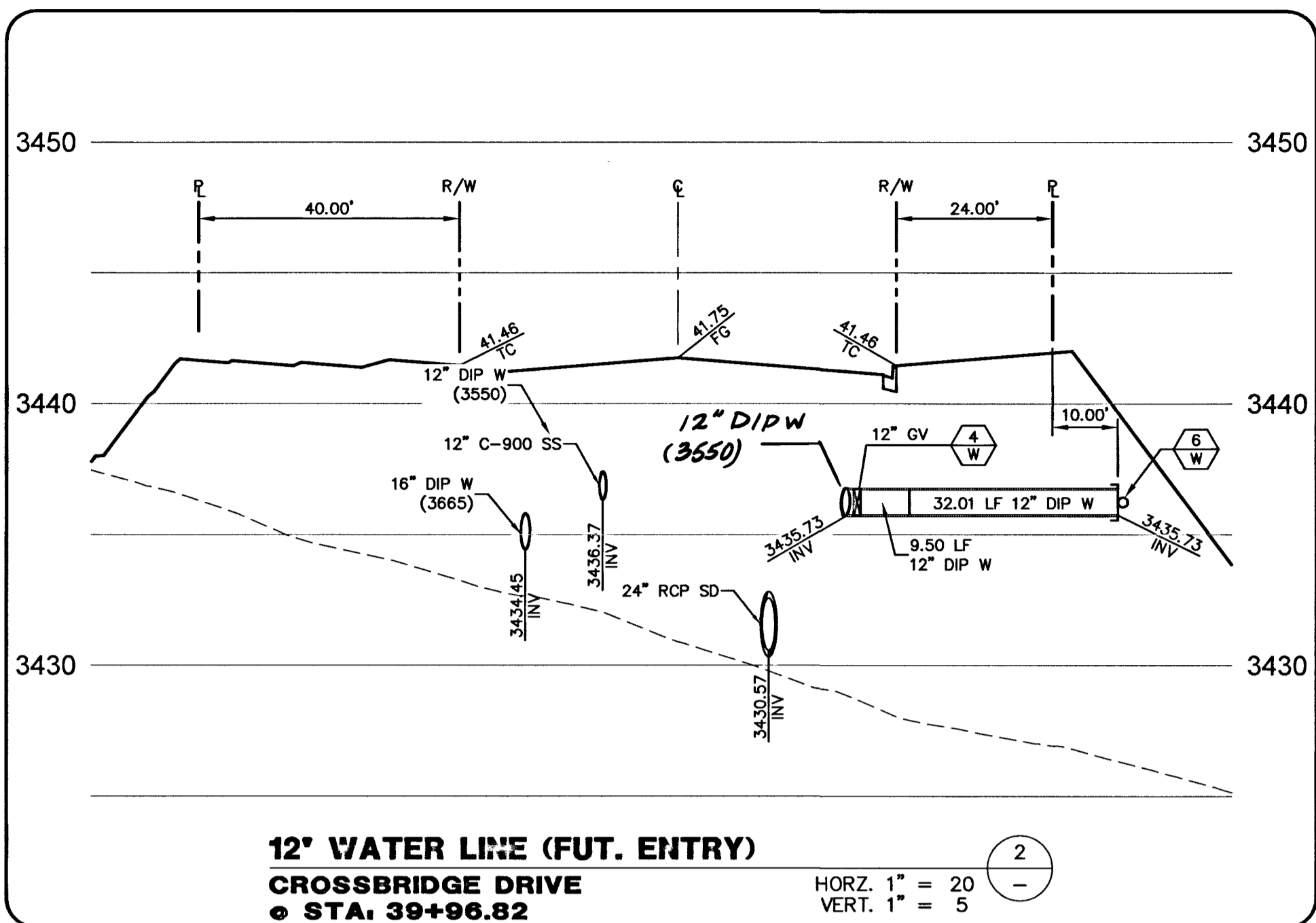
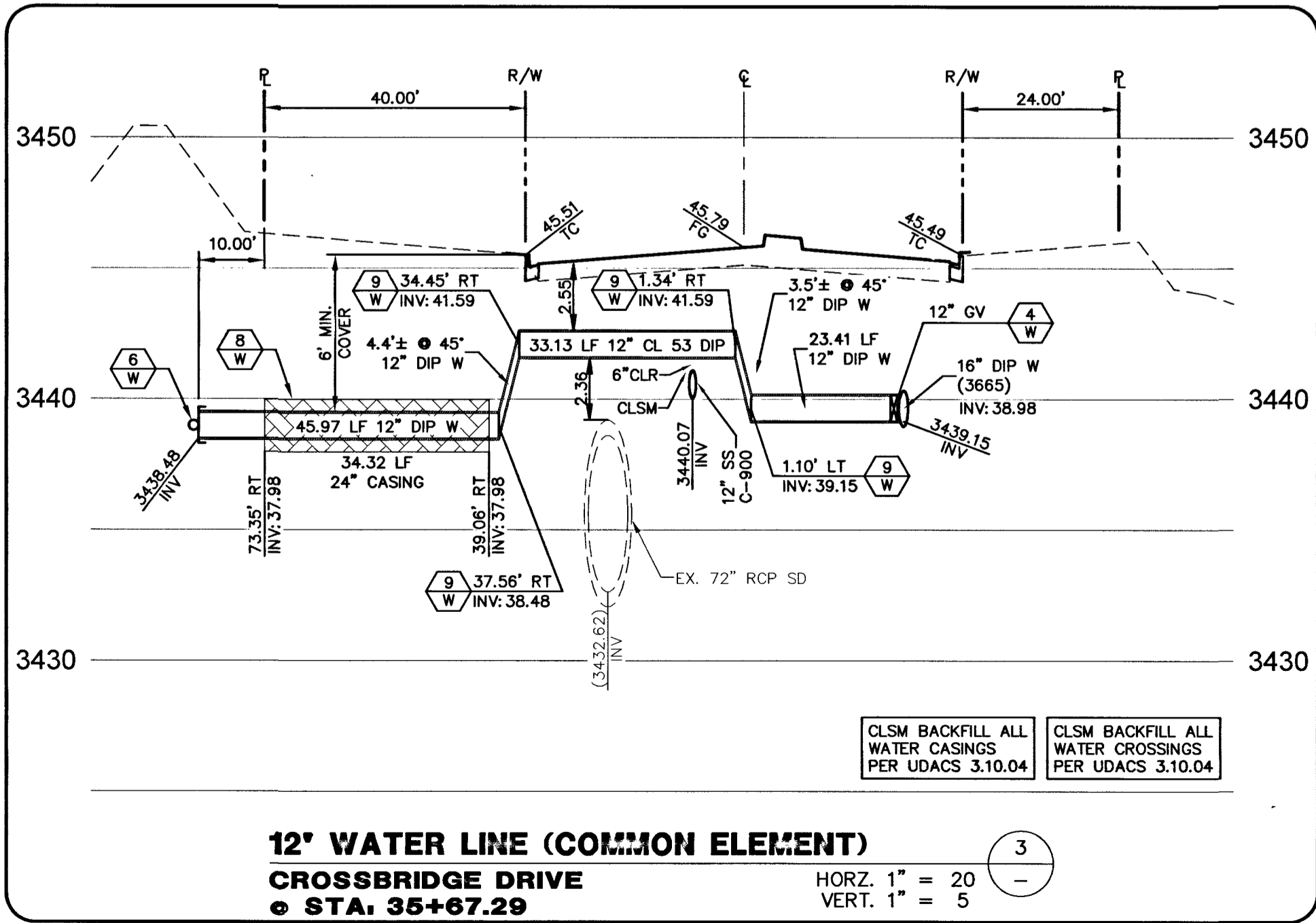
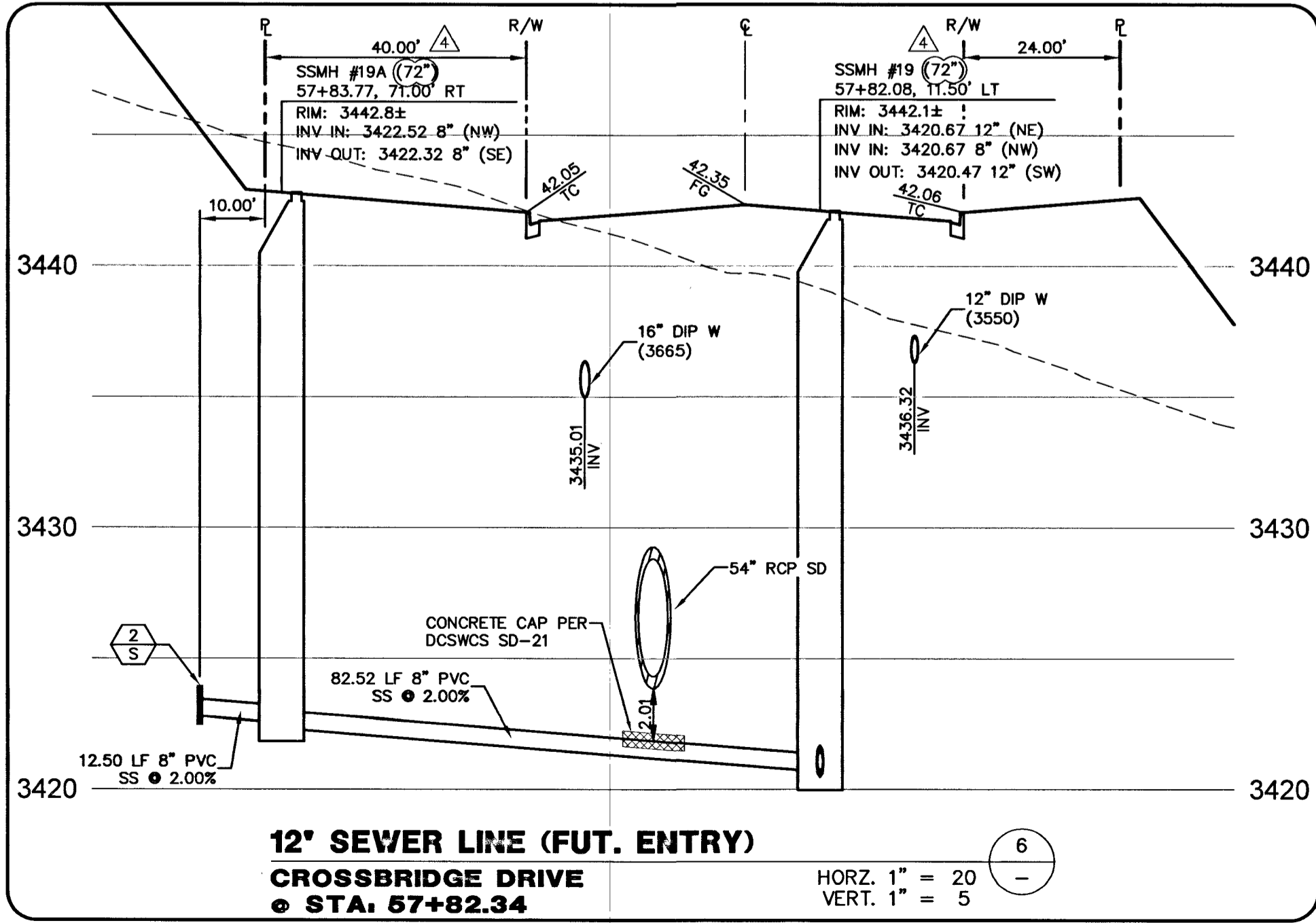
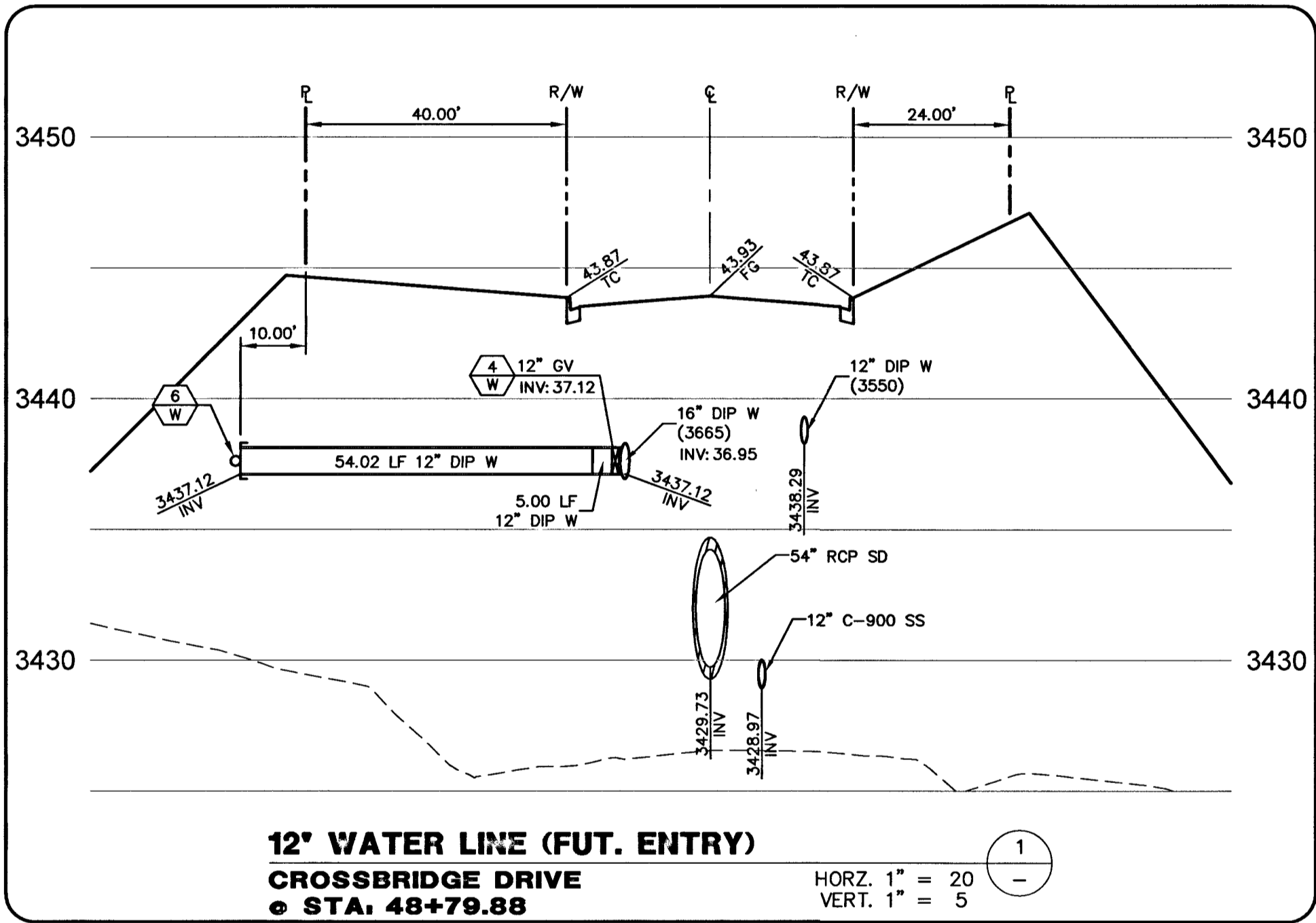

DROP INLET NOTE
 WHERE 10 FEET PARALLEL SEPARATION IS NOT PRACTICABLE:
 CAST-IN-PLACE MONOLITHIC POUR WITH WATERSTOP BETWEEN SLAB AND WALLS. BASE, WALLS AND TOP TO BE CONSTRUCTED WITH WATERSTOPS, CENTER BULB, OR FLAT STRIP (VINYLEX, GREENSTREAK PLASTIC PRODUCTS OR APPROVED EQUAL).

APPROVED FOR CONSTRUCTION 1st App'd 12/22/16
 LAS VEGAS VALLEY WATER DISTRICT ENGINEERING SERVICES MANAGER
 PROJECT NO. 123547 DATE: 9/27/16

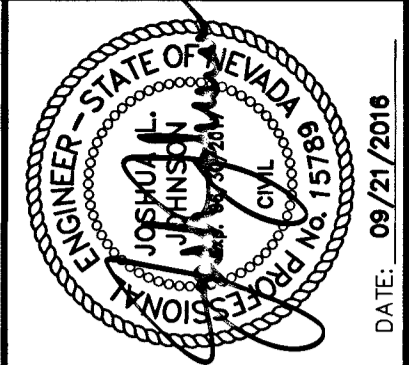

PROJECT NO.	DESIGN	DRAWN	CHECK	PLOT DATE	REV	DATE	AGN APP	DATE	GCW APP
62024-222	GCW	GCW	JLJ	09/27/16	1	09/27/16	AGN APP	09/27/16	GCW APP

G.C. WALLACE COMPANIES
 ENGINEERS | PLANNERS | SURVEYORS
 1535 S. RAINBOW BLVD. LAS VEGAS, NV 89146
 T: 702.884.2000 F: 702.884.2299 GCWALLACE.COM
 LAS VEGAS
 F:\Projects\600\62024-222\DWG\Production\24C82c39_LA13.dwg
 Lupe Garcia

THE HOWARD HUGHES COMPANY, LLC
 VILLAGE 24 - CROSSBRIDGE DRIVE UNIT 2
 IMPROVEMENT PLANS
 LATERAL DETAILS 3
 DRAWING 39
 10/16/2015
 4# 42303
 39 OF 53 SHTS
 PROJECT NO. 123547 DATE: 9/27/16
 PROJ.#: 123547 AGR#: 115478 QS:137-33-SE XC 11081
 SID NO. 812 PROJECT 9A, 9B AND 10A