

**APPROXIMATE QUANTITIES THIS SHEET**

ITEM	DESCRIPTION	CLARK COUNTY C.L.V.	CLARK COUNTY S.I.D.	TOTAL UNIT
203.00.01	ROADWAY EXCAVATION	1,131	3,797	CY.
302.00.01	TYPE 1 GRAVEL BASE	345	1,663	CY.
302.00.02	TYPE 2 GRAVEL BASE	242	682	CY.
401.00.10	A.C. PAVEMENT	249	1,403	TON
406.00.01	BITUMINOUS PRIME COAT	256	1,443	GAL.
603.03.06	ADJUST WATER VALVE		2	EA.
613.00.01	24" "L" TYPE CURB & GUTTER	912	912	L.F.
613.00.08	CONCRETE SIDEWALK	5,469	5,469	S.F.
203.00.01A	SCARIFIED & RECOMPACTED SUBGRADE	1,465	5,225	S.Y.
	ADDITIVE ITEMS			
	ADDITIVE ALTERNATE ITEMS			

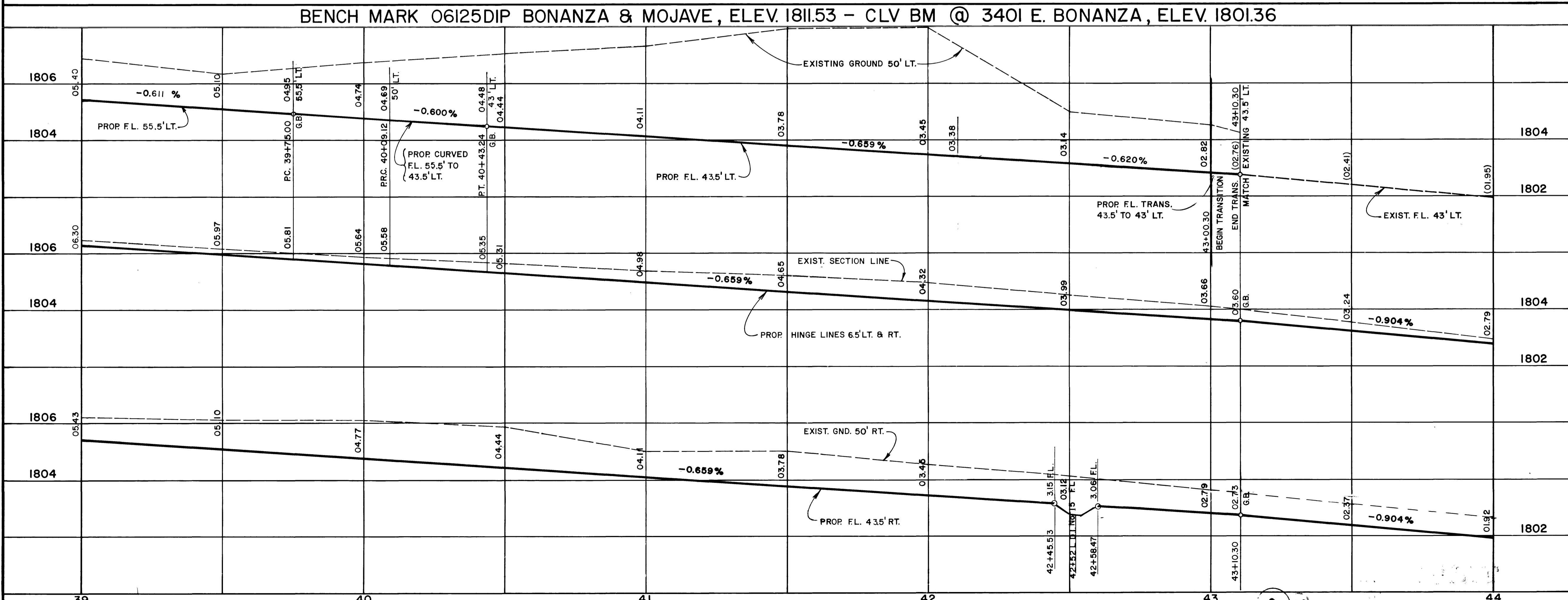

**CURVE DATA**

No.	DELTA	RADIUS	LENGTH	TANGENT	LOCATION	ITEM	DESCRIPTION	CLARK COUNTY C.L.V.	CLARK COUNTY S.I.D.	TOTAL UNIT
(1)	19° 57' 00"	9500'	33.08'	16.71'	R/W	203.00.01	ROADWAY EXCAVATION	2,666		
(2)	19° 57' 00"	10500'	36.56'	18.47'	R/W	302.00.01	TYPE 1 GRAVEL BASE	1,318		
(3)	19° 57' 00"	101.00'	35.17'	17.76'	B/C	302.00.02	TYPE 2 GRAVEL BASE	440		
(4)	19° 57' 00"	99.00'	34.47'	17.41'	B/C	401.00.10	A.C. PAVEMENT	1,154		
(5)	19° 57' 00"	99.00'	34.47'	17.41'	B/C	406.00.01	BITUMINOUS PRIME COAT	1,187		
(6)	19° 57' 00"	99.00'	34.47'	17.41'	B/C	603.03.06	ADJUST WATER VALVE	2		
(7)	19° 57' 00"	99.00'	34.47'	17.41'	B/C	613.00.01	24" "L" TYPE CURB & GUTTER	912		
(8)	19° 57' 00"	99.00'	34.47'	17.41'	B/C	613.00.08	CONCRETE SIDEWALK	5,469		
(9)	19° 57' 00"	99.00'	34.47'	17.41'	B/C	203.00.01A	SCARIFIED & RECOMPACTED SUBGRADE	3,960		

**Department of Public Services Engineering Design Division**

**BONANZA ROAD**

**EASTERN AVE. TO PECOS DRIVE**

**PLAN AND PROFILE**

Scale (h) 1" = 20'    Scale (v) 1" = 2'    W.U. no. 2118

Fid. bk. no. 78-4X    Date

Design by S. JACKSON    Drawn by S. S. NORATH    Date

Revisions

Date

City of Las Vegas

Engineering Design Division

BONANZA ROAD

EASTERN AVE. TO PECOS DRIVE

PLAN AND PROFILE

Scale (h) 1" = 20'    Scale (v) 1" = 2'    W.U. no. 2118

Fid. bk. no. 78-4X    Date

Design by S. JACKSON    Drawn by S. S. NORATH    Date

Revisions

Date

2477

194

Drawing no. 107-V849A 12/57