

EXISTING CHARLESTON RAINBOW 10-C

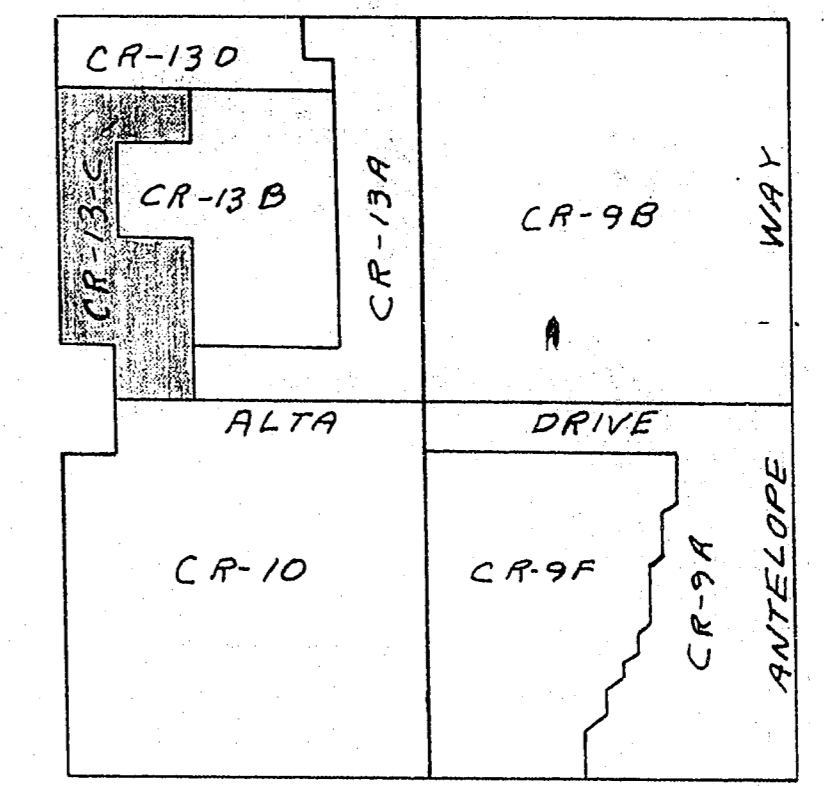
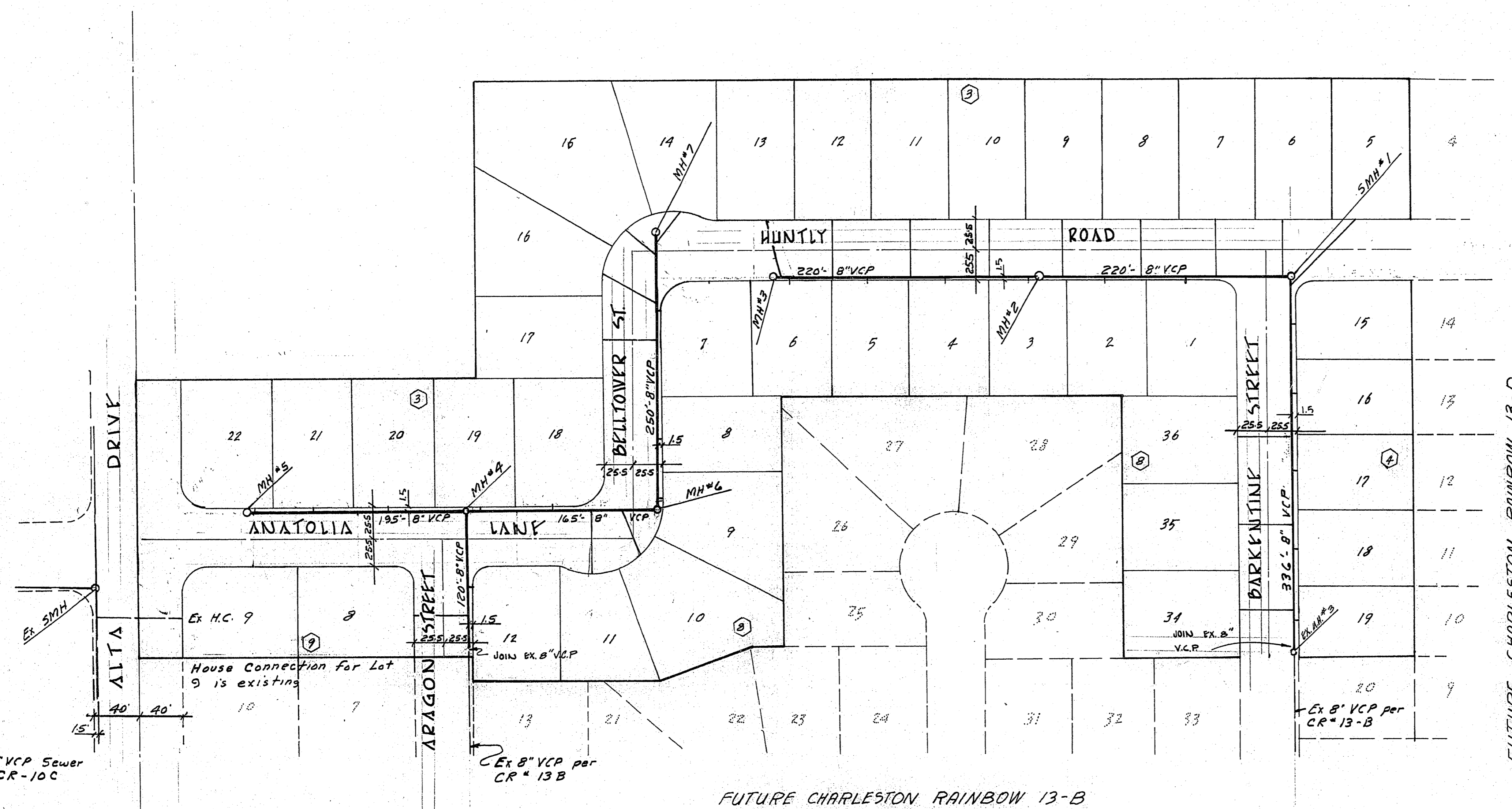

VICINITY MAP

GENERAL NOTES

1. HOUSE SERVICES SHALL COMPLY WITH WESTERN PLUMBING CODE AS THE SEPARATION DISTANCE.
2. ALL HOUSES TO BE SERVED INDIVIDUALLY AS PER SEC 515 OF THE UNIFORM PLUMBING CODE.
3. CONTRACTOR SHALL FURNISH THE ENGINEER WITH AS-BUILT DRAWING SHOWING THE EXACT LOCATION OF ALL HOUSE CONNECTIONS.

LEGEND & QUANTITY ESTIMATE

1. STANDARD SEWER MANHOLE	2 EA
2. OFFSET SEWER MANHOLE	5 EA
3. 8" VCP SEWER MAIN	1506 LF
4. 4" VCP	39 EA
5. 4" HOUSE CONNECTION LATERALS	972 LF

APPROVED BY:

[Signature] 3/1/73
 CITY SANITATION SUPT. DATE
 [Signature] 3-6-73
 MR. VEZINA CITY ENGINEER DATE
 [Signature] 2-22-73
 CITY OF LAS VEGAS FIELD ENG. DATE
 CLARK COUNTY HEALTH DEPT. DATE

SUBMITTED BY

Charles R. Johnson 12/20/72
 CHARLEY R. JOHNSON, NEV. RPE # 3005 DATE

CONSULTING ENGINEERS & PLANNERS
 2200 PARKER ROAD, LAS VEGAS, NEVADA 89102
 CHARLESTON RAINBOW 13-C
 MASTER SEWER PLAN

SCALE:	WO NO 1066-13C	DATE 12/20/72	SHEET 5	OF 9
HORIZ. 1"=60'	DES.	REV.		
VERT.	CHK.	REV.		