

11-7-19

CITY OF LAS VEGAS ENGINEERING DEPT.

Approval of this plan by the City of Las Vegas, Nevada,
does not relieve the Subdivider of responsibility for errors
in calculation, design, or planning by the Subdivider's
Engineer or Surveyor.

REVISED 4-16-36
BY KCH

APP BY B. W. W. CHECKED BY J. E. S.
J. E. STANBACH
Office Engineer

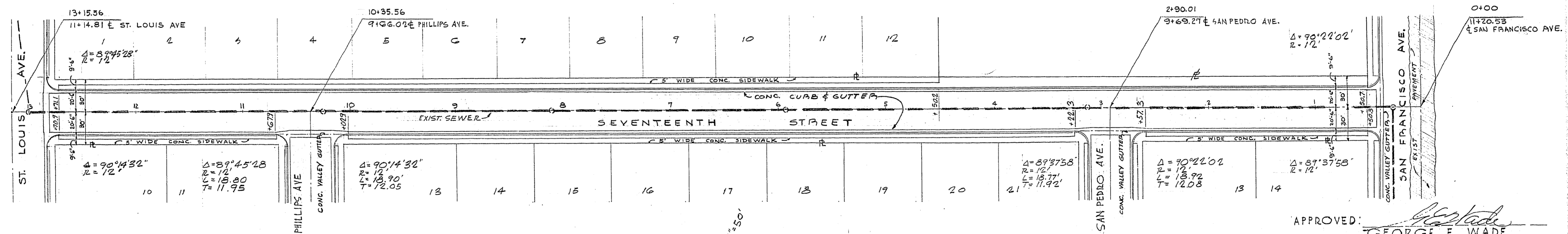

APPROVED: G. E. Wade
GEORGE E WADE
CITY ENGINEER OF LAS VEGAS

DATE: _____

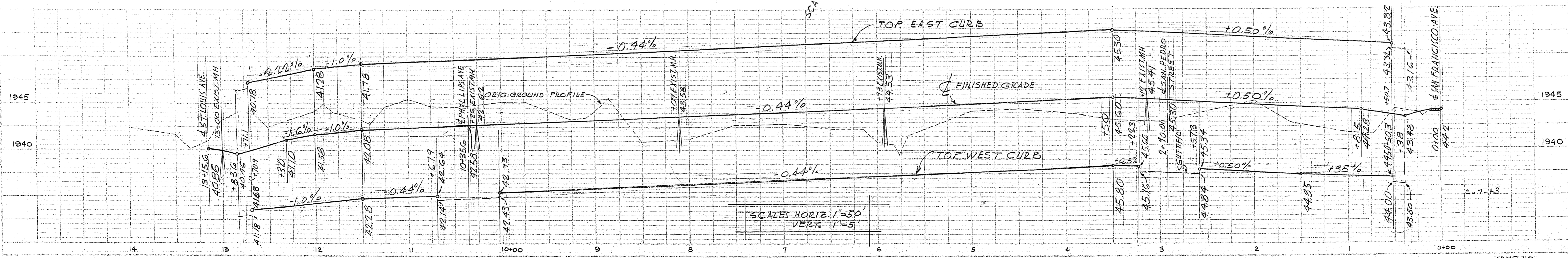

PLATE OF PLAN-PROFILE, F.A.L.
GEORGE E. WADE & CO., INC.
LAS VEGAS, NEV.

FRANCISCO PARK NO. 2 SEVENTEENTH STREET

DRWG. NO.
OF 5

207Y-7440-2