

- LEGEND**
- STREET CENTERLINE
 - PROPERTY LINE
 - LOT LINE
 - ⊙ LOT NUMBER
 - ⊙# PAD ELEVATION
 - EXIST. CONTOUR
 - BUILDING SETBACK LINE
 - CONCRETE
 - SWALE @ 1% MIN.
 - CONCRETE BLOCK WALL
 - ⊙ FINISH CONTOUR

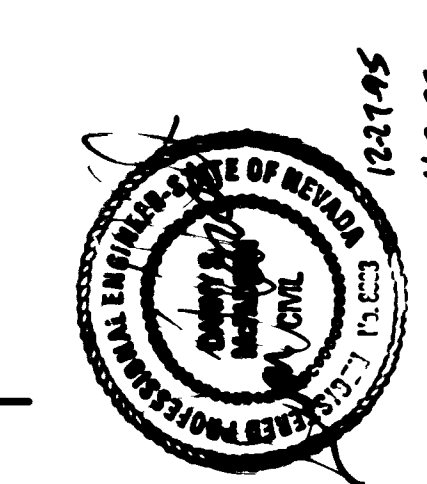

NOTE:
 REFER TO GEOTECHNICAL INVESTIGATION
 NWC LONE MOUNTAIN ROAD AND CIMARRON
 ROAD - LAS VEGAS, NEVADA
 FILE NO.: C855-G159
 SEPTEMBER 29, 1994 BY GEOTECHNICAL
 & ENVIRONMENTAL SERVICES, INC.
 FOR SITE PREPARATION AND PAVEMENT
 THICKNESS.

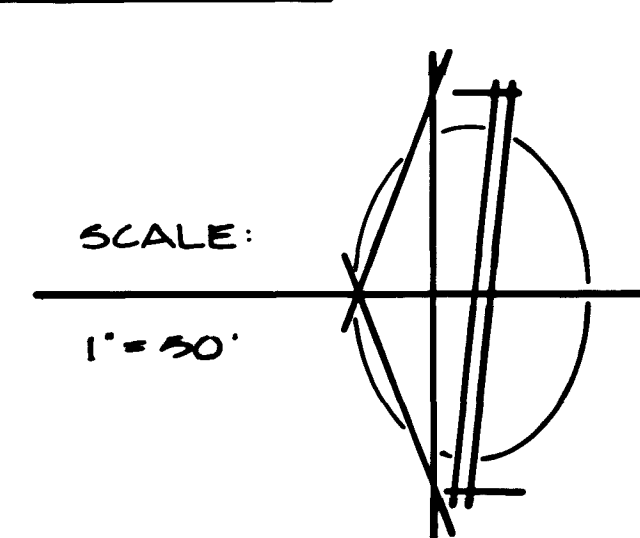
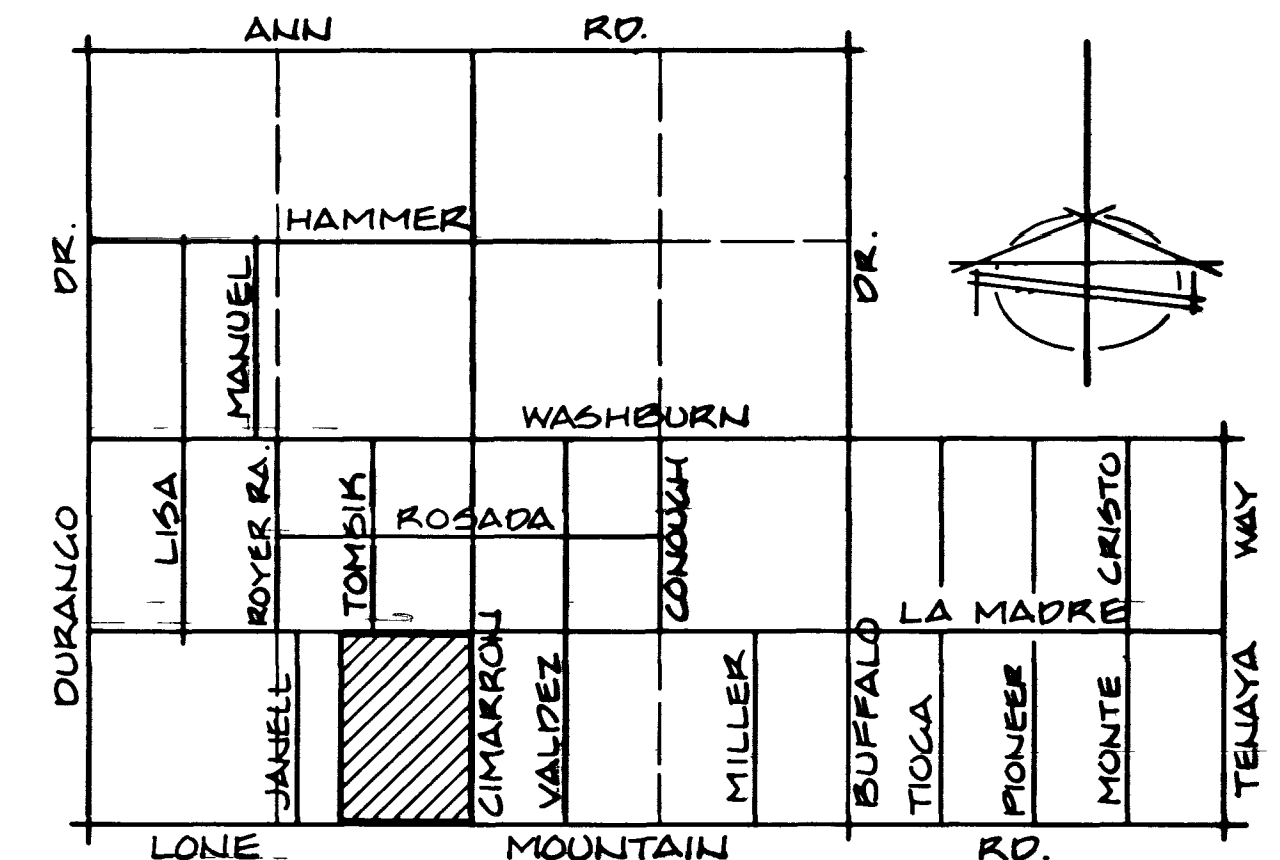

SEE SHEET C-2

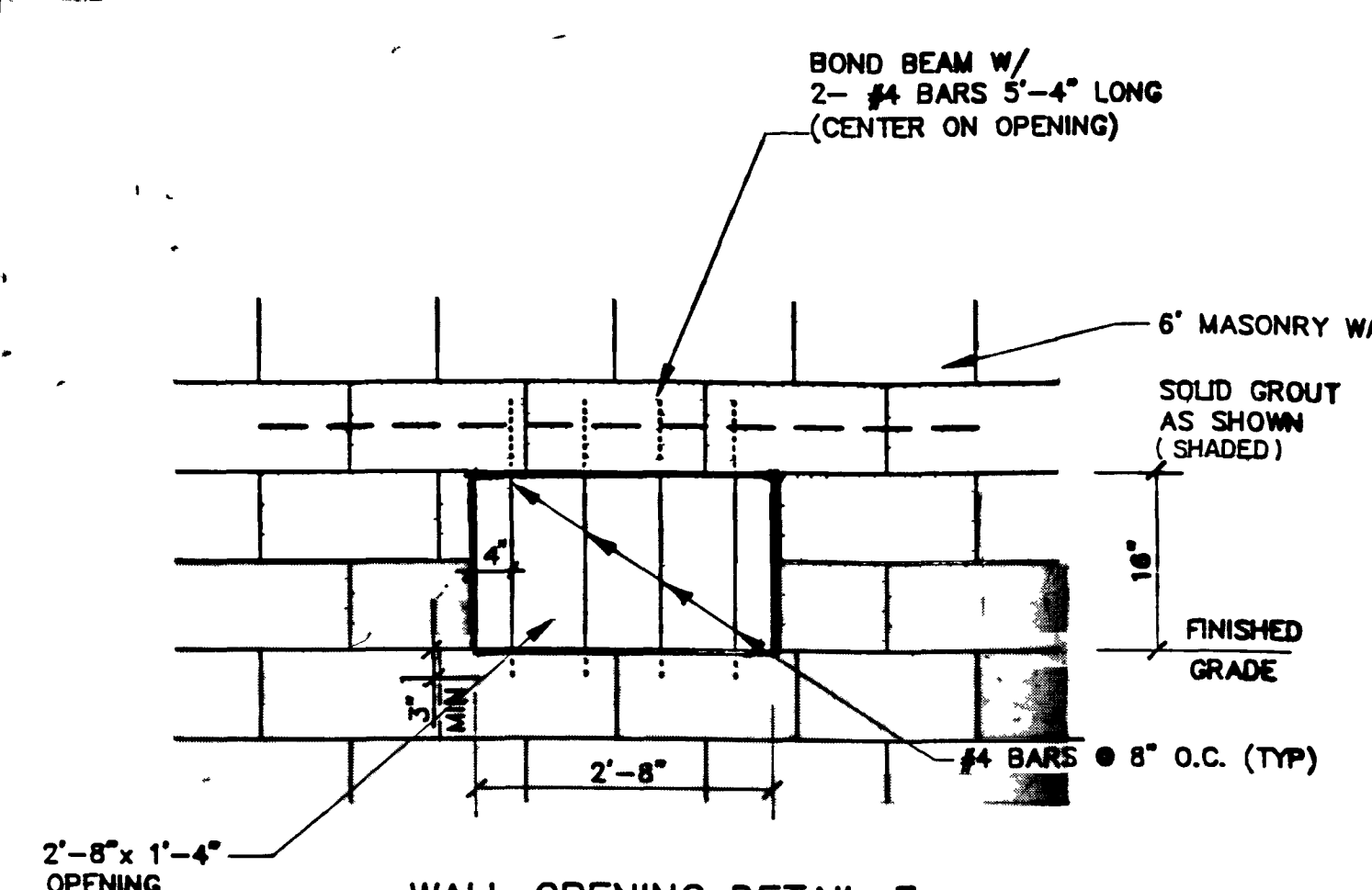

WALL OPENING-DETAIL 3
NO SCALE

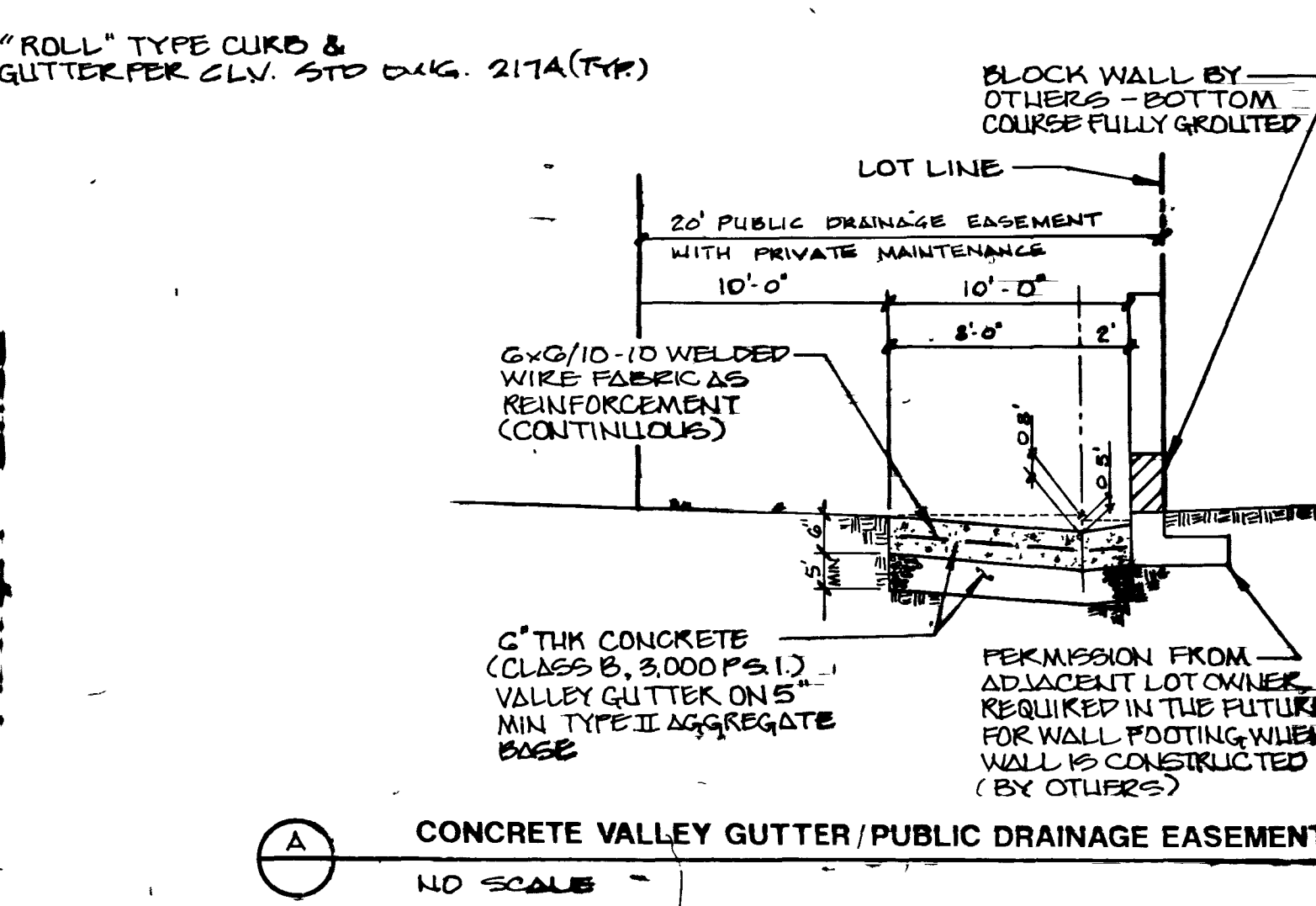

CONCRETE VALLEY GUTTER/PUBLIC DRAINAGE EASEMENT
NO SCALE

BENCH MARK

B.M. No. C0004A2 - Railroad spike in power pole at Southeast Quad. of Lone Mountain Road and Cimarron Road.
 Elev. = 2371.77 C.C.E.D. Datum (N&VD 29)

ELEVATION EQUATION:
 All plan elevations + 1.68' = NAVD 88 Datum

GENERAL NOTES

- CLARK COUNTY GENERAL NOTES:**
- ALL WORK DONE WITHIN THE PUBLIC RIGHT-OF-WAY AND OUTSIDE THE PROJECT BOUNDARIES REQUIRES A SEPARATE ENCROACHMENT PERMIT ISSUED BY THE CLARK COUNTY DEPARTMENT OF PUBLIC WORKS. TRENCH AND PAVEMENT REPLACEMENT CONDITIONS SHALL BE AS PER THE PERMIT.
 - EXACT LOCATION OF ALL SAWCUT LINES SHALL BE DETERMINED IN THE FIELD BY A CLARK COUNTY INSPECTOR.
 - WHEELCHAIR RAMPS SHALL BE CONSTRUCTED IN EACH QUADRANT OF AN INTERSECTION PER STANDARD DRAWING NO. 235. EXACT LOCATION OF RAMPS SHALL BE DETERMINED IN THE FIELD BY A CLARK COUNTY INSPECTOR.
 - CURBS AND GUTTER WITH A GRADE OF LESS THAN FOUR TENTHS OF ONE PERCENT SHALL BE CONSTRUCTED BY FORMING. EACH JOINT SHALL BE CHECKED FOR GRADE PRIOR TO CONSTRUCTION AND WATER TESTED AS SOON AS POSSIBLE AFTER CONSTRUCTION.
 - ALL OFF-SITE IMPROVEMENT CONSTRUCTION SHALL CONFORM TO THE UNIFORM STANDARD SPECIFICATIONS AND IMPROVEMENT DRAWINGS, LATEST REVISION.
 - FINAL ASPHALTIC CONCRETE (AC) PAVEMENT SURFACES SHALL BE ONE-HALF INCH ABOVE THE TOP OF THE GUTTER (INCLUDING OPEN GRADE).
 - PRIVATE STREETS AND/OR DRIVEWAYS REFLECTED ON THESE PLANS ARE TO BE INSPECTED BY A CLARK COUNTY INSPECTOR.

CLARK COUNTY DEPARTMENT OF PUBLIC WORKS
 BY: [Signature] DATE: 02/15/95
 I HEREBY CERTIFY THAT THESE PLANS FOR FILING SHALL NOT BE CONSIDERED A PERMIT FOR OR AN APPROVAL OF ANY OF THE PROVISIONS OF THE CLARK COUNTY LAND AND/OR SUBDIVISIONS. CLARK COUNTY SHALL BE HELD HARMLESS FROM ANY DAMAGES TO THE PROPERTY OF ANY ENGINEERING DESIGNER OR ARCHITECT FOR ANY CONSTRUCTION OF THE PROJECT OR FOR ANY DAMAGE TO PROPERTY OR OTHER DAMAGES CAUSED BY ANY CONSTRUCTION BASED ON THESE PLANS. THE ENGINEER OR ARCHITECT WILL BE RESPONSIBLE TO THE CLIENT TO CLARK COUNTY.

I CERTIFY THAT THIS GRADING PLAN CONFORMS TO THE APPROVED DRAINAGE STUDY ON FILE WITH CLV FLOOD CONTROL.

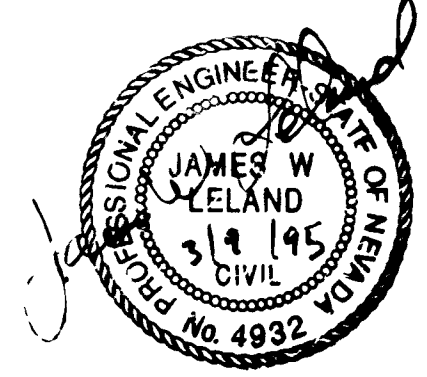

DATE: 02/15/95
 REVISIONS: [None]
 PREPARED FOR: THE DEVELOPERS OF NEVADA
 DATE: [None]
 DESIGN: R. E. T.
 CHECK: R. E. T.
 SCALE: 1" = 50'
 PROJECT: 330093.1071-446
 SHEET: 23 OF 23
 PROJ. NO. 4331

