

Standard Plates, Drawings, and Specifications, latest edition.

Material shall be used throughout the project unless otherwise approved by the LVVWD.

Water boxes shall be located outside of driveway areas.

Requirements must be met in the event a water line and sanitary or storm sewer line

Minimum eighteen (18) inch vertical separation (outside to outside) must be maintained

Sanitary or storm sewer line must be placed adjacent to the sanitary or storm sewer line.

Sanitary or storm sewer line must be constructed with one of the following or, as shown

Potable water supply quality material.

Encasement, with four (4) inch concrete (minimum)

Steeving with potable water supply quality pipe.

Provision must extend along the sanitary or storm sewer, on either side of the main, a

minimum 10 foot distance perpendicular to the water main exterior.

Working type shall be required over all mains, all six (6) inch diameter and larger service laterals, and

any service lateral not installed perpendicular to the main in accordance with Standard Plate No. 27.

All site facilities shall be filled, disinfected, pressure tested, flushed, lifted and an acceptable water

sample obtained, prior to connection to the LVVWD's distribution system.

The contractor must obtain all meters two (2) inches and smaller from LVVWD Central Stores

Telephone 258-3152 forty-eight (48) hours prior to pickup.

Contractor may interrupt service, with LVVWD approval and proper notification, between the hours

of 8 AM, Sunday through Thursday. Circumstances may require temporary service feeds

without LVVWD reimbursement. Any temporary service feed must have prior LVVWD

approval. Facility construction materials used must be as listed on the LVVWD's Pre-Approved

Materials and Manufacturers Listing for New Facilities, latest revision, or specifically approved on

plans.

- FIRE DEPARTMENT "HYDRANT SPECIFICATIONS", "HYDRANT INSTALLATION SPECIFICATIONS" AND ORDINANCE #3677.
- AUTHORIZED HYDRANTS FOR THIS PROJECT ARE:
 - KENNEDY GUARDIAN
 - MUELLER A-423 CENTURION
 - CLOW MODEL 2344 MEDALLION
- ON ANY NEW HOME OR BUILDING INSTALLATION, ACCESSIBLE FIRE HYDRANTS SHALL BE INSTALLED BEFORE COMBUSTIBLE CONSTRUCTION COMMENCES AND SAID FIRE HYDRANTS SHALL BE IN GOOD WORKING ORDER WITH AN ADEQUATE WATER SUPPLY. CONTRACTOR SHALL PLACE A BLUE REFLECTIVE MARKER AT CENTERLINE OF STREET ADJACENT TO FIRE HYDRANT AS REQUIRED IN ORDINANCE #3677 TO IDENTIFY FIRE HYDRANT LOCATIONS.
- CALL THE LAS VEGAS BUILDING DEPARTMENT AT 229-2071 FOR UNDERGROUND INSPECTION, PRESSURE AND FLUSH VERIFICATION OF ALL FIRE HYDRANTS AND FIRE LINES BEFORE COVERING.
- PAINTING OF THE CURBS AND HYDRANT AND ANY WORK NECESSARY FOR PROTECTION OF HYDRANTS FROM PHYSICAL DAMAGE, PER ORDINANCE #3677, SHALL BE COMPLETED BEFORE APPROVAL BY THE CITY OF LAS VEGAS FIRE DEPARTMENT. A PERMIT IS REQUIRED FROM THE FIRE DEPARTMENT FOR ON-SITE WATER LINE AND FIRE HYDRANT. THE PERMIT AND CONTRACTOR'S MATERIAL AND TEST CERTIFICATE FOR UNDERGROUND PIPING SHALL BE OBTAINED FROM THE FIRE PROTECTION ENGINEER PRIOR TO ANY WORK BEGINNING.
- A FLOW TEST MUST BE WITNESSED BY THE FIRE DEPARTMENT PRIOR TO OCCUPANCY FOR VERIFICATION OF REQUIRED ON-SITE WATER SUPPLY.
- ALL ON-SITE FIRE MAIN MATERIALS MUST BE U.L. LISTED AND F.M. APPROVED.
- FIRE HYDRANT SPACING:
 - RESIDENTIAL - 500 FEET UNSPRINKLERED, 800 FEET SPRINKLERED COMMERCIAL, INCLUDING MULTI-FAMILY - 300 FEET UNSPRINKLERED, 400 FEET SPRINKLERED.
 - NO FIRE HYDRANT SHALL BE LOCATED WITHIN THE REQUIRED RADIUS OF A CUL-DE-SAC OR WITHIN 20 FEET OF THE PERIMETER OF THE RADIUS OF THE CUL-DE-SAC.
 - NO FIRE HYDRANT SHALL BE LOCATED WITHIN 6 FEET OF ANY CURB RETURN, DRIVEWAY, POWER POLE, STREET LIGHT OR ANY OTHER OBSTRUCTION.
 - NOT MORE THAN 2 HYDRANTS CAN BE OUT OF SERVICE DUE TO A SINGLE MAIN BREAK.
 - A FIRE APPARATUS ROAD SHALL BE REQUIRED WHEN ANY PORTION OF AN EXTERIOR WALL OF THE FIRST STORY IS LOCATED MORE THAN 150 FEET FROM A FIRE DEPARTMENT VEHICLE ACCESS (SEE EXCEPTIONS IN UFC 88, SECTION 10.207).
 - ALL DEAD END FIRE APPARATUS ACCESS ROADS AND/OR FIRE LANES, PUBLIC OR PRIVATE, IN EXCESS OF 150 FEET IN LENGTH SHALL BE PROVIDED WITH AN APPROVED TURN AROUND AREA. SEE ORDINANCE #3677.

STREET LIGHTING INSTALLATION EXCEPT AS NOTED ON THE STREET LIGHTING PLANS SHALL CONFORM TO THE IMPROVEMENT STANDARDS, DEPARTMENT OF PUBLIC WORKS, CLARK COUNTY, NEVADA, AND THE UNIFORM STANDARD SPECIFICATIONS FOR PUBLIC WORKS CONSTRUCTION, OFF-SITE IMPROVEMENTS, CLARK COUNTY AREA, NEVADA.

ALL POLES TO BE GALVANIZED.

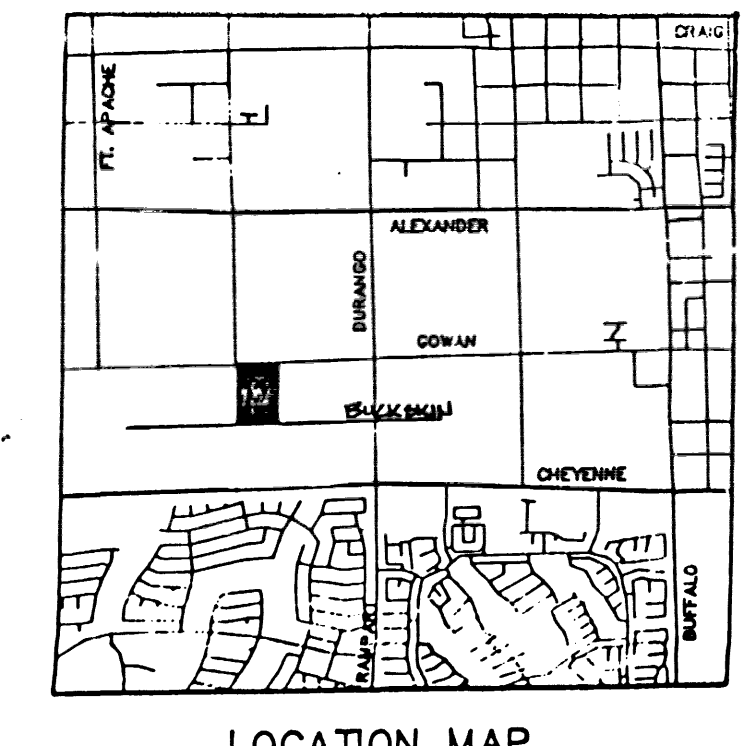
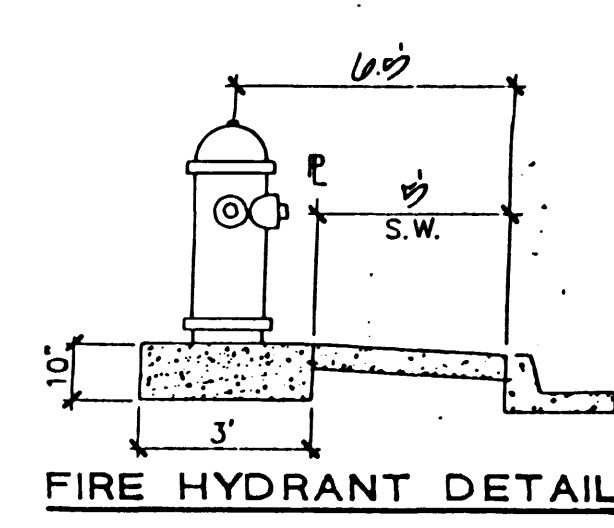
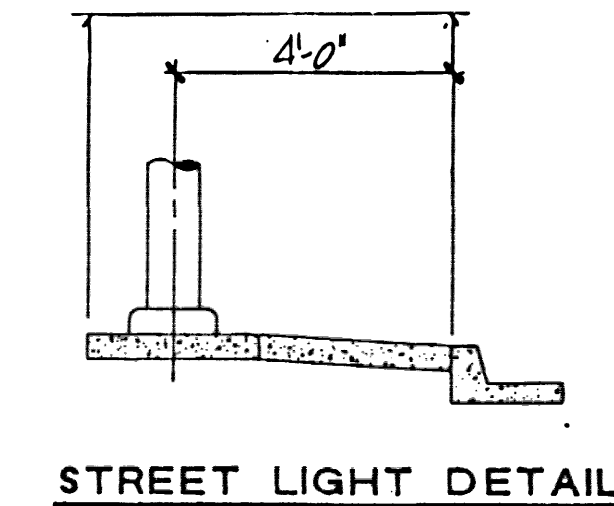

STREET LIGHT NOTE

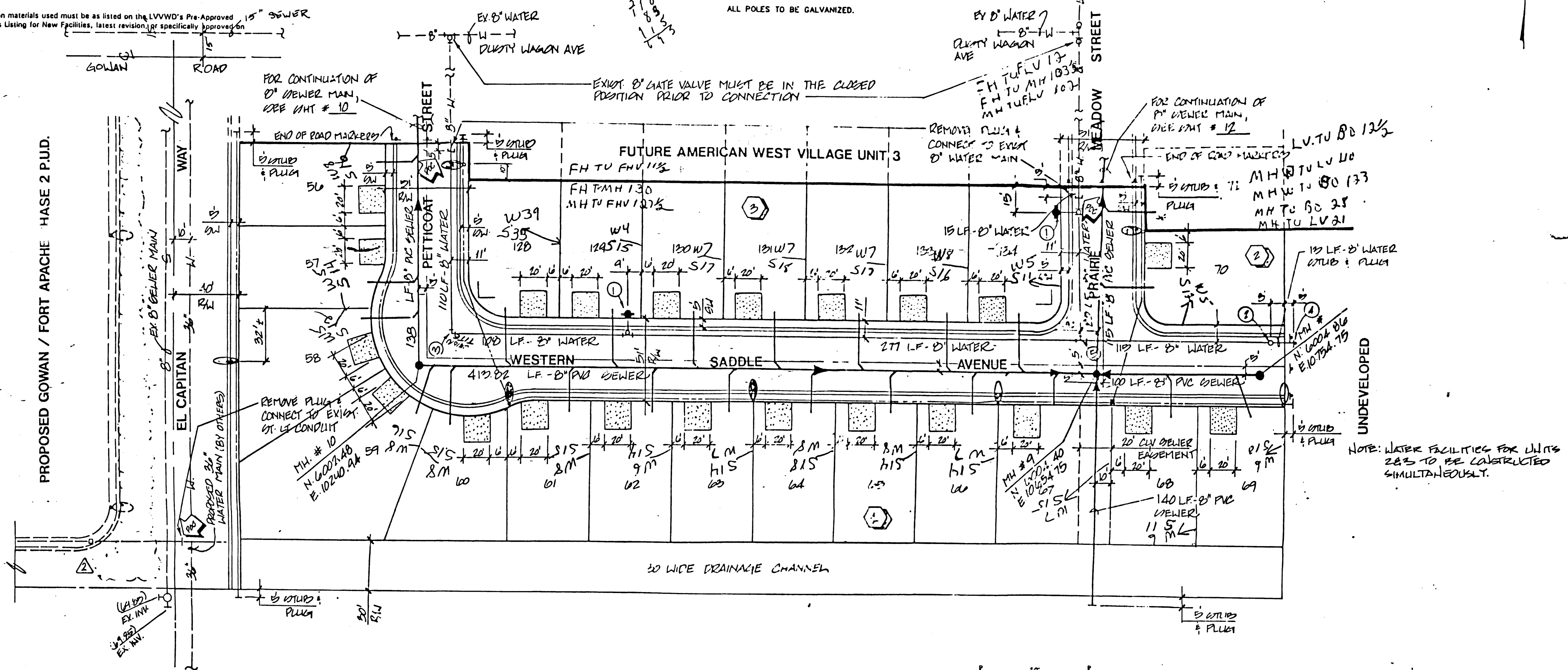

ESTIMATE OF QUANTITIES

WATER	
1) FIRE HYDRANT ACCESS	2 EA.
2) GATE VALVE	1 EA.
3) 8" 90° BEND	2 EA.
4) 8" TEE	1 EA.
5) 3/4" WATER SERVICE W/ 10' METER	22 EA.
6) 8" WATER MAIN	1004 LF.
SEWER	
7) 8" MANHOLE	2 EA.
8) 8" SEWER MAIN	900 LF.
9) 4" SEWER LATERALS	734 LF.
10) WYBES	23 EA.
11) 1/2" CONDUIT	685 LF.
12) 2 1/2" PULL BOX	2 EA.
STREETLIGHTS	
13) 200 WATT LUMIN.	1 EA.
14) 100 WATT LUMIN.	6 EA.
15) 1 1/2" CONDUIT	685 LF.
16) 2 1/2" PULL BOX	2 EA.
17) STOP SIGN	2 EA.
18) STREET NAME SIGN	2 EA.

LAS VEGAS FIRE DEPARTMENT

FIRE FLOW REQUIREMENT IS 1500 GALLONS/MIN. AT 20 LBS./SQ.IN. RESIDUAL.

BASED ON:

SQUARE FOOTAGE:

LARGEST AREA BETWEEN SEPERATION WALLS:

HEIGHT:

TYPE OF CONSTRUCTION:

EXPOSURES:

SPRINKLER SYSTEM:

OCCUPANCY:

ROOF CONSTRUCTION:

REVIEWED BY:

DATE:

PROVIDE FIRE LANE IDENTIFICATION PER CITY ORD. 3677

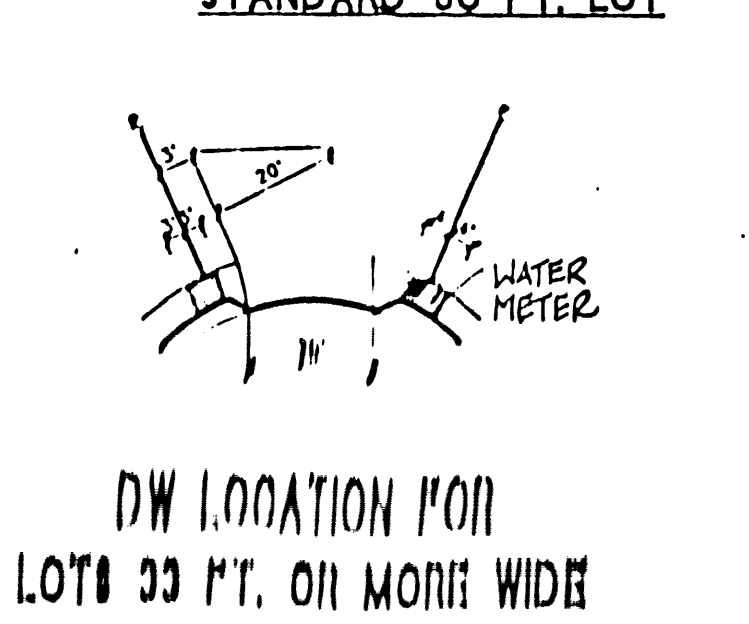
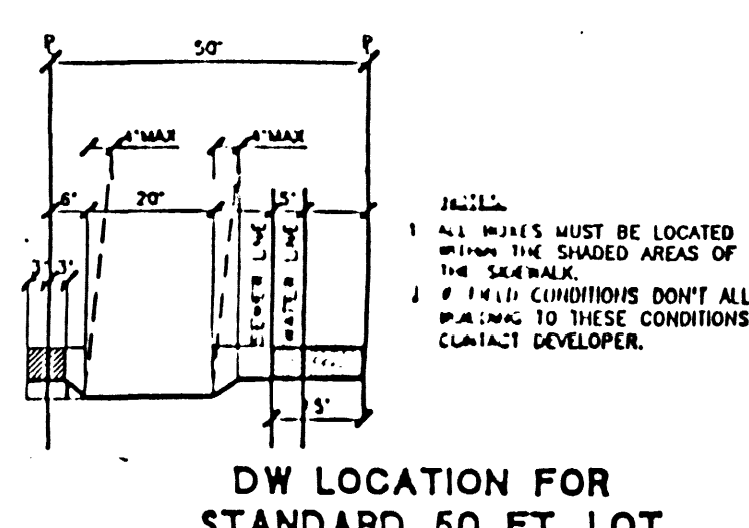

SEWER CONTRIBUTION

AVERAGE = 5,500 G.P.D.

PEAK = 8,000 G.P.D.

NOTE: 10' MIN. CLEARANCE BETWEEN WATER & SEWER OTHERWISE CONC.

NOTE: THIS UNIT WILL ONLY BE VALID IF THE WATER FACILITIES TO UNITS 1-6 ARE CONSTRUCTED SIMULTANEOUSLY. (SADDLEPACK EAST)

APPROVAL:

[Signature] 10/09/98
LAS VEGAS VALLEY WATER DISTRICT DATE

[Signature] 2/2/99
CITY OF LAS VEGAS FIRE MARSHALL DATE

PRINTED

DATE

NO. 4400-1

DATE

SHEET 9 OF 13 SHEETS

11-14-139

AMERICAN WEST HOMES, INC. CONSULTING ENGINEER

AMERICAN WEST VILLAGE UNIT 2

MASTER UTILITY PLAN

AS BUILT

AMERICAN WEST VILLAGE UNIT 2

NO. 4400-1

DATE

SHEET 9 OF 13 SHEETS

11-14-139

PLACEMENT AND CLEARANCE OF STREET LIGHT AND SIGNAL LIGHT INSTALLATION

Call before you dig

800-227-6600

23047