

SW RAMP DATA

NO	"A"	"B"
1	6'-0"	8'-0"
2	4'-6"	5'-0"

CURVE	RADIUS	LENGTH	TANGENT	DELTA
C1	27.00'	42.41'	27.00'	90°00'00"
C2	27.00'	42.41'	27.00'	90°00'00"
C3	2.50'	3.92'	2.50'	89°53'55"
C4	15.00'	23.59'	15.03'	90°06'05"
C5	15.00'	23.56'	15.00'	90°00'00"
C6	15.00'	23.56'	15.00'	90°00'00"
C7	15.00'	23.59'	15.03'	90°06'05"
C8	2.50'	3.92'	2.50'	89°53'55"
C9	25.00'	39.35'	25.08'	90°10'22"
C10	7.50'	11.76'	7.48'	89°49'38"
C11	2.50'	3.93'	2.50'	90°00'00"
C12	2.50'	3.93'	2.50'	90°00'00"
C13	7.50'	11.76'	7.48'	89°49'38"
C14	25.00'	39.35'	25.08'	90°10'22"
C15	25.00'	39.19'	24.92'	89°49'38"
C16	2.50'	3.93'	2.51'	90°10'22"
C17	2.50'	5.85'	6.23'	136°18'19"
C18	2.50'	1.91'	1.07'	43°43'41"
C19	2.50'	2.02'	1.07'	46°16'19"
C20	2.50'	5.83'	5.85'	133°43'41"
C21	2.50'	5.83'	5.85'	133°43'41"
C22	2.50'	2.02'	1.07'	46°16'19"
C23	2.50'	1.91'	1.00'	43°43'41"
C24	2.50'	5.85'	6.23'	136°18'19"
C25	2.50'	3.93'	2.51'	90°10'22"
C26	25.00'	39.19'	24.92'	89°49'38"

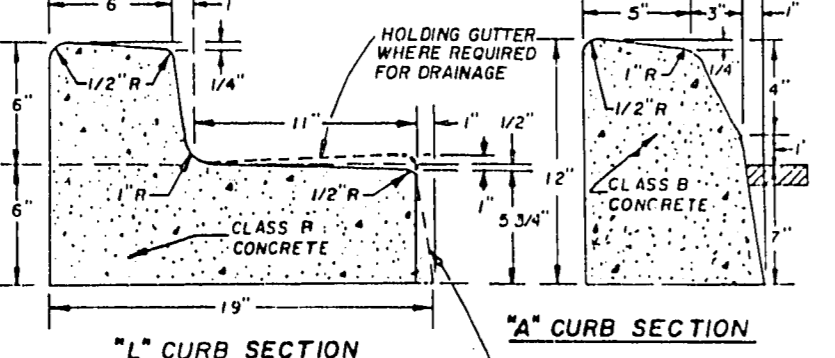

UNIFORM STANDARD DRAWINGS
CLARK COUNTY AREA
CONCRETE CURB
PAGE NO. 25

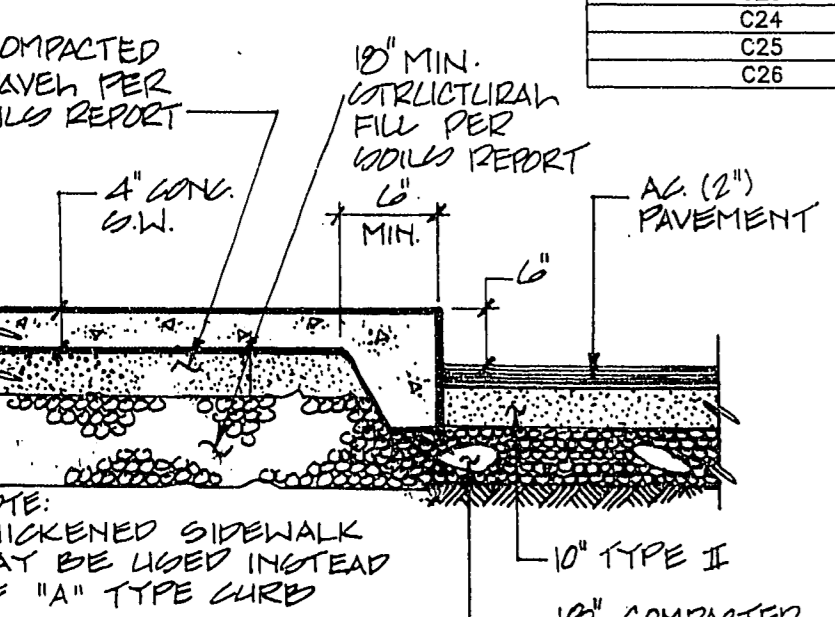

THICKENED SIDEWALK
N.T.S.

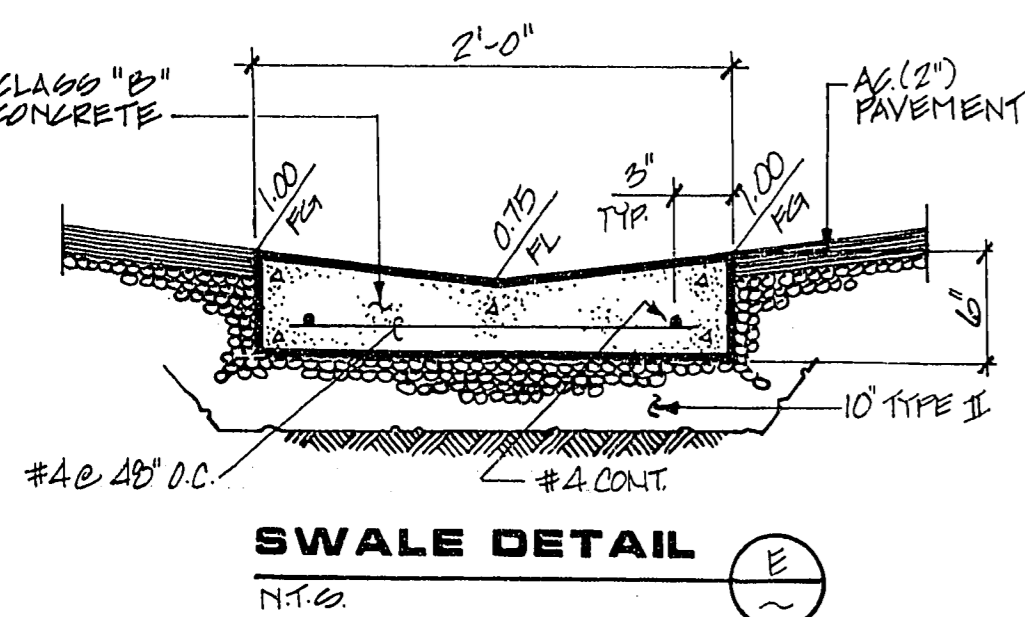

SWALE DETAIL
N.T.S.

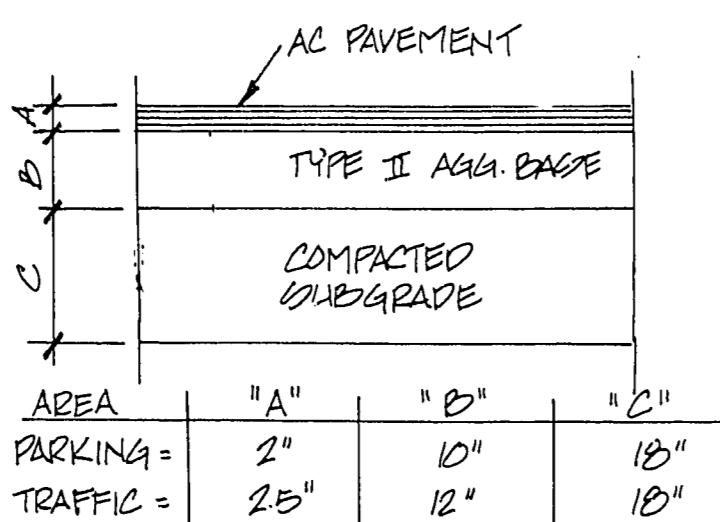

TYPICAL PAVEMENT SECTION (ON-SITE)
SEE WALK REPORT BY
CONVERSE CONSULTANTS SOUTHWEST, INC.

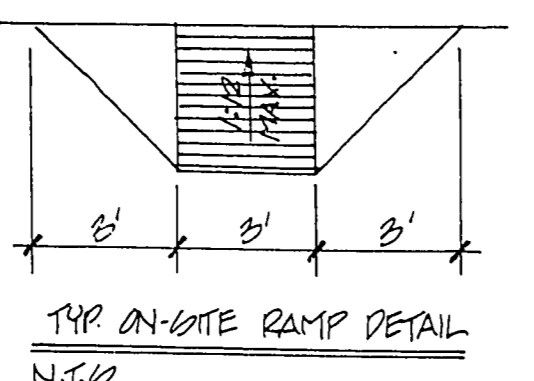

TYP. ON-SITE RAMP DETAIL
N.T.S.

BENCHMARK
BM-CLV2101-33CA RIVET AND PLATE
IN TOP OF CURB, SOUTHWEST RETURN,
ALTA DRIVE AND MARTIN LUTHER
KING BOULEVARD
ELEV. = 2044.276

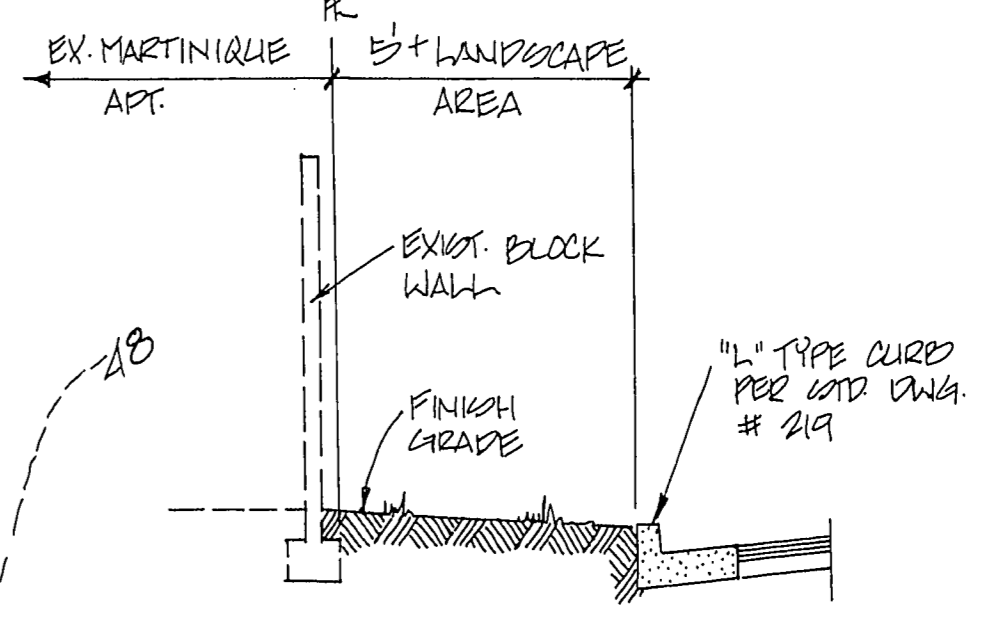
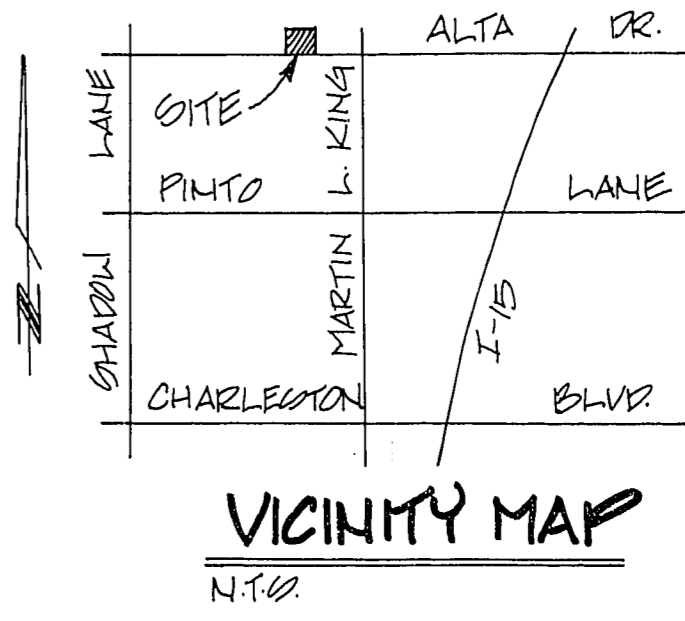
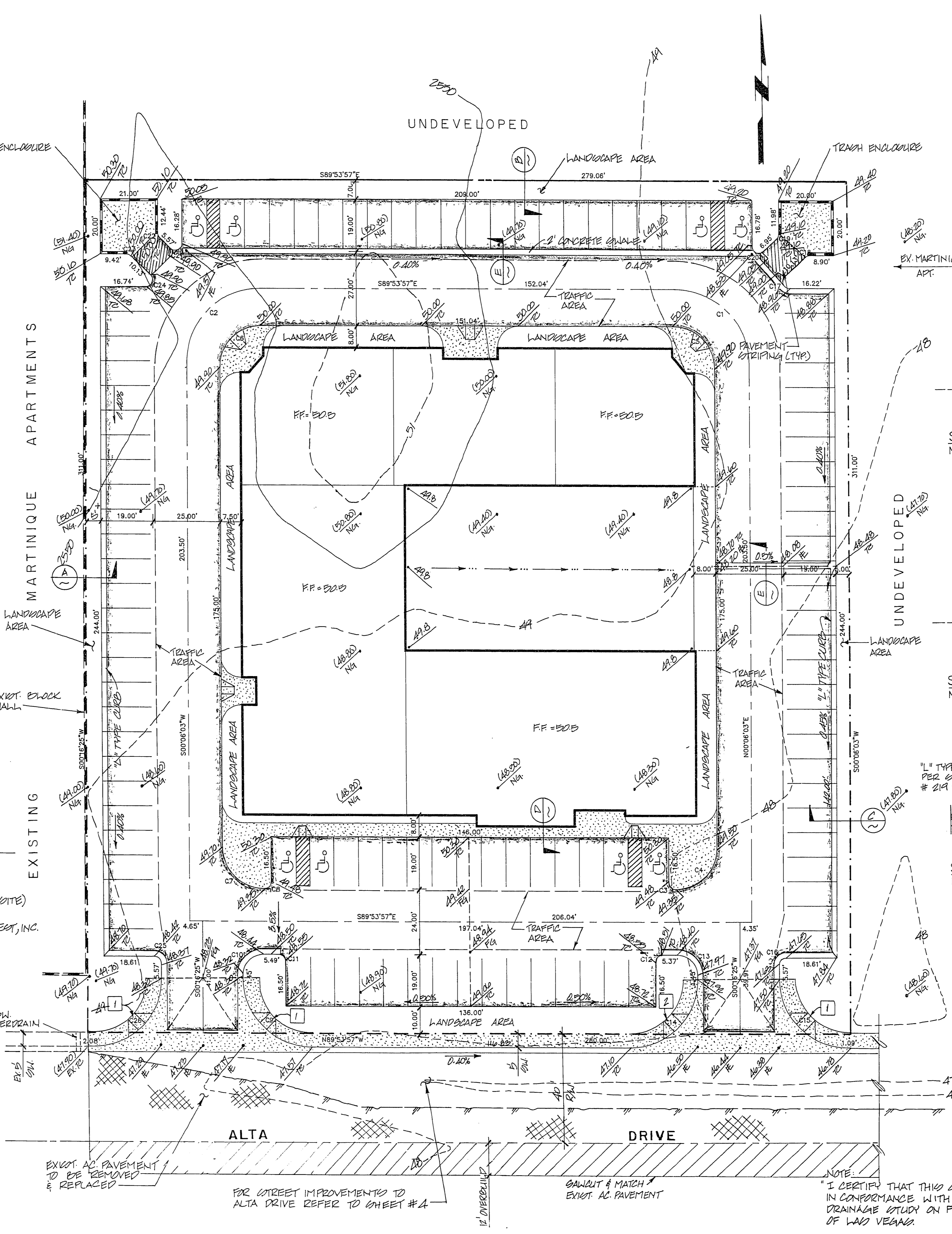

SECTION A
N.T.S.

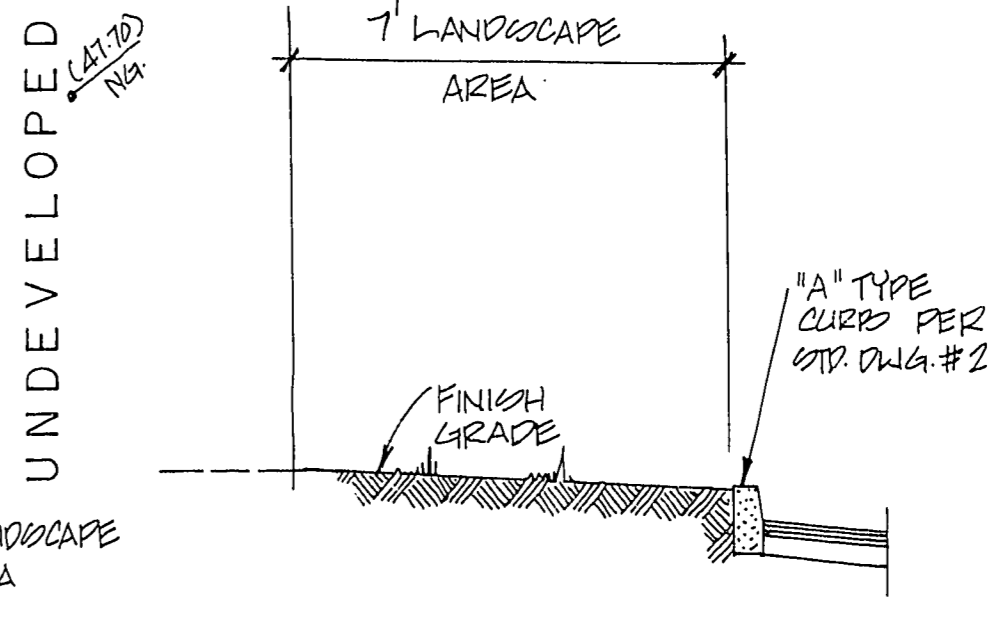

SECTION B
N.T.S.

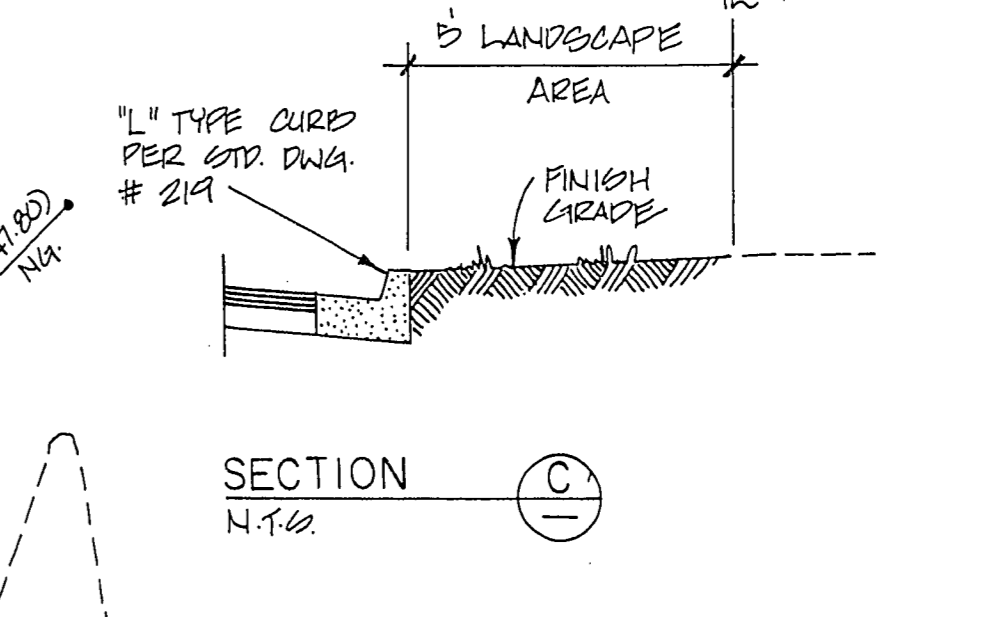

SECTION C
N.T.S.

REVISION

NO.	DATE	BY	REVISION
1	12/15/93	CT, WLR	REVISED

DATE: 12/15/93
BY: CT, WLR

RIBEIRO CORPORATION
CITY OF LAS VEGAS, NEVADA

CONSULTING ENGINEERS • PLANNERS • LAND SURVEYORS
2727 SOUTH RAINBOW BOULEVARD
LAS VEGAS, NEVADA 89102-5148 PHONE (702) 873-7550 FAX (702) 362-2597

nevada

FINISH GRADING PLAN

PROJECT: **ALTA QUAIL PARK**

TITLE: _____

PROJ. NO.: 4480

DATE: 12/15/93

SCALE: 1"=20'

SHEET: **2** OF 5 SHEETS

107Y-4306

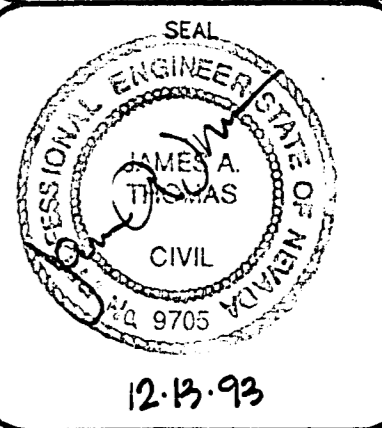

NOTE: I CERTIFY THAT THIS GRADING PLAN IS IN CONFORMANCE WITH THE APPROVED DRAINAGE STUDY ON FILE AT THE CITY OF LAS VEGAS.

11-10-77