

SEE SHEET ST4
DEER SPRINGS (PUBLIC)

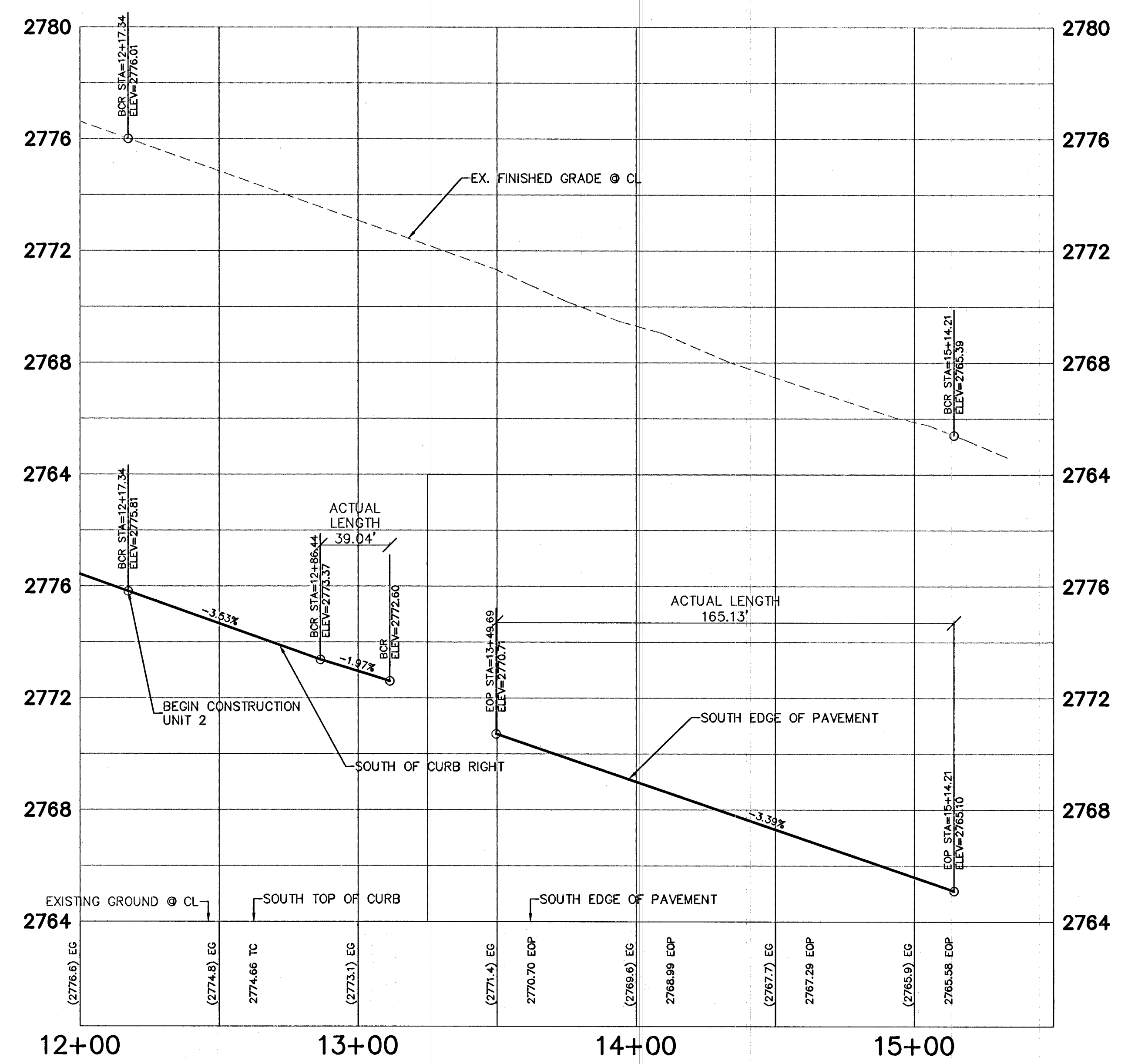

PROFILE SCALES:
 HORZ. = 1" = 30'
 VERT. = 1" = 3'

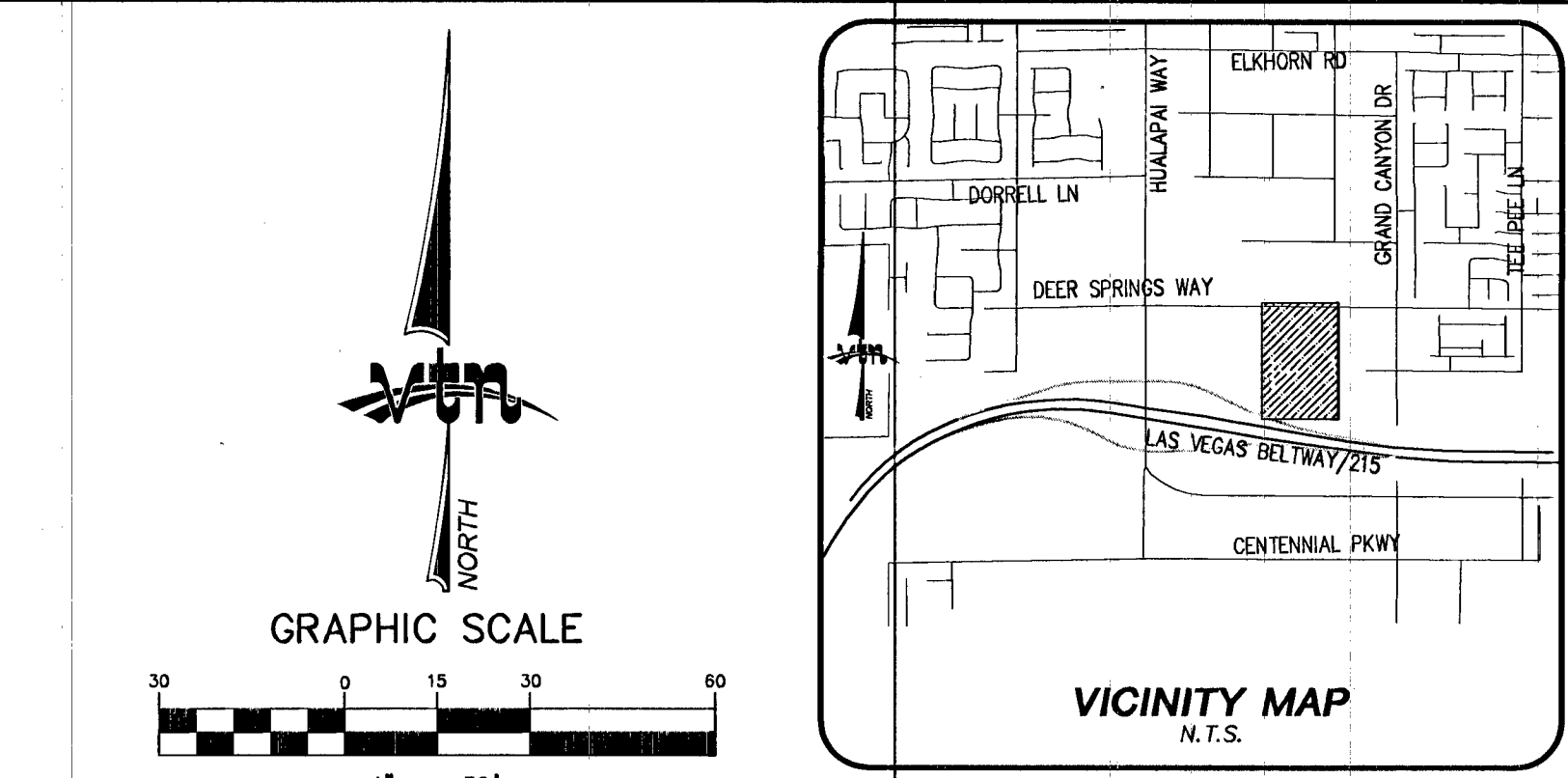

Call before you Dig
 Avoid cutting underground utility lines. It's costly.
 CALL BEFORE YOU DIG
 1-800-485-5884
 CLARK COUNTY TRAFFIC OPERATIONS
 1-702-432-5300

Call before you Dig
 Avoid overhead power line contact. It's costly.
 CALL BEFORE YOU DIG
 1-800-485-5884
 CLARK COUNTY TRAFFIC OPERATIONS
 1-702-227-2929

ENGINEER DISCLAIMER NOTE
 UTILITY LOCATIONS SHOWN HEREON ARE APPROXIMATE ONLY. IT SHALL BE THE CONTRACTOR'S RESPONSIBILITY TO DETERMINE THE EXACT HORIZONTAL AND VERTICAL LOCATION OF ALL EXISTING UNDERGROUND AND OVERHEAD UTILITIES AND NOTIFY THE DESIGN ENGINEER IMMEDIATELY OF ANY DISCREPANCIES PRIOR TO COMMENCING CONSTRUCTION. NO REPRESENTATION IS MADE THAT ALL ALL EXISTING UTILITIES ARE SHOWN HEREON. THE ENGINEER ASSUMES NO RESPONSIBILITY FOR UTILITIES NOT SHOWN OR UTILITIES NOT SHOWN IN THEIR PROPER LOCATION.

NOTE
 FOR DETAILS & SECTIONS REFER TO SHEET DT1 & DT2.

HQ RAMP DATA

NO.	"A"	"B"	CASE
1	8.0'	8.0'	1
2	4.5'	9.5'	1
3	4.5'	12'	1
4	4.5'	15'	1
5	9.5'	4.5'	1
6	12'	4.5'	1

- CONSTRUCTION NOTES**
- CONSTRUCT "L" TYPE CURB & GUTTER PER STD. DWG. NO. 216.1.51
 - CONSTRUCT CONCRETE CROSS GUTTER PER STD. DWG. NO. 228
 - CONSTRUCT 5.0' CONCRETE SIDEWALK PER STD. DWG. NO. 234
 - CONSTRUCT WHEEL CHAIR RAMP CASE 1 PER STD. DWG. NO. 235
 - SAWCUT & MATCH EXISTING AC
 - CONSTRUCT PER DETAIL C ON DT1
 - CONSTRUCT 2' SIDEWALK UNDERDRAIN PER STD. DWG. NO. 219
 - CONSTRUCT 6' HIGH WROUGHT IRON FENCE
 - CONSTRUCT DROP INLET STAMP & SIGN PER STD. DWG. NO. 421

PROJECT BENCHMARK
 PROJECT DATUM: NORTH AMERICAN VERTICAL DATUM OF 1988 (NAV88)
 CITY OF LAS VEGAS BENCHMARK: SLV90:19W4 2008 ADJUSTMENT (UPDATED 5/24/10) NAV88 ELEVATION: 857.697 METERS (2813.96 FEET)
 RIVET AND PLATE CONCRETE PAD (LWMD) 100'SE HUALAPAI WAY AND DEER SPRINGS.

BASIS OF BEARINGS
 GRID NORTH AS DEFINED BY THE CENTRAL MERIDIAN OF THE NEVADA COORDINATE REFERENCE SYSTEM (NCRS), LAS VEGAS ZONE, NORTH AMERICAN DATUM OF 1983; SAID MERIDIAN BEING COINCIDENT WITH 114°58' WEST OF THE GREENWICH MERIDIAN.
 LINEAR UNIT: US SURVEY FOOT (FTUS)
 DATUM (REFERENCE FRAME): NAD 1983 (CORS 2011) EPOCH 2010
 SYSTEM: NEVADA COORDINATE REFERENCE SYSTEM (NCRS)
 ZONE: LAS VEGAS
 PROJECTION: TRANSVERSE MERCATOR
 STANDARD PARALLEL (AND LATITUDE OF GRID ORIGIN): 36°15'00"N
 LONGITUDE OF CENTRAL MERIDIAN: 114°58'00"W
 NORTING AT GRID ORIGIN: 200,000,000 M (656,168,666.7 FTUS)
 EASTING AT CENTRAL MERIDIAN: 100,000,000 M (328,083,333.333 FTUS)
 SCALE FACTOR ON CENTRAL MERIDIAN: 1.0001 (EXACT)
 NOTES:
 1. ALL DISTANCES AND BEARINGS SHOWN HEREON ARE PROJECTED (GRID) VALUES BASED ON THE PRECEDING PROJECTION DEFINITION. THE PROJECTION WAS DEFINED SUCH THAT PROJECTED (GRID) DISTANCES ARE EQUIVALENT TO "GROUND" DISTANCES IN THE PROJECT AREA.
 2. GRID BEARINGS SHOWN HEREON (OR IMPLIED BY GRID COORDINATES) DO NOT EQUAL GEODETIC BEARINGS DUE TO MERIDIAN CONVERGENCE.

CLARK COUNTY DEPARTMENT OF PUBLIC WORKS
 DEVELOPMENT REVIEW
 Acceptance of plans for filing
 By: _____
 Acceptance of these plans for filing shall not be construed to be a permit for or an approval of any violation of any of the provisions of the state or county laws and/or specifications. Clark County shall be held free from damages which may result from the construction of the improvements from the engineering design depicted herein.
 NOTE: Power poles and/or other existing facilities not in proper location based on proposed improvements shown hereon will be relocated at no expense to Clark County.
 EXPIRES 06-30-16

RYLAND HOMES
 845 W. WASHINGTON, SUITE 200
 LAS VEGAS, NEVADA 89106
 (702) 360-7500

STREET PLAN & PROFILE
 DEER SPRINGS WAY
 STA: 12+17.34-15+14.21

BRISTLE FALLS UNIT 2

CITY OF LAS VEGAS
 2727 SOUTH RAINBOW BOULEVARD
 LAS VEGAS, NEVADA 89146-5148
 PH. (702) 873-7550 FAX (702) 362-2597 WEB WWW.LVNV.COM
 CONSULTING ENGINEERS & PLANNERS • LAND SURVEYORS

DRAWN BY: _____ DEC. 2013
 DESIGNED BY: _____ DEC. 2013
 CHECKED BY: _____ JAN. 2014
 PROJECT NO: _____ SCALE: 1" = 30' HORIZ.
 1" = 3' VERT.
 SHEET
 ST1
 14 OF 19 SHEETS
 DRAWING NO.
 HTE 14-17769
 H#53326
 1074994-2