

PROFILE SCALES:
 HORZ. = 1"=30'
 VERT. = 1"=3'

INYO SEWER (PUBLIC)

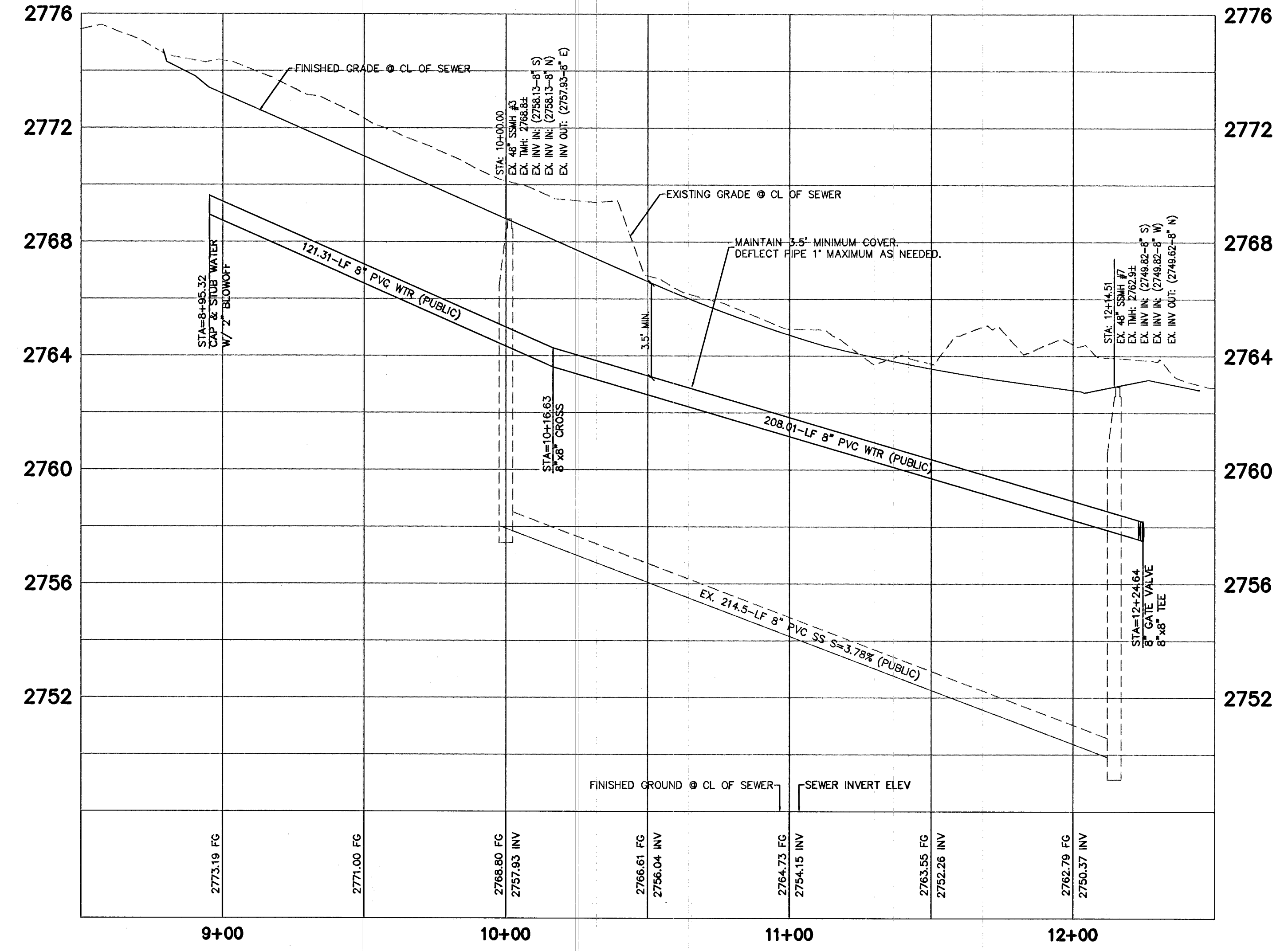

ENGINEER DISCLAIMER NOTE:
 UTILITY LOCATIONS SHOWN HEREON ARE APPROXIMATE ONLY. IT SHALL BE THE CONTRACTOR'S RESPONSIBILITY TO DETERMINE THE EXACT HORIZONTAL AND VERTICAL LOCATION OF ALL EXISTING UNDERGROUND AND OVERHEAD UTILITIES AND NOTIFY THE DESIGN ENGINEER IMMEDIATELY OF ANY DISCREPANCIES PRIOR TO COMMENCING CONSTRUCTION. NO REPRESENTATION IS MADE THAT ALL EXISTING UTILITIES ARE SHOWN HEREON. THE ENGINEER ASSUMES NO RESPONSIBILITY FOR UTILITIES NOT SHOWN OR UTILITIES NOT SHOWN IN THEIR PROPER LOCATION.

ALL NEW WATER MAIN TO COVER PER UDACS SECTION 2.08
NOTE:
 VERIFY AND LOCATE ALL EXISTING UTILITIES WITHIN THE PROJECT WORK AREA.

ALL SEWER/STORM DRAINS CROSSING WATER LINES MUST CONFORM TO SECTION 2.22 OF THE UNIFORM DESIGN AND CONSTRUCTION STANDARDS FOR POTABLE WATER SYSTEMS (UDACS) FOR WATER AND STORM MAIN CROSSINGS AND CLEARANCES.

NOTE:
 INSTALL PIPELINE MARKER BALLS IN TRENCH ABOVE EACH HORIZONTAL ELBOW FITTING, PER UDACS PLATE No. 15

UTILITY CROSSING NOTE:
 ALL SEWER/STORM DRAINS CROSSING WATER LINES MUST CONFORM TO SECTION 2.22 OF UNIFORM DESIGN AND CONSTRUCTION STANDARDS FOR POTABLE WATER SYSTEMS (UDACS) FOR WATER AND STORM MAIN CROSSINGS AND CLEARANCES.

WATER MAIN JOINT DEFLECTION (PVC 4"-24")
 PVC PIPE SHALL BE DEFLECTED AT THE JOINT ONLY. THE MAXIMUM ALLOWABLE DEFLECTION SHALL BE ONE (1) DEGREE PER JOINT WITH A MINIMUM RADIUS OF CURVATURE OF 1,150 FEET, PER UDACS 2.07.01 AND 2.07.02.
 FOR CHANGES IN DIRECTION EXCEEDING THE MAXIMUM ALLOWABLE JOINT DEFLECTION, FITTINGS SHALL BE USED.

PROJECT BENCHMARK
 PROJECT DATUM: NORTH AMERICAN VERTICAL DATUM OF 1988 (NAV88)
 CITY OF LAS VEGAS BENCHMARK: 5LV90:19W4 2008 ADJUSTMENT (UPDATED 5/24/10) NAV88 ELEVATION: 857.697 METERS (2813.96 FEET)
 RIVET AND PLATE CONCRETE PAD (LXVW0) 100'SE HUALAPAI WAY AND DEER SPRINGS.

BASIS OF BEARINGS
 GRID NORTH AS DEFINED BY THE CENTRAL MERIDIAN OF THE NEVADA COORDINATE REFERENCE SYSTEM (NCRS), LAS VEGAS ZONE, NORTH AMERICAN DATUM OF 1983; SAID MERIDIAN BEING COINCIDENT WITH 114°58' WEST OF THE GREENWICH MERIDIAN.
 LINEAR UNIT: US SURVEY FOOT (FTUS)
 DATUM (REFERENCE FRAME): NAD 1983 (COORDS 2011) EPOCH 2010
 SYSTEM: NEVADA COORDINATE REFERENCE SYSTEM (NCRS)
 ZONE: LAS VEGAS
 PROJECTION: TRANSVERSE MERCATOR
 STANDARD PARALLEL (AND LATITUDE OF GRID ORIGIN): 36°15'00"N
 LONGITUDE OF CENTRAL MERIDIAN: 114°58'00"W
 NORTHING AT GRID ORIGIN: 200,000,000 M (656,166,667 FTUS)
 EASTING AT CENTRAL MERIDIAN: 100,000,000 M (328,083,333 FTUS)
 SCALE FACTOR ON CENTRAL MERIDIAN: 1.0001 (EXACT)
NOTES:
 1. ALL DISTANCES AND BEARINGS SHOWN HEREON ARE PROJECTED (GRID) VALUES BASED ON THE PRECEDING PROJECTION DEFINITION. THE PROJECTION WAS DEFINED SUCH THAT PROJECTED (GRID) DISTANCES ARE EQUIVALENT TO "GROUND" DISTANCES IN THE PROJECT AREA.
 2. GRID BEARINGS SHOWN HEREON (OR IMPLIED BY GRID COORDINATES) DO NOT EQUAL GEODETIC BEARINGS DUE TO MERIDIAN CONVERGENCE.

APPROVALS:
 APPROVED FOR CONSTRUCTION
 [Signature] DISHA R. D. SM
 LAS VEGAS VALLEY WATER DISTRICT ENGINEERING SERVICES MANAGER
 DATE 9/18/14 PROJECT 122759
 LVWD APPROVED FIRE FLOW 1500 GPM AT 20 PSI RESIDUAL

7							
6							
5							
4							
3							
2							
1							

RYLAND HOMES
 8925 W. RUSSELL ROAD, SUITE 200
 LAS VEGAS, NV 89148
 (702) 366-7500

BRISTLE FALLS UNIT 2

INYO SEWER PLAN & PROFILE
 STA: 8+95.92-12+14.51

CITY OF LAS VEGAS
 2727 SOUTH RAINBOW BOULEVARD
 LAS VEGAS, NEVADA 89146-5148
 PH: (702) 873-7550 FAX (702) 362-2597 WEB WWW.VTNV.COM
 CONSULTING ENGINEERS • PLANNERS • LAND SURVEYORS

PROFESSIONAL ENGINEER STATE OF NEVADA
 AARON M. [Signature]
 CIVIL
 NO. 60791

SHEET **SS4**
 13 OF 19 SHEETS
 DRAWING NO. 10744944-2

DATE: FEB 2014
 DESIGNED BY: [Signature]
 CHECKED BY: [Signature]
 PROJECT NO: 7519
 SCALE: 1"=30' HORIZ.
 1"=3' VERT.

EXPIRES 06-30-16
 HTE 14-17769
 H#53528