



MATCHLINE SEE SHEET G-2 FOR CONTINUATION

MATCHLINE SEE SHEET G-5 FOR CONTINUATION

MATCHLINE SEE SHEET G-4 FOR CONTINUATION

STORMWATER RUNOFF MANAGEMENT

(REQUIRED FOR ALL SITES GREATER THAN 1 ACRE (43,560 SQ.FT.))

- THE OWNER, SITE DEVELOPER, CONTRACTOR AND/OR THEIR AUTHORIZED AGENTS SHALL EACH DAY REMOVE ALL SEDIMENT, MUD, CONSTRUCTION DEBRIS, OR OTHER POTENTIAL POLLUTANTS THAT MAY HAVE BEEN DISCHARGED TO OR ACCUMULATE IN THE PUBLIC RIGHT-OF-WAYS OF CLARK COUNTY AS A RESULT OF CONSTRUCTION ACTIVITIES ASSOCIATED WITH THIS SITE DEVELOPMENT OR CONSTRUCTION PROJECT. SUCH MATERIALS SHALL BE PREVENTED FROM ENTERING THE STORM SEWER SYSTEM.
- ADDITIONAL CONSTRUCTION SITE DISCHARGE BEST MANAGEMENT PRACTICES MAY BE REQUIRED OF THE OWNER AND HIS OR HER AGENTS DUE TO UNDERGROUND STORAGE TANKS OR IF THE SUBMITTED PLAN DOES NOT MEET THE PERFORMANCE STANDARDS SPECIFIED IN TITLE 24.40 AND THE LAS VEGAS VALLEY CONSTRUCTION SITE BEST MANAGEMENT PRACTICES MANUAL.
- TEMPORARY OR PERMANENT STABILIZATION PRACTICES WILL BE INSTALLED ON DISTURBED AREAS AS SOON AS PRACTICABLE AND NO LATER THAN 14 DAYS AFTER THE CONSTRUCTION ACTIVITY IN THAT PORTION OF THE SITE HAS TEMPORARILY OR PERMANENTLY CEASED. SOME EXCEPTIONS TO WEEKLY INSPECTIONS MAY APPLY, SUCH AS SUSPENSION OF LAND DISTURBANCE ACTIVITIES. REFER TO NEVADA STORMWATER GENERAL PERMIT FOR CONSTRUCTION ACTIVITY NVR100000, SECTION III.A.5.
- AT A MINIMUM, THE CONTRACTOR OR HIS AGENT SHALL INSPECT ALL DISTURBED AREAS, AREAS USED FOR STORAGE OF MATERIALS AND EQUIPMENT THAT ARE EXPOSED TO PRECIPITATION, VEHICLE ENTRANCE AND EXIT LOCATIONS AND ALL BMPs WEEKLY, AND WITHIN 24 HOURS AFTER ANY ACTUAL RAIN EVENT OF 0.5 INCHES OR MORE. THE CONTRACTOR OR HIS AGENT SHALL UPDATE OR MODIFY THE STORMWATER POLLUTION PREVENTION PLAN AS NECESSARY. SOME EXCEPTIONS TO WEEKLY INSPECTIONS MAY APPLY, SUCH AS SUSPENSION OF LAND DISTURBANCE ACTIVITIES. REFER TO NEVADA STORMWATER GENERAL PERMIT FOR CONSTRUCTION ACTIVITY NVR100000, SECTION III.A.12.
- ACCUMULATED SEDIMENT IN BMPs SHALL BE REMOVED WITHIN SEVEN DAYS AFTER A STORMWATER RUNOFF EVENT OR PRIOR TO THE NEXT ANTICIPATED STORM EVENT, WHICHEVER IS EARLIER. SEDIMENT MUST BE REMOVED WHEN BMP DESIGN CAPACITY HAS BEEN REDUCED BY 50 PERCENT OR MORE.

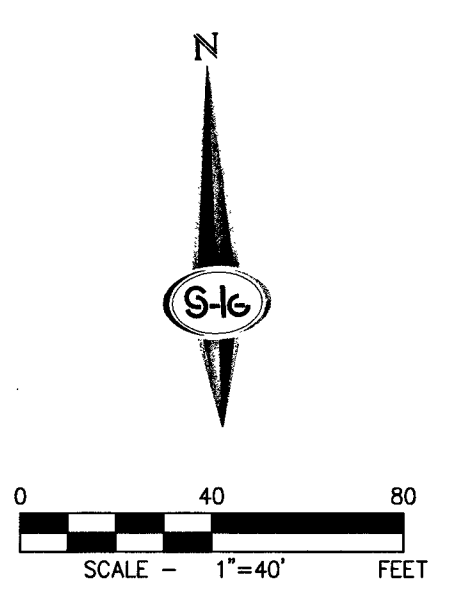
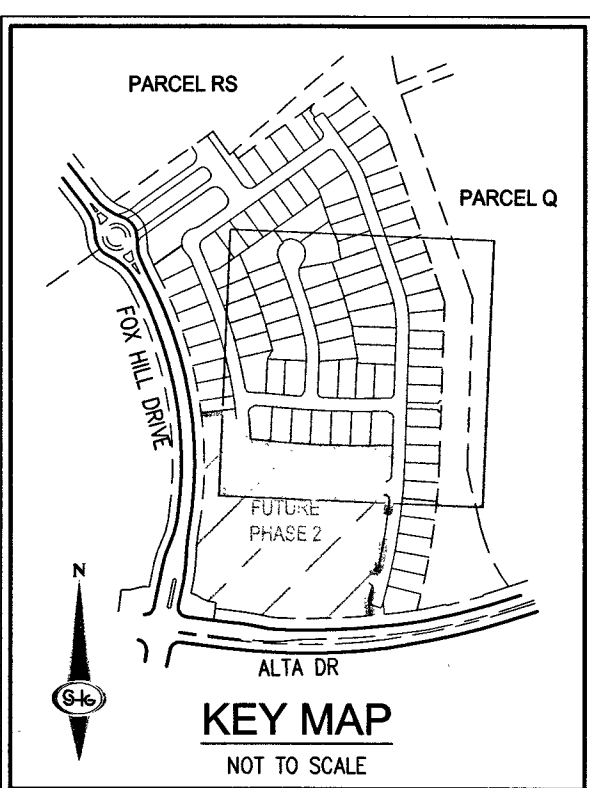

- ### GRADING NOTES
- CONSTRUCT 2" AC PAVEMENT OVER 4" TYPE II AGGREGATE BASE
 - NOT USED
 - CONSTRUCT 30" ROLL TYPE CURB AND GUTTER PER SUMMERLIN IMPROVEMENT STANDARDS S-48
 - CONSTRUCT 1" TYPE CURB AND GUTTER PER SUMMERLIN IMPROVEMENT STANDARDS S-50
 - CONSTRUCT "A" TYPE ISLAND CURB PER SUMMERLIN IMPROVEMENT STANDARDS S-50
 - CONSTRUCT "C" TYPE ISLAND CURB PER SUMMERLIN IMPROVEMENT STANDARDS S-50
 - CONSTRUCT 8" CROSS GUTTER PER SUMMERLIN IMPROVEMENT STANDARDS S-64
 - CONSTRUCT 5" WIDE SIDEWALK PER SUMMERLIN IMPROVEMENT STANDARDS S-72
 - CONSTRUCT 4" WIDE SIDEWALK PER SUMMERLIN IMPROVEMENT STANDARDS S-72
 - CONSTRUCT SIDEWALK RAMPS USING ARMOR TILE TRUNCATED DOMES OR EQUIVALENT PER CCAUSD NO. 235, CASE II
 - CONSTRUCT SIDEWALK RAMPS USING ARMOR TILE TRUNCATED DOMES OR EQUIVALENT PER CCAUSD NO. 235, CASE II
 - CONSTRUCT 10" TRANSITION FROM 24" L CURB TO 30" ROLL CURB PER DETAIL 35 ON SHEET D-2
 - INTO EXISTING CURB AND GUTTER, CONTRACTOR TO VERIFY LOCATION AND INVERT PRIOR TO START OF CONSTRUCTION
 - INSTALL 18" RCP CLASS IV STORM DRAIN (PRIVATE)
 - INSTALL 24" RCP CLASS IV STORM DRAIN (PRIVATE)
 - INSTALL 30" RCP CLASS IV STORM DRAIN (PRIVATE)
 - INSTALL 36" RCP CLASS IV STORM DRAIN (PUBLIC)
 - INSTALL 24" TYPE CM2 DROP INLET PER CCAUSD NO. 412.1 AND 421
 - INSTALL 10.0" TYPE CM2 DROP INLET PER CCAUSD NO. 412.1 AND 421
 - INSTALL 12.5" TYPE CM2 DROP INLET PER CCAUSD NO. 412.1 AND 421
 - INSTALL 48" TYPE I STORM DRAIN MANHOLE PER CCAUSD NO. 406
 - INSTALL 60" TYPE III STORM DRAIN MANHOLE PER CCAUSD NO. 406
 - INSTALL 4" CEMENT SLURRY (CLSM I) ENCASEMENT
 - CONNECT TO EX. 36" RCP STORM DRAIN. CONTRACTOR TO VERIFY LOCATION AND INVERT PRIOR TO START OF CONSTRUCTION
 - INSTALL RIP RAP D50=6" THICKNESS=12"
 - INSTALL 18" RCP CLASS III STORM DRAIN (PRIVATE)
 - CONSTRUCT SIDEWALK RAMP PER SUMMERLIN IMPROVEMENT STANDARDS S-75 (OPTION 1)
 - INSTALL CONCRETE PAVERS W/ 1" SAND (PER GEOTECH REPORT #E-06-107). SEE DETAIL C ON G-1.
 - INSTALL CONCRETE BANDING (DESIGN & MATERIAL SPECIFICATION BY OTHERS). SEE DETAIL D ON G-1.
- SEE SHEET C-2 FOR ABBREVIATIONS AND QUANTITIES

- ### GENERAL NOTES
- SEE SHEETS 10-12 FOR WALL PLAN.
 - SEE PLAN AND PROFILE SHEETS FOR CENTERLINE AND BACK OF CURB CURVE DATA.
 - FINAL GRADES ADJACENT TO STRUCTURES SHALL BE IN CONFORMANCE WITH IBC 2006 SECTION 2304.11.2.2.
 - THE CONTRACTOR SHALL VERIFY ALL CONDITIONS AND DIMENSIONS AND REPORT ALL DISCREPANCIES TO THE ENGINEER.
 - ALL IMPROVEMENTS TO BE PROTECTED FROM EROSION BY SWFP.
 - MAXIMUM/MINIMUM SLOPES AND MINIMUM STREET SECTIONS NOT TO EXCEED THAT SHOWN ON GEOTECH REPORT.
 - SEE DETAIL SHEETS FOR STREET SECTIONS AND DETAILS.
 - ALL PUBLIC AND PRIVATE DRAINAGE IMPROVEMENTS TO BE BONDED FOR AND INSPECTED.
 - CONSTRUCTION OF BLOCK WALLS REQUIRES A SEPARATE BUILDING PERMIT AND APPROVAL.
 - EXISTING UTILITY LOCATIONS SHOWN HEREON ARE APPROXIMATE ONLY. CONTRACTOR TO VERIFY LOCATION AND ELEVATION OF EXISTING UTILITY STRUCTURES AND FACILITIES AND NOTIFY ENGINEER OF ANY DISCREPANCIES PRIOR TO CONSTRUCTION. CONTRACTOR TO PROTECT IN PLACE DURING CONSTRUCTION. CONTRACTOR/OWNER SHALL BE NOTIFIED OF PRIOR DAMAGE TO EXISTING FACILITIES PRIOR TO CONSTRUCTION. CONTRACTOR WILL BE RESPONSIBLE FOR REPAIR/REPLACING FACILITIES IF ENGINEER/OWNER IS NOT NOTIFIED OF EXISTING DAMAGE PRIOR TO CONSTRUCTION COMMENCING.
 - NO STRUCTURE, VEGETATION, OR OBJECTS OF ANY KIND IS PERMITTED OVER TWENTY-FOUR (24) INCHES IN HEIGHT (MEASURED FROM THE TOP OF THE ADJACENT CURB IF CURB EXIST) WITHIN THE SIGHT VISIBILITY ZONES.
 - ALL ELEVATIONS SHOWN, WITH EXCEPTION TO PAD AND FINISHED FLOOR ELEVATIONS, ARE THE VALUE SHOWN PLUS 3.000'
 - ALL PRIVATE STREETS ARE PUBLIC UTILITY, G/LV SEWER AND PUBLIC DRAINAGE EASEMENTS TO BE PRIVATELY MAINTAINED BY HOA.

DISCLAIMER NOTE

EXISTING UTILITY LOCATIONS SHOWN HEREON ARE APPROXIMATE ONLY. IT SHALL BE THE CONTRACTOR'S RESPONSIBILITY TO DETERMINE THE EXCEPT VERTICAL AND HORIZONTAL LOCATION OF ALL EXISTING UNDERGROUND UTILITIES PRIOR TO COMMENCING CONSTRUCTION. NO REPRESENTATION IS MADE THAT ALL EXISTING UTILITIES ARE SHOWN HEREON. THE ENGINEER ASSUMES NO RESPONSIBILITY FOR UTILITIES NOT SHOWN IN THEIR PROPER LOCATION.

NOTE

ALL ON-SITE STORM DRAIN AND THE ASSOCIATED FACILITIES ARE PRIVATELY OWNED AND TO BE PRIVATELY MAINTAINED BY THE HOMEOWNERS ASSOCIATION.

DROP INLET NOTES

- CAST-IN-PLACE MONOLITHIC POUR WITH WATER STOP BETWEEN SLAB AND WALLS.
- BASE WALLS AND TOP TO BE CONSTRUCTED WITH MECHANICAL WATER STOPS, CENTER BULB, OR FLAT STRIP (VINYLEX, GREENSTREAK PLASTIC PRODUCTS, OR APPROVED EQUAL)

BENCHMARK

RIVET & PLATE IN TOP OF CURB IN THE SOUTHEAST CORNER OF DESERT MOON ROAD & DESERT SUNRISE ROAD, 7LV09345W6A
NAVD 88 ELEV = 1006.289 METERS = 3301.47 FEET

BASIS OF BEARING

NORTH 05°59'55" WEST, BEING THE BEARING OF THE WEST LINE OF SECTION 34, TOWNSHIP 20 SOUTH, RANGE 59 EAST, M.D.M., CITY OF LAS VEGAS, CLARK COUNTY, NEVADA, AS SHOWN BY MAP THEREOF ON FILE IN BOOK 143, PAGE 47 OF PLATS IN THE CLARK COUNTY RECORDER'S OFFICE, NEVADA.

FLOOD CERTIFICATION

I CERTIFY THAT THIS GRADING PLAN IS IN CONFORMANCE WITH THE APPROVED TECHNICAL DRAWING STUDY DS413 ON FILE AT CITY OF LAS VEGAS FOR THE SUBJECT SITE.

Corey A. Lieber, P.E. 15875
DATE: 10-26-16

FEMA FLOOD ZONE DESIGNATION

THE PROJECT SITE IS LOCATED WITHIN A FEMA DESIGNATED ZONE X AND SHADDED ZONE X (AREA OUTSIDE THE 500-YEAR FLOOD PLAIN AND AREA OF 2% ANNUAL CHANCE FLOOD), PER FIRM PANEL 32003C2150, DATED SEPTEMBER 27, 2002.

Call before you Dig
Avoid hitting underground utilities. IT'S COSTLY.

Call 811
1-800-227-2600
CLARK COUNTY OPERATIONS
1-702-455-6000

AVOID HITTING UNDERGROUND TRAFFIC SIGNAL SYSTEMS AND STREET LIGHT SYSTEM CONDUITS. IT'S COSTLY.

Call before you dig UnderGround
1-702-455-6000
CLARK COUNTY TRAFFIC OPERATIONS
1-702-432-5300
FREWAY AND ARTERIAL SYSTEM OF TRANSPORTATION

AVOID HITTING OVERHEAD POWER LINES. IT'S COSTLY.

CALL BEFORE YOU DO OVERHEAD
1-702-227-2929

SLATER HANIFAN GROUP
CONSULTING ENGINEERS & PLANNERS
5740 S. ARVILLE STREET #216, LAS VEGAS, NV 89118
PHONE (702) 284-5300 FAX (702) 284-5399

Woodside Homes
BELMONTE - PHASE 1
GRADING PLAN III
BETTER BY DESIGN

NO.	DESCRIPTION	DATE	BY	APP.
1	ADD RETAINING WALL	7/5/16	WJK	
2	REVISE RETAINING WALL ON LOT 91	10/5/16	WJK	

DATE: 1/2/14
DRAFTER: GWB
DESIGNER: MAK
CHECKED: CAL
PROJECT NO.: WSH1302-001

Corey A. Lieber, P.E.
15875
10-26-16

G-3
SHEET 5 OF 40
H #51783
10714989-1