

G:\1\4078 CIMARRON PEDESTRIAN BRIDGE\H4838\SET\DWG\H4838-07-S07.DWG

1/9/18

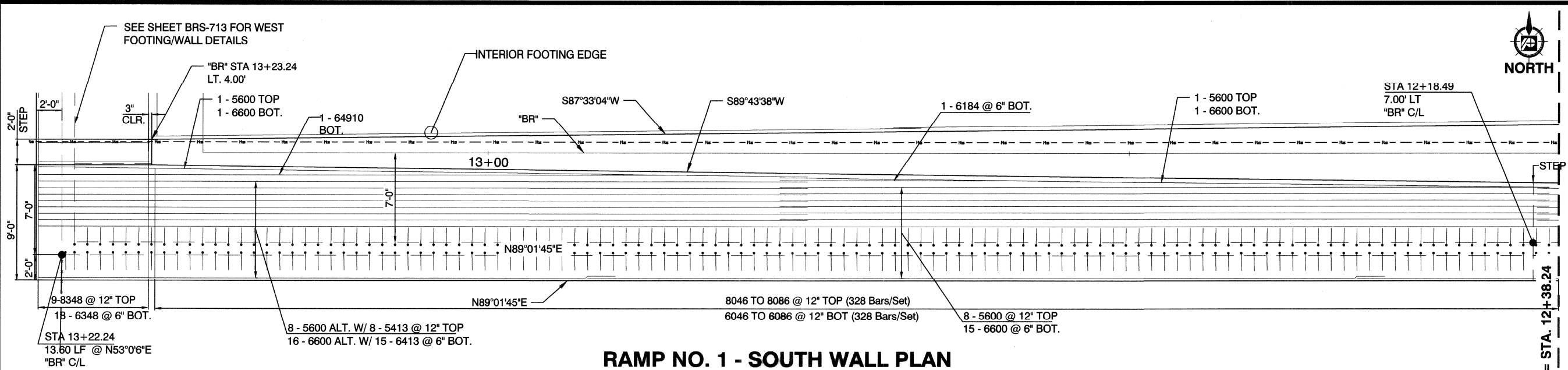

**RAMP NO. 1 - SOUTH WALL PLAN**

SCALE: 1/4" = 1'-0"

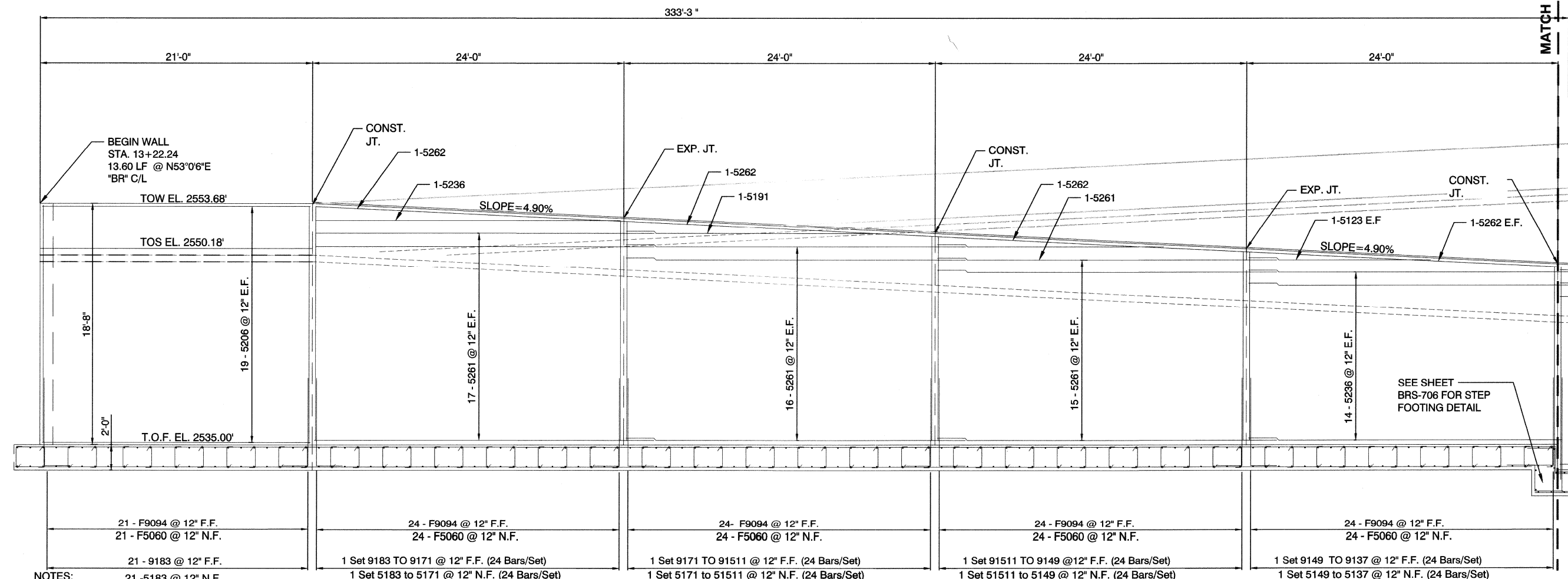

**RAMP NO. 1 - SOUTH WALL ELEVATION**

SCALE: 1/4" = 1'-0"

**NOTES:**

1. SEE SHEET BRS-714 FOR WEEPHOLE DETAILS
2. SEE AESTHETIC DRAWINGS FOR AESTHETIC TREATMENTS.
3. SEE ELECTRICAL DRAWINGS FOR CONDUIT PLACEMENT / DETAILS.
4. SEE NDOT STANDARD DETAIL B-30.1.4 FOR EXPANSION JOINT AND WATERSTOP DETAILS.

\* FENCE NOT SHOWN FOR CLARITY  
FEDERAL PROJECT NUMBER: CM-0003(180)

 PREPARED BY <b>CITY OF LAS VEGAS</b> DEPARTMENT OF PUBLIC WORKS CAPITAL PROJECT MGMT	 DESIGN GROUP <small>9900 Brookhurst Road - Suite 100          Las Vegas, Nevada 89149 - (702) 855-9100</small>	NO. DATE REVISIONS	
PREPARED FOR <b>CITY OF LAS VEGAS</b> H# 48938 DATE: JANUARY 2018 SUBMITTAL STAGE: <b>100% FINAL</b>	DESIGNED BY: SR DRAWN BY: AG CHECKED BY: AP		
<b>CIMARRON PEDESTRIAN BRIDGE          AT SUMMERLIN PARKWAY</b>		<b>PLAN AND ELEVATION          RAMP NO. 1 SOUTH WALL</b>	
<b>SHEET          BRS-701</b> 45 OF 86 DRAWING NO. <b>676-22</b>			