

12/27/17 6:114078 CIMARRON PEDESTRIAN BRIDGE H48938 SHEET SET DWG H48938-05-SM00.DWG

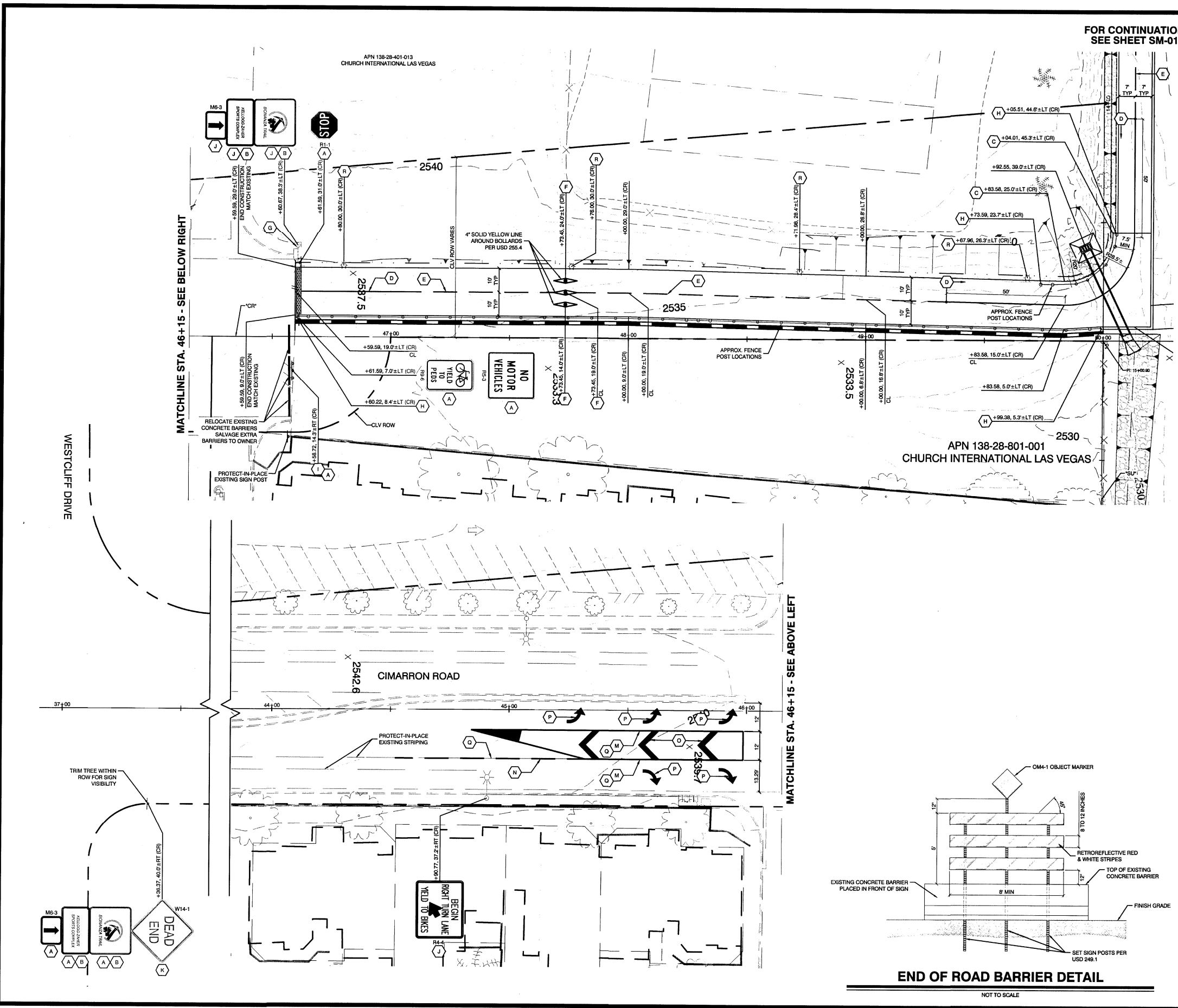

FOR CONTINUATION  
SEE SHEET SM-01

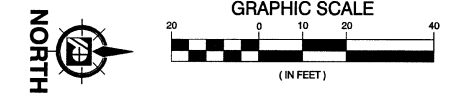

CALL BEFORE CONSTRUCTION		
BEFORE YOU DIG	USA NORTH	811 OR 800-227-2600
BEFORE YOU UNDERGROUND	F.A.S.T.	702-432-5300
	CLARK COUNTY TRAFFIC OPERATIONS	702-455-7511
	CITY OF LAS VEGAS T.E.F.O.	702-229-6611
BEFORE YOU OVERHEAD	NV ENERGY	702-227-2929

**STRIPING, SIGNAGE AND CONST. NOTES**

- A PROVIDE AND INSTALL POST-MOUNTED TRAFFIC SIGN PER USD 249.1
- B USE SYMBOLLOGY THAT MATCHES EXISTING BONANZA TRAIL SIGNAGE PER DETAIL 1 ON SHEET TY-02
- C HORIZONTAL CURVE TRANSITION
- D INSTALL 4" SOLID YELLOW CENTER LINE (POLYUREA) PER USD 255.4
- E INSTALL 4" DASHED YELLOW CENTER LINE (POLYUREA) PER USD 255.4
- F INSTALL REMOVABLE BOLLARD (SEE SHEET TY-02, DETAIL 2)
- G REPLACE EXISTING STREETLIGHT FIXTURE HEAD WITH 400W LED-EQUIVALENT LUMINAIRE PER SPECIAL PROVISION SECTION 623L.02.03.
- H INSTALL POST AND CABLE FENCE PER DETAIL 1 ON SHEET TY-03. ENSURE FULL ENCLOSURE BETWEEN EXISTING TRAIL WALL AND AND PROPOSED RAMP RAIL. ENSURE FENCE IS NOT INSTALLED OVER UTILITY BOXES.
- I PROVIDE AND INSTALL END OF ROAD BARRIER SIGN PER DETAIL THIS SHEET.
- J PROVIDE AND INSTALL TRAFFIC SIGN ON EXISTING STREETLIGHT.
- K REINSTALL EX TRAFFIC SIGN PANELS
- L PROVIDE AND INSTALL WALL-MOUNTED TRAFFIC SIGN
- M INSTALL 6" SOLID WHITE STORAGE LANE LINE (POLYUREA) PER USD 246.7
- N INSTALL 6" WHITE SKIP LINE (POLYUREA) PER USD 244.9
- O INSTALL 24" WHITE CHEVRON AT 25' O.C. SPACING (POLYUREA)
- P INSTALL WHITE PAINTED DIRECTIONAL ARROW (POLYUREA)
- Q REMOVE EXISTING STRIPING
- R AREA LUMINAIRE TO BE INSTALLED BY CONTRACTOR. CONSTRUCT PER SHEET E2.01 & E3.01.

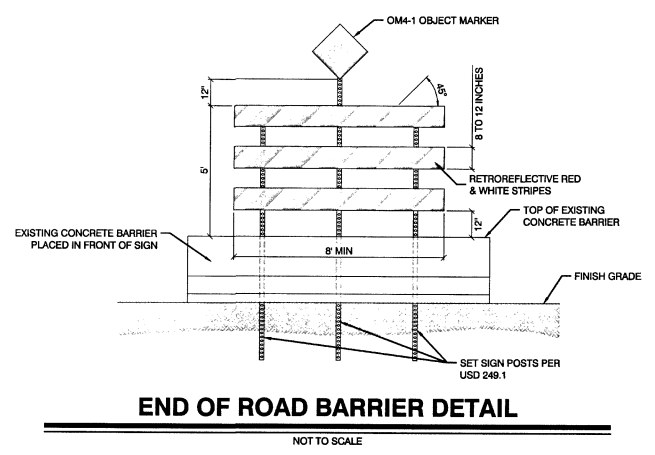

PREPARED BY <b>CITY OF LAS VEGAS</b> DEPARTMENT OF PUBLIC WORKS CAPITAL PROJECT MGMT	DESIGNED BY: MAS DRAWN BY: MAS CHECKED BY: AP
BID# 17-48938 HW 48938	DATE: JANUARY 2018 SUBMITTAL STAGE: 100% FINAL
<b>TITLE</b> CIMARRON PEDESTRIAN BRIDGE AT SUMMERLIN PARKWAY <b>SIGNAGE/MARKING/CURVE DATA PLAN</b> CIMARRON ROAD	
SHEET <b>SM-02</b> 17 OF 86 DRAWING NO. <b>676-22</b>	
FEDERAL PROJECT NUMBER: CM-0003(180)	