

VICINITY MAP
NOT TO SCALE
T21S R61E SEC. 26

CONSTRUCTION NOTES:
COORDINATE CONSTRUCTION WITH
tw telecom Inc. ALL UG CONDUIT TO
BE EQUIPPED WITH LOCATE WIRE
MAINTAIN A MINIMUM OF 36"
(PLACE BORE PITS AS NECESSARY)

Contact:
Hank Schlesinger,
tw telecom Inc.
(702) 216-2233

Call
before you
UnderGround
1-702-432-5200
FREEMAN AND ARTERIAL SYSTEM
OF TRANSPORTATION

GENERAL NOTES
ALL CONSTRUCTION SHALL CONFORM TO tw telecom Inc. AND CLARK COUNTY AREA UNIFORM STANDARD DRAWINGS AND SPECIFICATIONS.
ALL CONDUIT, PULL BOXES, MANHOLES, TRENCHING, BACK FILLING AND SUBSTRUCTURES ARE TO BE PROVIDED BY THE CONTRACTOR AND CONFORM TO tw telecom Inc. STANDARDS UNLESS OTHERWISE SPECIFIED.
TRENCHING AND TELEPHONE BOXES ARE TO BE PLACED IN THE SIDEWALK AREA WHENEVER POSSIBLE. ALL TRENCHING WILL BE OF A MINIMUM DEPTH TO MAINTAIN A 36" COVER OVER ALL tw telecom Inc. FACILITIES AND 12" MINIMUM SEPARATION FROM FOREIGN UTILITIES. NEW AND EXISTING BOXES WILL BE ESTABLISHED TO FINISH GRADE.
ALL 90° DEGREE BENDS MUST BE A MINIMUM F A 48" SWEEP.
ALL PULL BOXES LARGER THAN 17"x30" AND MANHOLES ARE TO BE GROUNDED WITH A #6 COPPER TINNED SOFT COPPER BONDING RIBBON PLACED VERTICALLY AROUND THE BOTTOM OF THE BOX WITH A 3" END STUBBED INSIDE.
PLYWOOD BACKBOARDS ARE TO BE TREATED WITH A FIRE RETARDANT MATERIAL, PAINT OR SEALER.
THE CONTRACTOR SHALL PROVIDE AND INSTALL A MEASURING TAPE CONSISTING OF A WATER PROOF 400 LB. TENSILE STRENGTH MARKED IN ONE FOOT OR LESS INCREMENTS IN AT LEAST ONE DUCTS IN ALL CONDUIT SECTIONS. ALL OTHER DUCTS WILL HAVE A 3" JET LINE PULL STRING WITH 400 LB. TENSILE STRENGTH. THE CONTRACTOR SHALL PROVE AND MANDREL ALL CONDUIT AFTER BACK FILLING WHILE A tw telecom Inc. ENGINEER IS PRESENT. MANDREL SIZE IS TO BE 3/4" SMALLER THAN THE INSIDE DIAMETER OF CONDUIT.
IN ORDER TO INSURE ADEQUATE FACILITIES ARE PROVIDED FOR ON THE PROJECT, IT IS IMPERATIVE THAT THE CONDUIT DESIGN NOT BE CHANGED WITHOUT THE tw telecom Inc. ENGINEER'S APPROVAL.
ALL TERMINALS, BACKBOARDS, CABINETS, ETC. SHALL BE EQUIPPED WITH A #6 GAUGE COPPER GROUND WIRE, ATTACHED TO A COMMON POWER MGN.
ALL PULL BOXES AND MANHOLES NOT IN A CONCRETE SIDEWALK, WILL BE REQUIRED TO HAVE A PROTECTIVE 8"x8" CONCRETE COLLAR POURED AROUND THE TOP PORTION OF THE BOX AND H-20 LOAD BEARING LIDS.
ALL CONDUIT ENDS (TERMINATED OR STUBBED) WILL HAVE A TAPERED POLYETHYLENE DUCT PLUG WITH A PULL STRING ATTACHED.
INSPECTION IS REQUIRED FOR ALL PHASES OF THE JOB. THESE PHASES ARE:
* OPEN TRENCHES AFTER CONDUIT HAS BEEN PLACED.
* OBSERVATION OF BACK FILL AND COMPACTION AS MEETING STANDARDS.
* MANDREL OF CONDUIT.
* WALL OF PULL BOXES AND MANHOLES MUST BE "CORDED WITH PROPER AMOUNT OF TERMINATIONS."
* GROUTING OF PULL BOXES AND CONCRETE COLLARS.
* PULL STRING IN ALL CONDUITS.
ALL WORK MUST BE ACCEPTED BY tw telecom Inc., AS MEETING tw telecom Inc. STANDARDS, FOR A CONTRACTOR TO BE PAID AND FOR tw telecom Inc. TO PLACE ANY TYPE OF TELECOMMUNICATIONS CABLE/FIBER.

LEGEND
--- INDICATES EX. UTILITIES & OH CABLE
--- PROPOSED 2.3,4 & 6" PVC, SCHEDULE 40
--- PROPOSED FIBER
--- PROPOSED 1 1/4" HDPE DUCT
--- INDICATES CENTER LINE
--- INDICATES RIGHT OF WAY
□ PROPOSED PULL BOX 3'X5'X4'6"
□ PROPOSED PULL BOX 2'6"X4'X3"
□ PROPOSED PULL BOX 3'0"X4'8"X3'6"
☒ TERMINAL CABINET 36"X36"X6"
☒ TERMINAL CABINET 24"X24"X6"
☒ TERMINAL CABINET 18"X24"X6"
☒ RAIN TIGHT, HINGED DOOR EW A 3/4" PLYWOOD BACKBOARD, UL APPROVED.
▨ 3/4" PLYWOOD BACKBOARD TREATED WITH A FIRE RETARDANT PAINT OR SEALER. BACKBOARDS SMALLER THAN 4'X8' SHOULD BE MOUNTED 40" ABOVE THE FLOOR.
--- #6 COPPER GROUND WIRE ATTACHED TO A POWER MGN.

UTILITY NOTE
UTILITY LOCATIONS SHOWN HEREON ARE APPROXIMATE ONLY. IT SHALL BE THE CONTRACTOR'S RESPONSIBILITY TO DETERMINE THE EXACT HORIZONTAL AND VERTICAL LOCATION OF ALL EXISTING UNDERGROUND UTILITIES PRIOR TO COMMENCING CONSTRUCTION. NO REPRESENTATION IS MADE THAT ALL EXISTING UTILITIES ARE SHOWN HEREON. THE ENGINEER ASSUMES NO RESPONSIBILITY FOR UTILITIES NOT SHOWN OR UTILITIES NOT SHOWN IN THEIR PROPER LOCATION.
Call before you Dig
Dial 811
UNDERGROUND SERVICE (USA)
CALL BEFORE YOU DIG
CALL 1-702-227-2929
CALL BEFORE YOU DIG
CALL 1-702-227-2929

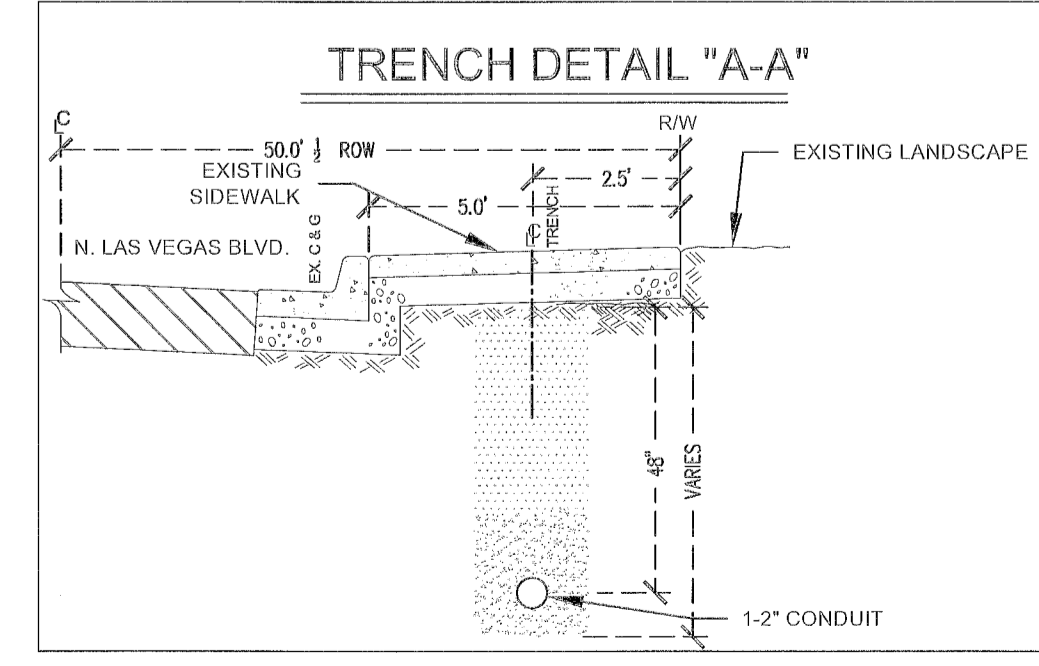
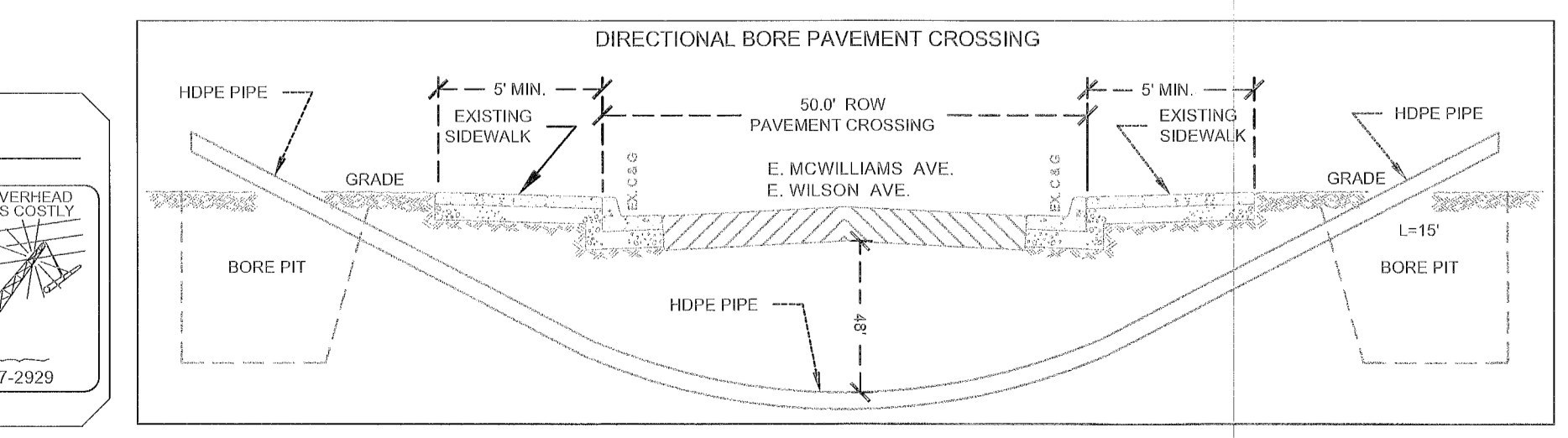
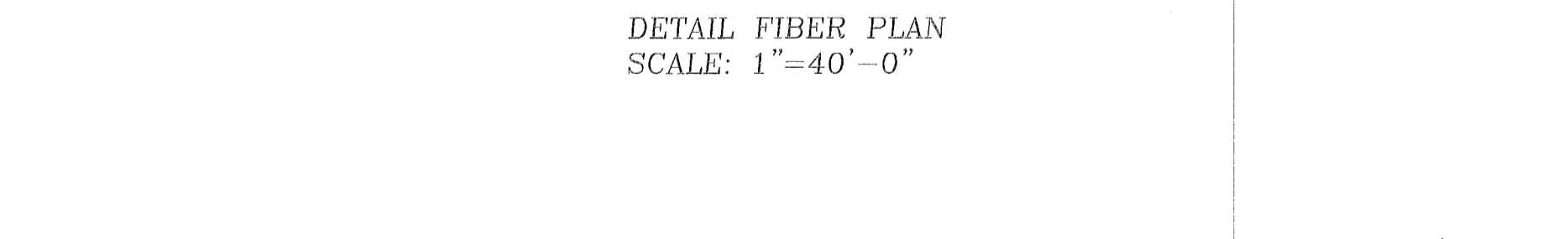
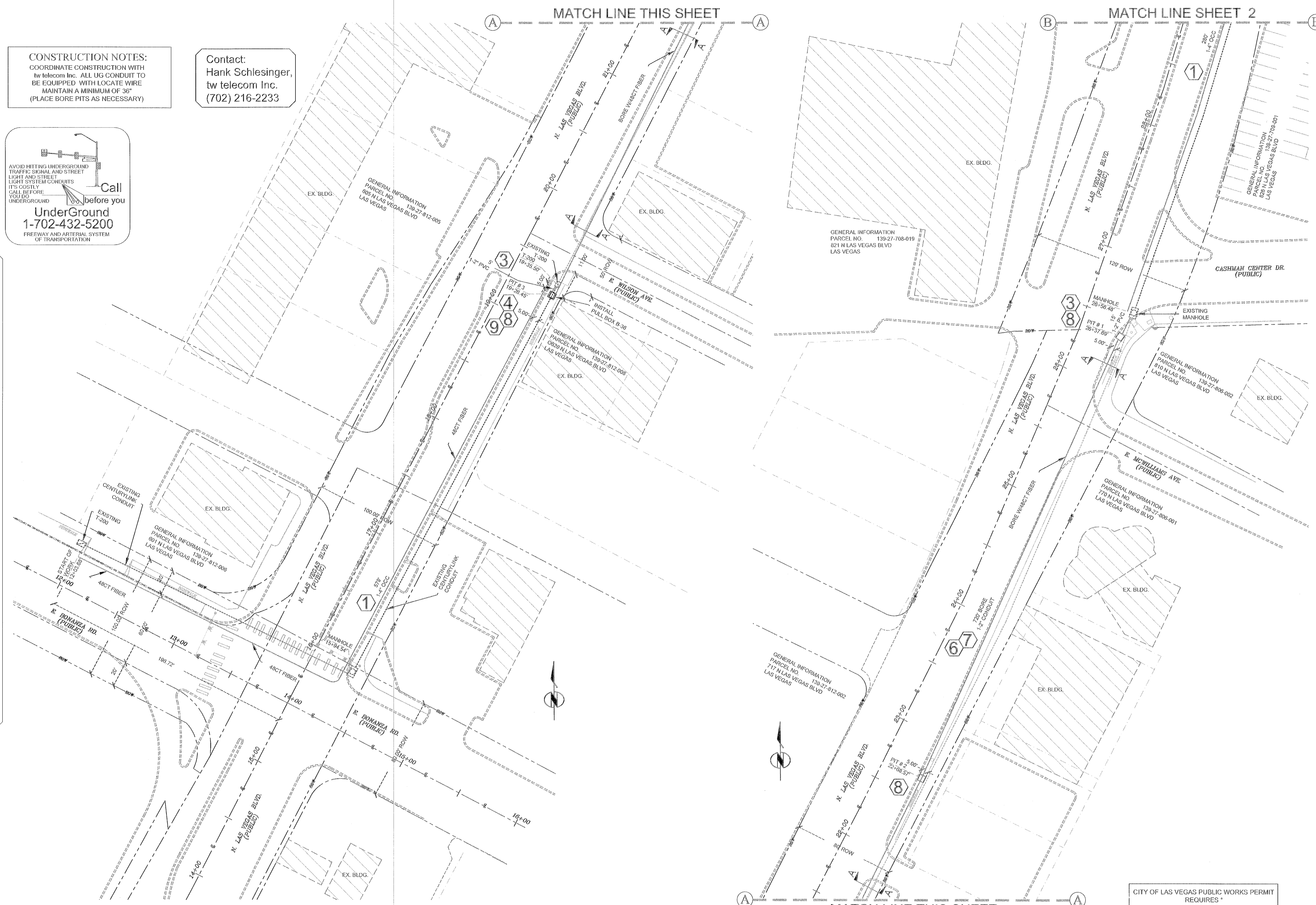

- CONSTRUCTION NOTES**
- INSTALL 48CT FIBER IN EXISTING TELCO CONDUIT.
 - TRENCH IN ASPHALT (TYPE 2 BACKFILL 2' PATCH).
 - INSTALL 1-2" SCH-40 CONDUIT W/48CT FIBER.
 - R & R SIDEWALK PANEL.
 - TRENCH IN DIRT.
 - DIRECTIONAL BORE 3'± FROM FINISH GRADE.
 - PLACE 1-2" HDPE CONDUIT OR EQUIVALENT W/1-48 CT FO/CABLE.
 - BORE PIT.
 - INSTALL PULL BOX B-36

CITY OF LAS VEGAS PUBLIC WORKS PERMIT
REQUIRES:
DEVELOPER/CONTRACTOR SHALL OBTAIN A CITY OF LAS VEGAS (CLV) PERMIT BEFORE ANY EXCAVATION WORK WITHIN CITY OF LAS VEGAS RIGHT-OF-WAY
* tw telecom Inc. INSPECTOR WILL VERIFY CITY OF LAS VEGAS PERMIT FOR WORK DONE WITHIN CLV RIGHT-OF-WAY
INSPECTOR: _____ DATE: _____

NOTE: ALL WORK SHALL COMPLY WITH THE CCAU STANDARDS DRAWINGS.
City of Las Vegas
APPROVED FOR CONSTRUCTION
THIS APPROVAL IS FOR WORK IN CLV ROW OR CLV EASEMENT ONLY. OBTAINING PERMISSION OR EASEMENT FOR WORK SHOWN ON PRIVATE PROPERTY IS THE RESPONSIBILITY OF THE UTILITY.
Approval: 50586 49538 Date: 8-14-19
100766212 - FIB

SCALE (H)	1"=40'
DESIGN BY	FRANK
DRAWN BY	CORSAN
REVIEW BY	HANK
REV. #	DATE
DESCRIPTION	APPROVAL
PROJECT NAME:	555 E. WASHINGTON AVE.
PROJECT LOCATION:	E. WASHINGTON AVE. & N. LAS VEGAS BLVD.
PROJECT NUMBER:	TW-13002

tw telecom
3944 East Silverst Lane
Las Vegas, NV 89120
(702) 316-2323 OFFICE
(702) 316-2399 FACSIMILE

SHEET
1
1 OF 2 SHEETS