

Memorandum

Department of Public Works
City Engineer Division
Survey Section
333 North Rancho Dr., 8th Floor
Las Vegas, Nevada 89106
Phone (702) 229-6217
Fax (702) 804-8582

To: Chris Knight, Director
Building and Safety Department

From: Alan R. Riecki, PLS
City Surveyor

C: Raymond Jemison, PLS
Jemison Surveying & Services

Tim Parks, P.E., Engineering Project Manager
Sanitary Sewers Section, Engineering Planning

Date: June 10, 2014

Re: Sanitary Sewer Final Location Map
SV 23A/23B Alta Drive Improvements
(Drawing No. 107V5922, L-Civil No. 47511)

The Survey Section has reviewed the Final Location Map and as far as our jurisdiction of this project is concerned, we find that the map is:

Acceptable: 6/10/2014



Signature

City Surveyor

Title

Public Works/Survey

Department/Division

ARR/OS:sy

NAD 83 (2011) EPOCH 2010.D?

A.

CITY OF LAS VEGAS
BUILDING AND SAFETY DEPARTMENT

OFFSITE INSPECTION & TESTING
333 NORTH RANCHO DRIVE
LAS VEGAS, NV 89106
PHONE: (702) 229-6337
FAX: (702) 363-1051

DEVELOPER'S SUBMITTAL OF GPS COORDINATES

- Sewer Storm Drain
- Electronic Comma Delineated File
- Final Location Map (2)

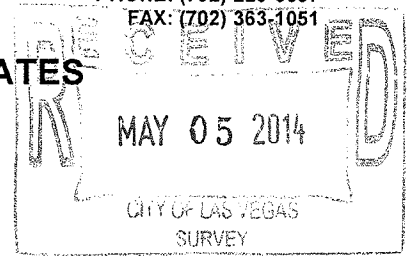

NOTE: THE TOP PART OF THIS FORM MUST BE FILLED OUT IN ITS ENTIRETY

PROJECT NAME: Village 23 A/B Alta Drive UNIT: _____ PHASE: _____
PROJECT LOCATION: _____
CLV PLAN #: 107V5922 CLV PROJECT # 47511 SHEET NO. (S): _____
OF MANHOLES _____ PUB. SEWER/STORM DRAIN LIN. FT. _____ # OF PRIVATE LATERALS _____
DEVELOPER: Howard Hughes Corp. PHONE: 702-791-4000 FAX: 702-791-4450
SURVEY CO.: Jemison Surveying PHONE: 702-360-4838 FAX: 702-360-4839
CONTRACTOR: TAB Contractors PHONE: 702-642-3033 FAX: 702-642-9936
CONTRACTOR'S SUPERVISOR NAME: Brandon Stott MOBILE: _____
DATE OF REQUEST: _____

THIS SEWER HAS BEEN SURVEYED BY NEVADA LICENSED LAND SURVEYOR:

Company Name Jemison Surveying Surveyor Name Ray Jemison
License # PLS# 10598 License exp. Date: 6/30/15

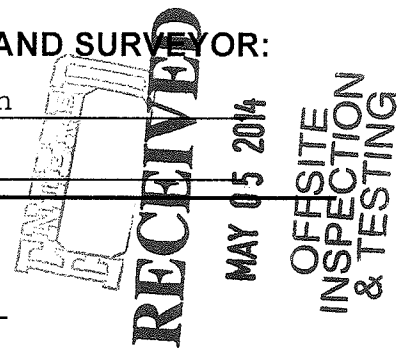

CITY USE ONLY

DATE SR. INSPECTOR RECEIVED: 5/5/14 SR. INSPECTOR INITIALS: [Signature]
DATE RECEIVED FROM SR. INSPECTOR AND SENT TO CITY SURVEYOR: _____

ACCEPTABLE BY CITY SURVEYOR DATE: 6/10/14 NOT ACCEPTABLE BY CITY SURVEYOR DATE 5/15/15

CLV SURVEYOR'S SIGNATURE: [Signature] DATE: 6-10-14

THE CITY OF LAS VEGAS RECOMMENDS THAT ALL DEFICIENCIES NOTED ON THE ATTACHED SURVEY REPORT BE CORRECTED PRIOR TO THE FINAL ACCEPTANCE.

For Sanitary Sewer To Complete and Return to Offsite Inspection & Testing:

RECEIVED BY: Joe Peña
(PLEASE PRINT)

SIGNATURE: [Signature]

RECEIVED
DATE: 6/19/2014
MAY 02 2014

For Flood Control To Complete and Return to Offsite Inspection & Testing:

RECEIVED BY: _____
(PLEASE PRINT)

SIGNATURE: _____ DATE: _____

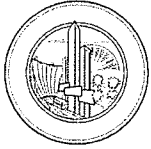

City of Las Vegas
Department of Public Works
Survey Section

REVIEW CHECKLIST
SANITARY SEWER
FINAL LOCATION MAP

JOB NUMBER 47511-SS 2
 PROJECT NAME Alta Drive Improve
 WORK AUTH. NO. P28000
 SURVEY FIRM Jemison Surveying
 PROJECT TYPE CIP Land Dev Street Rehab
 DATE 6/10/14
 REVIEWED BY O-SANTANA

REVIEW DETERMINATION

- Approved
- Not Acceptable

TO BE RE-SUBMITTED

- Two bond copies (no mylar)
- Electronic media with comma-separated coordinate file

REVIEW ITEM	OK	SEE R/L	N/A	COMMENTS
Submittal Contents				
Two bond copies (no mylar)	<input checked="" type="checkbox"/>	<input type="checkbox"/>	<input type="checkbox"/>	
Electronic media containing comma-separated coordinate file	<input checked="" type="checkbox"/>	<input type="checkbox"/>	<input type="checkbox"/>	
General Map Contents				
Sheet size 24" x 36"	<input type="checkbox"/>	<input type="checkbox"/>	<input type="checkbox"/>	
Sheet number and number of sheets	<input type="checkbox"/>	<input type="checkbox"/>	<input type="checkbox"/>	
North arrow (pointing up, left or right)	<input type="checkbox"/>	<input type="checkbox"/>	<input type="checkbox"/>	
Scale (written & graphic, correctly shown, appropriate scale used)	<input type="checkbox"/>	<input type="checkbox"/>	<input type="checkbox"/>	
Lettering legibility (minimum text size 0.08")	<input type="checkbox"/>	<input type="checkbox"/>	<input type="checkbox"/>	
Map title shown ("Sanitary Sewer Final Location Map")	<input type="checkbox"/>	<input type="checkbox"/>	<input type="checkbox"/>	
CLV project name shown	<input type="checkbox"/>	<input type="checkbox"/>	<input type="checkbox"/>	
CLV Hansen No. shown	<input type="checkbox"/>	<input type="checkbox"/>	<input type="checkbox"/>	
CLV Drawing No. shown	<input type="checkbox"/>	<input type="checkbox"/>	<input type="checkbox"/>	
Survey firm's company name and contact information shown	<input type="checkbox"/>	<input type="checkbox"/>	<input type="checkbox"/>	
Legend (all linetypes and symbols defined)	<input type="checkbox"/>	<input type="checkbox"/>	<input type="checkbox"/>	
Non-standard abbreviations defined	<input type="checkbox"/>	<input type="checkbox"/>	<input type="checkbox"/>	
Distances, coordinates and elevations labeled using decimal feet	<input type="checkbox"/>	<input type="checkbox"/>	<input type="checkbox"/>	
Approximate limits of streets shown (improvements or right-of-way)	<input type="checkbox"/>	<input type="checkbox"/>	<input type="checkbox"/>	
Street names labeled (identified as public or private)	<input type="checkbox"/>	<input type="checkbox"/>	<input type="checkbox"/>	

REVIEW CHECKLIST – SANITARY SEWER FINAL LOCATION MAP

REVIEW ITEM	OK	SEE R/L	N/A	COMMENTS
Sanitary Sewer Improvements Data				
Manhole Lids: (measured horizontally at centerline of lid, vertically at rim; specify diameter of lid)	<input checked="" type="checkbox"/>	<input type="checkbox"/>	<input type="checkbox"/>	
*NOTE In the case of a two-piece lid system locate outer lid only (specify diameter of outer lid).				
Manhole Barrel: (measured horizontally at centerline of structure barrel, vertical location does not apply)	<input type="checkbox"/>	<input type="checkbox"/>	<input type="checkbox"/>	
Vaults and Junction Structures: (measured horizontally at all outer extents of structure, vertically at top of structure)	<input type="checkbox"/>	<input type="checkbox"/>	<input checked="" type="checkbox"/>	
Lateral/Main/Interceptor Pipes: locate at all connections to other pipes and structures, all horizontal and vertical deflections, points of termination (stubs), point at which pipe exits the public right-of-way or easement (measured horizontally at centerline of pipe, vertically at top of pipe)	<input type="checkbox"/>	<input type="checkbox"/>	<input checked="" type="checkbox"/>	WAIVED
*NOTE All pipe connections to manholes and other structures should be located at outside face of structure before backfilling due to accuracy limitations of pipe measurements from the structure's surface access point.				
Survey Information				
Survey completion date indicated	<input checked="" type="checkbox"/>	<input type="checkbox"/>	<input type="checkbox"/>	
Statement of positional certainty (0.3' horizontally, 0.3' vertically)	<input checked="" type="checkbox"/>	<input type="checkbox"/>	<input type="checkbox"/>	
Surveyor's seal (validated and current)	<input checked="" type="checkbox"/>	<input type="checkbox"/>	<input type="checkbox"/>	
Basis of bearings and coordinate system indicated (only CLV approved coordinate systems are to be used, basis of bearings must agree with coordinate system used)	<input checked="" type="checkbox"/>	<input type="checkbox"/>	<input type="checkbox"/>	
Horizontal datum, datum adjustment, and epoch date indicated (only CLV approved datums are to be used)	<input checked="" type="checkbox"/>	<input type="checkbox"/>	<input type="checkbox"/>	
Benchmark ID, description, elevation and CLV adjustment indicated	<input checked="" type="checkbox"/>	<input type="checkbox"/>	<input type="checkbox"/>	
*NOTE Only benchmarks and benchmark elevations included in the most recent CLV Vertical Control Network adjustment are to be used, this may require using a different benchmark or benchmark elevation than shown on the improvement plans.				
Survey accuracy QA/QC (when available)	<input type="checkbox"/>	<input type="checkbox"/>	<input type="checkbox"/>	

ADDITIONAL COMMENTS