

4224

3811-1082-3
 SHEET 10 OF 10
 DATE 11/13/10
 DRAWN BY MON 1081
 CHECKED BY RBE/GAL
 NO. 3880-3

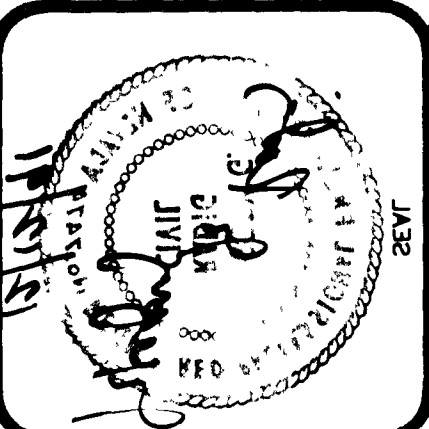

CRIMSON RIDGE - UNIT 3
 CRIMSON LEAF DRIVE & TERRA ROSA DRIVE
 OFFSITE SEWER PLAN AND PROFILE

CONSULTING ENGINEERS • PLANNERS • LAND SURVEYORS
 1725 SOUTH RAINBOW BOULEVARD
 LAS VEGAS, NEVADA 89102-2148 PHONE (702) 732-7272 FAX (702) 732-2828

APP'D	REV	DATE	BY	REASON

STATIONING: 1+00 TO 1+50
 BENCHMARK: 1+00
 ELEVATION: 5110.00
 ALL ELEVATIONS ARE IN FEET AND DECIMALS THEREOF.
 THE BENCHMARK IS A CONCRETE PIPER STAKE SET IN THE GROUND.
 THE BENCHMARK IS A CONCRETE PIPER STAKE SET IN THE GROUND.
 THE BENCHMARK IS A CONCRETE PIPER STAKE SET IN THE GROUND.

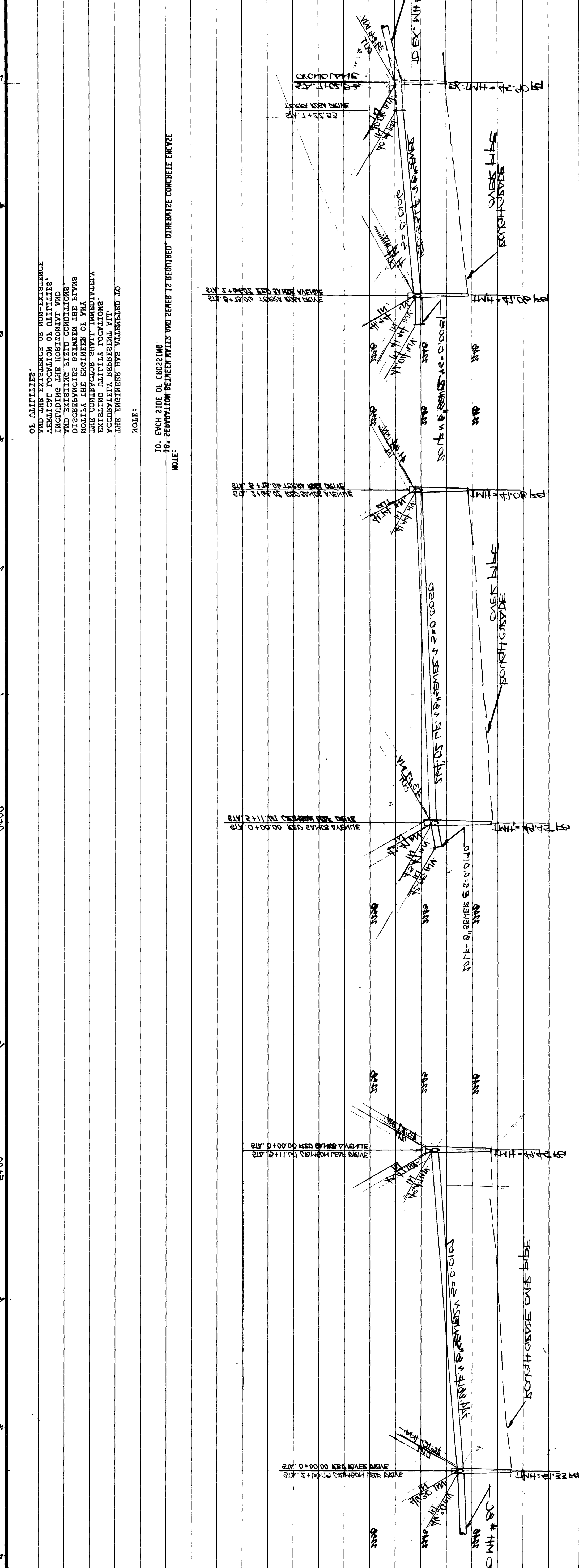
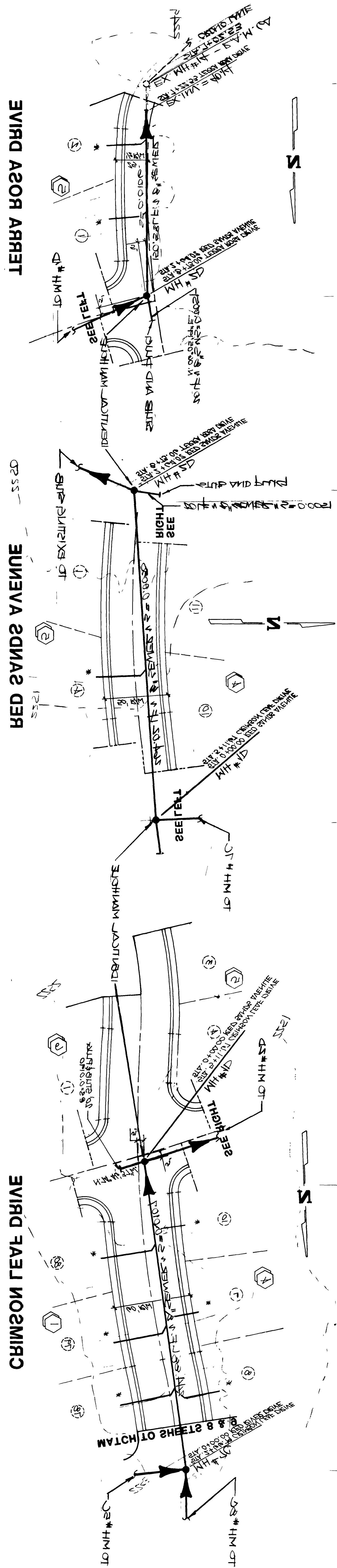

OF ALLIANCE.
 AND THE EXISTENCE OF NON-EXISTENCE
 INCLUDING THE HORIZONTAL AND
 DISCREPANCIES BETWEEN THE ETYPE
 HOLE. THE ENGINEER OF THE
 EXISTING ALLIANCE TOOLS
 ACCORDANCE HEREBY WITH
 THE ENGINEER HAS AGREED TO
 HOLE:

10. EACH SIDE OF CROSSING
 15. SEPARATION BETWEEN WELLS AND JUNCTIONS REQUIRED TO MINIMIZE CONCRETE EROSION

