

"CALLING ALL KIDS"

PRESCHOOL

SMOKE RANCH ROAD / MAVERICK STREET

FIRE DEPARTMENT NOTES

- ALL WORK SHALL BE DONE IN STRICT ACCORDANCE WITH THE CITY OF LAS VEGAS FIRE DEPARTMENT "HYDRANT SPECIFICATIONS" AND "HYDRANT INSTALLATION SPECIFICATIONS" AND ORDINANCE #3316.
- AUTHORIZED HYDRANTS FOR THIS PROJECT ARE:
 - A- KENNEDY GUARDIAN
 - B- MUELLER A-23 CENTURIAN
 - C- CLOW NODEL 2546 MEDALLION
- ON ANY NEW HOME OR BUILDING CONSTRUCTION, ACCESSIBLE FIRE HYDRANTS SHALL BE INSTALLED BEFORE COMBUSTIBLE CONSTRUCTION COMMENCES AND SAID FIRE HYDRANTS SHALL BE IN GOOD WORKING ORDER WITH AN ADEQUATE WATER SUPPLY.
- CONTRACTOR SHALL PLACE A GREEN REFLECTIVE MARKER AT CENTERLINE OF STREET ADJACENT TO FIRE HYDRANTS.
- ALL FIRE HYDRANTS MUST BE CONNECTED TO A DEPENDABLE WATER SUPPLY CAPABLE OF SUPPLYING THE REQUIRED FIRE FLOW. CALL THE LAS VEGAS FIRE DEPARTMENT AT 383-2888 FOR UNDERGROUND INSPECTION, PRESSURE AND FLUSH VERIFICATION OF ALL FIRE HYDRANTS AND FIRE LINES BEFORE COVERING.
- PAINTING OF THE CURBS AND HYDRANT AND ANY WORK NECESSARY FOR PROTECTION OF HYDRANTS FROM PHYSICAL DAMAGE PER THE "HYDRANT INSTALLATION SPECIFICATIONS" SHALL BE COMPLETED BEFORE APPROVAL OF THE HYDRANTS BY THE CITY OF LAS VEGAS FIRE DEPARTMENT.
- LAS VEGAS VALLEY WATER DISTRICT TO DETERMINE THAT HYDRANTS ARE CONNECTED TO A WATER SUPPLY CAPABLE OF SUPPLYING THE REQUIRED FIRE FLOW.
- FIRE HYDRANT SPACING:
 - RESIDENTIAL 600 FT. MAXIMUM
 - COMMERCIAL 500 FT. MAXIMUM
 FIRE HYDRANTS SHALL BE LOCATED WITHIN 500 FT. OF ANY CONSTRUCTION OR COMBUSTIBLE OPEN STORAGE, AND SHALL BE INSTALLED PRIOR TO CONSTRUCTION.
- NO FIRE HYDRANT SHALL BE LOCATED WITHIN 6' OF AND CURB RETURN, DRIVEWAY, POWER POLE, STREETLIGHT, OR ANY OTHER OBSTRUCTION.
- NO FIRE HYDRANT SHALL BE LOCATED WITHIN THE REQUIRED RADIUS OF A CUL-DE-SAC OR WITHIN 20' OF THE PERIMETER OF THE RADIUS OF THE CUL-DE-SAC.
- A PERMIT MUST BE OBTAINED FROM THE FIRE DEPARTMENT FOR ONSITE FIRE WATER SYSTEM INSTALLATION PRIOR TO CONSTRUCTION.

SEWER NOTES

- ALL SANITARY SEWER INSTALLATIONS SHALL CONFORM TO THE STANDARD DETAILS AND SPECIFICATIONS OF THE CITY OF LAS VEGAS AND SHALL ALSO CONFORM TO THE UNIFORM STANDARD SPECIFICATIONS FOR THE PUBLIC WORKS CONSTRUCTION FOR OFF-SITE IMPROVEMENTS, CLARK COUNTY AREA, LATEST EDITION, UNLESS OTHERWISE NOTED.
- CHISEL "S" OR "G" IN CURBS WHERE SEWER OR GAS LATERAL PASS UNDER THE CURB.
- POLYVINYL CHLORIDE (PVC) SEWER PIPE SHALL MEET ASTM D-3034 SDR35 SPECIFICATIONS AND INSTALLED WITH SAND BEDDING AND BACKFILL OR TYPE II GRAVEL.
- ALL MANHOLES IN PAVED STREETS 80' R/W AND LARGER, SHALL HAVE CONCRETE COLLARS.
- TEE SADDLES SHALL BE USED TO CONNECT SEWER LATERALS TO EXISTING MAIN LINES UP TO 12" DIAMETER SIZE; CONNECTIONS TO 15" OR LARGER MAINS SHALL REQUIRE SPECIAL PROCEDURES.

ON-SITE WATER NOTES

- ALL ON-SITE WATER MAINS SHALL BE ACP CLASS 150 PAST LAS VEGAS VALLEY WATER DISTRICT VAULT AND METER.
- THE ON-SITE WATER SYSTEM SHALL FOLLOW THE LAS VEGAS VALLEY WATER DISTRICT STANDARDS FOR PIPE INSTALLATIONS.
- SEE LANDSCAPING PLAN FOR IRRIGATION SERVICE STUB LOCATIONS.

OFF-SITE WATER NOTES

- ALL WORK TO CONFORM TO LAS VEGAS VALLEY WATER DISTRICT STANDARD PLATES AND SPECIFICATIONS.
- ALL WORK, EXCEPT AS MODIFIED HEREON OR BY NOTE NO. 1, SHALL BE DONE IN ACCORDANCE WITH THE MOST CURRENT DRAFT OR EDITION OF UNIFORM STANDARD SPECIFICATIONS FOR PUBLIC WORKS CONSTRUCTION OFF-SITE IMPROVEMENTS, CLARK COUNTY, NEVADA.
- NOTICE TO BE GIVEN ENGINEERING DEPARTMENT OF THE LAS VEGAS VALLEY WATER DISTRICT 48 HOURS PRIOR TO ACTUAL CONSTRUCTION.
- ALL LINES TO BE PRESSURE TESTED TO 200 P.S.I.
- DEFLECTION ANGLE SHALL NOT EXCEED 2.5 DEGREES PER 13 FOOT SECTION OF PIPE FOR PIPE SIZES SMALLER THAN 14 INCHES AND SHALL NOT EXCEED 2 DEGREES FOR PIPE SIZES BETWEEN 14 INCHES AND 16 INCHES.
- CALL BEFORE YOU DIG: 1-800-227-2600
- SERVICE SADDLES OR TAPPED COLLARS WILL BE REQUIRED ON ALL 3/4" AND 1" SERVICE LATERALS. SERVICE SADDLES ONLY WILL BE PERMITTED ON 1-1/2" AND 2" SERVICE LATERALS. DOUBLE TAPPED COLLARS ARE NOT PERMITTED.
- ALL METERS SHALL BE LOCATED OUTSIDE OF DRIVEWAYS.
- DETECTOR TAPE REQUIRED IN ACCORDANCE WITH STANDARD PLATE NO. 27 WHERE INDICATED AND AS FOLLOWS:
 - A. OVER ALL MAINS NOT INSTALLED AT 6 FEET FROM BACK OF CURB.
 - B. OVER ALL SERVICE LATERALS NOT INSTALLED AT RIGHT ANGLES TO MAINS.

SHEET INDEX

- COVER SHEET
- PILOT PLAN
- UTILITY PLAN
- GRADING PLAN
- DETAIL SHEET

TRAFFIC NOTES

- BEFORE ANY WORK IS STARTED IN THE RIGHT-OF-WAY, THE CONTRACTOR SHALL INSTALL ALL ADVANCE WARNING SIGNS FOR THE CONSTRUCTION ZONE. THE CONTRACTOR SHALL INSTALL TEMPORARY STOP SIGNS AT ALL NEW STREET ENCROACHMENTS INTO EXISTING CITY STREETS IMMEDIATELY AFTER FIRST GRADING WORK IS ACCOMPLISHED.
- ALL CONSTRUCTION SIGNING, BARRICADING AND TRAFFIC DELINEATION SHALL CONFORM TO THE "NEVADA WORK ZONE TRAFFIC CONTROL HANDBOOK - 1985" AND THE "MANUAL OF UNIFORM TRAFFIC CONTROL DEVICES - 1978, REVISION NO. 4, MARCH 1986".
- IF THE IMPROVEMENTS NECESSITATE THE OBLITERATION, TEMPORARY OBSTRUCTION, TEMPORARY REMOVAL OR RELOCATION OF ANY EXISTING TRAFFIC PAVEMENT MARKING, SUCH PAVEMENT MARKING SHALL BE RESTORED OR REPLACED WITH LIKE MATERIALS TO THE SATISFACTION OF THE CITY TRAFFIC ENGINEER.
- THE DEVELOPERS SHALL BE RESPONSIBLE TO PROVIDE AND INSTALL ALL PERMANENT SIGNS SHOWN ON THE PLANS. STREET NAME SIGNS SHALL CONFORM IN THEIR ENTIRETY TO CLV STANDARDS. ALL OTHER SIGN POSTS SHALL BE INSTALLED IN ACCORDANCE WITH CLV STANDARDS.
- IF A PROPOSED STREETLIGHT STANDARD IS FIELD LOCATED TO WITHIN FIVE (5) FEET OF ANY SIGN SHOWN HEREON TO BE MOUNTED ON A SIGN POST, THEN CHANGE SIGN MOUNTING TO ONE ON THE STREETLIGHT STANDARD.
- ALL PERMANENT TRAFFIC CONTROL DEVICES CALLED FOR HEREON SHALL BE IN PLACE AND IN FINAL POSITION PRIOR TO ALLOWING ANY PUBLIC TRAFFIC ONTO THE PORTIONS OF THE ROAD(S) BEING IMPROVED HEREUNDER, REGARDLESS OF THE STATUS OF COMPLETION OF PAVING OR OTHER OFF-SITE IMPROVEMENTS CALLED FOR BY THESE PLANS.

APPROVALS

<i>Ra-lue Ouelson</i>	3/29/89
NEVADA POWER COMPANY	DATE
<i>Thomas D. Vase</i>	3/29/89
SOUTHWEST GAS COMPANY	DATE
<i>Nyle Smith</i>	3/28/89
CENTEL	DATE
<i>SEE SHEET 3</i>	
LAS VEGAS VALLEY WATER DISTRICT	DATE
<i>Charles Smith</i>	4/11/89
CLV CITY ENGINEER	DATE
<i>Edwin Montoya</i>	4/5/89
CLV FIRE DEPARTMENT	DATE

LAS VEGAS FIRE DEPARTMENT

FIRE FLOW REQUIREMENTS ARE 1500 GALLONS PER MINUTE AT 20 POUNDS PER SQUARE INCH RESIDUAL.

BASED ON: 7295 SQ.FT.

SQUARE FOOTAGE 7295 SQ.FT.

LARGEST AREA BETWEEN AREA SEPARATION WALLS 7295 SQ.FT.

HEIGHT ONE STORY

TYPE OF CONSTRUCTION TYPE V-N

EXPOSURES 35'N, 50'W, 150'S, 150'E

SPRINKLER SYSTEM YES

OCCUPANCY LOW HAZARD

ROOF CONSTRUCTION TILE

REVIEWED BY _____

DATE _____

GENERAL NOTES

- ALL CONSTRUCTION AND MATERIALS SHALL BE IN ACCORDANCE WITH THE UNIFORM STANDARD SPECIFICATIONS FOR PUBLIC WORKS CONSTRUCTION OFF-SITE IMPROVEMENTS, CLARK COUNTY AREA NEVADA, LATEST EDITION. THE "UNIFORM STANDARD DRAWINGS FOR PUBLIC WORKS CONSTRUCTION, CITY OF LAS VEGAS," ANY OTHER APPLICABLE APPROVED STANDARDS ISSUED BY THE CONTROLLING AGENCY, THE UNIFORM BUILDING CODE, AND ALL LOCAL CITY CODES AND ORDINANCES APPLICABLE.
- THE EXISTENCE AND LOCATION OF ANY UNDERGROUND UTILITY PIPES OR STRUCTURES SHOWN ON THESE PLANS ARE OBTAINED BY A SEARCH OF THE AVAILABLE RECORDS. THE CONTRACTOR IS REQUIRED TO TAKE PRECAUTIONARY MEASURES TO PROTECT THE UTILITY LINES SHOWN AND ANY OTHER LINES NOT OF RECORD OR NOT SHOWN ON THESE DRAWINGS. EXISTING UTILITIES ARE LOCATED ON PLANS ONLY FOR THE CONVENIENCE OF THE CONTRACTOR. EXISTING UTILITY SERVICE LATERALS ARE NOT SHOWN ON THE PLANS.
- THE CONTRACTOR SHALL TAKE ALL PRECAUTIONARY MEASURES NECESSARY TO PROTECT EXISTING IMPROVEMENTS WHICH ARE TO REMAIN IN PLACE, FROM DAMAGE, AND ALL SUCH IMPROVEMENTS OR STRUCTURES DAMAGED BY THE CONTRACTOR'S OPERATIONS SHALL BE REPAIRED OR RECONSTRUCTED SATISFACTORY TO THE OWNER AT THE EXPENSE OF THE CONTRACTOR.
- THE CONTRACTOR SHALL NOT BACKFILL ANY TRENCHES IN WHICH WATERLINES HAVE BEEN UNCOVERED UNTIL THE WATERLINES HAVE BEEN INSPECTED BY THE LAS VEGAS VALLEY WATER DISTRICT. THE WATER DISTRICT SHALL BE NOTIFIED 48 HOURS IN ADVANCE OF CONSTRUCTION IN THE VICINITY OF WATER LINES.
- ALL CONSTRUCTION SHALL BE AS SHOWN ON THESE PLANS, ANY ALTERATIONS SHALL HAVE THE PRIOR WRITTEN APPROVAL OF THE CITY ENGINEER.
- TYPE V CEMENT SHALL BE USED IN ALL OFF-SITE CONCRETE WORK. CONCRETE TO BE DESIGNED FOR A 5.5 SACK MIX WITH A MAXIMUM WATER/CEMENT RATIO OF 0.45 (OR AS DESIGNED BY THE SOILS ENGINEER). MIX DESIGN TO BE APPROVED BY THE QUALITY CONTROL DIVISION PRIOR TO USE ON THE PROJECT.
- THE CONTRACTOR SHALL, AT HIS EXPENSE, LOCATE ALL OVERHEAD INTERFERENCES WHICH MAY AFFECT HIS OPERATION DURING CONSTRUCTION AND SHALL TAKE ALL NECESSARY PRECAUTIONS TO AVOID DAMAGE TO SAME. THE CONTRACTOR SHALL USE EXTREME CAUTION WHEN WORKING NEAR OVERHEAD OR UNDERGROUND POWER AND/OR TELEPHONE FACILITIES SO AS TO SAFELY PROTECT ALL PERSONNEL AND EQUIPMENT, AND SHALL BE RESPONSIBLE FOR ALL COST AND LIABILITY IN CONNECTION THEREWITH.
- PERMITS ARE REQUIRED FOR ANY WORK IN THE PUBLIC RIGHT-OF-WAY REQUIRED FOR THIS CONSTRUCTION.
- EXPANSION JOINTS REQUIRED, MAXIMUM EVERY 300' IN EXTRUDED TYPE CURB.
- A.C. PAVEMENT TO BE 1/2" ABOVE LIP OF ALL GUTTERS AND VALLEY GUTTER AFTER COMPACTION.
- APPLY FOG SEAL ONLY AFTER CORRECTIONS AND ADJUSTMENTS HAVE BEEN MADE.
- CURB AND GUTTER WITH A GRADE OF LESS THAN FOUR TENTHS OF ONE PERCENT SHALL BE CONSTRUCTED BY FORMING. EACH JOINT SHALL BE CHECKED FOR GRADE PRIOR TO CONSTRUCTION AND WATER TESTED AS SOON AS POSSIBLE AFTER CONSTRUCTION.
- WHEELCHAIR RAMPS SHALL BE CONSTRUCTED IN EACH QUADRANT OF AN INTERSECTION PER STANDARD DRAWING 235. EXACT LOCATION OF RAMPS MAY BE ADJUSTED IN THE FIELD BY A CITY INSPECTOR.
- CONTRACTOR SHALL PROVIDE ALL NECESSARY HORIZONTAL AND VERTICAL TRANSITIONS BETWEEN NEW CONSTRUCTION AND EXISTING SURFACES TO PROVIDE FOR PROPER DRAINAGE AND FOR INGRESS AND EGRESS TO SAID CONSTRUCTION. EXTENT OF TRANSITION TO BE AS SHOWN ON PLANS.
- ALL GRADING WORK SHALL CONFORM TO THE SOILS REPORT AS PREPARED BY THE SOILS ENGINEER OR PER THESE PLANS.
- EXACT LOCATION OF ALL SAWCUT LINES MAY BE DETERMINED IN THE FIELD BY A CITY OF LAS VEGAS INSPECTOR IF LOCATION OF PLANS IS NOT CLEARLY SHOWN, OR EXISTING PAVEMENT CONDITIONS REQUIRES LOCATION.
- THE CONTRACTOR SHALL TAKE ALL PRECAUTIONS NECESSARY TO PROTECT EXISTING PERMANENT SURVEY MONUMENTS. ANY MONUMENTS DISTURBED SHALL BE REPLACED AND ADJUSTED PER AVAILABLE RECORDS IN ACCORDANCE WITH N.R.S. STATUTE NO. 625.550.

UTILITY NOTE

UTILITY LOCATIONS SHOWN HEREON ARE APPROXIMATE ONLY. IT SHALL BE THE CONTRACTOR'S RESPONSIBILITY TO DETERMINE THE EXACT VERTICAL AND HORIZONTAL LOCATION OF ALL EXISTING UNDERGROUND UTILITIES PRIOR TO COMMENCING CONSTRUCTION. NO REPRESENTATION IS MADE THAT ALL EXISTING UTILITIES ARE SHOWN HEREON. THE ENGINEER ASSUMES NO RESPONSIBILITY FOR UTILITIES NOT SHOWN OR UTILITIES NOT SHOWN IN THEIR PROPER LOCATION.

CALL BEFORE YOU DIG: 1-800-227-2600

Call before you Dig

1-800-227-2600
UNDERGROUND SERVICE (USA)

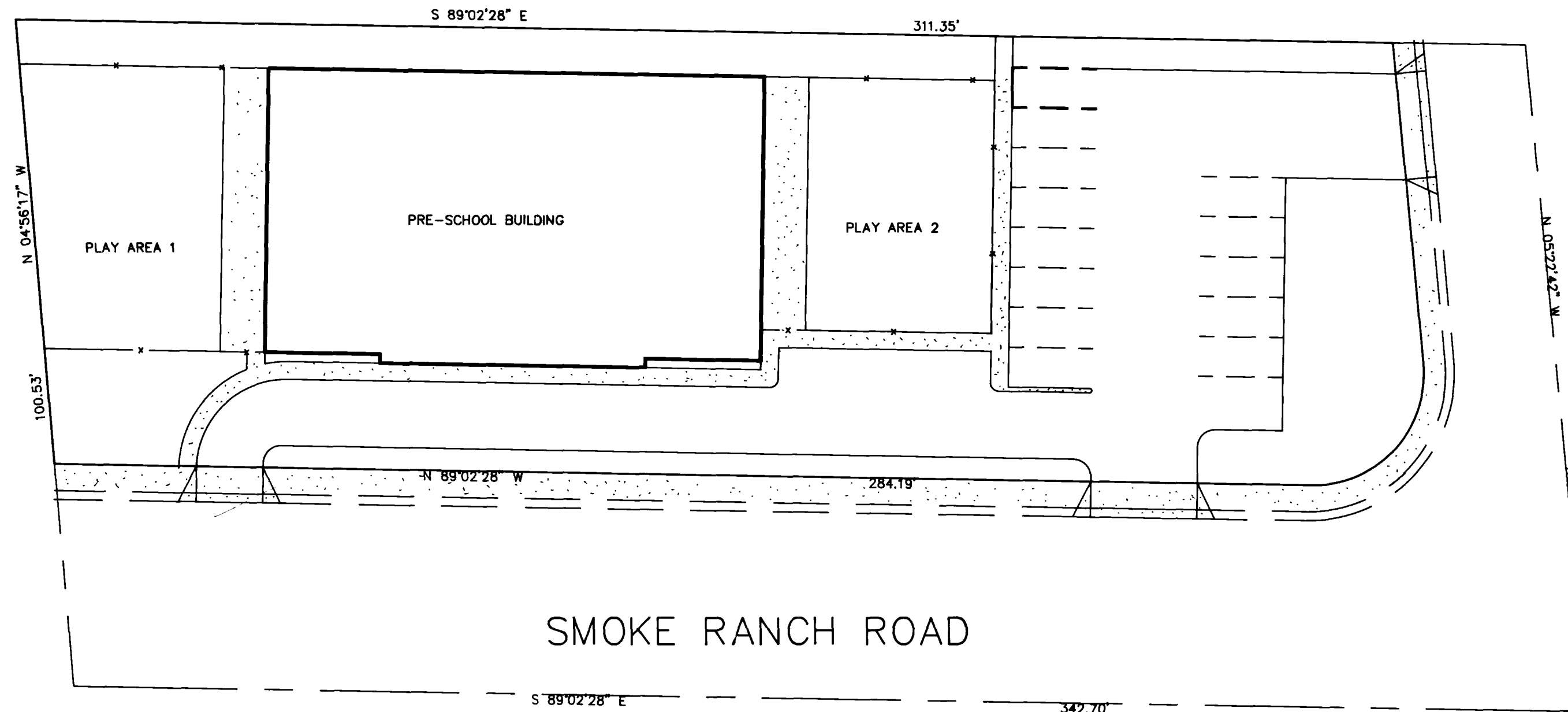

REVISIONS	No.	Date	Description

Edwin Montoya
CLV CITY ENGINEER

PREPARED FOR:
CARPENTER/SELLERS
ARCHITECTS

DESIGNED:
DRAWN:
CHECKED:
SCALE: HORIZ -
VERT -

1500 EAST TROPICANA AVENUE
SUITE 125
LAS VEGAS, NEVADA 89119
(702) 798-1007

MEA
CONSULTING ENGINEERS

CALLING ALL KIDS
COVER SHEET

SHEET
1
OF
5

17-3-41

107-V1655

