

CLARIFICATION NOTE:

- ⚠ WHERE IRRIGATION PULLBOX OR ELECTRICAL PULLBOX FALL IN CURB LINE, REFERENCE DETAIL "E" ON DETAIL SHEET DET. SHEET DET.
- ⚠ WHERE STORM DRAIN DROP INLET FALL IN CURB LINE, REFERENCE DETAIL "F" ON DETAIL SHEET DET.
- ⚠ FG OF FIELD REPRESENTS BASE OF SYNTHETIC TURF (TOP OF SAND).

UTILITY DISCLAIMER:

ALL EXISTING UTILITY LOCATIONS SHOWN HEREON ARE APPROXIMATE ONLY. IT SHALL BE THE CONTRACTORS RESPONSIBILITY TO DETERMINE THE EXACT VERTICAL AND HORIZONTAL LOCATION OF ALL EXISTING UNDERGROUND UTILITIES PRIOR TO COMMENCING CONSTRUCTION.

NO REPRESENTATION IS MADE THAT ALL UTILITIES ARE SHOWN HEREON. THE ENGINEER ASSUMES NO RESPONSIBILITY FOR UTILITIES NOT SHOWN IN THEIR PROPER LOCATION.

THE DEPTH BELOW GRADE OF THE VARIOUS UTILITIES DEPICTED ON THE PLANS VARIES THROUGHOUT THE PROJECT AREA. THE CONTRACTOR SHALL EXERCISE EXTREME CARE WHERE EXCAVATING AND GRADING THE SUBBASE IN THE VICINITY OF UTILITIES TO AVOID DAMAGE TO THE LATTER.

CALL BEFORE CONSTRUCTION ⚠

BEFORE YOU DIG	USA NORTH	811 OR 800-227-2600
	F.A.S.T.	702-432-5300
BEFORE YOU UNDERGROUND	CLARK COUNTY TRAFFIC OPERATIONS	702-455-7511
	CITY OF LAS VEGAS T.E.F.O.	702-229-6611
BEFORE YOU OVERHEAD	NV ENERGY	702-227-2929

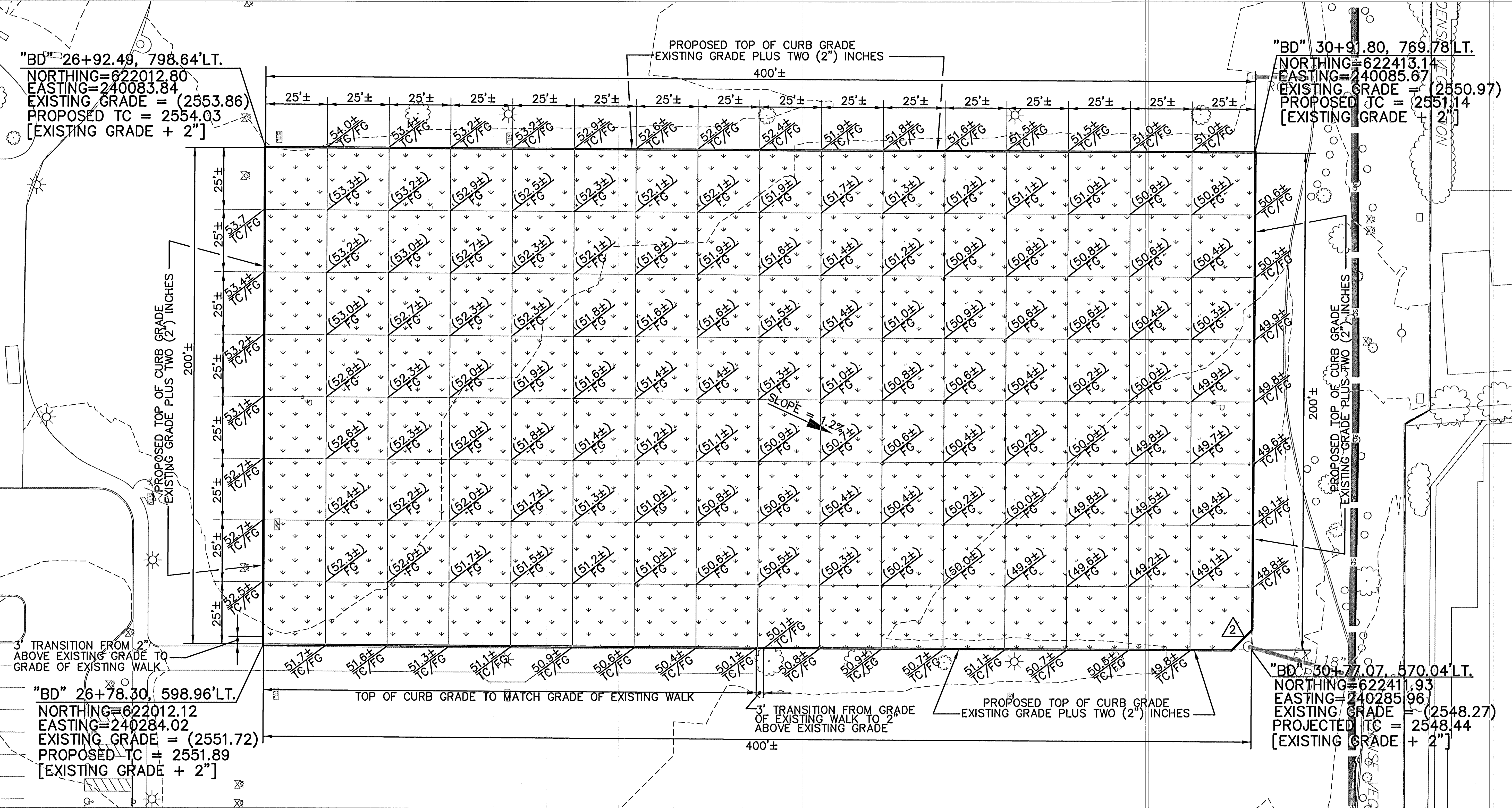
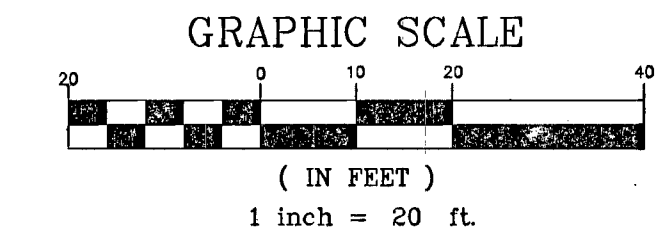

3/12/13 F:\DEPOT\CITY_ENG\DESIGN\DESIGN VALL AMERICAN PARK_45161\DWG1.DWG: DESIGN DESIGN ALLAMERICANPARK100.DWG

 PREPARED BY CITY OF LAS VEGAS BID# 13-45161 DESIGNED BY: GJJ DATE: MARCH 2013 DRAWN BY: GJJ CHECKED BY: RMM SUBMITTAL STAGE: 100% - FINAL	DEPARTMENT OF PUBLIC WORKS CAPITAL PROJECT MANAGEMENT	NO. DATE REVISIONS		
TITLE SHEET ALL AMERICAN PARK IMPROVEMENTS GRADING PLAN FIELD 4				
SHEET FLD4 7 of 24 DRAWING NO. 650.62-1				