

TWENTY - FIFTH STREET

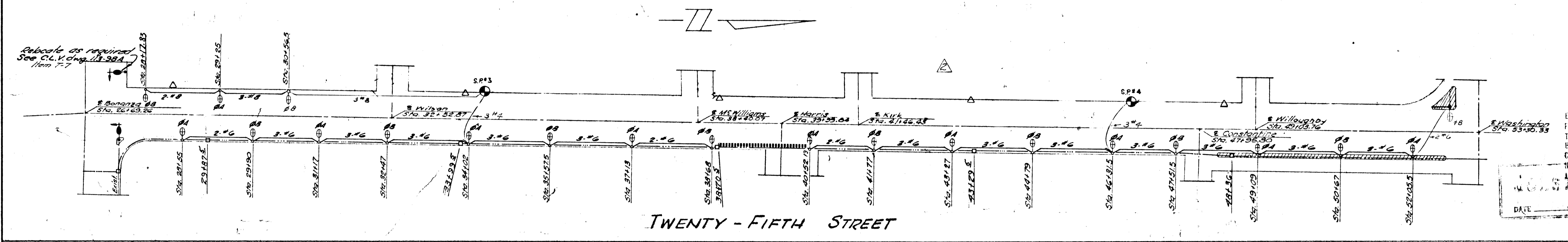

TWENTY - FIFTH STREET

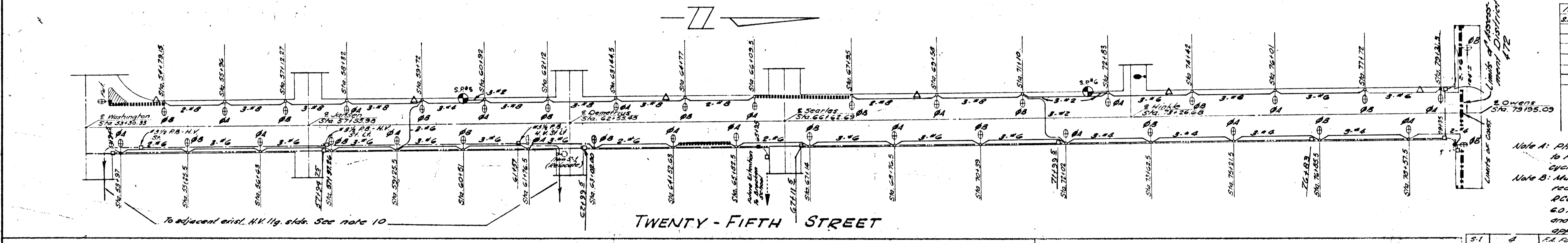

TWENTY - FIFTH STREET

EXISTING UTILITIES ARE LOCATED ON THE PLANS FOR THE CONVENIENCE OF THE CONTRACTOR ONLY. THE CONTRACTOR SHALL BEAR FULL RESPONSIBILITY FOR THE LOCATION OF UTILITIES AND THE CITY ENGINEER'S OFFICE SHALL NOT BE RESPONSIBLE FOR UTILITIES NOT SHOWN ON THE PLANS OR NOT IN THE LOCATION SHOWN ON THE PLANS.

DATE FEB 20 1967

| SERVICE POINTS | | | |
|----------------|------------|------------|---------|
| SP# | # of Phase | # of Phase | Total |
| 1 | 2800 W. | 2800 W. | 5600 W. |
| 2 | 2400 W. | 2800 W. | 5200 W. |
| 3 | 2000 W. | 2400 W. | 4400 W. |
| 4 | 2000 W. | 2000 W. | 4000 W. |
| 5 | 4000 W. | 3600 W. | 7600 W. |
| 6 | 3600 W. | 4000 W. | 7600 W. |

Note A: Photo cell relay control to be similar to Fisher-Pierce Mod. #6620-A, 120V, 60 cycle, D.R.S.T. or approved equal.

Note B: Multi street lg. relay w/ photo electric receptacle to be similar to Westinghouse R200 type MRUG spec. #6388. 2 pole N.A. 60 Amp 120/240V A.C. w/ 120V A.C. coil and w/ holes A+B for 1/4" conduit or approved equal.

The Street Lighting, Fire Alarm, Traffic Signal and Interconnect System as called for on the applicable plans must conform as to material, workmanship and installation to Section 400 and 405 and any other applicable sections of the Uniform Standard Specifications and the Special Provisions of this contract.

Change Order No. 1 Deleted 14 Street Light Standards and associated conduit Sta. 30+57 to 30+63

GENERAL NOTES

- All 11 gauge street lighting standards shall be 18 inches back of curb. All 7 gauge street lighting standards shall be 24 inches back of curb.
- The locations of ends of all conduits in structures or terminating at curbs shall be marked by a "+" at least 3" high cut into the face of curb, gutter, or wall, directly above conduit.
- Conduits shall be laid to a depth of not less than 18 inches below the curb grade in sidewalk areas and to a depth of not less than 24 inches below the finished surface in street areas, except that conduit may be laid to a depth of not less than 18 inches below the curb grade in curbed dividing strips.
- All conduits for future use shall be cleaned, blown-out with compressed air and provided with a #9 AWG galvanized iron pull wire, 2 feet of pull wire shall be doubled back into conduit at each termination and the end of the conduit shall be capped.
- Lighting system to be 120/240 volt 60 cycle single phase 3 wire multiple underground. Luminaires to be connected alternately to phase circuit "A" or "B" as indicated.
- BASE COVERS FOR LIGHTING STANDARDS ARE NOT TO BE INSTALLED BEFORE BREAKOUT CAPS ARE PLACED AND INSPECTED. ALL MATERIAL USED IN UNDERGROUND WIRING, IN BREAKOUT CAPS AND UNDER BASE COVERS TO BE INSPECTED BEFORE INSTALLATION.
- All conduits at limits of construction shall be stubbed, capped and located for future extension of conduit runs and "As Built" marked prints returned to the Electrical Engineer.
- For details of traffic intersections at Bonanza, Washington, Owens, see dwg. US 10092 / 10093
- City forces to disconnect all existing high voltage lighting circuits and contractor is to remove and deliver to City Yards all STD's electrical material under the direction of the City Electrician.
- City forces to provide 6.6 amp series loop tie for disconnected H.V. lighting circuits on 25th Street.

LEGEND

- 1/4" Conduit only.
- 400 watt Mercury Vapor Luminaire I.E.S. Type III Distribution
- Existing Conduit (Do not remove)
- Existing Light Standard with Luminaire (Do not remove)
- 7 gauge Street Lighting Standard
- 11 gauge Street Lighting Standard
- Underground Fire Alarm Conduit 1/4" Traffic Control Interconnect * 5 Pull Box, spaced 480 ft. apart.
- Pull Box # 3/4 Fire Alarm
- Foundation to be 48" deep
- Foundation to be 60" deep
- Denotes numbered service point
- Indicates phase circuit
- 14" Conduit in dirt 24" minimum cover
- 14" Conduit in front of curb 24" minimum cover
- 14" Conduit in back of curb 18" minimum cover
- 14" Conduit in roadway 24" minimum cover (Boring)
- Indicates wire size of lighting circuit
- Underground 1/4" H.V. Ltg. conduit for 6.6 Amp. ser. lg. cir.

Approvals

[Signature] Nevada Power Company Date 2-1-66

[Signature] Traffic Engineer Date 2-22-66

[Signature] City Electrician Date

| | | |
|-----|----------|---|
| F-1 | 2 | 24" Foundation w/ 1/4" sig. std., cable, install, & remove |
| F-2 | 1 | # 3/4 Pull Box for Traffic Control |
| F-5 | 8263 ft. | 2" Conduit for Traffic Signal Interconnect |
| T-4 | 100 ft. | 1 1/2" Conduit for Traffic Control |
| F-3 | 3053 ft. | 1" Conduit for Traffic Control |
| T-2 | 1 | # 7 Pull Box for Traffic Control |
| F-1 | 24 | # 5 Pull Box for Traffic Control |
| F-2 | 8200 ft. | 1 1/2" Conduit installed for Fire Alarm System |
| F-1 | 22 | # 3/4 Pull Box marked F.A. Complete Installed |
| L-9 | 5 | 24" Trenching - Symbol T-9. 24" Trenching - Symbol T-9. 24" Trenching - Symbol T-9. 24" Trenching - Symbol T-9. 24" Trenching - Symbol T-9. |
| L-8 | 5 | 24" Trenching - Symbol T-8. 24" Trenching - Symbol T-8. 24" Trenching - Symbol T-8. 24" Trenching - Symbol T-8. 24" Trenching - Symbol T-8. |
| L-7 | 5 | 24" Trenching - Symbol T-7. 24" Trenching - Symbol T-7. 24" Trenching - Symbol T-7. 24" Trenching - Symbol T-7. 24" Trenching - Symbol T-7. |
| L-6 | 5 | 24" Trenching - Symbol T-6. 24" Trenching - Symbol T-6. 24" Trenching - Symbol T-6. 24" Trenching - Symbol T-6. 24" Trenching - Symbol T-6. |
| L-5 | 5 | 24" Trenching - Symbol T-5. 24" Trenching - Symbol T-5. 24" Trenching - Symbol T-5. 24" Trenching - Symbol T-5. 24" Trenching - Symbol T-5. |
| L-4 | 5 | 24" Trenching - Symbol T-4. 24" Trenching - Symbol T-4. 24" Trenching - Symbol T-4. 24" Trenching - Symbol T-4. 24" Trenching - Symbol T-4. |
| L-3 | 1130 | 24" Trenching - Symbol T-3. 24" Trenching - Symbol T-3. 24" Trenching - Symbol T-3. 24" Trenching - Symbol T-3. 24" Trenching - Symbol T-3. |
| L-2 | 1130 | 24" Trenching - Symbol T-2. 24" Trenching - Symbol T-2. 24" Trenching - Symbol T-2. 24" Trenching - Symbol T-2. 24" Trenching - Symbol T-2. |
| L-1 | 1051 | 24" Trenching - Symbol T-1. 24" Trenching - Symbol T-1. 24" Trenching - Symbol T-1. 24" Trenching - Symbol T-1. 24" Trenching - Symbol T-1. |

CITY OF LAS VEGAS NEVADA
ENGINEERING DEPT.

STREET LIGHTING & FIRE ALARM SYSTEM
25th Street - Stewart Ave. to Owens Ave.
S.A.D. 472

| DES. | DATE | SC. NO. | 1" = 100' |
|-----------------------------|---------|-------------|-----------|
| DR. G.W. Evans, Elect. Eng. | 3-31-66 | SC. NO. | |
| DR. Sid Gibson | 3-31-66 | P. NO. | |
| CKD. [Signature] | 3-18-66 | P.O. NO. | 110.751 |
| APPROVED BY CITY ENGR. | | DRAWING NO. | |
| <i>[Signature]</i> | 11/2/66 | 107-116 | 20030 |