

COLEMAN HOMES AT DESERT SHORES UNIT NO. 1

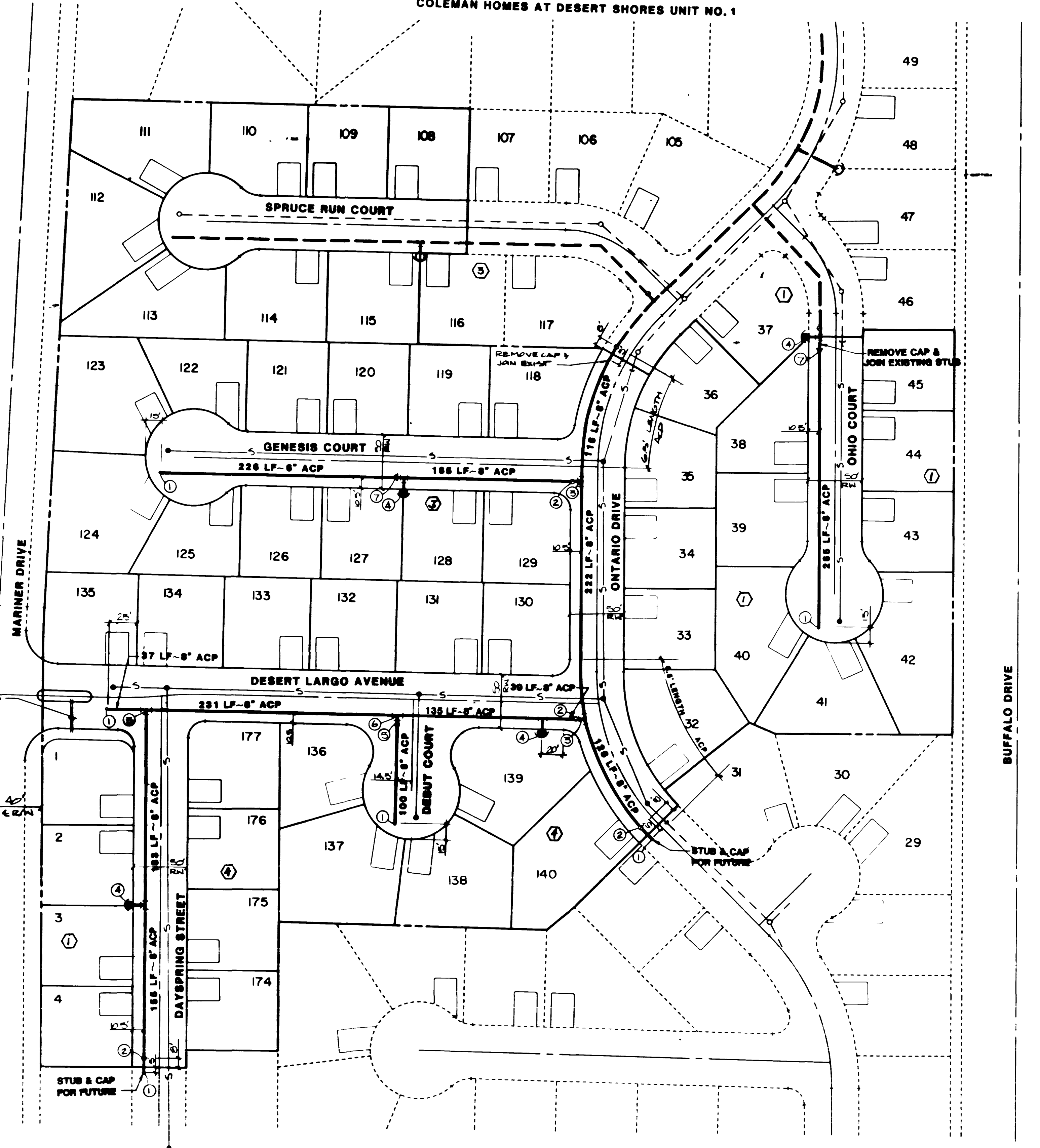

FUTURE "COLEMAN HOMES AT DESERT SHORES UNIT NO. 3"

LAS VEGAS VALLEY WATER DISTRICT NOTES

- 1 ALL WORK TO CONFORM TO LAS VEGAS VALLEY WATER DISTRICT LATEST STANDARD PLATES AND SPECIFICATIONS.
- 2 ALL WORK, EXCEPT AS MODIFIED HEREON OR BY NOTE 1, SHALL BE DONE IN ACCORDANCE WITH THE MOST CURRENT DRAFT OR EDITION OF UNIFORM STANDARD SPECIFICATIONS FOR PUBLIC WORKS CONSTRUCTION OFF-SITE IMPROVEMENTS CLARK COUNTY AREA.
- 3 NOTICE TO BE GIVEN TO THE ENGINEERING DEPARTMENT OF THE LAS VEGAS VALLEY WATER DISTRICT 48 HOURS PRIOR TO ACTUAL CONSTRUCTION.
- 4 SERVICE SADDLES OR TAPPED COLLARS WILL BE REQUIRED ON ALL 3/4" AND 1" SERVICE LATERALS. SERVICE SADDLES ONLY WILL BE PERMITTED ON 1 1/2" AND 2" SERVICE LATERALS. DOUBLE TAPPED COLLARS ARE NOT PERMITTED.
- 5 ALL LINES TO BE PRESSURE TESTED TO 200 PSI.
- 6 DEFLECTION ANGLE SHALL NOT EXCEED 2 1/2 DEGREES PER 13 FOOT SECTION OF PIPE FOR PIPE SIZES SMALLER THAN 14 INCHES, AND SHALL NOT EXCEED 2 DEGREES FOR PIPE SIZES BETWEEN 14" AND 18".
- 7 ALL METERS SHALL BE LOCATED OUTSIDE OF DRIVEWAYS.
- 8 DETECTOR TAPE REQUIRED IN ACCORDANCE WITH STANDARD PLATE NO. 27 WHERE INDICATED AND AS FOLLOWS:
A - OVER ALL MAINS NOT INSTALLED AT 6 FEET FROM BACK OF CURB
B - OVER ALL SERVICE LATERALS NOT INSTALLED AT RIGHT ANGLES TO MAINS
- 9 CALL BEFORE YOU DIG - 1-800-227-2600

CITY OF LAS VEGAS FIRE DEPARTMENT NOTES

- 1 ALL WORK SHALL BE DONE IN STRICT ACCORDANCE WITH THE CITY OF LAS VEGAS FIRE DEPT. "HYDRANT INSTALLATION SPECIFICATIONS", AND ORDINANCE #3318.
- 2 AUTHORIZED HYDRANTS FOR THIS PROJECT ARE:
A - KENNEDY GUARDIAN
B - MUELLER A-423 CENTURION
C - CLOW MODEL 2546 MEDALLION
- 3 ON ANY NEW HOME OR BUILDING CONSTRUCTION, ACCESSIBLE FIRE HYDRANTS SHALL BE INSTALLED BEFORE COMBUSTIBLE CONSTRUCTION COMMENCES AND SAID FIRE HYDRANTS SHALL BE IN GOOD WORKING ORDER WITH AN ADEQUATE WATER SUPPLY.
- 4 CONTRACTOR SHALL PLACE A GREEN REFLECTIVE MARKER AT CENTERLINE OF STREET ADJACENT TO FIRE HYDRANTS.
- 5 A FLOW TEST MUST BE WITNESSED BY THE FIRE DEPARTMENT FOR VERIFICATION OF ON-SITE WATER SUPPLY.
- 6 PAINTING OF THE CURBS AND HYDRANT AND ANY WORK NECESSARY FOR PROTECTION OF HYDRANTS FROM PHYSICAL DAMAGE PER ORDINANCE #3318 SHALL BE COMPLETED BEFORE APPROVAL BY THE CITY OF LAS VEGAS FIRE DEPARTMENT.
- 7 FIRE HYDRANT SPACING:
RESIDENTIAL 600 FT. MAXIMUM
COMMERCIAL 500 FT. MAXIMUM.
FIRE HYDRANTS SHALL BE LOCATED WITHIN 500 FT. OF ANY CONSTRUCTION OR COMBUSTIBLE OPEN STORAGE.
- 8 NO FIRE HYDRANT SHALL BE LOCATED WITHIN 6' OF ANY CURB RETURN, DRIVEWAY, POWER POLE, STREET LIGHT OR ANY OTHER OBSTRUCTION.
- 9 NO FIRE HYDRANT SHALL BE LOCATED WITHIN THE REQUIRED RADIUS OF A CUL-DE-SAC OR WITHIN 20' OF THE PERIMETER OF THE RADIUS OF THE CUL-DE-SAC.
- 10 A PERMIT IS REQUIRED FROM THE FIRE DEPARTMENT FOR WATER LINE AND FIRE HYDRANT INSTALLATIONS ON THE PRIVATE SIDE OF THE METER.
- 11 ENSURE THAT FIRE HYDRANTS ARE CONNECTED TO A DEPENDABLE WATER SUPPLY CAPABLE OF SUPPLYING THE REQUIRED FIRE FLOW.
- 12 ALL ON-SITE FIRE MAIN MATERIALS MUST BE U.L. LISTED AND F.M. APPROVED.

LAS VEGAS FIRE DEPARTMENT

FIRE FLOW REQUIREMENT IS 1500 GALLONS PER MINUTE AT 20 POUNDS PER SQUARE INCH RESIDUAL BASED ON:
 AREA SEPARATION FIRE WALLS MUST BE IDENTIFIED. N/A
 SQUARE FOOTAGE 3000 SF
 LARGEST AREA BETWEEN AREA SEPARATION WALLS 3000 SF
 HEIGHT 12 FEET
 TYPE OF CONSTRUCTION CLASS 1
 EXPOSURES 10' MINIMUM
 SPRINKLER SYSTEM N/A
 OCCUPANCY RESIDENTIAL
 ROOF CONSTRUCTION CONCRETE TILE
 REVIEWED BY:
 DATE:
 GPM REQUIRED WITHIN 500 FT. OF ALL BUILDING AREAS.

QUANTITY ESTIMATE

① 2" BLOWOFF	6 EA.
② 8" GATE VALVE	4 EA.
③ 8" TEE	3 EA.
④ FIRE HYDRANT W/ASSEMBLY	4 EA.
⑤ 6" GATE VALVE	1 EA.
⑥ 8" x 8" x 6" TEE	1 EA.
⑦ 8" x 6" REDUCER	2 EA.
8" ACP WATER MAIN	1411 L.F.
6" ACP WATER MAIN	591 L.F.
3/4" SERVICE LATERALS	44 EA.
3/4" METERS BY L.V.V.W.D.	52 EA.

EXISTING SERVICE LATERALS TO LOTS 108-116 OF BLOCK 3 WERE INSTALLED WITH UNIT NO. 1.

NOTE: THESE QUANTITIES ARE ONLY ESTIMATES, CONTRACTOR TO VERIFY.

BENCHMARK

TOP OF B.L.M. BRASS CAP E. 1/16 ON CHRISTYNE RD. 1/4 MILE WEST OF BUFFALO DR.
 ELEVATION = 2388.62'

APPROVAL

Call before you Dig.
 1-800-227-2600
 UNDERGROUND SERVICE UTILITIES
 Tisha
 LAS VEGAS VALLEY WATER DISTRICT
 7-5-11
 DATE

Edwin J. [Signature]
 CLV FIRE DEPARTMENT
 4/12/11
 DATE

REV	DATE	BY	REVISION
1	4.4.11	Tisha	DESIGNED PER IFC 2006.17 UNDERGROUND SERVICE UTILITIES
2	4.28.11	Tisha	REVISIONS TO PERMITS. APPROVED BY [Signature]

ESI ENGINEERS & SURVEYORS INC.
 1000 S. GARDEN BLVD. SUITE 100
 LAS VEGAS, NV 89102
 (702) 735-1100
 SUBMITTED BY: [Signature]

MASTER WATER PLAN
 AS BUILT
 COLEMAN HOMES AT
 DESERT SHORES UNIT NO. 2

WO NO	5113 B
BY	TISHA
DATE	3/89
SCALE	1"=60'

SHEET	8
OF 9 SHEETS	

6084

15-9-n AS BUILT

567Y-4025-2



LAS VEGAS VALLEY WATER DISTRICT NOTES

- 1. WATER MAIN
- 2. 12" WATER MAIN
- 3. 18" WATER MAIN
- 4. 24" WATER MAIN
- 5. 30" WATER MAIN
- 6. 36" WATER MAIN
- 7. 42" WATER MAIN
- 8. 48" WATER MAIN
- 9. 54" WATER MAIN
- 10. 60" WATER MAIN
- 11. 66" WATER MAIN
- 12. 72" WATER MAIN
- 13. 78" WATER MAIN
- 14. 84" WATER MAIN
- 15. 90" WATER MAIN
- 16. 96" WATER MAIN
- 17. 102" WATER MAIN
- 18. 108" WATER MAIN
- 19. 114" WATER MAIN
- 20. 120" WATER MAIN

CITY OF LAS VEGAS FIRE DEPARTMENT NOTES

- 1. FIRE MAIN
- 2. FIRE MAIN
- 3. FIRE MAIN
- 4. FIRE MAIN
- 5. FIRE MAIN
- 6. FIRE MAIN
- 7. FIRE MAIN
- 8. FIRE MAIN
- 9. FIRE MAIN
- 10. FIRE MAIN
- 11. FIRE MAIN
- 12. FIRE MAIN
- 13. FIRE MAIN
- 14. FIRE MAIN
- 15. FIRE MAIN
- 16. FIRE MAIN
- 17. FIRE MAIN
- 18. FIRE MAIN
- 19. FIRE MAIN
- 20. FIRE MAIN

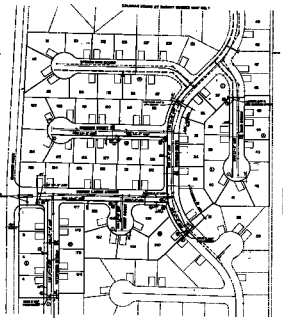

FIGURE "GENERAL VIEW OF SITE" DRAWING SET NO. 1"

LAS VEGAS FIRE DEPARTMENT
 APPROVED FOR THE CITY OF LAS VEGAS
 BY THE FIRE DEPARTMENT
 DATE: _____
 BY: _____
 TITLE: _____
 SIGNATURE: _____

QUANTITY SCHEDULE

NO.	DESCRIPTION	QUANTITY	UNIT
1	12" WATER MAIN	100	LINEAL FEET
2	18" WATER MAIN	50	LINEAL FEET
3	24" WATER MAIN	20	LINEAL FEET
4	30" WATER MAIN	10	LINEAL FEET
5	36" WATER MAIN	5	LINEAL FEET
6	42" WATER MAIN	2	LINEAL FEET
7	48" WATER MAIN	1	LINEAL FEET
8	54" WATER MAIN	0	LINEAL FEET
9	60" WATER MAIN	0	LINEAL FEET
10	66" WATER MAIN	0	LINEAL FEET
11	72" WATER MAIN	0	LINEAL FEET
12	78" WATER MAIN	0	LINEAL FEET
13	84" WATER MAIN	0	LINEAL FEET
14	90" WATER MAIN	0	LINEAL FEET
15	96" WATER MAIN	0	LINEAL FEET
16	102" WATER MAIN	0	LINEAL FEET
17	108" WATER MAIN	0	LINEAL FEET
18	114" WATER MAIN	0	LINEAL FEET
19	120" WATER MAIN	0	LINEAL FEET

REVISIONS
 NONE

APPROVAL

 DATE: _____

NO.	DATE
1	10-2-2004
2	10-2-2004
3	10-2-2004
4	10-2-2004
5	10-2-2004
6	10-2-2004
7	10-2-2004
8	10-2-2004
9	10-2-2004
10	10-2-2004



MASTER WATER PLAN
GOLDENVA HOUSE AT
DESERT SHORES UNIT NO. 2

NO.	DATE
1	10-2-2004
2	10-2-2004
3	10-2-2004
4	10-2-2004
5	10-2-2004

8

10-2-2004