

CONSTRUCTION KEY NOTES

- 1 CONSTRUCT TYPE "L" CURB AND GUTTER PER C.C.A.U.S.D. NO. 216 OVER 6" MIN. TYPE II BASE COMPACTED TO 95% MIN., UNLESS OTHERWISE NOTED IN THE PROJECT GEOTECHNICAL INVESTIGATION.
- 2 CONSTRUCT TYPE "A" CURB PER DETAIL 1 ON SHEET C6.01.
- 3 CONSTRUCT 2" CONCRETE VALLEY GUTTER PER DETAIL 2 ON SHEET C6.01.
- 4 CONSTRUCT 4" CONCRETE VALLEY GUTTER PER DETAIL 3 ON SHEET C6.01.
- 5 CONSTRUCT CONCRETE SIDEWALK PER C.C.A.U.S.D. NO. 234.
- 6 CONSTRUCT SIDEWALK RAMP PER C.C.A.U.S.D. NO. 235 CASE I.
- 7 CONSTRUCT COMMERCIAL DRIVEWAY PER C.C.A.U.S.D. NO. 225 WITH GEOMETRICS OF C.C.A.U.S.D. 222A.
- 8 CONSTRUCT HANDICAP AREA PER DETAIL 4 ON SHEET C6.01.
- 9 CONSTRUCT NON-HOLDING "L" CURB AND GUTTER PER DETAIL 11 ON SHEET C6.01.
- 10 INSTALL 3" FLUME PER DETAIL 5 ON SHEET C6.01.
- 11 INSTALL 6" FLUME PER DETAIL 6 ON SHEET C6.01.
- 12 INSTALL ON-SITE CONCRETE APRON PER DETAIL 7 ON SHEET C6.01.
- 13 CHAIN LINK FENCE, REFER TO ARCHITECTURAL PLANS FOR DETAILS AND ADDITIONAL INFORMATION.
- 14 LANDSCAPE AREA, REFER TO LANDSCAPE ARCHITECTURAL PLANS.
- 15 FUELING AREA, REFER TO ARCHITECTURAL PLANS FOR DETAILS AND ADDITIONAL INFORMATION.
- 16 BUS WASH AREA, REFER TO ARCHITECTURAL PLANS FOR DETAILS AND ADDITIONAL INFORMATION.
- 17 REFER TO SHEET C7.01 FOR RETAINING WALL STRUCTURAL SECTION AND NOTES.
- 18 WALL "A" PROFILE, REFER TO SHEET C7.04.
- 19 WALL "B" PROFILE, REFER TO SHEET C7.02.
- 20 WALL "B3" PROFILE, REFER TO SHEET C7.02.
- 21 WALL "C1" PROFILE, REFER TO SHEET C7.03 AND C7.04.
- 22 WALL "D" PROFILE, REFER TO SHEET C7.04.
- 23 CONSTRUCT ELECTRICAL AREA PER ARCHITECTURAL PLANS AND SITE ELECTRICAL PLANS.
- 24 CONSTRUCT SIDEWALK DRAIN PER C.C.A.U.S.D. NO. 236.
- 25 INSTALL HEAVY DUTY AC PER DETAIL 8 ON SHEET C6.01.
- 26 INSTALL LIGHT DUTY AC PER DETAIL 9 ON SHEET C6.01.
- 27 INSTALL 4" WIDE WHITE PARKING LOT STRIPE.
- 28 CONSTRUCT BUILDING PAD PER DETAIL 10 ON SHEET C6.01. FOR ADDITIONAL INFORMATION REFER TO PROJECT GEOTECHNICAL REPORT AND STRUCTURAL DWGS.
- 29 INSTALL PRECAST CONCRETE BUMPER BLOCK PER C.C.A.U.S.D. NO. 238.
- 30 ENTRANCE GATE, REFER TO ARCHITECTURAL PLANS FOR DETAILS.
- 31 CONSTRUCT SIDEWALK RAMP PER C.C.A.U.S.D. NO. 235, CASE II.
- 32 CONSTRUCT DETECTABLE WARNING STRIP PER C.C.A.U.S.D. NO. 235.
- 33 NOT USED.
- 34 TRASH ENCLOSURE, REFER TO ARCHITECTURAL PLANS FOR DETAILS AND ADDITIONAL INFORMATION.
- 35 CONTRACTOR TO INSTALL TYPE "A" BARRIER RAIL PER NDOT DWG. R-3.6.1 AND BARRIER RAIL REFLECTORS PER NDOT DWG. R-3.2.2.
- 36 PROVIDE A 12" WIDE ACCESS ROAD, CONSTRUCT WITH TYPE II COMPACTED TO 95% DENSITY WITH 2% MAX. CROSS SLOPE.
- 37 REFER TO DETAIL "C" ON SHEET C3.02 FOR ADDITIONAL INFORMATION.
- 38 REFER TO SHEET C7.02 FOR ADDITIONAL INFORMATION.
- 39 EXISTING AC PAVEMENT TO BE REMOVED AND LEGALLY DISPOSED OF.

STORM DRAIN KEY NOTES

- 1 INSTALL A 48" TYPE I MANHOLE PER C.C.A.U.S.D. 403.
- 2 INSTALL A 60" TYPE I MANHOLE PER C.C.A.U.S.D. 403.
- 3 INSTALL A 48" TYPE II MANHOLE PER C.C.A.U.S.D. 405.
- 4 INSTALL A 60" TYPE II MANHOLE PER C.C.A.U.S.D. 406.
- 5 INSTALL A CONCRETE COLLAR PER C.C.A.U.S.D. 408.
- 6 INSTALL A 2.5" GRATE WITH A 10" CURB OPENING MODIFIED TYPE "C" INLET PER C.C.A.U.S.D. 412A. INLET SHALL INCLUDE A WATER QUALITY STAMP PER C.C.A.U.S.D. 421.
- 7 INSTALL A JENSEN PRECAST D142448 CATCH BASIN.
- 8 INSTALL A JENSEN PRECAST D1424872 CATCH BASIN.
- 9 INSTALL A 5" MODIFIED TYPE "CM" INLET PER C.C.A.U.S.D. 412A. INLET SHALL INCLUDE A WATER QUALITY STAMP PER C.C.A.U.S.D. 421.
- 10 INSTALL A 7.5" GRATE WITH AN 11.25" CURB OPENING MODIFIED TYPE "CM" INLET PER C.C.A.U.S.D. 412A. INLET SHALL INCLUDE A WATER QUALITY STAMP PER C.C.A.U.S.D. 421.
- 11 INSTALL A 7.5" MODIFIED TYPE "CM" INLET PER C.C.A.U.S.D. 412A. INLET SHALL INCLUDE A WATER QUALITY STAMP PER C.C.A.U.S.D. 421.
- 12 INSTALL A 10" MODIFIED TYPE "CM" INLET PER C.C.A.U.S.D. 412A. INLET SHALL INCLUDE A WATER QUALITY STAMP PER C.C.A.U.S.D. 421.
- 13 INSTALL A 12.5" MODIFIED TYPE "CM" INLET PER C.C.A.U.S.D. 412A. INLET SHALL INCLUDE A WATER QUALITY STAMP PER C.C.A.U.S.D. 421.
- 14 INSTALL A 27.5" MODIFIED TYPE "CM" INLET PER C.C.A.U.S.D. 412A. INLET SHALL INCLUDE A WATER QUALITY STAMP PER C.C.A.U.S.D. 421.
- 15 INSTALL AN RCP END SECTION PER NDOT DETAIL R-2.3.1.
- 16 INSTALL A 5" MODIFIED TYPE "CM" INLET PER C.C.A.U.S.D. 412A. INLET SHALL INCLUDE A WATER QUALITY STAMP PER C.C.A.U.S.D. 421.
- 17 INSTALL AN NDOT TYPE 2 DROP INLET PER DWG. NO. R-4.2.1.
- 18 CAP FOR FUTURE WITH BRICK OR CONCRETE. DO NOT USE WOOD. ALL STORM DRAIN PIPE SHALL BE CLASS III (MIN.) UNLESS OTHERWISE NOTED.

BASIS OF BEARING

NORTH 00°05'54" WEST, BEING THE BEARING OF THE WEST LINE OF THE EAST HALF (E 1/2) OF THE NORTHWEST QUARTER (NW 1/4) OF SECTION 36 TOWNSHIP 19 SOUTH, RANGE 59 EAST, AS SHOWN ON A MAP ON FILE IN THE CLARK COUNTY, NEVADA RECORDER'S OFFICE AS FILE 89, PAGE 3 OF SURVEYS.

BENCHMARK

CITY OF LAS VEGAS BENCHMARK SLY99 36N6
A RIVET AND PLATE IN A FENCE POST BASE AT THE SOUTHWEST CORNER OF ALPINE RIDGE AND HAMMER LANE
ELEVATION = 2891.24 FEET (899.059 METERS) NAVD 1988 DATUM

NOTE:
ACCORDING TO THE FEDERAL EMERGENCY MANAGEMENT AGENCY (FEMA) FLOOD INSURANCE RATE MAP (FIRM) COMMUNITY PANEL NUMBER 32003C1790 E, REVISED SEPTEMBER 27, 2002 THE SITE IS LOCATED WITHIN A ZONE "X". A ZONE "X" IS DESCRIBED AS AREAS OUTSIDE OF THE 0.2% ANNUAL CHANCE FLOODPLAIN.

I CERTIFY THAT THIS GRADING CONFORMS TO THE APPROVED DRAINAGE STUDY FOR THIS SITE ON FILE AT CITY OF LAS VEGAS PER DS4511A
VERNON R. HARKINS P.E. No. 9898 DATE 11/21/11

REVISIONS			
REV	DESCRIPTION	DATE	BY

DISCLAIMER NOTE
UTILITY LOCATIONS SHOWN HEREON ARE APPROXIMATE ONLY. IT SHALL BE THE CONTRACTOR'S RESPONSIBILITY TO DETERMINE THE EXACT HORIZONTAL AND VERTICAL LOCATION OF ALL EXISTING UNDERGROUND AND OVERHEAD UTILITIES PRIOR TO COMMENCING CONSTRUCTION. NO REPRESENTATION IS MADE THAT ALL EXISTING UTILITIES ARE SHOWN HEREON. THE ENGINEER ASSUMES NO RESPONSIBILITY FOR UTILITIES NOT SHOWN OR UTILITIES NOT SHOWN IN THEIR PROPER LOCATION.

Call before you Dig
Avoid overhead power line contact
Call before you OVERHEAD
1-800-237-2600
1-702-227-2929
1-702-228-8811
1-702-455-7544

ENGINEER'S SEAL
VERNON R. HARKINS
EXP. 6/30/13
CIVIL
No. 009898

PROJECT NO. 15-45
CDS REVIEW
APPROVED BY
DATE
OCTOBER 31, 2011
DRAWN BY
CHECKED BY
SUBMITTAL
PROJECT NO. C3-010

L. R. NELSON CONSULTING ENGINEERS, INC.
2524 West Sahara Blvd., Suite 202
Las Vegas, Nevada 89118
(702) 798-7979
(702) 431-2596 FAX

KGA ARCHITECTURE
9075 West Diablo Drive, Third Floor 1701 Directors Boulevard, Suite 770
Las Vegas, Nevada 89148 Austin, Texas 78744
702.367.6900 512.441.8200
LAS VEGAS AUSTIN
www.KGAarchitecture.com

CLARK COUNTY SCHOOL DISTRICT
DESIGN MANAGEMENT / PLANNING AND DESIGN
4170 McLEOD DRIVE LAS VEGAS, NEVADA 89121

CCSD NORTHWEST SATELLITE TRANSPORTATION FACILITY
PROJECT
DRAWING TITLE
GRADING PLAN

SHEET NO. **C3.02**
SHEET 20 OF 83
CLV #11249 715-183
HTE #11-19927

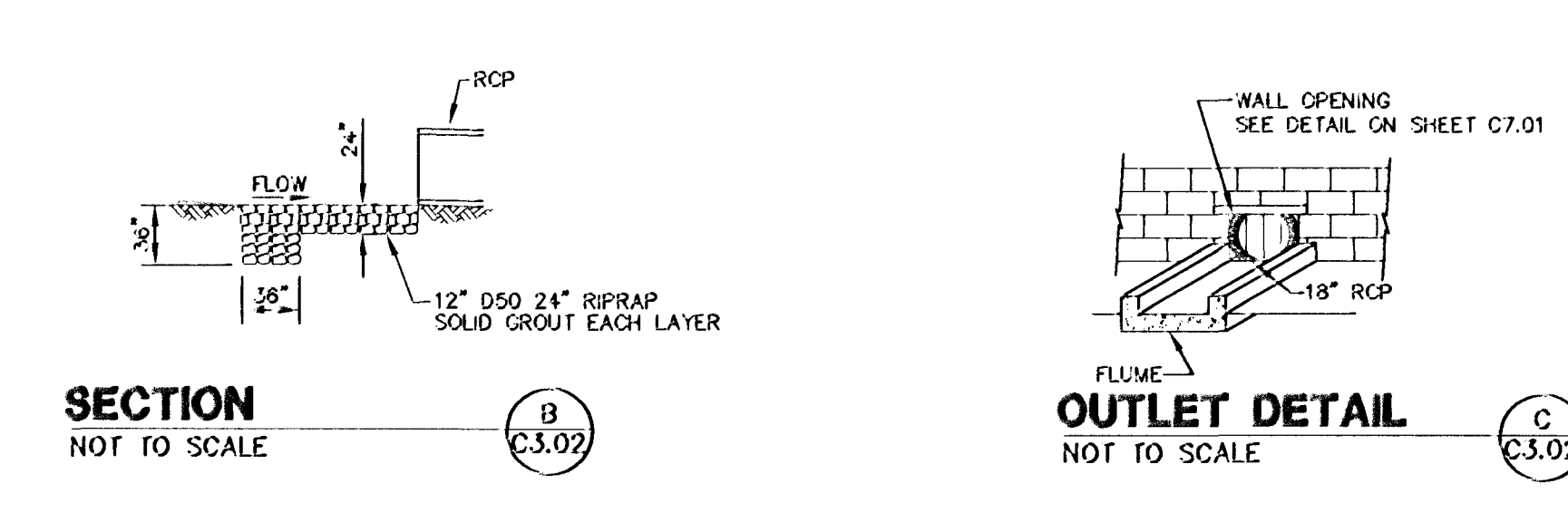
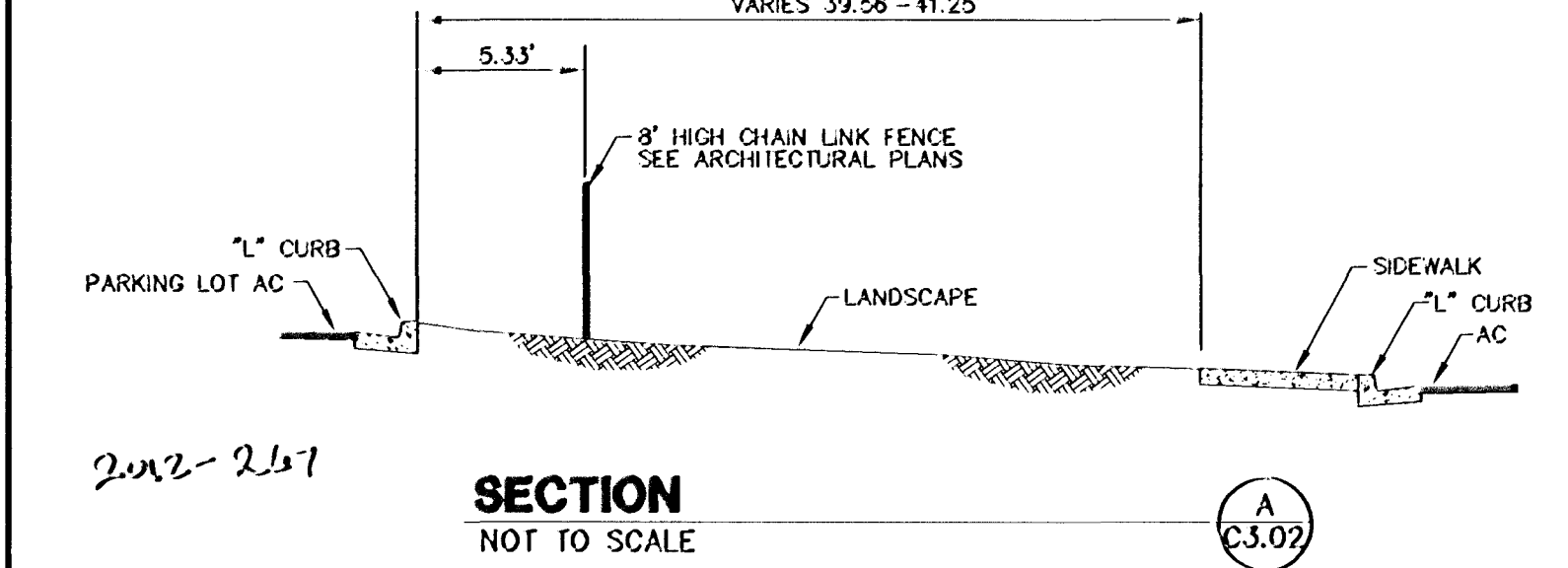

2012-2017
SECTION A NOT TO SCALE
SECTION B NOT TO SCALE
SECTION C NOT TO SCALE

MATCH LINE-SEE C3.03

MATCH LINE-SEE C3.05