

VILLAGE 23B PARCEL X SF3
FUTURE SUBDIVISION

ALTA DRIVE
(PUBLIC)

HIGH COUNTRY LN.
(PRIVATE)

HIGHLAND VISTA WY.
(PRIVATE)

HIGHLAND BLUFF WY.
(PRIVATE)

CONSTRUCTION NOTES

ROADWAY

- INSTALL 2" AC PAVEMENT
- INSTALL "L" TYPE CURB & GUTTER
- INSTALL ROLL TYPE CURB
- INSTALL NON-LANDSCAPE MEDIAN ISLAND
- INSTALL 8" CROSS GUTTER
- INSTALL CONCRETE SIDEWALK
- INSTALL HANDICAP RAMP CURB DEPRESSION

STORM DRAIN

- INSTALL NEENAH R-2560-G BEEHIVE DROP INLET
- INSTALL (2) 8" PVC PIPES

* NOTE: 8" TYPE II AGGREGATE BASE COMPACTED TO 95% UNDER ALL CURBS.

for Andy

ROAD CONTROL LINE	TABLE	ROAD CONTROL CURVE	LENGTH	TANGENT
L3	64.32 S08°31'59"W	C6	45°00'00"	49.50 38.88 20.50
L4	39.43 S08°31'59"W	C12	12°48'32"	500.00 111.78 56.12
L9	185.90 S08°31'59"W	C13	9°57'11"	2000.00 347.42 174.15
L10	37.91 S04°16'33"E	C18	9°27'45"	300.00 49.55 24.83
L11	118.75 N85°43'27"E	C19	31°3'20"	1000.00 56.24 28.13
L15	229.85 S89°33'10"E	C21	8°45'12"	100.00 15.28 7.65
L17	2.58 S89°33'10"E	C22	1°48'49"	100.00 3.17 1.58
L18	28.79 N08°17'22"E	C23	45°00'00"	49.50 38.88 20.50
L19	13.98 N08°17'22"E	C24	15°28'03"	49.00 13.20 6.64
L20	40.75 N75°09'28"E	C25	35°04'45"	49.00 30.00 15.49
L21	75.44 S08°31'59"W	C26	35°04'44"	49.00 30.00 15.49
L22	0.52 S04°16'33"E	C27	25°32'29"	49.00 21.84 11.11
L23	37.91 S04°16'33"E	C28	90°00'00"	30.00 47.12 30.00
L24	12.81 S85°43'27"W	C29	2°58'54"	519.50 27.03 13.52
L25	66.55 S85°43'27"W	C30	7°00'22"	519.50 63.53 31.80
L26	7.55 S85°43'27"W	C31	2°49'18"	519.50 25.58 12.79
L27	65.77 S85°43'27"W	C32	5°08'08"	480.50 43.07 21.55
L28	43.42 S85°43'27"W	C33	7°40'24"	480.50 64.35 32.22
L55	39.32 S88°19'50"E	C86	91°22'37"	20.00 31.90 20.49
L78	38.78 S89°33'10"E	C92	1°39'32"	1980.50 57.34 28.67
L79	69.50 S89°33'10"E	C93	2°02'59"	1980.50 70.85 35.43
L80	70.00 S89°33'10"E	C94	2°01'25"	1980.50 69.95 34.98
L81	51.60 S89°33'10"E	C95	2°10'13"	1980.50 75.02 37.52
L83	25.53 S80°05'24"E	C97	1°40'35"	2019.50 59.09 29.55
		C98	1°58'41"	2019.50 63.50 31.78
		C99	1°58'41"	2019.50 63.50 31.78
		C100	1°58'08"	2019.50 63.39 31.70
		C109	1°08'41"	980.50 19.59 9.80
		C110	2°04'38"	980.50 35.55 17.78
		C112	5°30'01"	319.50 30.67 15.35
		C113	3°57'44"	319.50 22.09 11.05

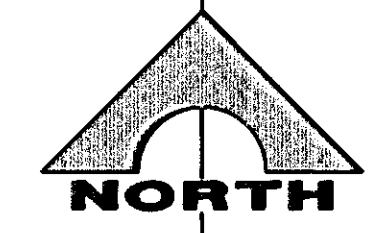

Call before you Dig
811
1-800-227-2600
1-702-456-7544

CALL BEFORE YOU DO OVERHEAD
1-702-227-2929

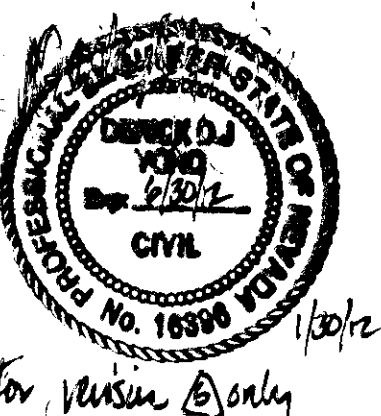

LEGAL DESCRIPTION

LOT 7, 8, & COMMON LOT "G" OF BLOCK B OF "SUMMERLIN VILLAGE 23A UNIT NO. 2" ON FILE IN BOOK 121, PAGE 12 OF PLATS IN THE COUNTY RECORDER'S OFFICE, CLARK COUNTY, NEVADA LYING WITHIN SECTION 34, TOWNSHIP 20 SOUTH, RANGE 59 EAST, M.D.M., CITY OF LAS VEGAS, CLARK COUNTY, NEVADA.

BASIS OF BEARINGS

NORTH 05° 59' 55" WEST BEING THE BEARING OF THE WEST LINE OF SECTION 34, T 20 S, R 59 E, M.D.M., CITY OF LAS VEGAS, CLARK COUNTY, NEVADA, AS SHOWN BY MAP THEREOF ON FILE IN FILE #91, PAGE 28 OF PARCEL MAPS IN THE CLARK COUNTY RECORDERS OFFICE, CLARK COUNTY, NEVADA.

BENCHMARK

BM #	DESC.	NAVD 88 DATUM	NAVD 88 DATUM
CLV BM No. D368 3	U.S.C. & G.S. BRASS DISC SET IN ROCK ON THE EAST SIDE OF CHARLESTON BOULEVARD AND SOUTH OF THE RED ROCK DETENTION BASIN.	3246.71 (FEET)	989.599 (METERS)

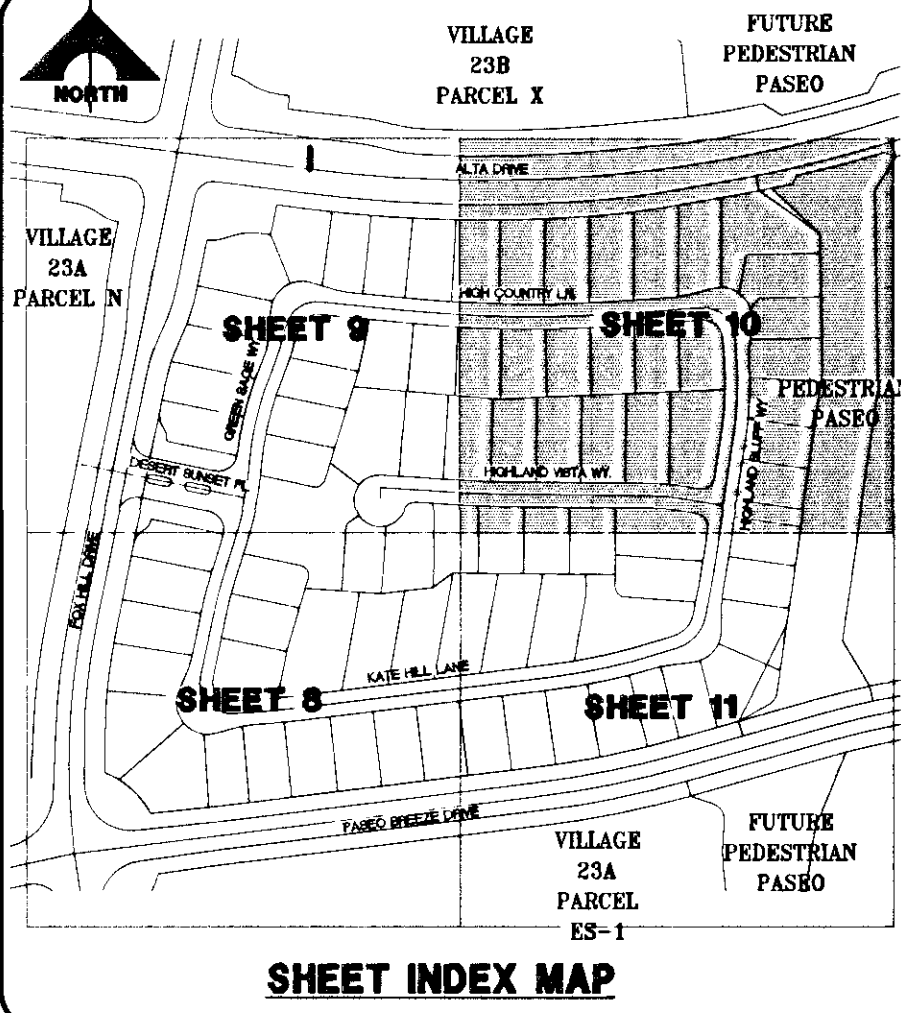

NOTE
ALL PRIVATE STREETS ARE P.U.E., PUBLIC SEWER EASEMENTS AND PUBLIC DRAINAGE EASEMENTS TO BE PRIVATELY MAINTAINED BY HOA.

DRAINAGE CERTIFICATION

I CERTIFY THAT THIS GRADING PLAN IS IN CONFORMANCE WITH THE APPROVED DRAINAGE STUDY DS3712-4.

JONATHAN D. TULL, PE NO. 14581 DATE 7-1-11
CLV DRAWING NO.

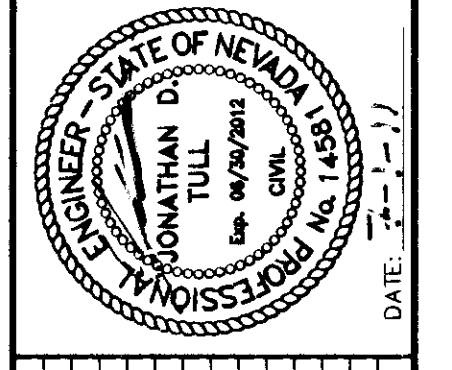

REV	DATE	DESCRIPTION
1	11/18/11	ADD REMAINING WALLS
2	11/18/11	REVISIONS TO WALLS
3	11/18/11	REVISIONS TO WALLS
4	11/18/11	REVISIONS TO WALLS
5	11/18/11	REVISIONS TO WALLS

PROJECT NO: 62023-980
DESIGN: DRAM
CHECK: JDT
PLOT DATE: 06-29-11
PLOT TIME: 10:39:36

G.C. WALLACE COMPANIES
ENGINEERS | PLANNERS | SURVEYORS
1555 S. RAINBOW BOULEVARD - LAS VEGAS, NV 89146
T: 702.804.2000 F: 702.804.2599 GCWALLACE.COM

LAS VEGAS, SACRAMENTO - RENO
F:\Projects\600\62023-980\DWG\Production\AND\010-0-grading3.dwg
Michael Fang

THE HOWARD HUGHES COMPANY, LLC
SUMMERLIN VILLAGE 23A PARCEL L
ANDALUSIA
GRADING PLAN III

DRAWING
C10
10 OF 31 SHTS