

**NOTE:**  
ALL PRIVATE STREETS ARE P.U.E., PUBLIC SEWER EASEMENTS AND PUBLIC DRAINAGE EASEMENTS TO BE PRIVATELY MAINTAINED BY THE HOA.

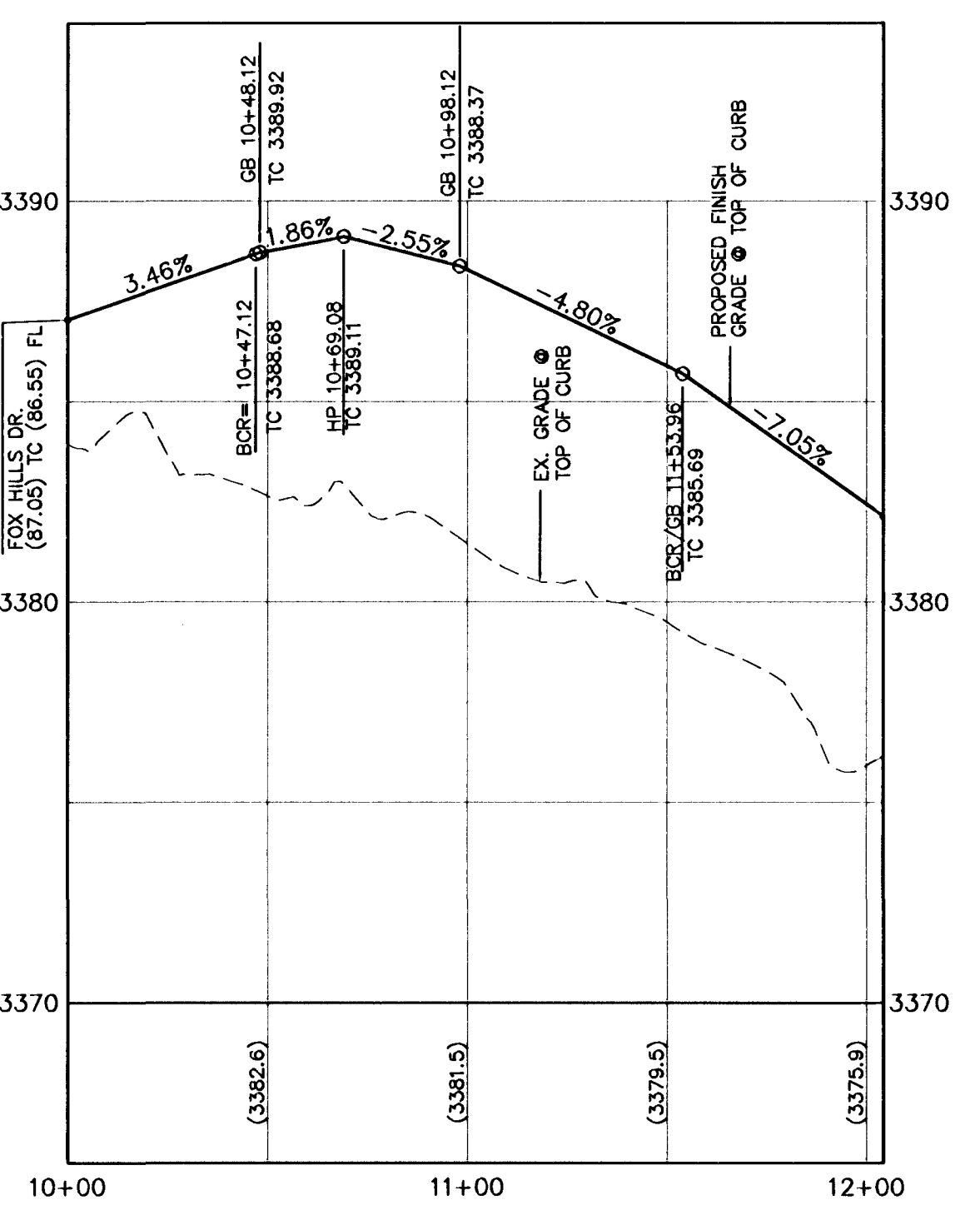
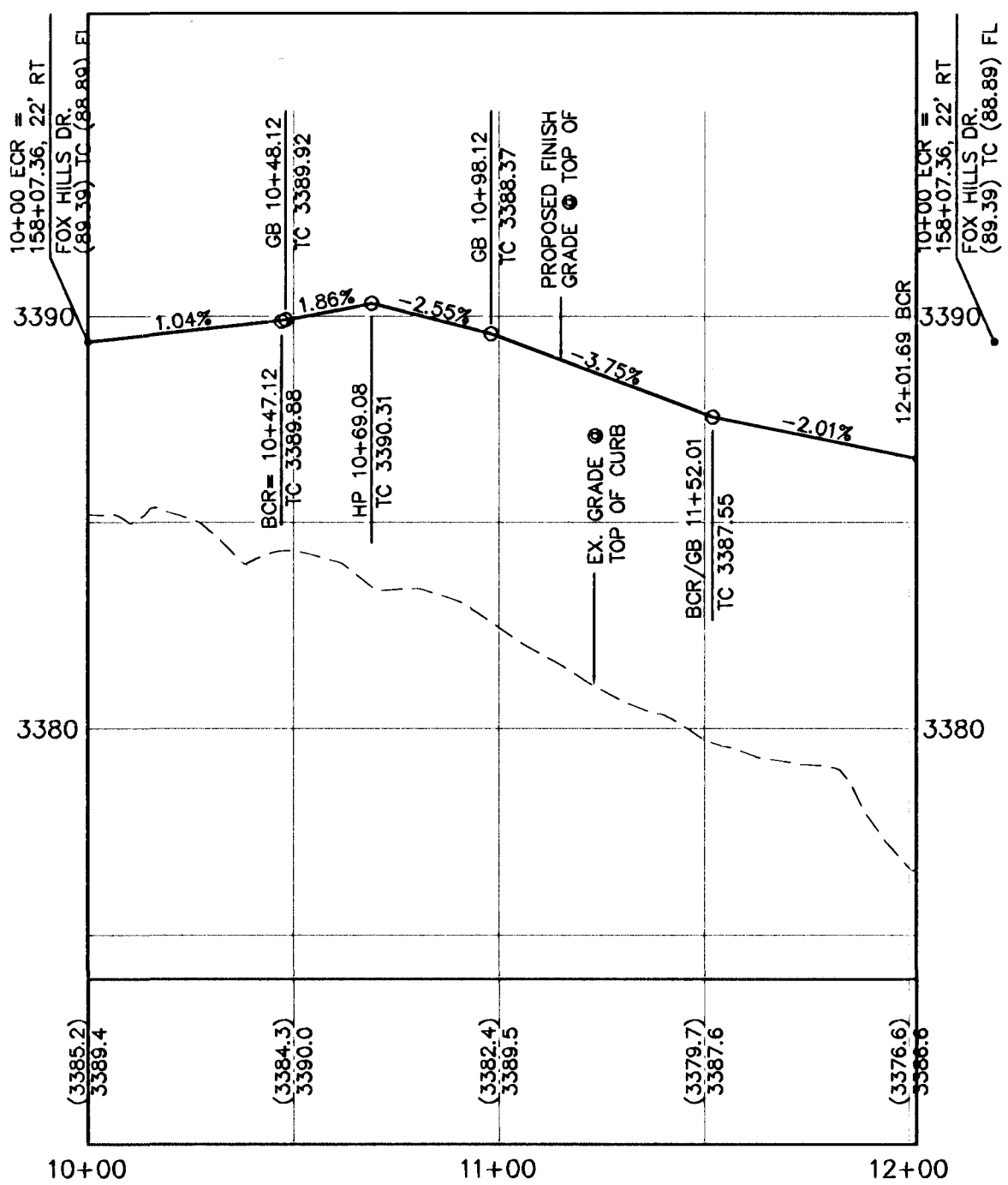
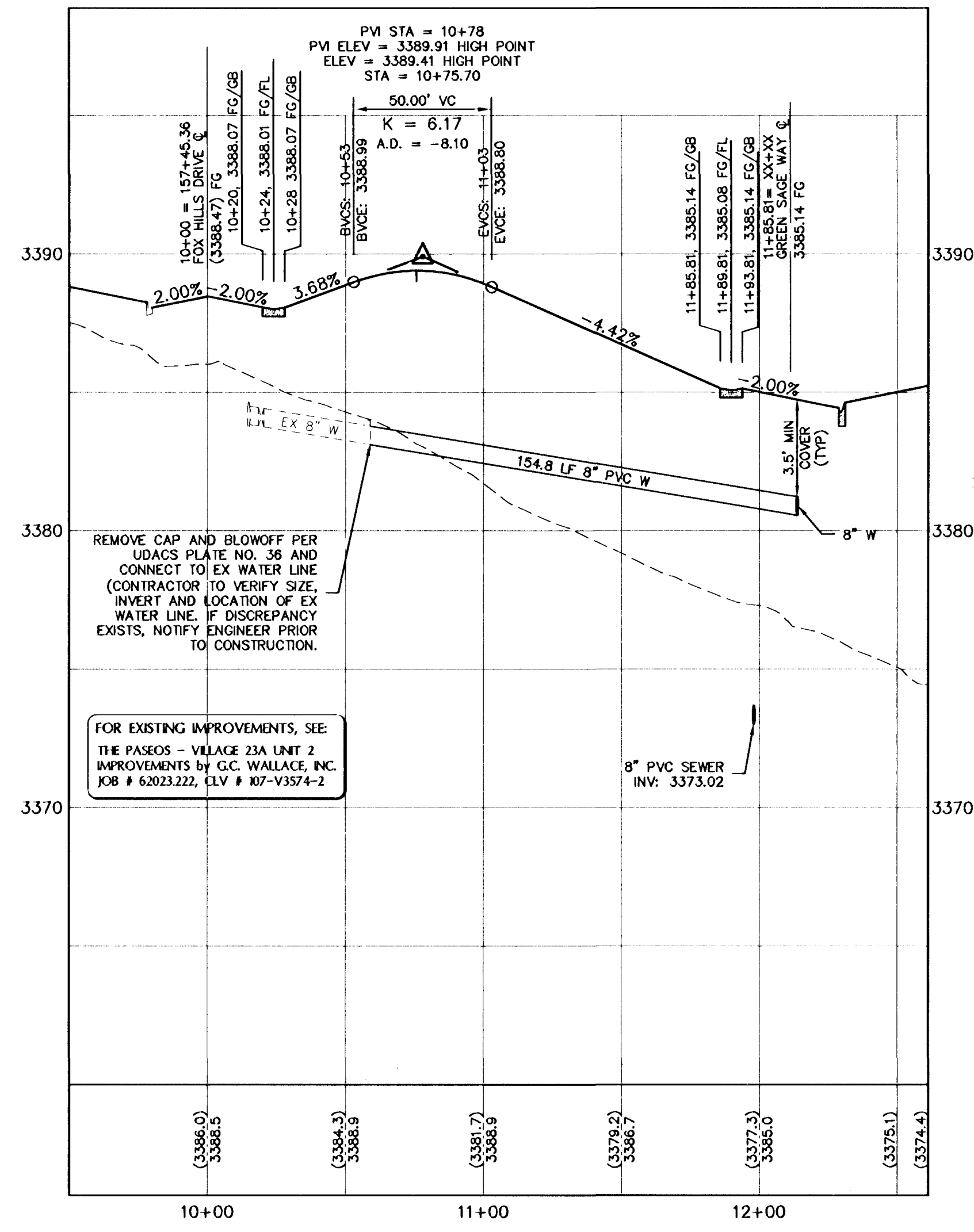
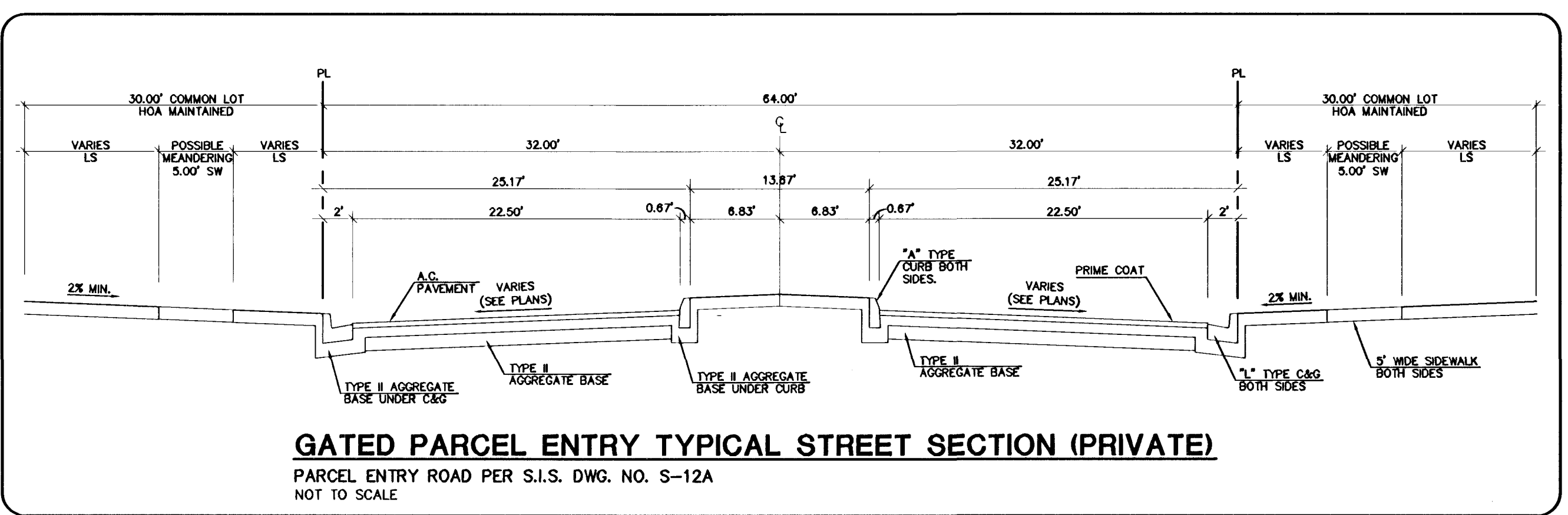

Call before you UnderGround  
1-702-455-7511  
1-702-229-6611

Call before you Dig  
1-800-227-2600  
1-702-455-7544

CALL BEFORE YOU DIG OVERHEAD  
1-702-227-2929

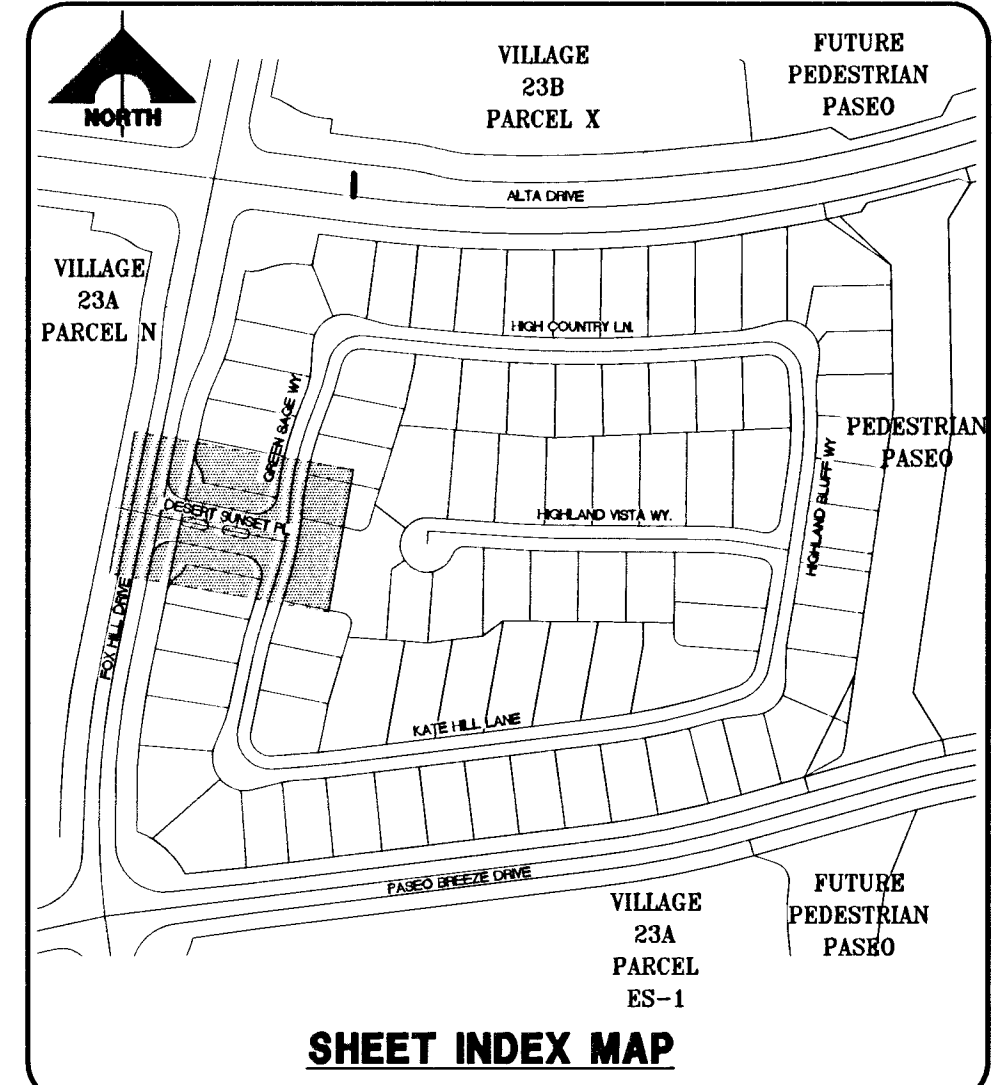

BENCHMARK			
BM #	DESC.	NAVD 88 DATUM	NAVD 88 DATUM
CLV BM No. D368 3	U.S.C. & G.S. BRASS DISC SET IN ROCK ON THE EAST SIDE OF CHARLESTON BOULEVARD AND SOUTH OF THE RED ROCK DETENTION BASIN.	3248.71 (FEET)	989.599 (METERS)

**BASIS OF BEARINGS**  
NORTH 05° 59' 55" WEST BEING THE BEARING OF THE WEST LINE OF SECTION 34, T 20 S, R 59 E, M.D.M., CITY OF LAS VEGAS, CLARK COUNTY, NEVADA, AS SHOWN BY MAP THEREOF ON FILE IN FILE 91, PAGE 28 OF PARCEL MAPS IN THE CLARK COUNTY RECORDERS OFFICE, CLARK COUNTY, NEVADA.

**LEGAL DESCRIPTION**  
LOT 7, 8, & COMMON LOT "G" OF BLOCK B OF "SUMMERLIN VILLAGE 23A UNIT NO. 2" ON FILE IN BOOK 121, PAGE 12 OF PLATS IN THE COUNTY RECORDER'S OFFICE, CLARK COUNTY, NEVADA LYING WITHIN SECTION 34, TOWNSHIP 20 SOUTH, RANGE 59 EAST, M.D.M., CITY OF LAS VEGAS, CLARK COUNTY, NEVADA.

- CONSTRUCTION NOTES**
- ROADWAY**
- INSTALL 2" AC PAVEMENT
  - INSTALL "L" TYPE CURB & GUTTER
  - INSTALL ROLL TYPE CURB
  - INSTALL "A" TYPE ISLAND CURB
  - INSTALL 8" CROSS GUTTER
  - INSTALL CONCRETE SIDEWALK
  - INSTALL HANDICAP RAMP CURB DEPRESSION
- ROADWAY**
- INSTALL 48" DIA. SEWER MANHOLE

APPROVED FOR CONSTRUCTION  
*Dee Gregory*  
LAS VEGAS VALLEY WATER DISTRICT ENGINEERING SERVICES MANAGER  
PROJECT NO. 116847 DATE: 03/14/11

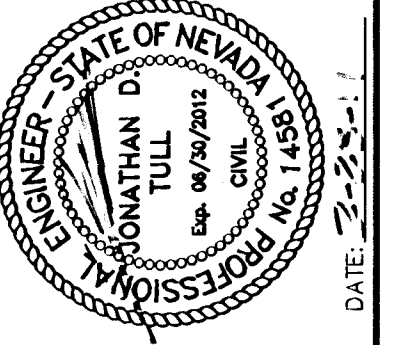

PROJECT NO.	DATE	DESCRIPTION
62023-980	02-23-11	DESERT SUNSET PLACE PLAN AND PROFILE
62023-980	02-23-11	DESERT SUNSET PLACE PLAN AND PROFILE
62023-980	02-23-11	DESERT SUNSET PLACE PLAN AND PROFILE

**G.C. WALLACE COMPANIES**  
ENGINEERS | PLANNERS | SURVEYORS  
1555 S. RAINBOW BOULEVARD - LAS VEGAS, NV 89146  
TEL: 702.804.2000 FAX: 702.804.2299 GCWALLACE.COM

**THE HOWARD HUGHES COMPANY, LLC**  
SUMMERLIN VILLAGE 23A PARCEL L ANDALUSIA

**DESERT SUNSET PLACE**  
PLAN AND PROFILE