

FOR EX RCB & SD, SEE VILLAGE 23A/23B ALTA DRIVE RCB REGIONAL DRAINAGE IMPROVEMENT BY CCW, JOB #62052233, CLV #327-V269

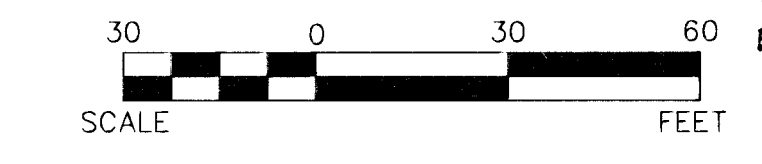

UTILITY LEGEND

- EX 8" WL --- EXISTING WATER LINE W/SIZE
- 8" PVC WL --- PROPOSED WATER LINE W/SIZE
- 1" PROPOSED WATER LATERAL & 3/4" METER PER UDACS PLATE 2 AS NOTED
- EX 8" SS --- EXISTING SEWER LINE W/SIZE
- 8" PVC SS --- PROPOSED SEWER LINE W/SIZE
- PROPOSED SEWER LATERAL
- PROPOSED SEWER MANHOLE
- GATE VALVE
- 8" WL --- 6" WL --- WATER REDUCER
- PROPOSED CAP & BLOW-OFF
- CONCRETE DRIVEWAY
- (BW) --- REQUIRES BACKWATER VALVE
- (PRV) --- REQUIRES PRESSURE REDUCER VALVE
- EXISTING SEWER MANHOLE

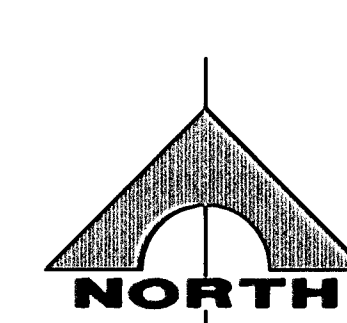
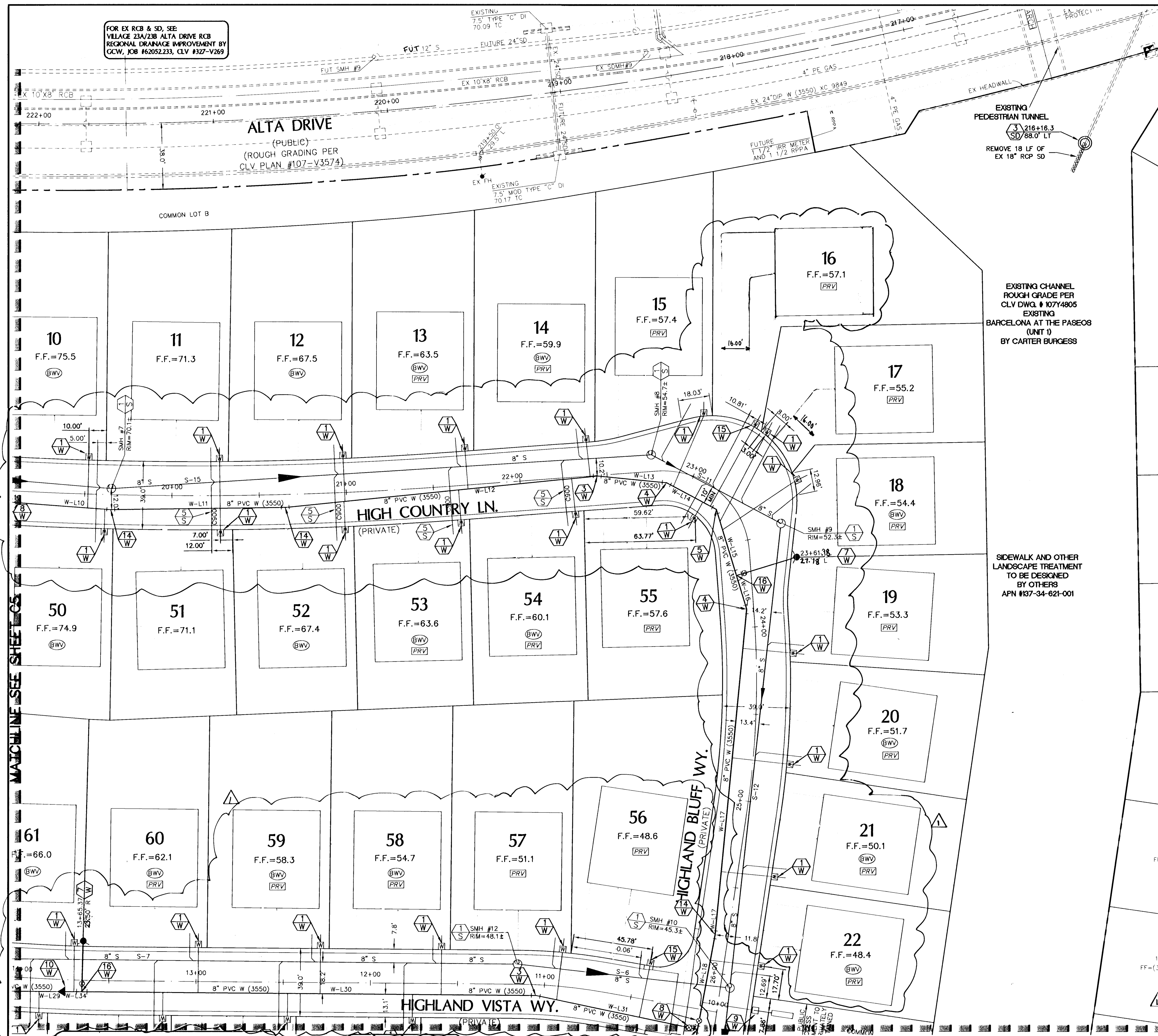
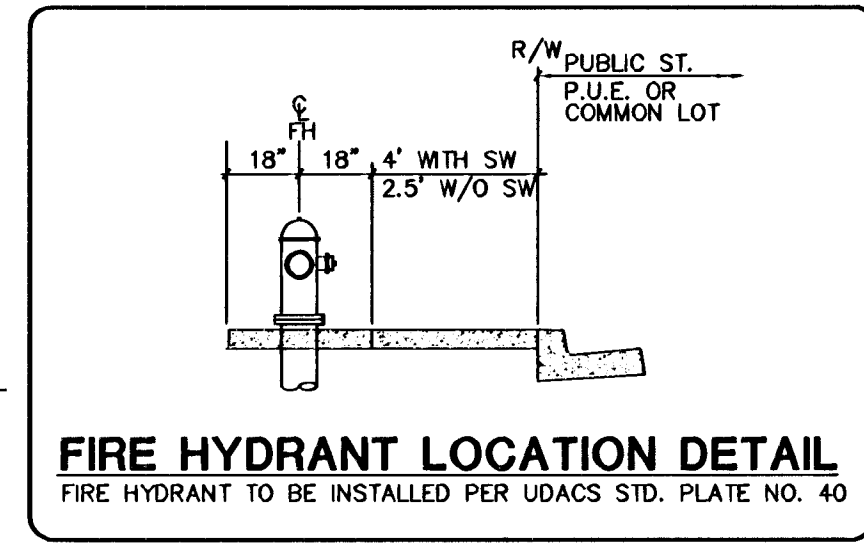

FIRE HYDRANT LOCATION DETAIL
FIRE HYDRANT TO BE INSTALLED PER UDACS STD. PLATE NO. 40

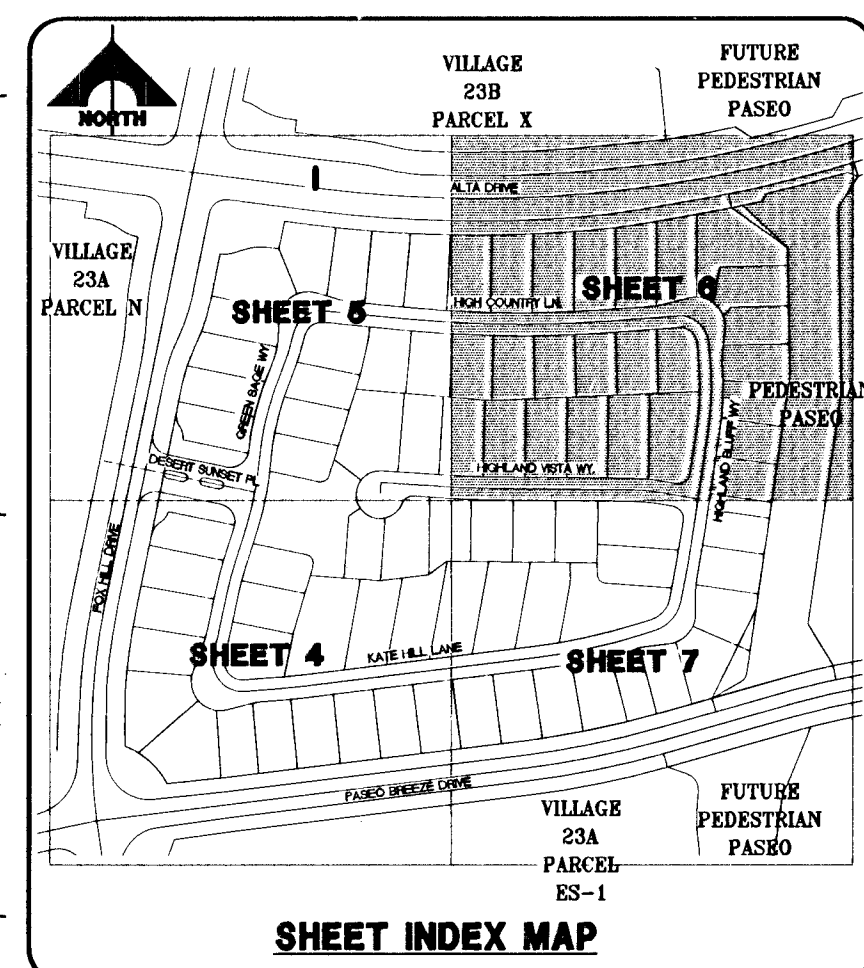

WATER CONTROL LINE TABLE			SEWER CONTROL LINE TABLE		
LINE	LENGTH	BEARING	LINE	LENGTH	BEARING
W-L10	67.68'	S89°45'00"E	S-6	122.56'	S83°41'22"E
W-L11	100.00'	N89°15'00"E	S-7	422.15'	S89°25'01"E
W-L12	180.00'	N84°15'00"E	S-11	84.20'	N62°13'11"W
W-L13	40.00'	S84°30'00"E	S-12	267.38'	S06°15'11"W
W-L14	32.25'	S62°00'00"E	S-15	310.27'	N86°23'19"E
W-L15	34.87'	S17°00'00"E	REFER TO DRAWING C7 FOR SEWER MANHOLE TABLE		
W-L16	14.86'	S27°00'00"E			
W-L17	187.16'	S5°30'00"W			
W-L18	55.98'	S10°30'00"W			
W-L19	169.38'	S89°33'10"E			
W-L20	260.51'	S89°33'10"E			
W-L31	94.76'	S78°18'10"E			
W-L34	14.32'	S89°33'10"E			

CONSTRUCTION NOTES

- WATER**
- 1. INSTALL 3/4" WATER METER (2 UDACS)
 - 2. INSTALL 8"x8" TEE (31 UDACS)
 - 3. INSTALL 11-1/4" BEND (31 UDACS)
 - 4. INSTALL 22-1/2" BEND (31 UDACS)
 - 5. INSTALL 45" BEND (31 UDACS)
 - 6. INSTALL CAP W/ 2" BLOW-OFF ASSEMBLY (36 UDACS)
 - 7. INSTALL FIRE HYDRANT ASSEMBLY (40 UDACS)
 - 8. INSTALL 8" GATE VALVE & BOX (39 UDACS)
 - 9. INSTALL 5/8" WATER METER W/ 1" RPPA (UDACS)
 - 10. INSTALL 8" X 8" REDUCER (30 UDACS)
 - 11. REMOVE CAP AND BLOW OFF PER UDACS PLATE NO. 36 & CONNECT TO EX WATER LINE (CONTRACTOR TO VERIFY SIZE, INVERT, AND LOCATION OF EX WATER LINE. IF DISCREPANCY EXISTS, NOTIFY ENGINEER PRIOR TO CONSTRUCTION).
 - 12. INSTALL IRRIGATION SLEEVES PER SUMMERLIN STANDARD DRAWING U-18
 - 13. INSTALL 1" WATER METER W/ 1" RPPA (4 UDACS)
 - 14. INSTALL 5" BEND (31 UDACS)
 - 15. INSTALL 1" WATER METER (4 UDACS)
 - 16. INSTALL 8"x8" TEE (31 UDACS)
- SEWER**
- 17. INSTALL 48" DIA. SEWER MANHOLE (SD 1A UDACS)
 - 18. INSTALL 4" SEWER LATERAL (SD 2 UDACS)
 - 19. REMOVE PLUG & CONNECT TO EX SEWER LATERAL (CONTRACTOR TO VERIFY SIZE, INVERT, AND LOCATION OF EX SEWER LATERAL. IF DISCREPANCY EXISTS, NOTIFY ENGINEER PRIOR TO CONSTRUCTION).
 - 20. ADJUST TO GRADE
 - 21. LATERAL MUST BE CONSTRUCTED OF WATER SUPPLY QUALITY MATERIALS PER UDACS SECTION 2.22.02 B3
- STORM DRAIN**
- 22. INSTALL CLV TYPE "CM2" DROP INLET (SEE PLAN FOR LENGTH)
 - 23. INSTALL NEENAH R-2560-G BEEHIVE DROP INLET

FIRE FLOW CALCULATIONS

FIRE FLOW REQUIREMENT IS 1500 GALLONS PER MINUTE AT 20 PSI.
 SQUARE FOOTAGE: LESS THAN 3,600 SQ. FT.
 LARGEST AREA BETWEEN 4-HOUR: N/A
 AREA SEPARATION WALLS: 20 FT. MAX
 BUILDING HEIGHT: 2
 NUMBER OF STORIES: V-NR
 TYPE OF CONSTRUCTION: RESIDENTIAL
 OCCUPANCY: RESIDENTIAL
 FULL AUTOMATIC: NO
 FIRE SPRINKLER SYSTEM: NO

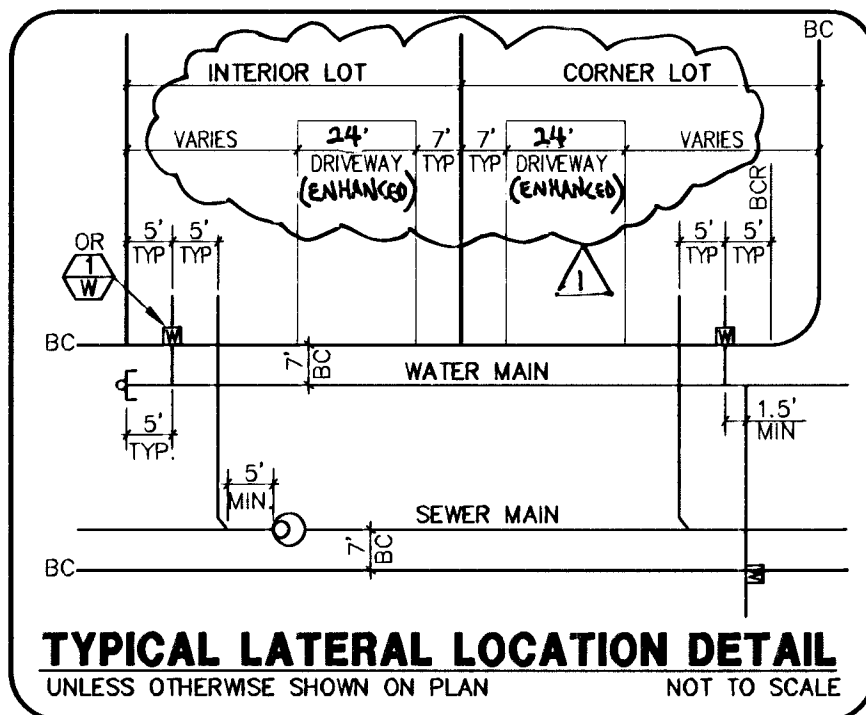

TYPICAL LATERAL LOCATION DETAIL
UNLESS OTHERWISE SHOWN ON PLAN NOT TO SCALE

BENCHMARK

BM #	DESC.	NAVD 88 DATUM	NAVD 88 DATUM
CLV BM No. D368 3	U.S.C. & G.S. BRASS DISC SET IN ROCK ON THE EAST SIDE OF CHARLESTON BOULEVARD AND SOUTH OF THE RED ROCK DETENTION BASIN.	3246.71 (FEET)	989.599 (METERS)

BASIS OF BEARINGS

NORTH 05° 59' 55" WEST BEING THE BEARING OF THE WEST LINE OF SECTION 34, T 20 S, R 59 E, M.D.M., CITY OF LAS VEGAS, CLARK COUNTY, NEVADA, AS SHOWN BY MAP THEREOF ON FILE IN FILE #1, PAGE 28 OF PARCEL MAPS IN THE CLARK COUNTY RECORDERS OFFICE, CLARK COUNTY, NEVADA.

LEGAL DESCRIPTION

LOT 7, 8, & COMMON LOT "G" OF BLOCK B OF "SUMMERLIN VILLAGE 23A UNIT NO. 2" ON FILE IN BOOK 121, PAGE 12 OF PLATS IN THE COUNTY RECORDER'S OFFICE, CLARK COUNTY, NEVADA LYING WITHIN SECTION 34, TOWNSHIP 20 SOUTH, RANGE 59 EAST, M.D.M., CITY OF LAS VEGAS, CLARK COUNTY, NEVADA.

APPROVED FOR CONSTRUCTION
R. Milk
 CITY OF LAS VEGAS FIRE DEPARTMENT
 DATE: 3/2/11

APPROVED FOR CONSTRUCTION
Dea Gregory
 LAS VEGAS VALLEY WATER DISTRICT ENGINEERING SERVICES MANAGER
 PROJECT NO. 116847 DATE: 03/14/11
 CLV DRAWING NO. 107Y1975

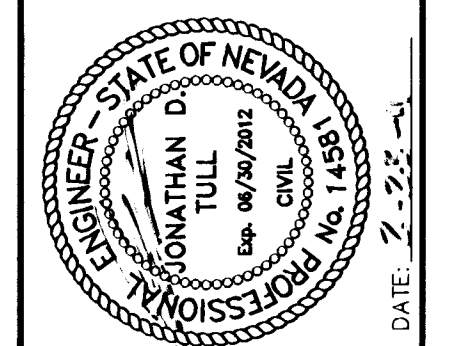

PROJECT NO.	DESIGN	DRAWN	CHECK	DATE
62023-980				

G. C. WALLACE COMPANIES
 ENGINEERS | PLANNERS | SURVEYORS
 1535 S. RAINBOW BOULEVARD - LAS VEGAS, NV 89146
 T: 702.804.3000 - F: 702.804.2299 - GCWALLACE.COM

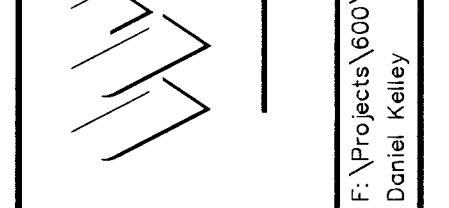

THE HOWARD HUGHES COMPANY, LLC
 SUMMERLIN VILLAGE 23A PARCEL L ANDALUSIA
 UTILITY PLAN III
 H40301

12/25/14
 12/6/12

NOTE
 ALL PRIVATE STREETS ARE P.U.E., PUBLIC SEWER EASEMENTS AND PUBLIC DRAINAGE EASEMENTS TO BE PRIVATELY MAINTAINED BY HOA.

Call before you Dig
 1-702-465-7511
 1-702-229-8811

Call before you Dig
 1-702-227-2929

Call before you Dig
 1-800-227-2600
 1-702-455-7544

WATER NOTE
 THIS PROPERTY MAY HAVE STATIC WATER PRESSURE IN EXCESS OF 80 PSI. THE UNIFORM PLUMBING CODE REQUIRES THAT INDIVIDUAL, ON-SITE (PRIVATE), PRESSURE REDUCING VALVES BE INSTALLED WHENEVER THE PRESSURE EXCEEDS 80 PSI. PRV'S ARE THE DEVELOPER'S RESPONSIBILITY AND WILL NOT BE INSPECTED OR INCLUDED IN THE ACCEPTANCE OF LVWD FACILITIES. EASEMENTS SHALL BE CLEARLY MARKED OR STAKED PRIOR TO THE START OF CONSTRUCTION.

- NOTES:**
- SEE SHEET 2 AND 3 FOR CONSTRUCTION NOTES
 - FOR SEWER & STORM DRAIN DESIGN SEE PLAN & PROFILES
 - FOR STREETLIGHTS SEE STREETLIGHT AND TRAFFIC CONTROL PLAN (SHEETS 23-26).
 - INSTALL PIPELINE MARKER BALLS IN TRENCH ABOVE EACH HORIZONTAL ELBOW FITTING, PER UDACS PLATE NO. 15.

SEWER AVERAGE DAILY FLOWS = 81 LOTS X 250 GPD/ERU = 20,250 (0.0203 MGPD)
 SEWER PEAK FLOWS = 0.0715 MGPD

WATER MAIN JOINT DEFLECTION (PVC 4'-24")
 PVC PIPE SHALL BE DEFLECTED AT THE JOINT ONLY. THE MAXIMUM ALLOWABLE DEFLECTION SHALL BE ONE (1) DEGREE PER JOINT WITH A MINIMUM ALLOWABLE RADIUS OF CURVATURE OF 1,150 FEET, PER UDACS 2.07.01 AND 2.07.02.
 FOR CHANGES IN DIRECTION EXCEEDING THE MAXIMUM ALLOWABLE JOINT DEFLECTION, FITTINGS SHALL BE USED.