

Sep 13, 2012 - 4:18pm - USER: Michael.Wooley
 K:\AV_Public\Trans\092225\021_Bonneville-Clark
 Phase 1\CAD\05\05021RDZ.dwg

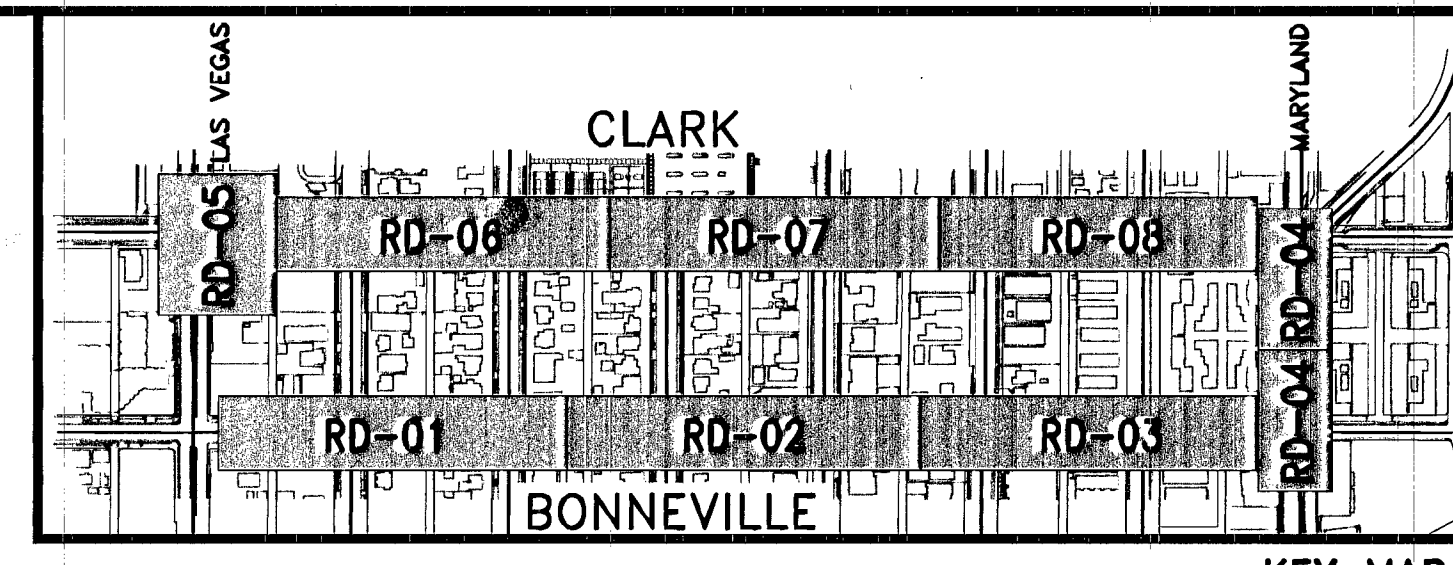
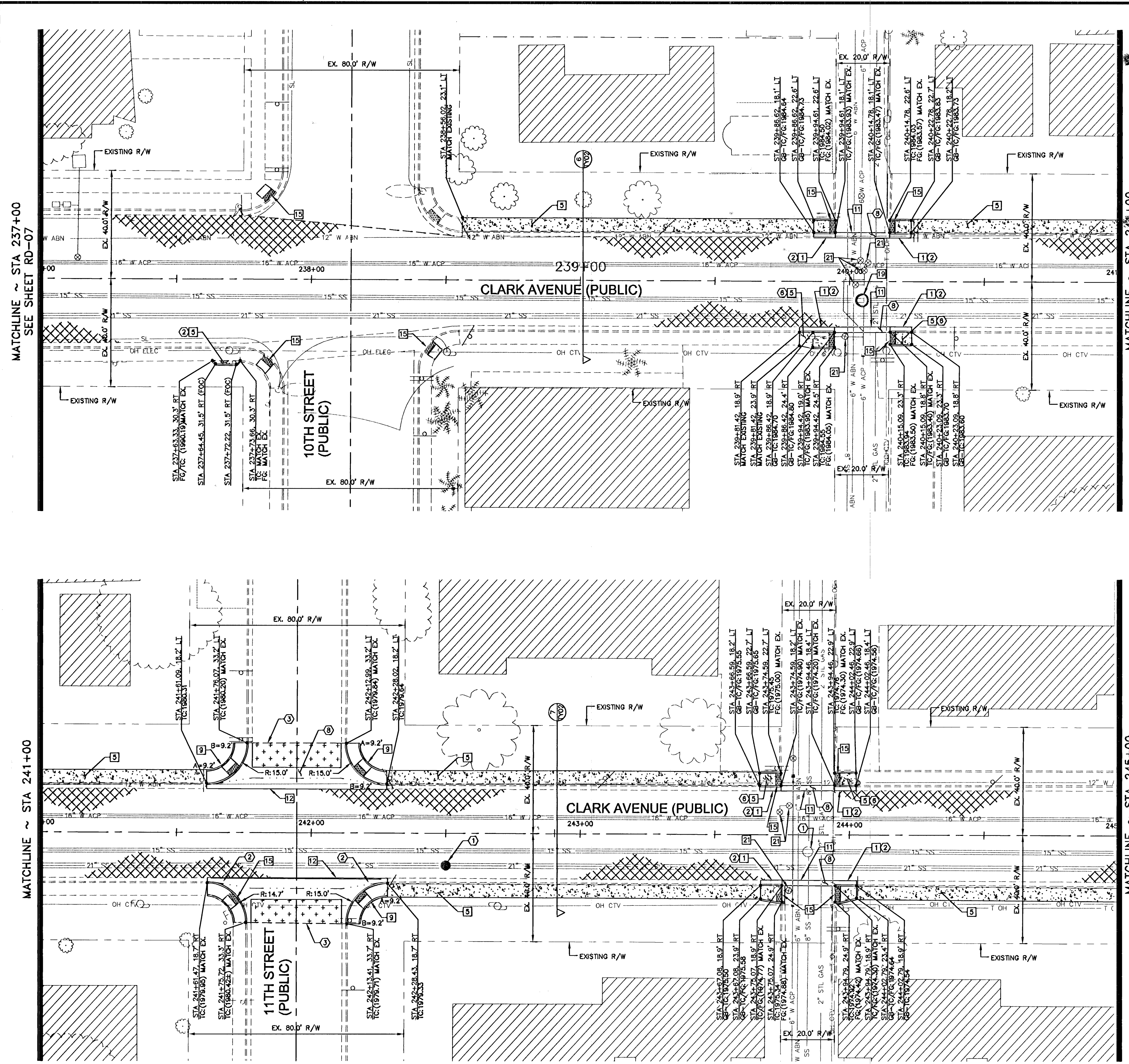

CONSTRUCTION NOTES

- 1 ASPHALTIC CONCRETE PAVEMENT SECTION. (SEE TY SHEETS FOR STRUCTURAL SECTION)
- 2 1" MILL AND 1" UTACS OVERLAY
- 3 ASPHALTIC CONCRETE PATCH (SEE TY SHEETS FOR STRUCTURAL SECTION)
- 4 CONSTRUCT CONCRETE SIDEWALK PER CCAUSD No. 234
- 1) CONSTRUCT "L" TYPE CURB AND GUTTER PER CCAUSD No. 216
- 2) CONSTRUCT "A" TYPE CURB PER CCAUSD No. 219 AND TYPICAL SECTIONS
- 4) CONSTRUCT CASE II SIDEWALK RAMP PER CCAUSD No. 235
- 5) CONSTRUCT CONCRETE SIDEWALK PER CCAUSD No. 234
- 9) CONSTRUCT CASE I SIDEWALK RAMP PER CCAUSD No. 235
- 11) CONSTRUCT 2-FOOT CROSS GUTTER PER DETAIL SHEET RD-01
- 12) CONSTRUCT 8-FOOT VALLEY GUTTER PER CCAUSD No. 228
- 13) REMOVE AND RELOCATE EXISTING STREET LIGHT AND EQUIPMENT. INSTALL NEW H TYPE FOUNDATION
- 14) INSTALL DRIVEWAY PER CCAUSD No. 224
- 15) INSTALL YELLOW TACTILE DOME INDICATOR
- 16) REMOVE AND REPLACE EXISTING BRICK MANHOLE. SEE UT SHEETS FOR DETAILS
- 2) SEE UT SHEETS FOR WATERLINE, VALVE, AND FIRE HYDRANT MODIFICATIONS

DEMOLITION NOTES

- 1) ADJUST EXISTING MANHOLE RIM TO FINISHED GRADE
- 2) REMOVE EXISTING CURB AND GUTTER
- 3) SAWCUT AND REMOVE ASPHALT PAVEMENT TO EXISTING GUTTER
- 5) REMOVE EXISTING LANDSCAPE SHRUBS, REMOVE EXISTING IRRIGATION LINES
- 6) REMOVE EXISTING SIDEWALK
- 7) REMOVE EXISTING UTILITY BOX
- 8) REMOVE EXISTING VALLEY GUTTER

GENERAL NOTES

- 1. ALL STATIONS AND OFFSETS ARE BASED ON CONTROL LINE.
- 2. ELEVATIONS, OFFSETS AND GRADES ARE AT BACK OF CURB UNLESS OTHERWISE NOTED. SEE DETAIL ON RD-09 FOR TYPICAL STATIONING OF PROPOSED RAMPS AT ALLEYS.
- 3. SEE HC SHEETS FOR CENTER LINE INFORMATION, BENCHMARK, AND BASIS OF BEARING.
- 4. ALL EXISTING UTILITY LOCATIONS SHOWN HEREIN ARE APPROXIMATE ONLY. IT SHALL BE THE CONTRACTORS RESPONSIBILITY TO DETERMINE THE EXACT VERTICAL AND HORIZONTAL LOCATION OF ALL EXISTING UNDERGROUND UTILITIES PRIOR TO COMMENCING CONSTRUCTION. NO REPRESENTATION IS MADE THAT ALL UTILITIES ARE SHOWN HEREON. THE ENGINEER ASSUMES NO RESPONSIBILITY FOR UTILITIES NOT SHOWN OR UTILITIES NOT SHOWN IN THEIR PROPER LOCATION.
- 5. CONTRACTOR TO FIELD VERIFY EXISTING SANITARY SEWER AND STORM DRAIN INVERT ELEVATIONS PRIOR TO CONSTRUCTION AND NOTIFY THE ENGINEER OF ANY DISCREPANCIES.
- 6. ALL MANHOLES, VALVES, VAULTS, ETC. LOCATED WITHIN THE LIMITS OF CONSTRUCTION SHALL BE ADJUSTED TO FINISHED GRADE.
- 7. SEE SHEET TY-02 FOR CONDUIT TRENCH PATCH STRUCTURAL SECTION. USE CONDUIT TRENCH PATCH STRUCTURAL SECTION IN AREAS OF CONDUIT INSTALLATION THAT ARE OUTSIDE LIMITS OF FULL PAVEMENT RECONSTRUCTION.

BASIS OF BEARING

THE BASIS OF BEARINGS FOR THIS SURVEY IS GRID NORTH AS DEFINED BY THE NORTH AMERICAN DATUM OF 1983 (NAD 83), NEVADA STATE PLANE EAST (2701) ZONE. SAID BEARINGS WERE DETERMINED BY STATIC POSITIONING SYSTEM (SPS) MEASUREMENTS PROCESSED BY THE NATIONAL GEODETIC SURVEY DIVISION OF THE NATIONAL OCEANIC AND ATMOSPHERIC ADMINISTRATION USING THE ON-LINE POSITIONING USER SERVICE (OPUS). THE REFERENCE FRAME USED WAS NAD83 (GCS98) WITH AN EPOCH OF 2002.0000. ALL DISTANCES SHOWN HEREON ARE GROUND VALUES.

BENCHMARK

CITY OF LAS VEGAS VERTICAL CONTROL POINT "6C01 345WB", BEING A RIVET & PLATE IN TOP OF CURB ON THE EAST SIDE OF MAIN BETWEEN BONNEVILLE & GARCES LIGHT POLE.
 ELEVATION: 2027.08 (FEET)
 617.8544 (METERS)
 CITY OF LAS VEGAS VERTICAL CONTROL DATED 08/2002 BASED UPON THE NORTH AMERICAN VERTICAL DATUM OF 1988 (NAVD 88).

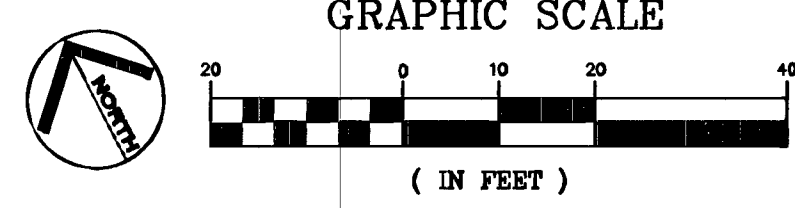

811
 SAFETY ALERT
 Call Before You Dig
 Call before you dig! 702-227-2929

DATE: _____
 REVISIONS: _____
 SCALE (V): _____
 SCALE (H): _____
 DRAWN BY: _____
 DESIGNED BY: _____
 CHECKED BY: _____
 © 2012

Kimley-Horn and Associates, Inc.
 Engineering, Planning, and Environmental Consultants
 4000 Flamingo Road, Suite 210, Las Vegas, NV 89119
 FAX 702.735.4448

DEPARTMENT OF PUBLIC WORKS
 PROJECT: BONNEVILLE/CLARK ONEWAY COUPLLET PHASE II IMPROVEMENT PLANS
 SHEET: CLARK AVENUE ROADWAY IMPROVEMENT PLAN

9/26/12
 SHEET NO. RD-08
 SHEET 19 OF 47
 DRAWING NO. 107V5541
 DE-SIP-0003(160)