

MATCHLINE ~ STA 127+90
SEE SHEET RD-01

MATCHLINE ~ STA 132+10
SEE SHEET RD-03

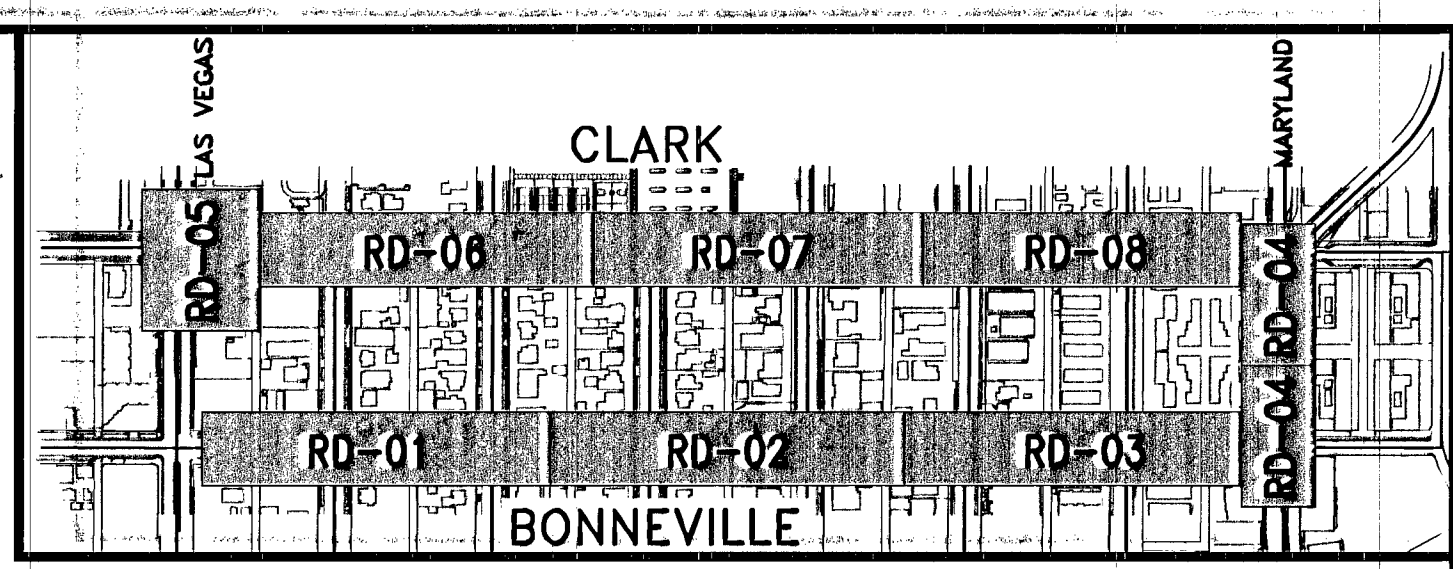

KEY MAP
CLARK COUNTY, NEVADA
RD-01, RD-02, RD-03, RD-04, RD-05, RD-06, RD-07, RD-08

- CONSTRUCTION NOTES**
- 1 ASPHALTIC CONCRETE PAVEMENT SECTION. (SEE TY SHEETS FOR STRUCTURAL SECTION)
 - 2 1" MILL AND 1" UTACS OVERLAY
 - 3 ASPHALTIC CONCRETE PATCH (SEE TY SHEETS FOR STRUCTURAL SECTION)
 - 4 CONSTRUCT CONCRETE SIDEWALK PER CCAUSD No. 234
 - 5 CONSTRUCT "L" TYPE CURB AND GUTTER PER CCAUSD No. 216
 - 6 CONSTRUCT "A" TYPE CURB PER CCAUSD No. 219 AND TYPICAL SECTIONS
 - 7 CONSTRUCT CASE II SIDEWALK RAMP PER CCAUSD No. 235
 - 8 CONSTRUCT CONCRETE SIDEWALK PER CCAUSD No. 234
 - 9 CONSTRUCT CASE I SIDEWALK RAMP PER CCAUSD No. 235
 - 10 CONSTRUCT 2-FOOT CROSS GUTTER PER DETAIL SHEET RD-01
 - 11 CONSTRUCT 8-FOOT VALLEY GUTTER PER CCAUSD No. 228
 - 12 REMOVE AND RELOCATE EXISTING STREET LIGHT AND EQUIPMENT. INSTALL NEW H TYPE FOUNDATION
 - 13 INSTALL DRIVEWAY PER CCAUSD No. 224
 - 14 INSTALL YELLOW TACTILE DOME INDICATOR
 - 15 REMOVE AND REPLACE EXISTING BRICK MANHOLE, SEE UT SHEETS FOR DETAILS.
 - 16 SEE UT SHEETS FOR WATERLINE, VALVE, AND FIRE HYDRANT MODIFICATIONS

- DEMOLITION NOTES**
- 1 ADJUST EXISTING MANHOLE RIM TO FINISHED GRADE
 - 2 REMOVE EXISTING CURB AND GUTTER
 - 3 SAWCUT AND REMOVE ASPHALT PAVEMENT TO EXISTING GUTTER
 - 4 REMOVE EXISTING LANDSCAPE SHRUBS, REMOVE EXISTING IRRIGATION LINES
 - 5 REMOVE EXISTING SIDEWALK
 - 6 REMOVE EXISTING UTILITY BOX
 - 7 REMOVE EXISTING VALLEY GUTTER
 - 8 SEE SD SHEETS FOR STORM DRAIN REMOVALS

- GENERAL NOTES**
1. ALL STATIONS AND OFFSETS ARE BASED ON CONTROL LINE.
 2. ELEVATIONS, OFFSETS AND GRADES ARE AT BACK OF CURB UNLESS OTHERWISE NOTED. SEE DETAIL ON RD-09 FOR TYPICAL STATIONING OF PROPOSED RAMPS AT ALLEYSWAYS.
 3. SEE HC SHEETS FOR CENTER LINE INFORMATION, BENCHMARK, AND BASIS OF BEARING.
 4. ALL EXISTING UTILITY LOCATIONS SHOWN HEREIN ARE APPROXIMATE ONLY. IT SHALL BE THE CONTRACTORS RESPONSIBILITY TO DETERMINE THE EXACT VERTICAL AND HORIZONTAL LOCATION OF ALL EXISTING UNDERGROUND UTILITIES PRIOR TO COMMENCING CONSTRUCTION. NO REPRESENTATION IS MADE THAT ALL UTILITIES ARE SHOWN HEREON. THE ENGINEER ASSUMES NO RESPONSIBILITY FOR UTILITIES NOT SHOWN OR UTILITIES NOT SHOWN IN THEIR PROPER LOCATION.
 5. CONTRACTOR TO FIELD VERIFY EXISTING SANITARY SEWER AND STORM DRAIN INVERT ELEVATIONS PRIOR TO CONSTRUCTION AND NOTIFY THE ENGINEER OF ANY DISCREPANCIES.
 6. ALL MANHOLES, VALVES, VAULTS, ETC. LOCATED WITHIN THE LIMITS OF CONSTRUCTION SHALL BE ADJUSTED TO FINISHED GRADE.
 7. SEE SHEET TY-02 FOR CONDUIT TRENCH PATCH STRUCTURAL SECTION. USE CONDUIT TRENCH PATCH STRUCTURAL SECTION IN AREAS OF CONDUIT INSTALLATION THAT ARE OUTSIDE LIMITS OF FULL PAVEMENT RECONSTRUCTION.

BASIS OF BEARING
THE BASIS OF BEARINGS FOR THIS SURVEY IS GRID NORTH AS DEFINED BY THE NORTH AMERICAN DATUM OF 1983 (NAD 83), NEVADA STATE PLANE EAST (2701) ZONE. SAID BEARINGS WERE DETERMINED BY STATIC GLOBAL POSITIONING SYSTEM (GPS) MEASUREMENTS PROCESSED BY THE NATIONAL GEODETIC SURVEY DIVISION OF THE NATIONAL OCEANIC AND ATMOSPHERIC ADMINISTRATION USING THE ON-LINE POSITIONING USER SERVICE (OPUS). THE REFERENCE FRAME USED WAS NAD83 (CORRS96) WITH AN EPOCH OF 2002.0000. ALL DISTANCES SHOWN HEREON ARE GROUND VALUES.

BENCHMARK
CITY OF LAS VEGAS VERTICAL CONTROL POINT "6001 34SW6", BEING A RIVET & PLATE IN TOP OF CURB ON THE EAST SIDE OF MAIN BETWEEN BONNEVILLE & GARCES LIGHT POLE.
ELEVATION: 2027.08 (FEET)
617.8544 (METERS)
CITY OF LAS VEGAS VERTICAL CONTROL DATED 08/2002 BASED UPON THE NORTH AMERICAN VERTICAL DATUM OF 1988 (NAVD 88).

GRAPHIC SCALE
(IN FEET)

811 SAFETY ALERT
Call before you dig
Call before you dig
Call before you dig

CALL SOUTHWEST GAS
at 365-2296 for Standby
when excavating over or near
HIGH PRESSURE GAS LINES

PROFESSIONAL ENGINEER-STATE OF NEVADA
PETER N. MEYERHOFER
Exp. 12/31/13
CIVIL
No. 18093

DATE: 9/28/12
CHECKED BY: [Signature]
DESIGNED BY: [Signature]
SCALE (S): [Blank]
SCALE (M): [Blank]
DRAWN BY: [Signature]

PROJECT: BONNEVILLE/CLARK ONEWAY COUPLER PHASE II IMPROVEMENT PLANS
SHEET: RD-02
SHEET 13 OF 47
107V5541

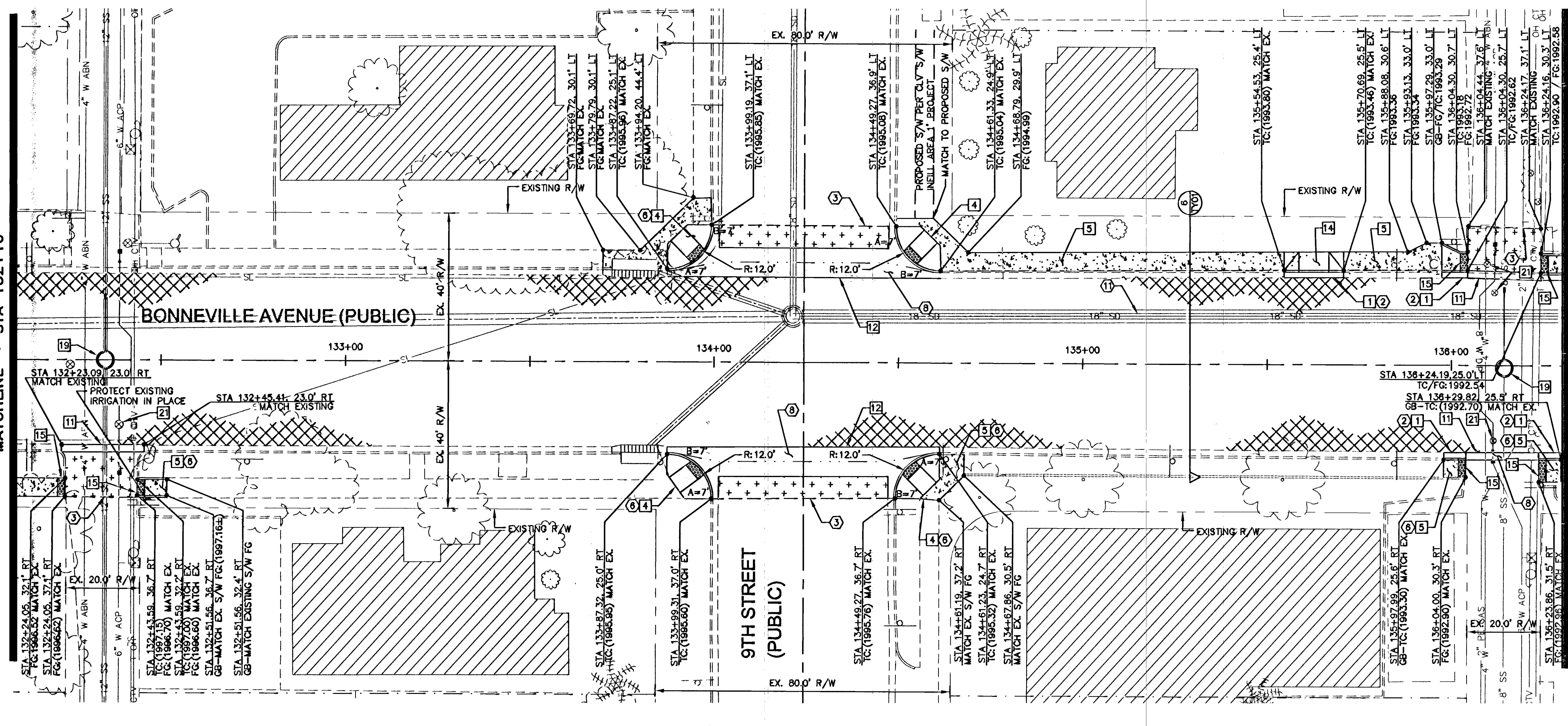

MATCHLINE ~ STA 132+10
SEE SHEET RD-01

MATCHLINE ~ STA 136+30
SEE SHEET RD-03

SEP 13, 2012 - 4:17pm - USER: Michael.Mosley
K:\AV_Public\Trans\092256\021_Bonneville-Clark_Phase II\CA00\256021RD02.dwg

DEPARTMENT OF PUBLIC WORKS
BONNEVILLE/CLARK ONEWAY COUPLER PHASE II IMPROVEMENT PLANS
BONNEVILLE AVENUE ROADWAY IMPROVEMENT PLAN