

Submitted by Moote, Kempa & Galloway Date 5/19/63
 Approved by R. J. Lawler City Engineer Date 4-17-64
 Approved by: J. A. Nielsen Field Engineer Date 4-17-64

BENCH MARK Spike in PP # 2708 approx 300' N of W 1/4 corner on W side of Decatur Ave. ELEVATION 2203.81'

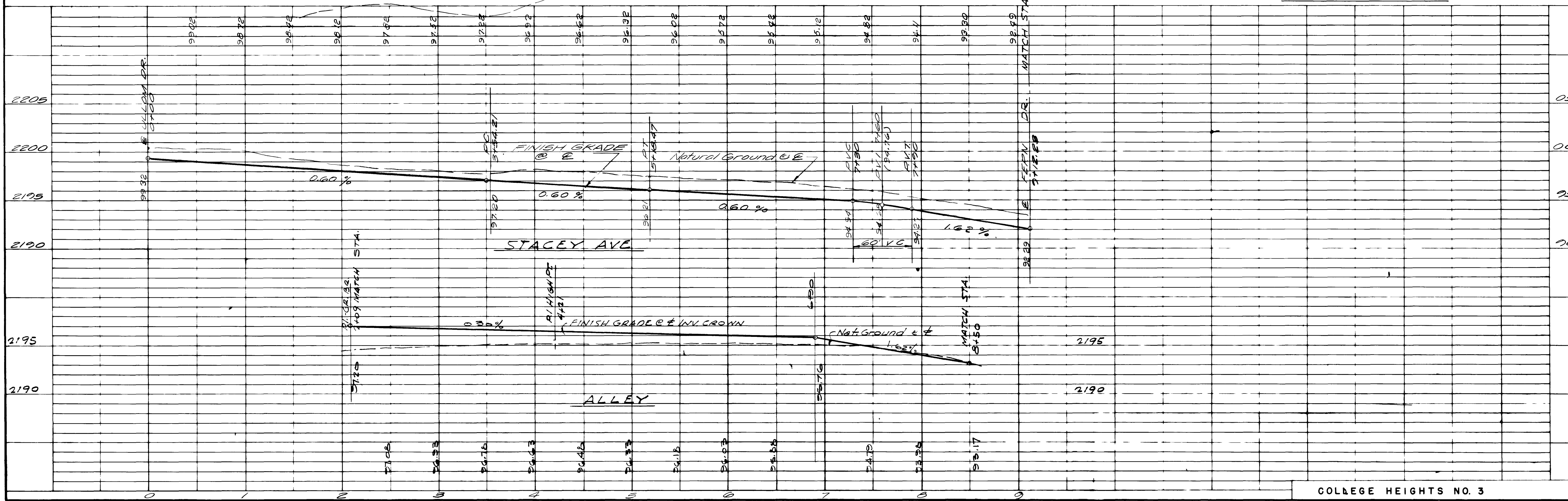

COLLEGE HEIGHTS NO. 3	
PART OF THE 1/2 OF SECTION 19, T.20S., R.8E., M.8B. SM., CLARK COUNTY, NEVADA	
PREPARED FOR FIRST WESTERN SAVING & LOAN	
PAYING PLAN AND PROFILE	DATE 5-3-63
MOOTE, KEMPA & GALLOWAY, INC.	SCALE 1"=30'
CIVIL ENGINEERS LAND PLANNERS LAND SURVEYORS	SCALE 1"=30'
CITY OF LAS VEGAS	APPD R/JG
DR FILE	DR FILE
13	40

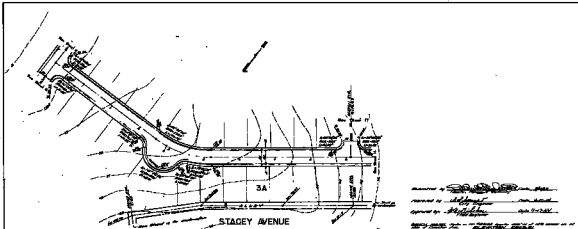

Drawn by [Signature]
 Checked by [Signature]
 Approved by [Signature] Date 1-2-24
 Scale 1" = 40'

