

CLV. BENCH MARK:
 N.W. COR. CAREY & HIGHLAND
 5' WEST OF CURB RETURN ON
 CAREY ON TOP OF CURB
 ELEVATION (PER FIELD DISTANCE)
 70.6114'

72
 71
 70
 69
 68

ITEM	AMOUNT
2" A.C. PAVING	6,356 S.F.
2 1/2" A.C. PAVING	5,750 "
12" TYPE CURB & GUTTER	4,895 L.F.
VALLEY GUTTER	2,920 S.F.
SIDEWALK	24,475 S.F.

NOTE: Permission to remove sections of existing C&G and to construct AC paving North of & to be obtained from City of No. Las Vegas.

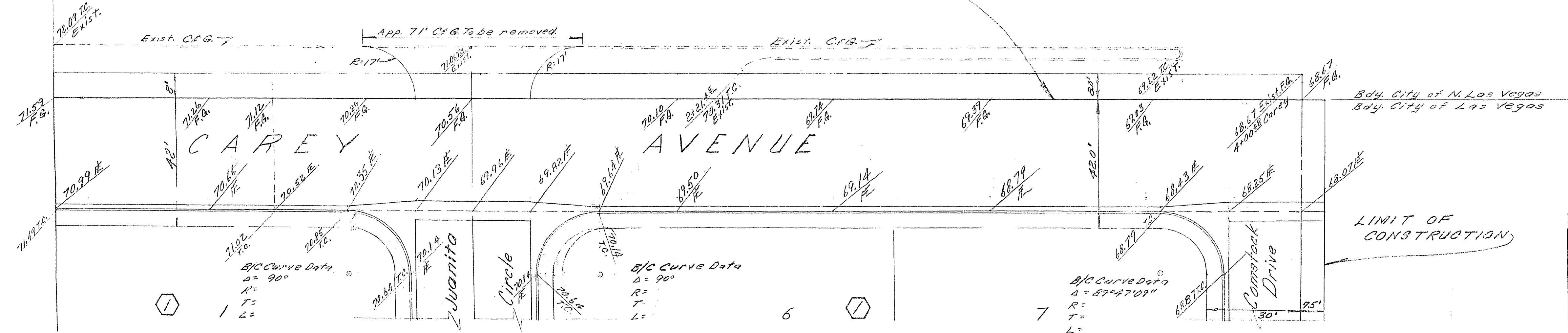

Engineer: W.T. de Volcourt, Jr.
 W.T. de Volcourt, Jr. R.C.E. 1816

Approved: [Signature] 6-22-64
 City Engineer.

H.P. Johnson 6-12-64
 Field Engineer

2	4/14	Moved Carey Ave. Sewer & Removed 4.5' Parkway	WH	6/17/64	
1	5/14	General Revision According to C.L.V.	WH	6/17/64	
NO. DATE		REVISIONS	BY	CK	CLIENT APPROVAL
BUSINESS ENGINEERING ARCHITECTURE MANAGEMENT, INC. LAS VEGAS, NEVADA					
DRAWN BY WH			CHECKED BY [Signature]		
COLLEGE HEIGHTS #6 STREET PLAN & PROFILE			SCALE 1"=20'		
DIV. MGR. B.L.O.			SHEET 2 OF 24		
DRAWING NO.					

beam, inc.

Carey Ave.
 1074-1110-6