

NOTE
Provide H.C. Laterals to Future Lots 68-75 Block 15 on North Side of Alta Drive

Exist 8" VCP Sewer per Charleston Rainbow Unit 9A

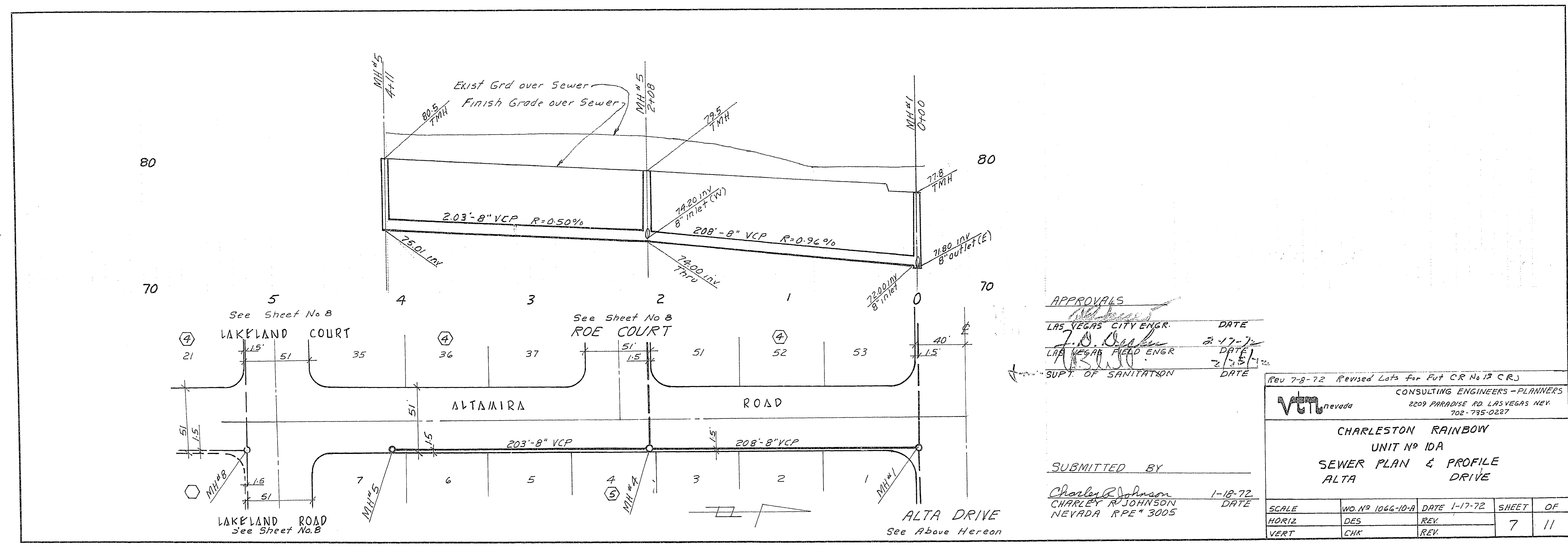

APPROVALS
LAS VEGAS CITY ENGR. DATE
LAS VEGAS FIELD ENGR. DATE
S.U.P.T. OF SANITATION DATE

SUBMITTED BY
Charles Johnson 1-18-72
CHARLEY R. JOHNSON
NEVADA RPE # 3005 DATE

Rev 7-8-72 Revised Lots for Fut CR No 13 CRJ				
CONSULTING ENGINEERS-PLANNERS				
VCP Nevada				
2209 PARADISE RD LAS VEGAS NEV. 702-735-0227				
CHARLESTON RAINBOW UNIT # 10A				
SEWER PLAN & PROFILE				
ALTA DRIVE				
SCALE	WO. NO 1066-10-A	DATE 1-17-72	SHEET	OF
HORIZ	DES	REV	7	11
VERT	CHK	REV		

3074.1055-10A