

CHARLESTON RAINBOW UNIT 1

SCALE 1" = 60'

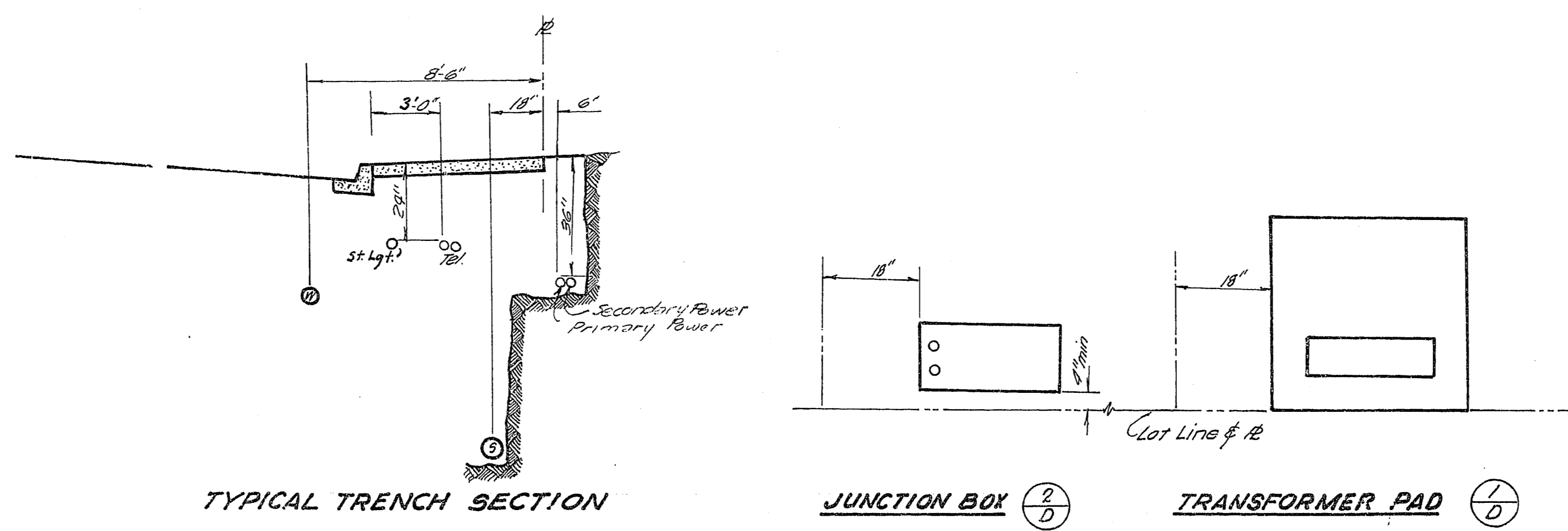

- SPECIFICATIONS:**
1. High voltage cable shall be one conductor 15 KV #2 cu crossed linked polyethylene insulated with concentric neutral. Cable shall be purchased in accordance with Nevada Power Co. specifications & Nevada Power Co. Drwgs # 2-508 shis 1-3, and bid list.
 2. All secondary cable shall be rated 600 volt and be stranded aluminum conductor Type T.H.W. or X.L.P.
 3. All conduit shall be A.B.S. plastic and meet Western Underground Specifications No 3.1, Rev #7. Conduit shall be installed per Nevada Power Co. specifications. All duct installed in travelled areas shall be encased in a 3" red concrete envelope.
 4. See attached specifications on cable, conduit, transformer pads, pull boxes, etc. Refer to Nevada Power Co. Drwgs, No 3-101, 3-301, 3-510, 5-510, 3-10, 2-501, & 5-100.
 5. All primary conduit shall be 2" unless otherwise shown.
 6. All secondary conduit shall be 3" unless otherwise shown.
 7. Nevada Power Co. to furnish and install all transformers.
 8. Contractor awarded this job is to notify Nevada Power Co. Inspector 48 hrs. in advance of start of electrical construction. Tel. 394-4600 ext. 376

- ESTIMATE OF QUANTITIES:**
- ⊙ Transformer pads 9 @
 - Junction boxes 31 @
 - 2" A.B.S. (D.B.) primary conduit.
 - 3" A.B.S. (D.B.) secondary conduit. will size when design approved
 - T.P.B. 2101 with traffic cover.

APPROVALS:

Dr. C. Blithen 10-15-69
Nevada Power Co.
Coordinated with:

R. C. Schuman 10/16/69
Central Telephone Co.

W. J. Bessant 10-28-69
City Electrician

W. J. Bessant 10-30-69
City Engineer

VOORHEIS-TRINDLE CO. OF NEVADA 2209 Paradise Road Las Vegas, Nevada	
CHARLESTON RAINBOW UNIT 9-E MASTER ELECTRIC PLAN	
Submitted by:	Sheet 8
Victor G. Kramelbauer R.C.E. # 1511	10/28/69