

EXIST. 5/2
 @ PARK OLIVER I

OWNER/SUBDIVIDER
 BIVINS CONSTRUCTION CO., INC.
 620 N. 11TH ST.
 LAS VEGAS, NEV.
 (702) 394-7575

ENGINEER
 MARK L. RUBY
 2517 CHESTNUT AVE.
 LAS VEGAS, NEV.
 (702) 452-2487

LEGAL DESCRIPTION
 A PORTION OF THE NW 1/4
 SECTION 30, T. 20S, R. 62E, N. 41M.
 LAS VEGAS, NEV.

UTILITY
 ELECT. NEMADA POWER CO.
 TELEPHONE CENTRAL TELEPHONE CO.
 GAS SOUTHWEST GAS CORP.
 SOLID WASTE SILVER STATE DISPOSAL
 WATER LAS VEGAS VALLEY WATER DIST.
 SEWER CITY OF LAS VEGAS
 CONTRIBUTION: AV. 16,960 GPD
 PEAK 226,184 GPD

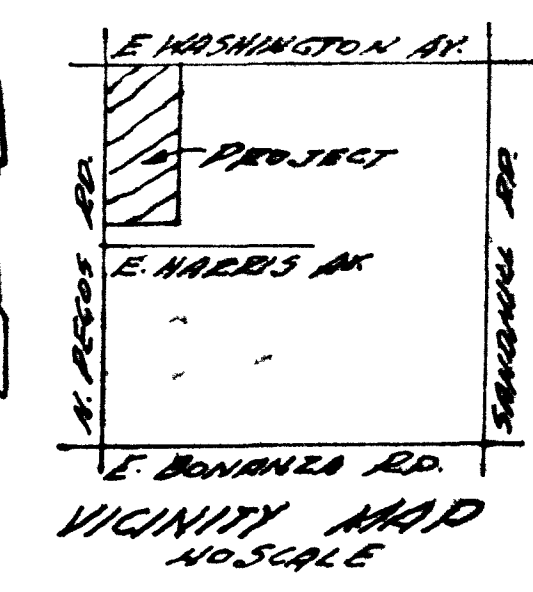

NOTE:
 STREET LIGHT LOCATIONS
 TO BE ADJUSTED IN
 FIELD

SERVICE POINT
 EXACT LOCATION
 TO BE DETER-
 MINED IN FIELD

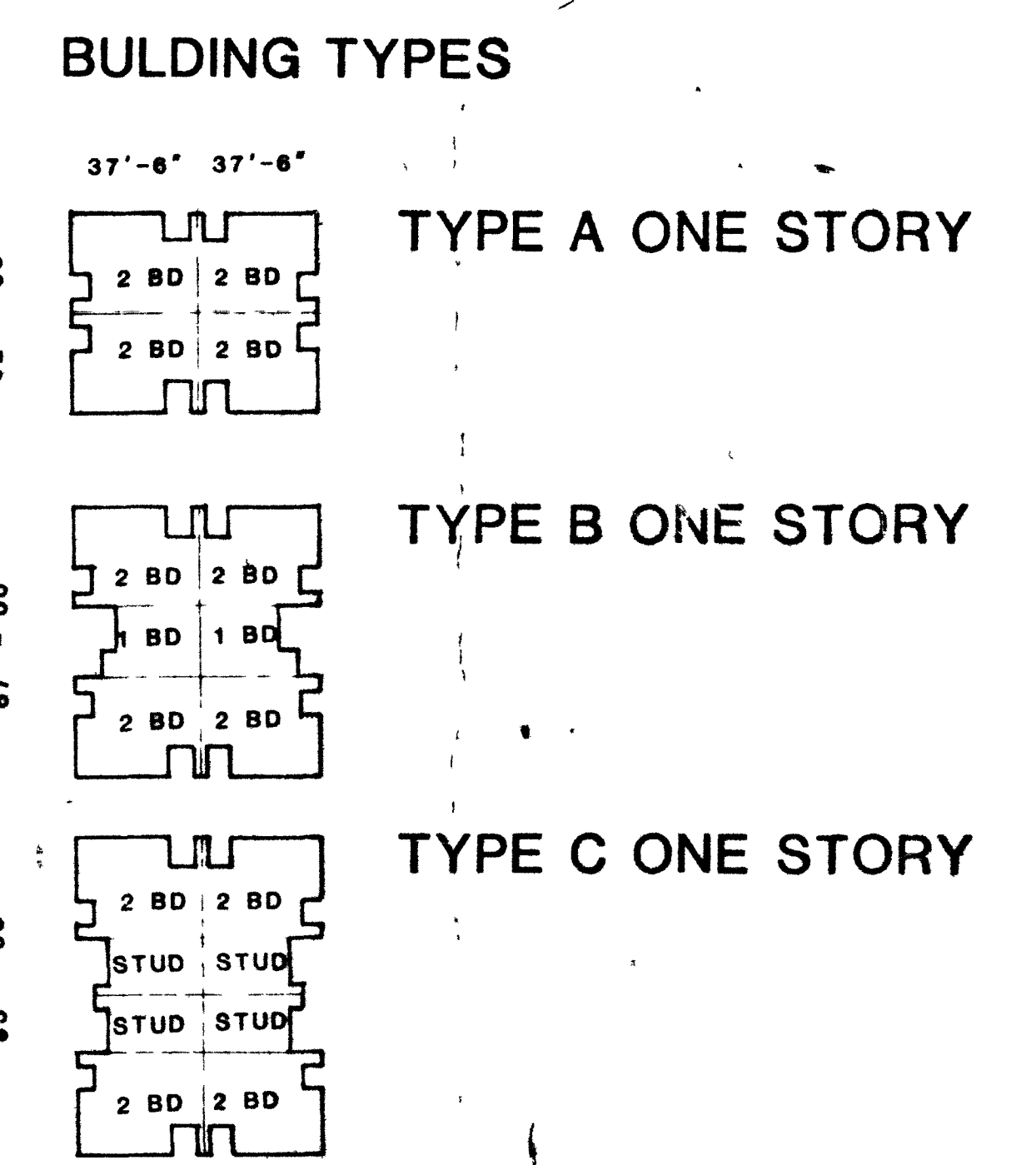
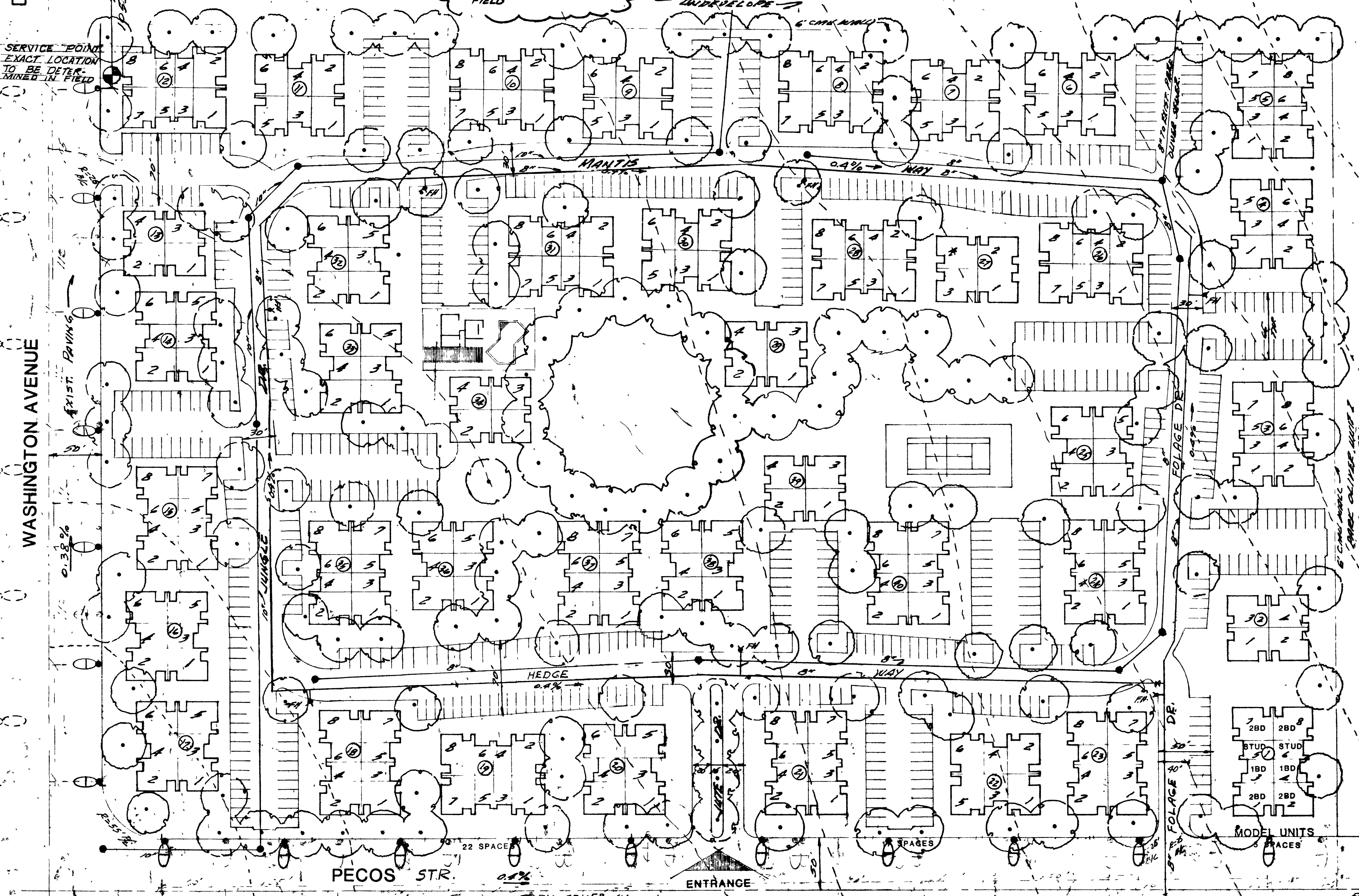

○ Block No.
 6 Lot No.

GENERAL DATA

AREA: 22.9 GROSS ACRES
 ZONING: R-PD 12
 NUMBER OF BUILDINGS:
 TYPE A: 6
 TYPE B: 16
 TYPE C: 18

UNIT TYPES:
 STUDIO: 72 UNITS
 1 BD: 32 UNITS
 2 BD: 160 UNITS
 264 UNITS

73 ON STREET PARKING SPACES
 587 OFF STREET PARKING SPACES
 660 TOTAL

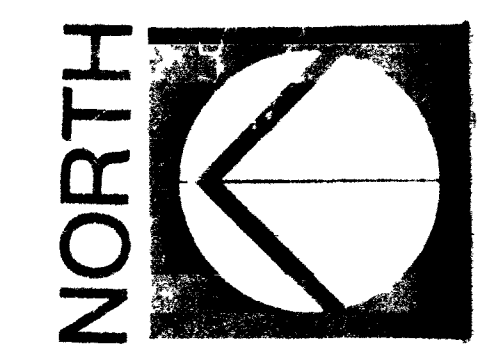

E. HARRIS AVE.
 NIP Co. SERVICE POINT
 EXIST. 5/2 @ PARK
 OLIVER I
 SCALE: 1" = 50',00"

DATE: DECEMBER 22, 1980

NOTE: EAST SANITARY SEWER IN
 PECOS STR. WILL NOT BE
 USED IN THIS PROJECT.

RESIDENTIAL PLANNED DEVELOPMENT
BIVINS CONSTRUCTION CO., INC.
 NEVADA

Consent Return 9/1/81
 CIVIL ENGINEER COORDINATOR
 5-19-81
 CIVIL ELECTRICAL SUPERVISOR
 CIVIL QUALITY CONTROL SUPERVISOR
 CIVIL SUPERVISOR

OVERALL STREET LIGHTING
 OF
ATRIUM GARDENS

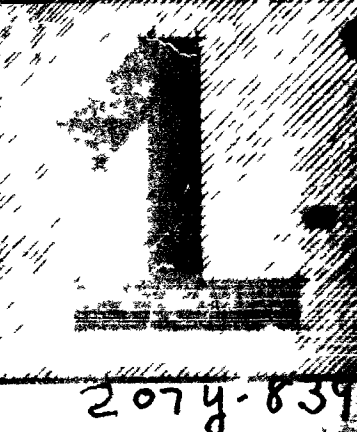

AS 11-1-8277

32-17

16-6-99

2078-831



General Information
 Project Name: Atrium Gardens
 Location: Washington Avenue
 Date: December 28, 1990

Street Address: 1000 Washington Ave
 City: St. Louis, MO
 State: MO
 County: St. Louis County
 Subdivision: Atrium Gardens



BUILDING TYPES

TYPE A ONE STORY
 TYPE B ONE STORY
 TYPE C ONE STORY

GENERAL DATA

Total Area: 100,000 sq. ft.
 Building Area: 80,000 sq. ft.
 Parking: 100 spaces
 Landscaping: 20,000 sq. ft.
 Amenities: Clubhouse, Pool, Tennis Courts

NORTH

 SCALE 1" = 80.00'
 DATE: DECEMBER 28, 1990

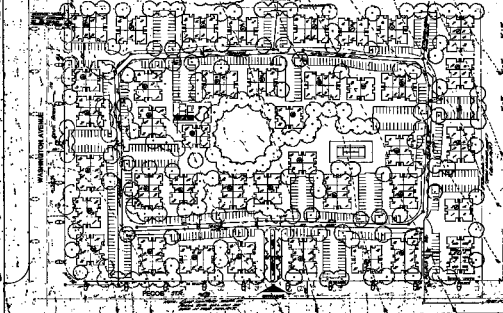

RESIDENTIAL PLANNED DEVELOPMENT
 BY
BRVNS CONSTRUCTION CO., INC.

ARCHITECT: [Faded text]
 ENGINEER: [Faded text]

OVERALL STREET LIGHTING
ATRIUM GARDENS