

NOTE
 The 3/4" Copper Laterals for Lots 10-16 Block 9 & 17-19 Block 5 were constructed by Charleston Rainbow Unit 10-A. The services will still require meters.

NOTE
 Construct 3/4" copper or approved plastic service for future lots 1, 2, 3, 4, & 28 Block 4.

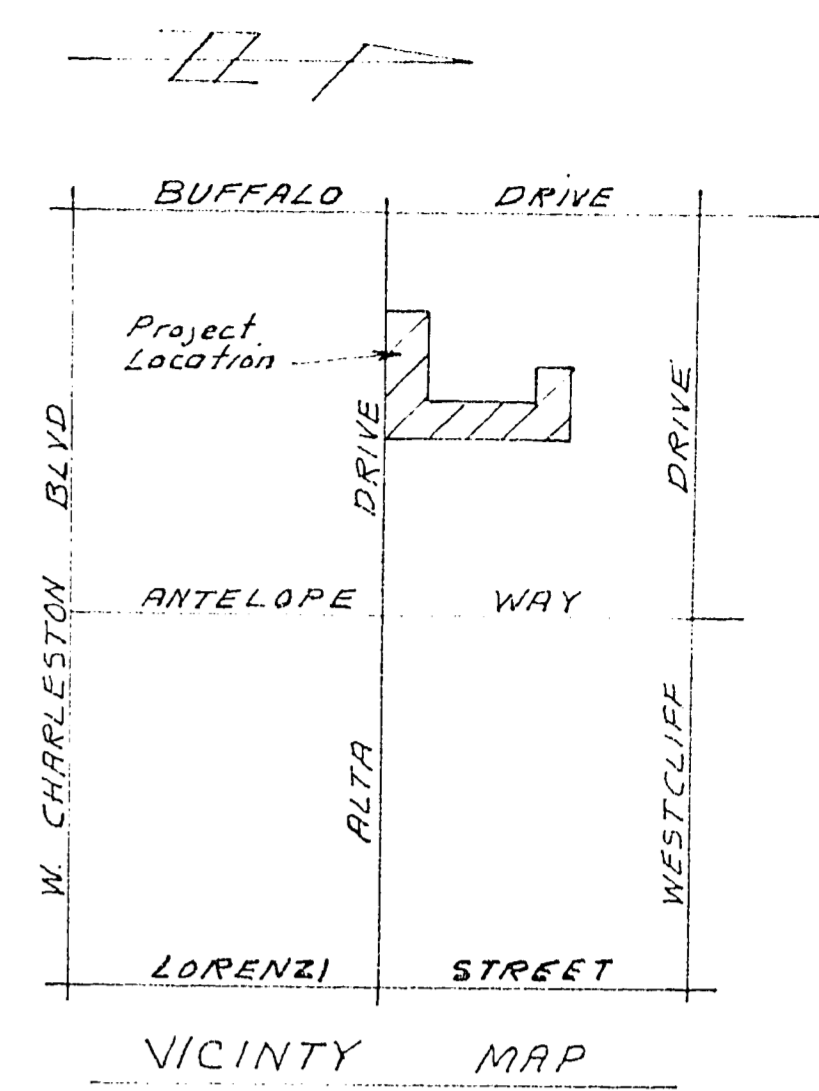

LEGEND & QUANTITY ESTIMATE

1. Std Fire Hydrant w/6" G.V.	3 EA.
2. 6" Gate Valve	6 EA.
3. 6"x6"x8" Tee	1 EA.
4. 6"x6"x6" Tee	3 EA.
3/4" Copper or Approved Plastic Services with 3/4" meter	30 EA.
3/4" Meter (Copper Service Exist)	10 EA.
8" ACP	275 LF
6" ACP	1802 LF

- GENERAL NOTES**
- All work except as modified hereon shall be done in strict accordance with Clark County Standard Specifications.
 - Service saddles or tapped collars will be required on services.
 - Parallel sewer & water lines shall have a minimum of ten (10) feet horizontal separation & three (3) foot minimum vertical separation on all water lines.
 - Notice to be given Engineering Department of the Las Vegas Valley Water District forty eight (48) hours prior to actual construction.
 - Deflection angle shall not exceed 5° per thirteen (13) foot section of pipe for pipe sizes smaller than ten (10) inches & shall not exceed 3° for pipe sizes ten (10) inches & larger.
 - Contractor to provide thrust blocks as required.
 - All lines to be pressure tested to 200 psi.
 - All work to conform to Las Vegas Valley Water District Standard Specifications S-1.

- All Flanged Fittings to be coated with EC-244 & wrapped with 10-mil thick polyethylene.
- All valve boxes shall have Concrete Collars & Surface of paved Areas.

APPROVED BY

 LAS VEGAS VALLEY WATER DISTRICT DATE _____

 LAS VEGAS CITY ENGINEER DATE _____

 CITY OF LAS VEGAS FIELD ENGINEER DATE _____

 CITY OF LAS VEGAS FIRE DEPARTMENT DATE _____

 CLARK COUNTY HEALTH DEPT DATE _____

SUBMITTED BY
 Charles R. Johnson 10/11/72
 CHARLEY R. JOHNSON NEV RPE #3005 DATE

		CONSULTING ENGINEERS • PLANNERS <small>2200 FREEMAN ROAD LAS VEGAS NEVADA 89105</small> <small>702-733-0277</small>	
CHARLESTON RAINBOW NO. 13-A MASTER WATER PLAN			
SCALE:	WO. NO. 1066-13A	DATE 10/11/72	SHEET OF
HORIZ. 1"=60'	DES.	REV.	7 8
VERT.	CHK.	REV.	

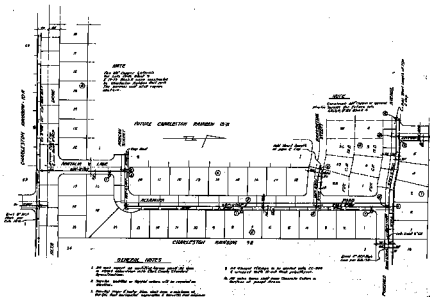

NOTE
 Do not change letters
 or numbers on this plan
 without approval of the
 architect and city engineer.

- GENERAL NOTES**
- All work shall be done in accordance with the specifications and drawings.
 - Work shall be done in accordance with the specifications and drawings.
 - Work shall be done in accordance with the specifications and drawings.
 - Work shall be done in accordance with the specifications and drawings.
 - Work shall be done in accordance with the specifications and drawings.
 - Work shall be done in accordance with the specifications and drawings.
 - Work shall be done in accordance with the specifications and drawings.
 - Work shall be done in accordance with the specifications and drawings.
 - Work shall be done in accordance with the specifications and drawings.
 - Work shall be done in accordance with the specifications and drawings.

- All work shall be done in accordance with the specifications and drawings.
- All work shall be done in accordance with the specifications and drawings.



LEADERS' QUANTITIES

1. 1/2" x 1/2" x 1/2" x 1/2"	1.00
2. 1/2" x 1/2" x 1/2" x 1/2"	1.00
3. 1/2" x 1/2" x 1/2" x 1/2"	1.00
4. 1/2" x 1/2" x 1/2" x 1/2"	1.00
5. 1/2" x 1/2" x 1/2" x 1/2"	1.00
6. 1/2" x 1/2" x 1/2" x 1/2"	1.00
7. 1/2" x 1/2" x 1/2" x 1/2"	1.00
8. 1/2" x 1/2" x 1/2" x 1/2"	1.00
9. 1/2" x 1/2" x 1/2" x 1/2"	1.00
10. 1/2" x 1/2" x 1/2" x 1/2"	1.00
11. 1/2" x 1/2" x 1/2" x 1/2"	1.00
12. 1/2" x 1/2" x 1/2" x 1/2"	1.00
13. 1/2" x 1/2" x 1/2" x 1/2"	1.00
14. 1/2" x 1/2" x 1/2" x 1/2"	1.00
15. 1/2" x 1/2" x 1/2" x 1/2"	1.00
16. 1/2" x 1/2" x 1/2" x 1/2"	1.00
17. 1/2" x 1/2" x 1/2" x 1/2"	1.00
18. 1/2" x 1/2" x 1/2" x 1/2"	1.00
19. 1/2" x 1/2" x 1/2" x 1/2"	1.00
20. 1/2" x 1/2" x 1/2" x 1/2"	1.00
21. 1/2" x 1/2" x 1/2" x 1/2"	1.00
22. 1/2" x 1/2" x 1/2" x 1/2"	1.00
23. 1/2" x 1/2" x 1/2" x 1/2"	1.00
24. 1/2" x 1/2" x 1/2" x 1/2"	1.00
25. 1/2" x 1/2" x 1/2" x 1/2"	1.00
26. 1/2" x 1/2" x 1/2" x 1/2"	1.00
27. 1/2" x 1/2" x 1/2" x 1/2"	1.00
28. 1/2" x 1/2" x 1/2" x 1/2"	1.00
29. 1/2" x 1/2" x 1/2" x 1/2"	1.00
30. 1/2" x 1/2" x 1/2" x 1/2"	1.00
31. 1/2" x 1/2" x 1/2" x 1/2"	1.00
32. 1/2" x 1/2" x 1/2" x 1/2"	1.00
33. 1/2" x 1/2" x 1/2" x 1/2"	1.00
34. 1/2" x 1/2" x 1/2" x 1/2"	1.00
35. 1/2" x 1/2" x 1/2" x 1/2"	1.00
36. 1/2" x 1/2" x 1/2" x 1/2"	1.00
37. 1/2" x 1/2" x 1/2" x 1/2"	1.00
38. 1/2" x 1/2" x 1/2" x 1/2"	1.00
39. 1/2" x 1/2" x 1/2" x 1/2"	1.00
40. 1/2" x 1/2" x 1/2" x 1/2"	1.00
41. 1/2" x 1/2" x 1/2" x 1/2"	1.00
42. 1/2" x 1/2" x 1/2" x 1/2"	1.00
43. 1/2" x 1/2" x 1/2" x 1/2"	1.00
44. 1/2" x 1/2" x 1/2" x 1/2"	1.00
45. 1/2" x 1/2" x 1/2" x 1/2"	1.00
46. 1/2" x 1/2" x 1/2" x 1/2"	1.00
47. 1/2" x 1/2" x 1/2" x 1/2"	1.00
48. 1/2" x 1/2" x 1/2" x 1/2"	1.00
49. 1/2" x 1/2" x 1/2" x 1/2"	1.00
50. 1/2" x 1/2" x 1/2" x 1/2"	1.00
51. 1/2" x 1/2" x 1/2" x 1/2"	1.00
52. 1/2" x 1/2" x 1/2" x 1/2"	1.00
53. 1/2" x 1/2" x 1/2" x 1/2"	1.00
54. 1/2" x 1/2" x 1/2" x 1/2"	1.00
55. 1/2" x 1/2" x 1/2" x 1/2"	1.00
56. 1/2" x 1/2" x 1/2" x 1/2"	1.00
57. 1/2" x 1/2" x 1/2" x 1/2"	1.00
58. 1/2" x 1/2" x 1/2" x 1/2"	1.00
59. 1/2" x 1/2" x 1/2" x 1/2"	1.00
60. 1/2" x 1/2" x 1/2" x 1/2"	1.00
61. 1/2" x 1/2" x 1/2" x 1/2"	1.00
62. 1/2" x 1/2" x 1/2" x 1/2"	1.00
63. 1/2" x 1/2" x 1/2" x 1/2"	1.00
64. 1/2" x 1/2" x 1/2" x 1/2"	1.00
65. 1/2" x 1/2" x 1/2" x 1/2"	1.00
66. 1/2" x 1/2" x 1/2" x 1/2"	1.00
67. 1/2" x 1/2" x 1/2" x 1/2"	1.00
68. 1/2" x 1/2" x 1/2" x 1/2"	1.00
69. 1/2" x 1/2" x 1/2" x 1/2"	1.00
70. 1/2" x 1/2" x 1/2" x 1/2"	1.00
71. 1/2" x 1/2" x 1/2" x 1/2"	1.00
72. 1/2" x 1/2" x 1/2" x 1/2"	1.00
73. 1/2" x 1/2" x 1/2" x 1/2"	1.00
74. 1/2" x 1/2" x 1/2" x 1/2"	1.00
75. 1/2" x 1/2" x 1/2" x 1/2"	1.00
76. 1/2" x 1/2" x 1/2" x 1/2"	1.00
77. 1/2" x 1/2" x 1/2" x 1/2"	1.00
78. 1/2" x 1/2" x 1/2" x 1/2"	1.00
79. 1/2" x 1/2" x 1/2" x 1/2"	1.00
80. 1/2" x 1/2" x 1/2" x 1/2"	1.00
81. 1/2" x 1/2" x 1/2" x 1/2"	1.00
82. 1/2" x 1/2" x 1/2" x 1/2"	1.00
83. 1/2" x 1/2" x 1/2" x 1/2"	1.00
84. 1/2" x 1/2" x 1/2" x 1/2"	1.00
85. 1/2" x 1/2" x 1/2" x 1/2"	1.00
86. 1/2" x 1/2" x 1/2" x 1/2"	1.00
87. 1/2" x 1/2" x 1/2" x 1/2"	1.00
88. 1/2" x 1/2" x 1/2" x 1/2"	1.00
89. 1/2" x 1/2" x 1/2" x 1/2"	1.00
90. 1/2" x 1/2" x 1/2" x 1/2"	1.00
91. 1/2" x 1/2" x 1/2" x 1/2"	1.00
92. 1/2" x 1/2" x 1/2" x 1/2"	1.00
93. 1/2" x 1/2" x 1/2" x 1/2"	1.00
94. 1/2" x 1/2" x 1/2" x 1/2"	1.00
95. 1/2" x 1/2" x 1/2" x 1/2"	1.00
96. 1/2" x 1/2" x 1/2" x 1/2"	1.00
97. 1/2" x 1/2" x 1/2" x 1/2"	1.00
98. 1/2" x 1/2" x 1/2" x 1/2"	1.00
99. 1/2" x 1/2" x 1/2" x 1/2"	1.00
100. 1/2" x 1/2" x 1/2" x 1/2"	1.00

DESIGNED BY
Rich Folsom

VER

CONDOR CORRIDOR NO. 24
 ARDREE WATERS PLAN

DATE	NO.	BY