

SCALE 1"=100'

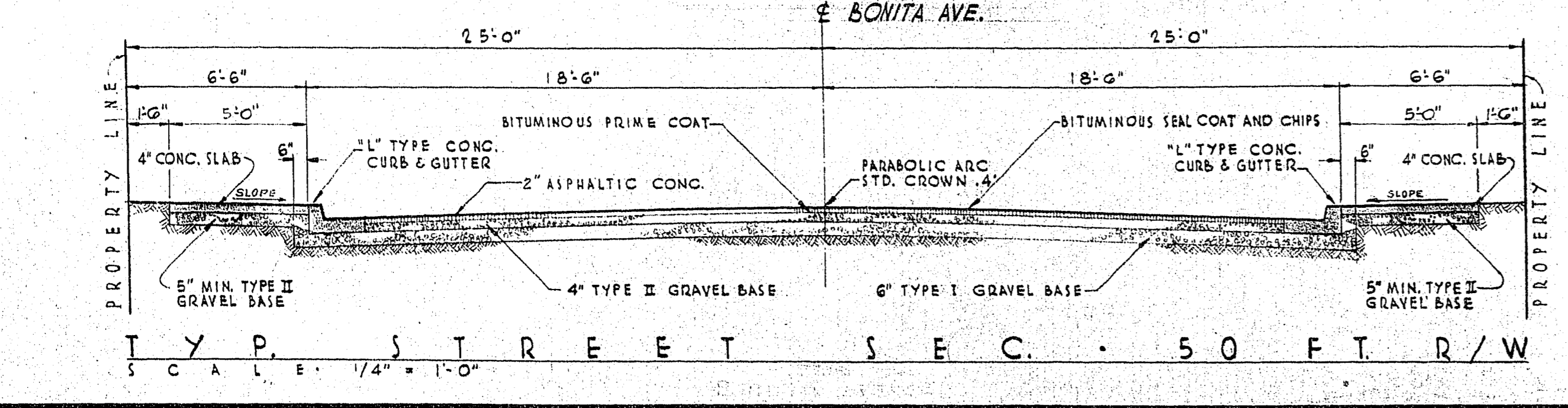
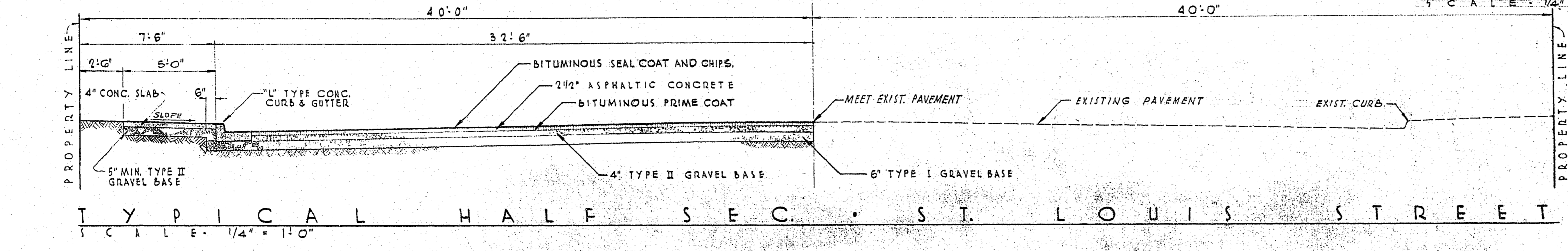
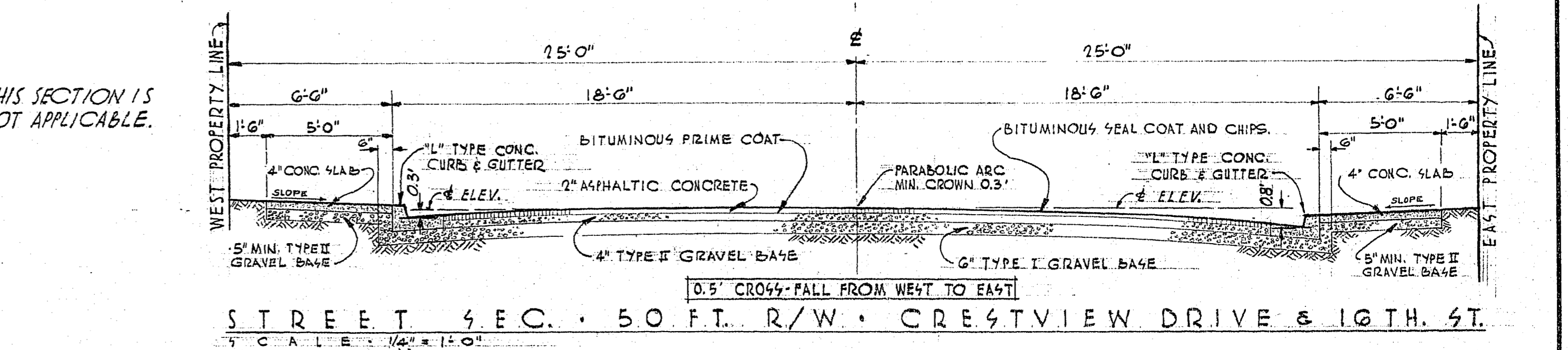
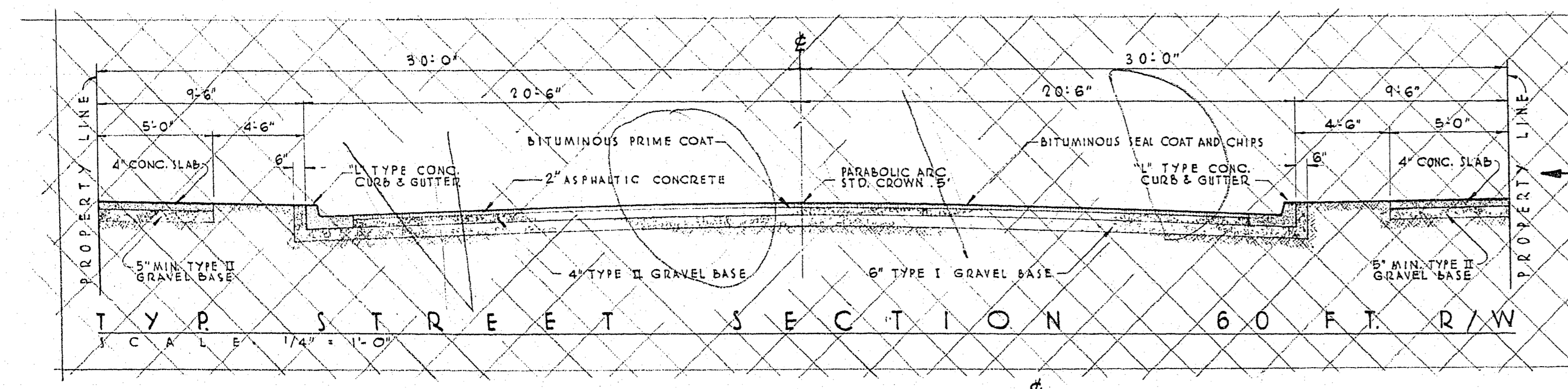
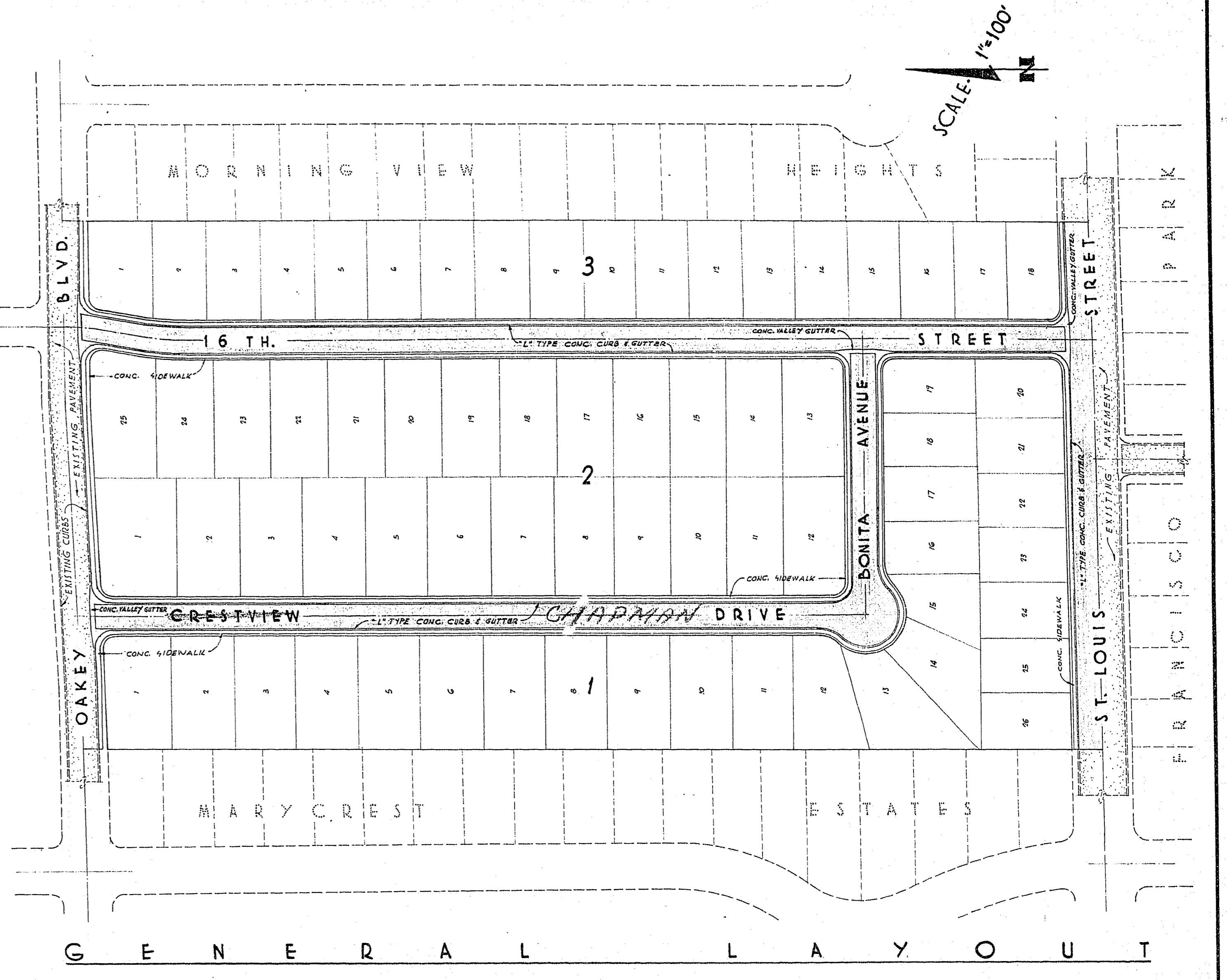
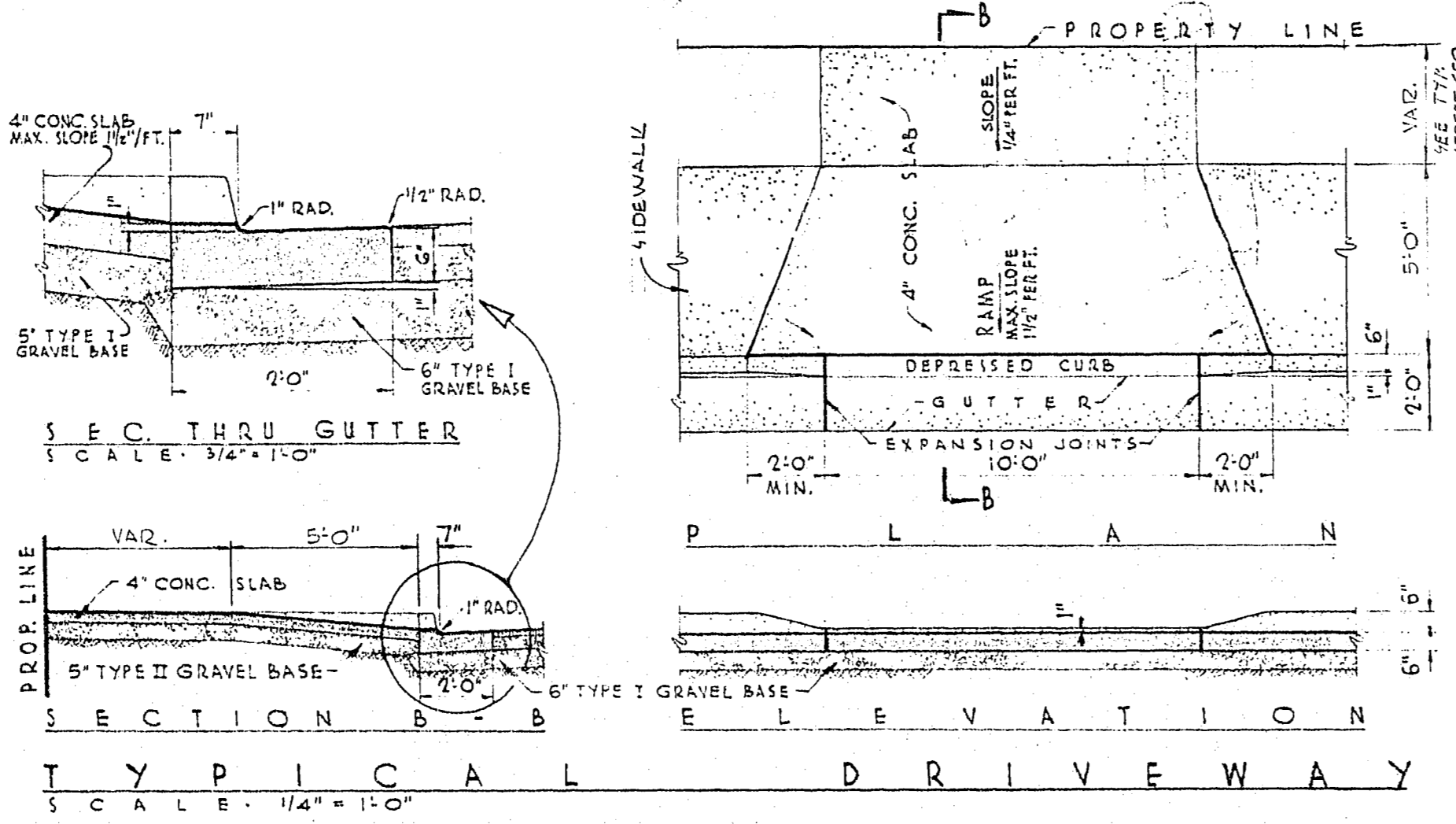
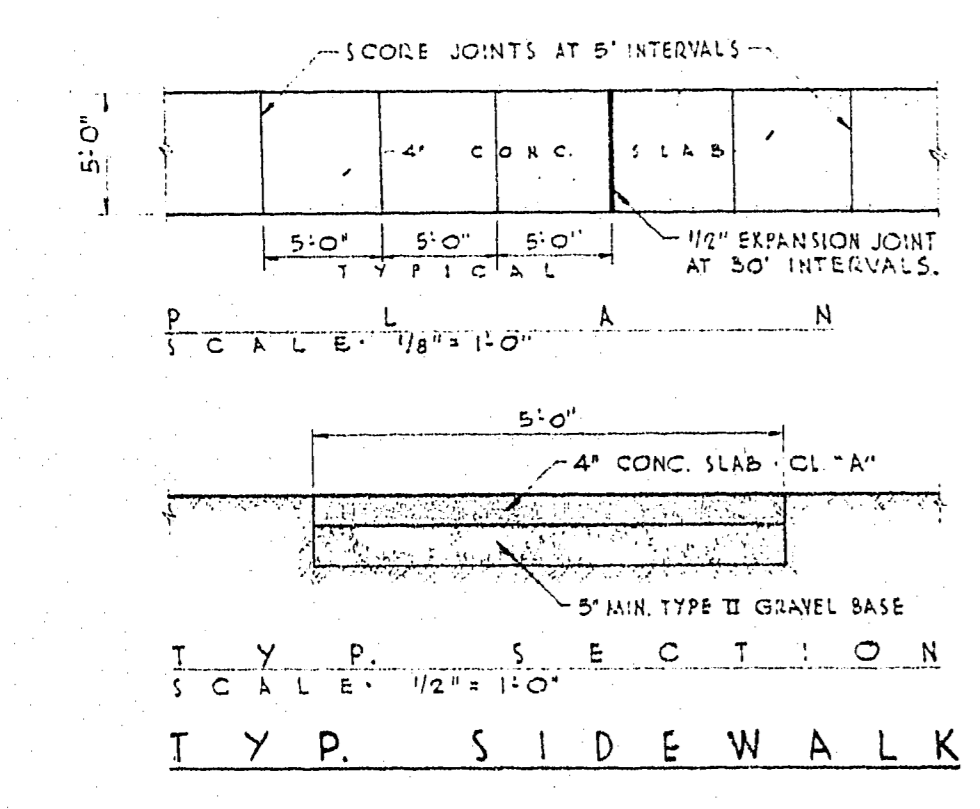
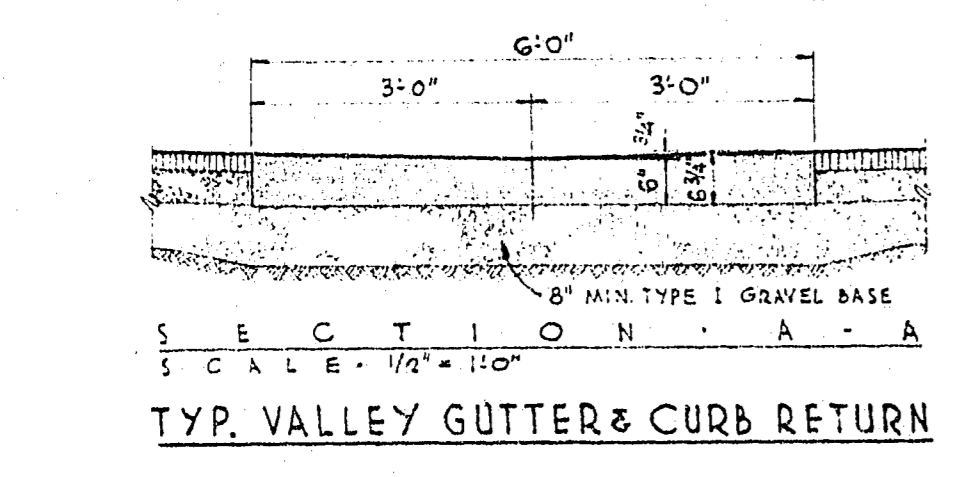
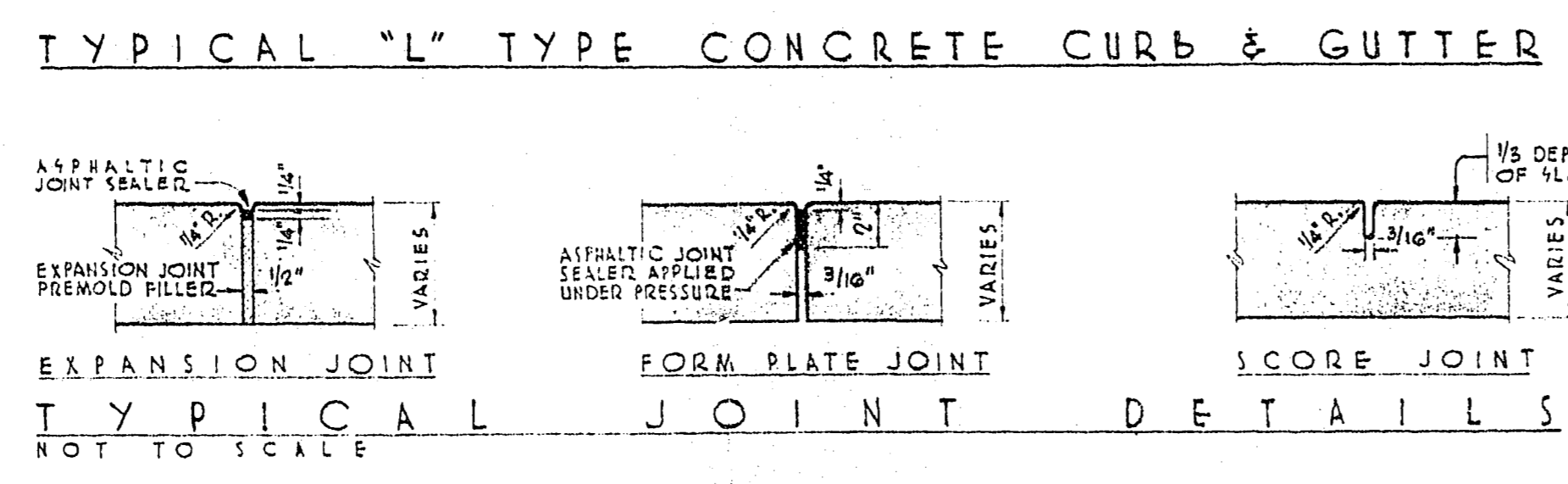
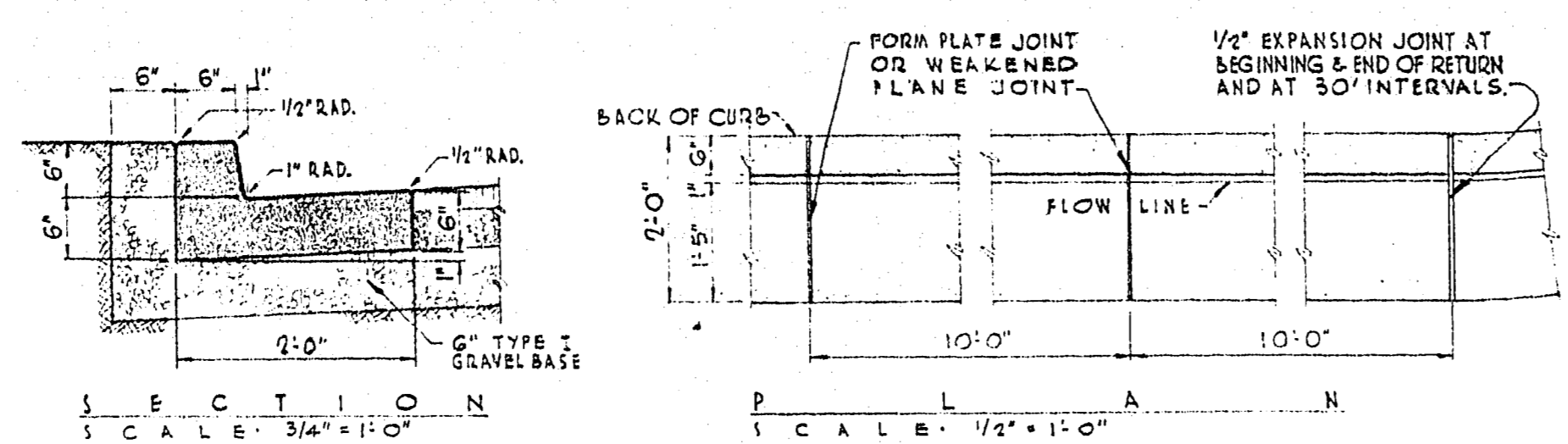
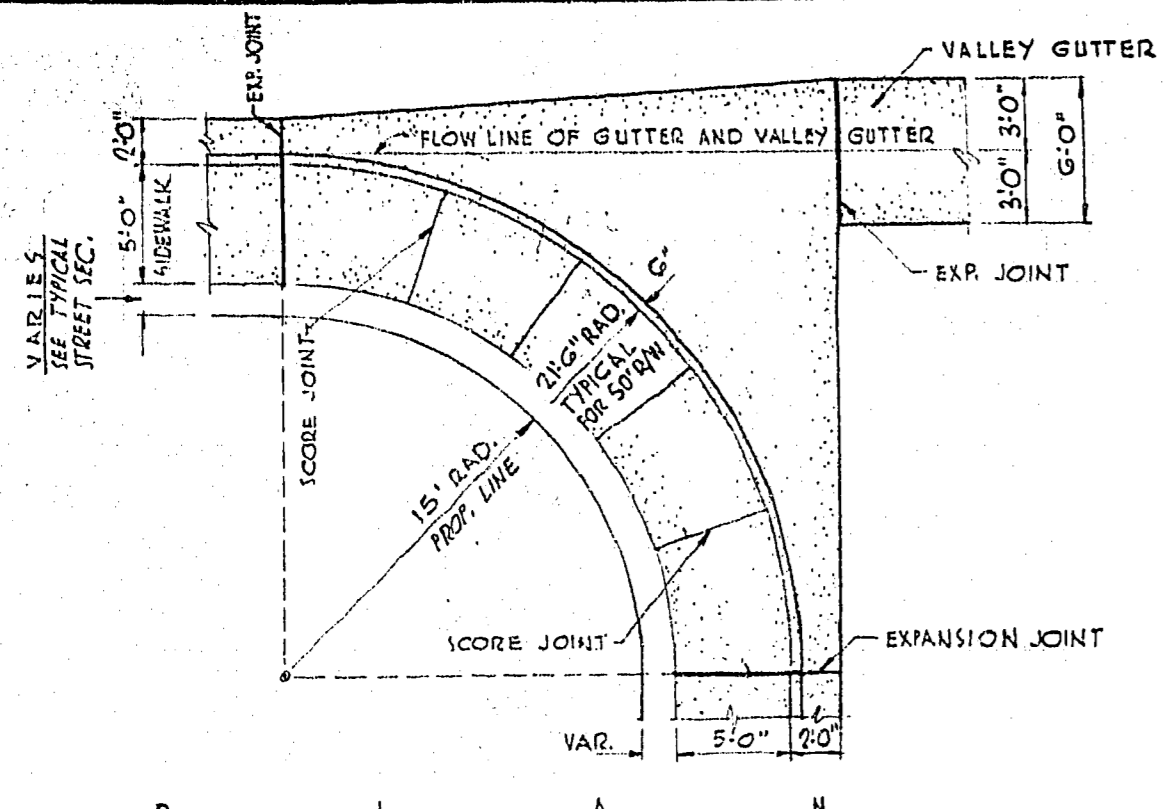

CITY OF LAS VEGAS ENGINEERING DEPT.
Approval of this plan by the City of Las Vegas, Nevada, does not relieve the Subdivider of responsibility for errors in calculation, design, or planning by the Subdivider's Engineer or Surveyor.
APPROVED AS TO DESIGN ONLY
Contractor will be responsible for all details, dimensions and conformity to the design drawings.
Date: 4-9-56
By: K.C.H. E.R.K.
City of Las Vegas, Nevada
Office of the City Engineer

ESTIMATE OF QUANTITIES

EXCAVATION	4,130 CU. YDS.
TYPE I GRAVEL	2,500 CU. YDS.
TYPE II GRAVEL	1,800 CU. YDS.
A. C. PAVEMENT	1,190 SQ. YDS.
CURB & GUTTER	5,801 LIN. FT.
VALLEY GUTTER	2,432 SQ. FT.
SIDEWALK	3,184 SQ. FT.
CURB AND GUTTER TO BE REMOVED	167 LIN. FT.
BORROW REQ'D. (FOR EMBANKMENT)	3,060 CU. YDS.
NUMBER OF LOTS	69 EACH

APPROVED
by **GEORGE E. WADE**
DIRECTOR OF PUBLIC WORKS
DATE: _____
GENERAL LAYOUT & CONSTRUCTION DETAILS
STREET IMPROVEMENTS
CRESTVIEW ESTATES
CITY OF LAS VEGAS - NEVADA
SCALE: PERLITER & SORING ENGINEERS
DATE: _____
448 SO. HILL LOS ANGELES OF 3

107Y-1180-1 11/21/55