

- NOTES:
1. ALL CONCRETE SHALL BE CLASS D FOR REINFORCED SECTIONS AND TYPE B FOR SIDEWALK SECTIONS.
 2. FINISHED ASPHALT CONCRETE SURFACE TO BE FLUSH WITH CROSS GUTTER LIP.
 3. ADJACENT SPANDREL SHALL BE 9" THICK.
 4. NON-FERROUS CHAIRS SHALL BE PLACED SO THAT REINFORCING WILL BE HELD AT THE PROPER ELEVATION UNDER ALL CONDITIONS OF CONSTRUCTION.
 5. ALL REINFORCING SHALL HAVE 2" CLEARANCE AT FORMED EDGES AND 3" FORM THE GROUND.
 6. WHEN THE CROSS GUTTER IS NOT POURED ACROSS THE FULL STREET WIDTH AN ADDITIONAL EXPANSION JOINT SHALL BE PLACED AT THE STREET CENTER LINE.
 6. WHEN THE SPANDREL SECTION IS REPLACED WITHOUT THE CROSS GUTTER SECTION THE CONTRACTOR SHALL DRILL AND PLACE REINFORCING STEEL DOWELS EXTENDED AT LEAST 8 INCHES INTO THE EXISTING CONCRETE.

STANDARD SPECIFICATION REFERENCE	
302	AGGREGATE BASE
501	CONCRETE
502	CONCRETE STRUCTURES
505	REINFORCING STEEL
707	EXPANSION JOINT MATERIAL

TYPICAL CROSS GUTTER PLAN

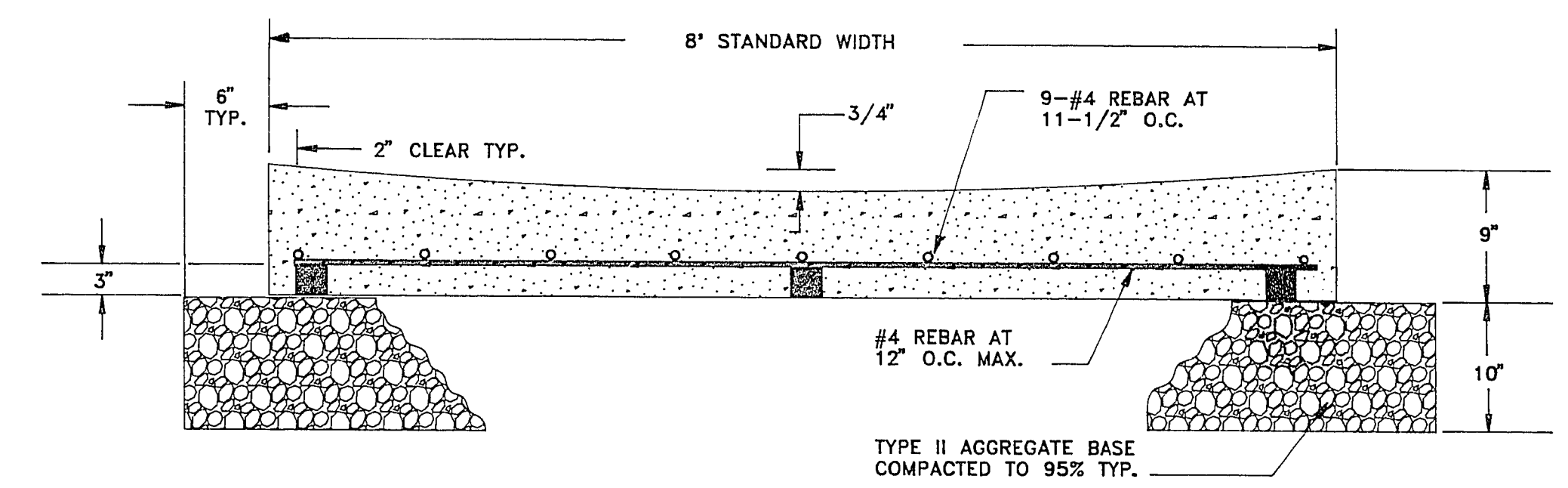

SECTION C - C

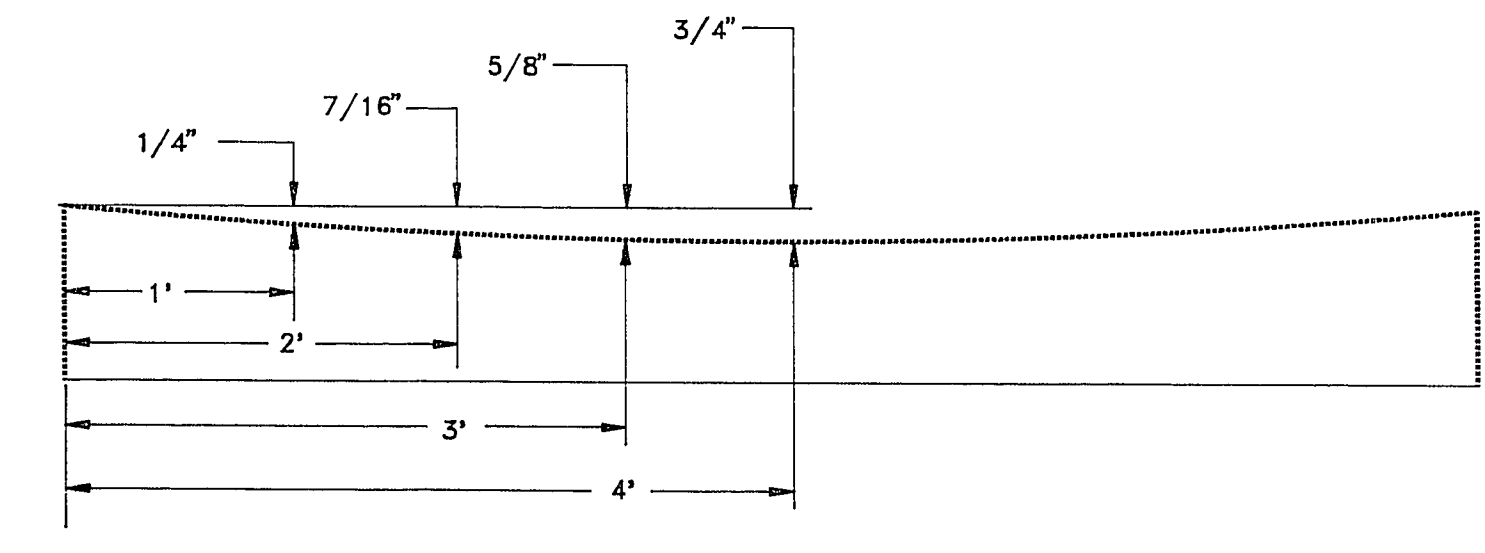

STANDARD CROSS GUTTER PROFILE

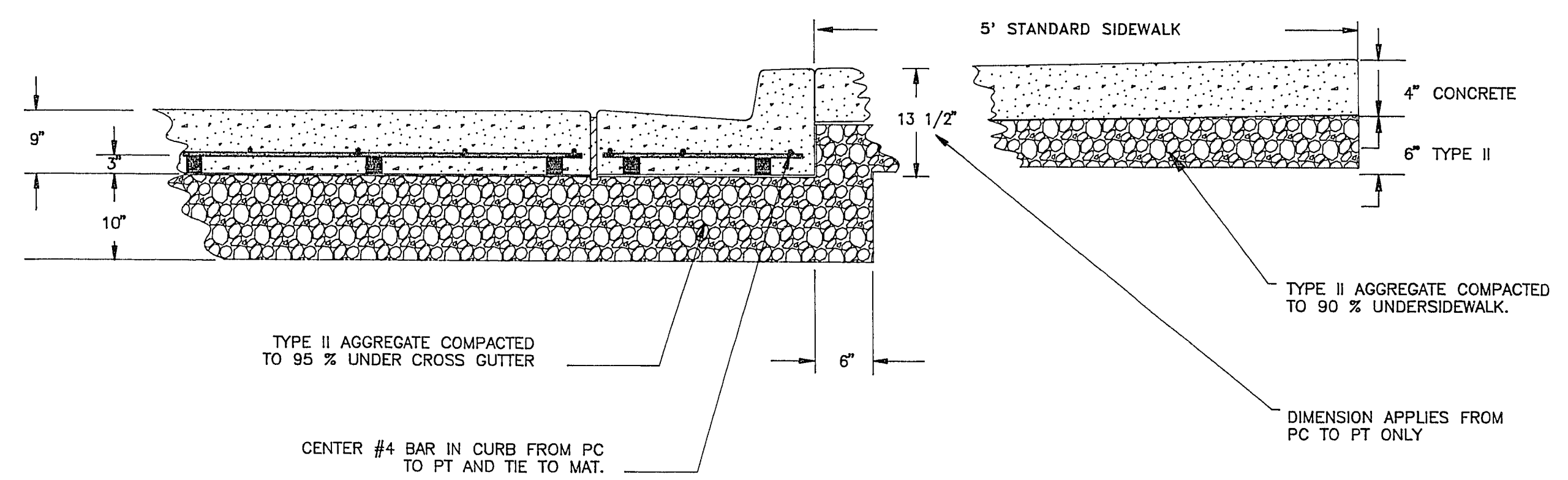

SECTION A - A

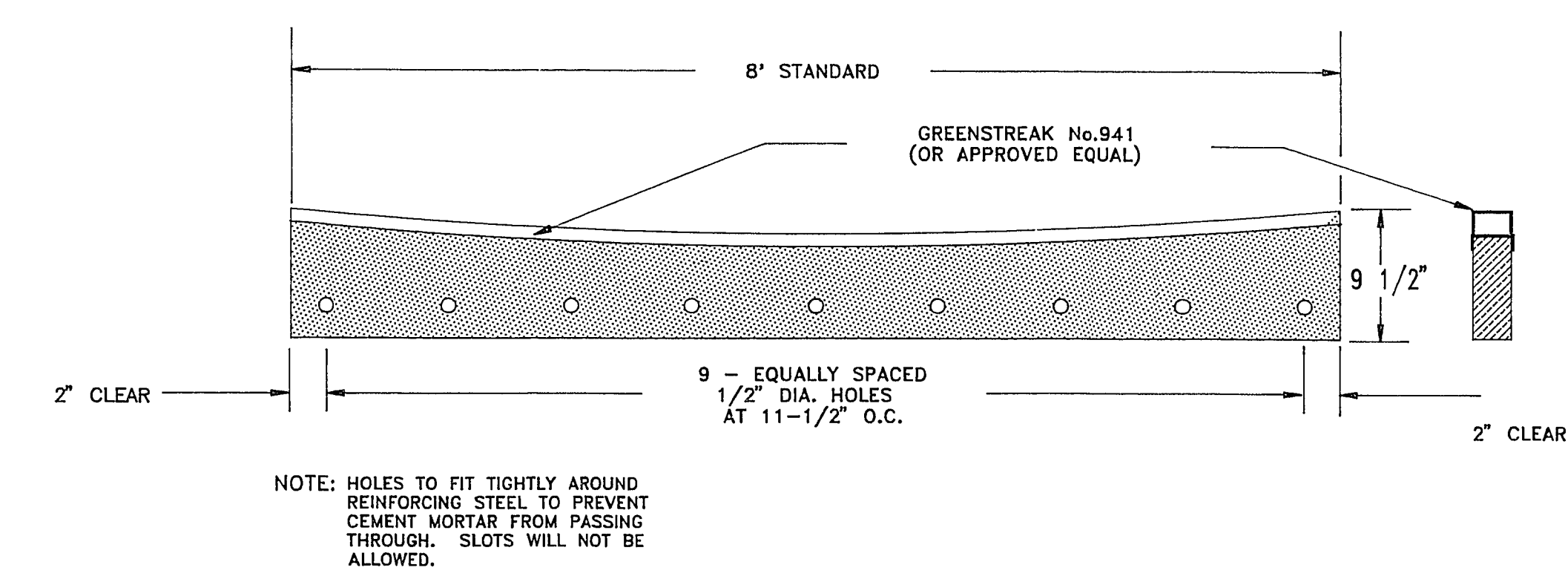

1/2" - EXPANSION BOARD

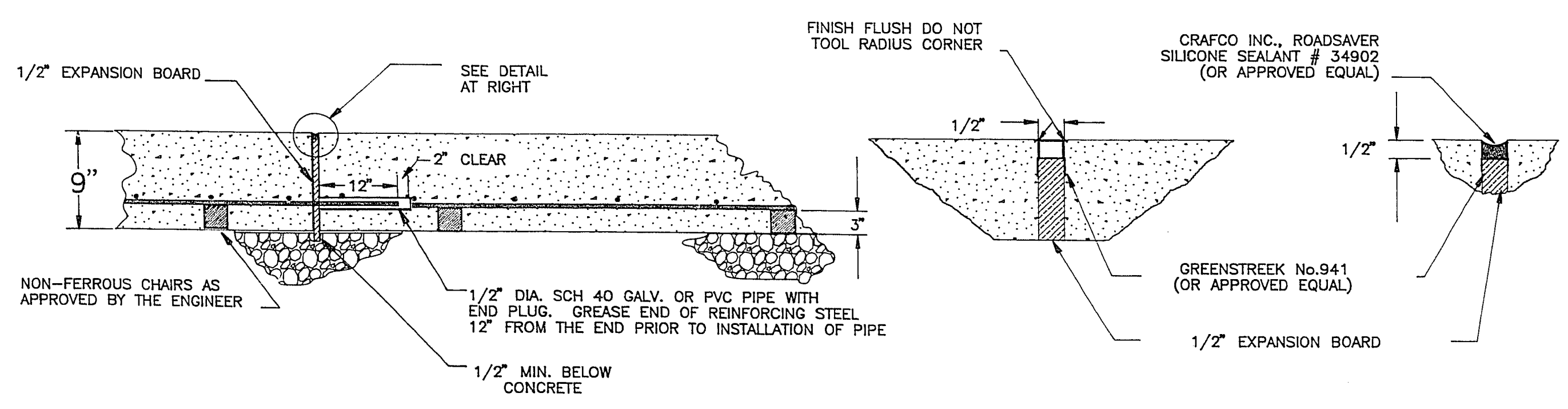

SECTION B - B

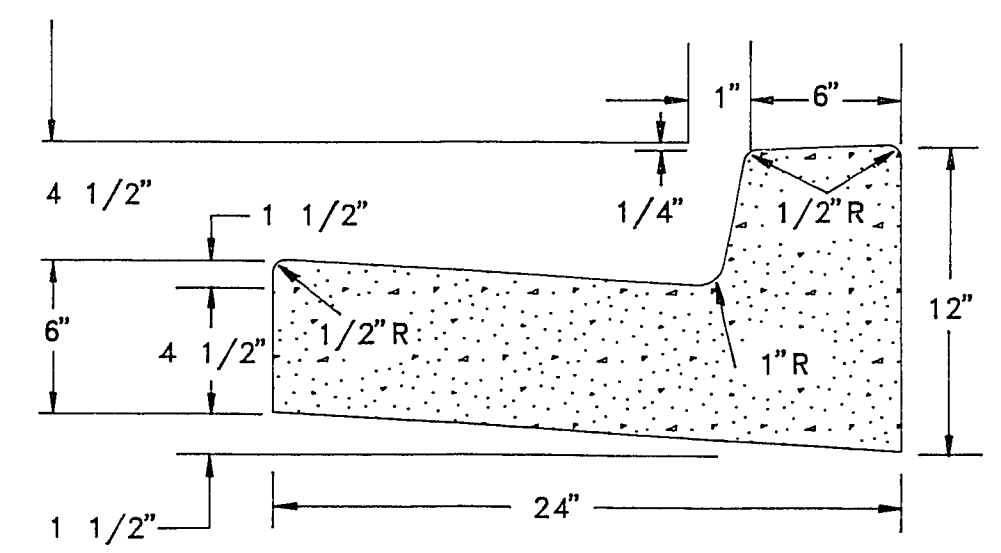

TYP. 24" L-TYPE CURB

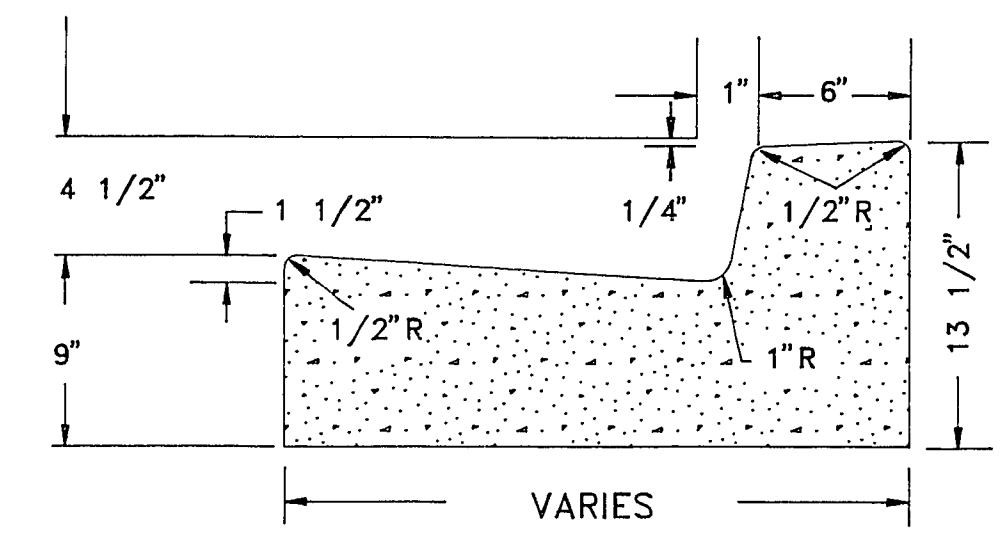

SPANDREL FROM PC TO PT

CURB AND GUTTER GEOMETRICS

REVISIONS

NO.	DATE	DESCRIPTION	BY

ENGINEERING DESIGN

DRAWN BY: AUTO - CAD DATE: MAY 1990
CHECKED BY: DA DRAWING NO.:
JOB NO.: SHEET

Department of Public Works

STANDARD CROSS GUTTER DETAIL

DRAWING No. 21
107-VI801 23

23-3-124