

LEGEND

- Sewer line designation
- Manhole Number
- Sewer Line
- Proposed trunk sewer (by Others)
- Manhole
- House Service
- Lot Number

Notes:
 All construction to be in accordance with City of Las Vegas Standard Specifications and Details.

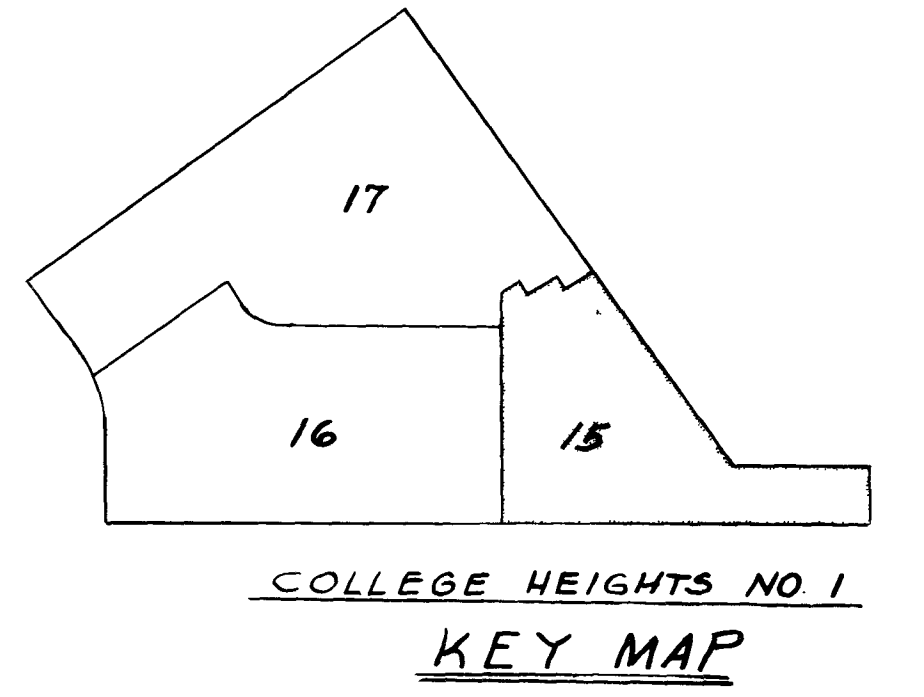
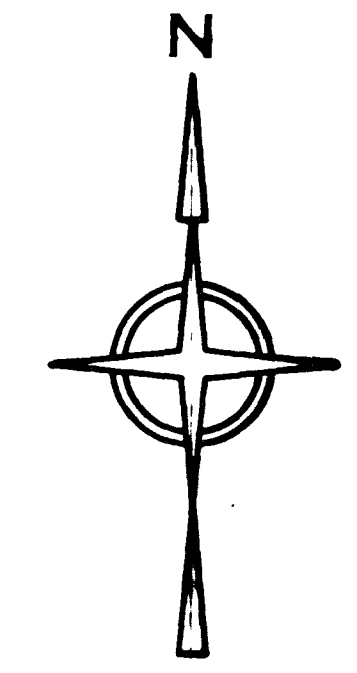

ESTIMATED QUANTITIES

DESCRIPTION	QUANTITY
8" V.C. Sewer Pipe	6663 L.F.
4" V.C. Sewer Pipe	4337 L.F.
Manholes	24 Ea.

Submitted by *[Signature]* Date *Oct 23, 1962*
 Approved by *[Signature]* Date *1-16-63*
 Approved by *[Signature]* Date *1-21-65*
 City Engineer

REVISIONS		DATE		MOOTE, KEMPA & GALLOWAY, INC.	
Rev 12-4-62	DKG	11-21-62	ENR/FG	CIVIL ENGINEERS AND LAND SURVEYORS	
				PHOENIX LAS VEGAS	
				JOB NO. LV. 1820	

SANITARY SEWER PLAN
COLLEGE HEIGHTS No 1
 A PART OF 5/4 N 1/2 SEC. 19 T20S R41E MDB 8M
 CLARK COUNTY, NEVADA.
 CLIENT: **FIRST WESTERN S. & L.**

SCALE: 1" = 40'
 SHEET: 15 OF 25
 DATE: 11-21-62

3077-1110-1 3077-1110-1

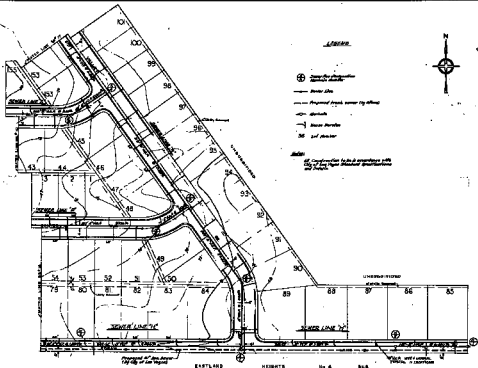

LEGEND

- ⊕ Center for proposed water main
- Water line
- Proposed trunk sewer by others
- Sewer
- Gas service
- ⊕ 2nd floor

Note:
 All construction to be in accordance with
 City of Los Angeles Standard Specifications
 and Details.



EXHAUSTION QUANTITIES

DESCRIPTION	QUANTITY
4" PB Water Pipe	2,883 LF
4" PB Sewer Pipe	2,997 LF
Manholes	10

Proposed 42" Dia. Artery
 City of Los Angeles

EASTLAND

HEIGHTS No. 4 608

Submitted by *[Signature]*
 Approved by *[Signature]* City Engineer
 Approved by *[Signature]* City Engineer

PROJECT: HIGHWAY 608	DATE: 1/20/50	BY: JOHN A. SALMON, INC.
COLLEGE HEIGHTS No. 4	DATE: 1/20/50	BY: JOHN A. SALMON, INC.
A PART OF AN L.S.D. MAP 1708 AND 1709	DATE: 1/20/50	BY: JOHN A. SALMON, INC.
PLAN SHEET 10000	DATE: 1/20/50	BY: JOHN A. SALMON, INC.
FOOT WESTERN S.W.L.	DATE: 1/20/50	BY: JOHN A. SALMON, INC.