

Unit 1

Unit 2

SMOKE RANCH ROAD

WOOSTER CIRCLE

Charleston Heights 50-D-3

NO. 3/2 P. D. W/ METER COVER

SERVICE POINT REQD. IN THIS AREA

SEE CHAS. HTS. TR. 50-D-4 FOR SPLIT LOCATION W. SIDE WINWOOD
WINWOOD STREET
CAMDEN LANE
AUBORN AVE

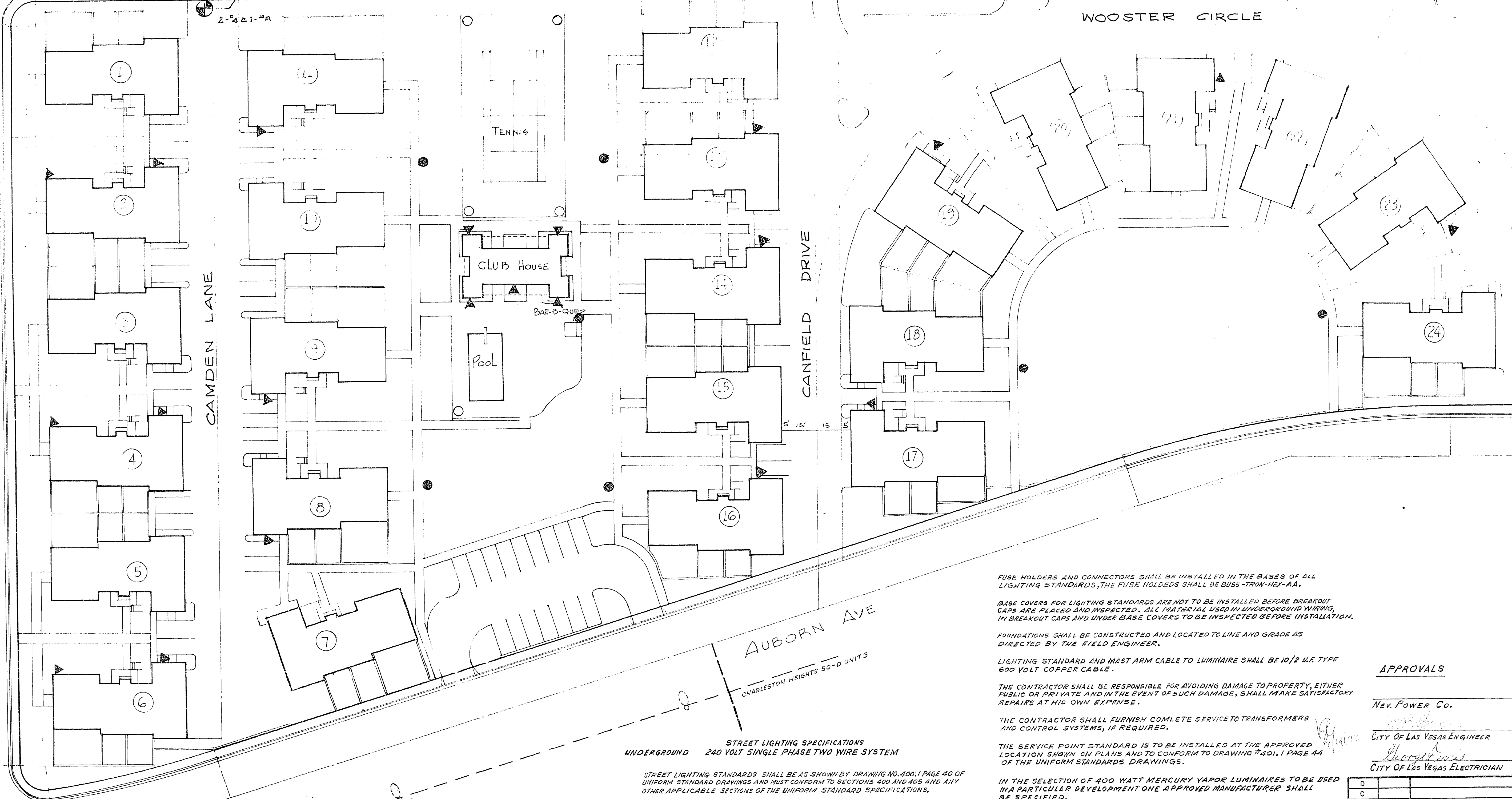

FUSE HOLDERS AND CONNECTORS SHALL BE INSTALLED IN THE BASES OF ALL LIGHTING STANDARDS, THE FUSE HOLDERS SHALL BE BUS-TRON-HEX-AA.

BASE COVERS FOR LIGHTING STANDARDS ARE NOT TO BE INSTALLED BEFORE BREAKOUT CAPS ARE PLACED AND INSPECTED. ALL MATERIAL USED IN UNDERGROUND WIRING, IN BREAKOUT CAPS AND UNDER BASE COVERS TO BE INSPECTED BEFORE INSTALLATION.

FOUNDATIONS SHALL BE CONSTRUCTED AND LOCATED TO LINE AND GRADE AS DIRECTED BY THE FIELD ENGINEER.

LIGHTING STANDARD AND MAST ARM CABLE TO LUMINAIRE SHALL BE 10/2 U.F. TYPE 600 VOLT COPPER CABLE.

THE CONTRACTOR SHALL BE RESPONSIBLE FOR AVOIDING DAMAGE TO PROPERTY, EITHER PUBLIC OR PRIVATE AND IN THE EVENT OF SUCH DAMAGE, SHALL MAKE SATISFACTORY REPAIRS AT HIS OWN EXPENSE.

THE CONTRACTOR SHALL FURNISH COMPLETE SERVICE TO TRANSFORMERS AND CONTROL SYSTEMS, IF REQUIRED.

THE SERVICE POINT STANDARD IS TO BE INSTALLED AT THE APPROVED LOCATION SHOWN ON PLANS AND TO CONFORM TO DRAWING #401, PAGE 44 OF THE UNIFORM STANDARDS DRAWINGS.

IN THE SELECTION OF 400 WATT MERCURY VAPOR LUMINAIRES TO BE USED IN A PARTICULAR DEVELOPMENT ONE APPROVED MANUFACTURER SHALL BE SPECIFIED.

THESE SPECIFICATIONS TO BECOME EFFECTIVE ON ALL CITY OF LAS VEGAS MULTIPLE STREET LIGHTING DESIGNS APPROVED ON OR AFTER SEPTEMBER 1, 1971.

THESE SPECIFICATIONS SHALL BE SUPERSEDED BY ANY REVISED SPECIFICATIONS IN EXISTENCE AT THE TIME OF INSTALLATION.

STREET LIGHTING SPECIFICATIONS UNDERGROUND 240 VOLT SINGLE PHASE TWO WIRE SYSTEM

STREET LIGHTING STANDARDS SHALL BE AS SHOWN BY DRAWING NO. 400.1 PAGE 40 OF UNIFORM STANDARD DRAWINGS AND MUST CONFORM TO SECTIONS 400 AND 405 AND ANY OTHER APPLICABLE SECTIONS OF THE UNIFORM STANDARD SPECIFICATIONS.

ON 100' R/W STREETS THERE SHALL BE ONE POLE AT EACH CORNER.

MERCURY VAPOR LUMINAIRES TO BE USED ON 80' R/W STREETS AND OVER, SHALL BE 400 WATT 240 VOLT, I.E.S. DISTRIBUTION TYPE 3 WITH INTEGRAL CONSTANT WATTAGE BALLAST SIMILAR TO GENERAL ELECTRIC TYPE M-400, CATALOG #C79B034 OR APPROVED EQUAL.

400 WATT MERCURY VAPOR LAMPS SHALL BE ASA CODE #H33-1GL/W PHOTO CELL AND CONTROL TO BE 120/240 VOLTS.

SPACING OF STANDARDS ON 100' R/W STREETS OR MORE SHALL BE 120 FEET MAXIMUM ON BOTH SIDES AND STAGGERED TO PROVIDE 1.2 TO 2.0 F.C.

ALL STANDARDS TO BE SET 18" BACK OF CURB.

SCH. 40 RIGID NON-METALLIC CONDUIT (PVC) OR APPROVED EQUAL COMPLYING WITH ARTICLE 347 OF THE NATIONAL ELECTRICAL CODE MAY BE USED FOR UNDERGROUND APPLICATIONS AND TO BE WITHIN 12" BACK OF CURB AND 24" COVER.

LEGEND & ESTIMATE

- 400W. MERC. VAPOR LUMINAIRE ON 11 GA. POLE 8 EA.
- EXISTING STREET LIGHT
- 250W QUARTZ HUBBELL 325-5 OR EQUAL 21 EA
- 200W PRESCOLITE NO 5812 ON 12" HIGH 3" POST 7 EA
- 250W QUARTZ HUBBELL 325-5 OR EQUAL ON 15" HIGH 3" POST 5 EA

SCALE: 1" = 30'

APPROVALS

NEV. POWER CO. _____ DATE _____

CITY OF LAS VEGAS ENGINEER _____ DATE _____

CITY OF LAS VEGAS ELECTRICIAN _____ DATE _____

REV.	DATE	DESCRIPTION	BY	APPR.
D				
C				
B	9-25-71	RELOCATED UNIT 7		
A	12/29/71	INCREASED ON-SITE LIGHTING	JMR	

CHARLESTON HEIGHTS TR. 50-D-3 "SMOKE RANCH VILLAS" STREET AND ON-SITE LIGHTING PLAN

DESIGNED JMR JAY M. RASSLER, R.P.E. CIVIL ENGINEER & SURVEYOR LAS VEGAS, NEVADA

DRAWN JMR

CHECKED JMR APPROVED _____ DATE _____

CITY ELECTRICAL COORDINATOR DATE _____

SHEET 1 OF 1

207 19-040-50E-3-20