

SCALE: 1"=50'

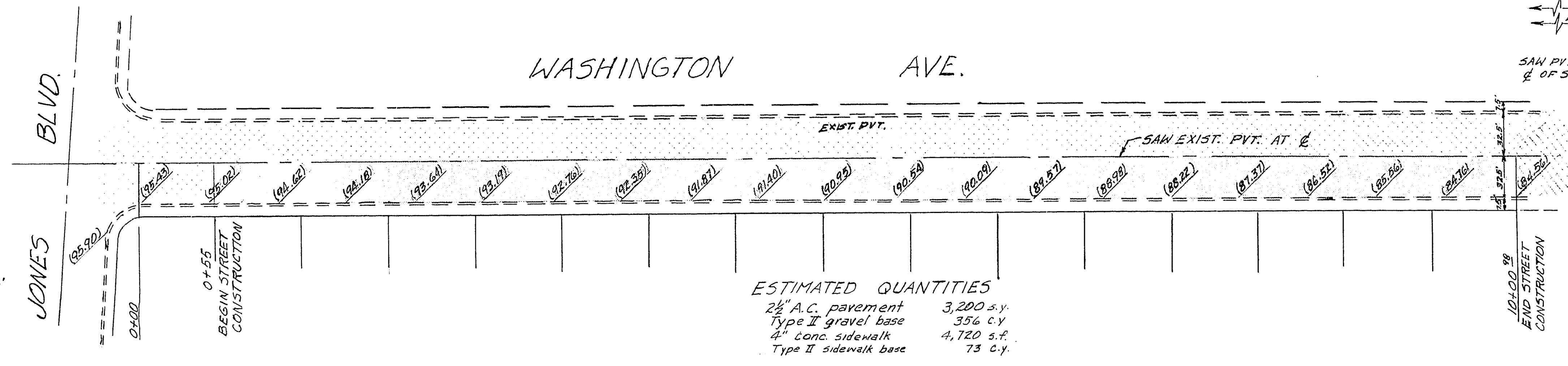

ESTIMATED QUANTITIES
 2 1/2" A.C. pavement 3,200 s.y.
 Type II gravel base 356 c.y.
 4" conc. sidewalk 4,720 s.f.
 Type II sidewalk base 73 c.y.

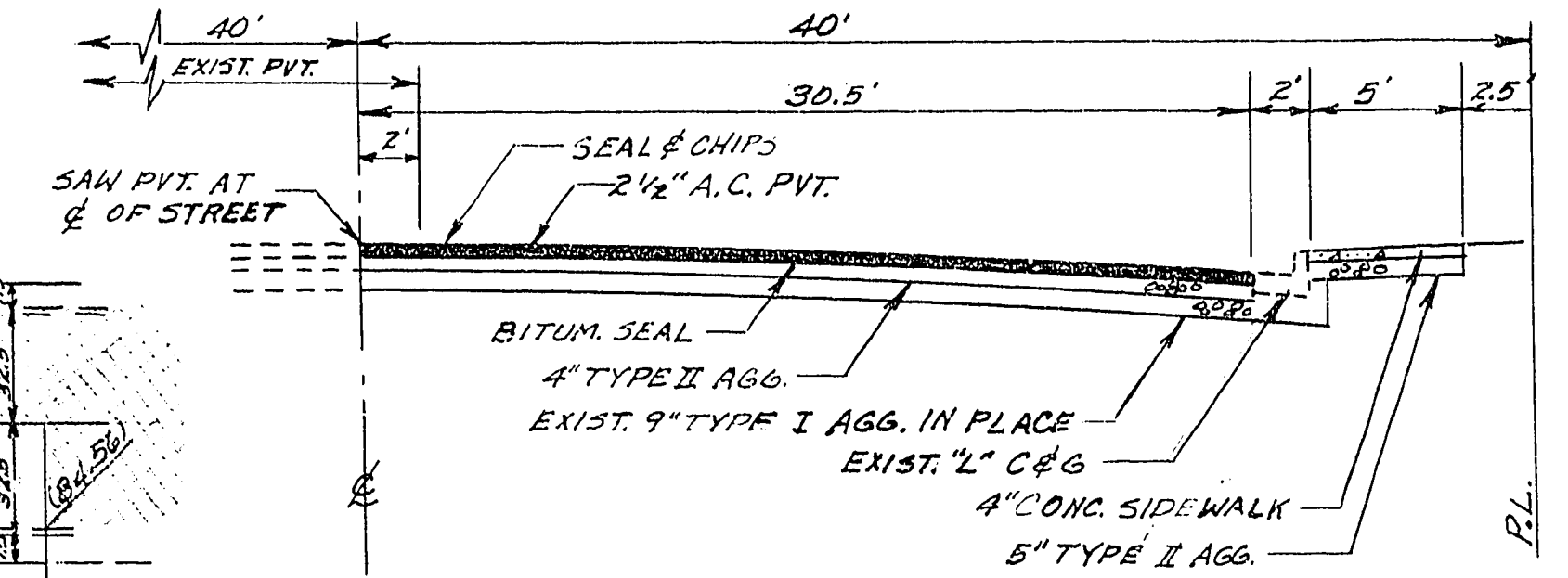

TYPICAL SECTION
 WASHINGTON AVE.

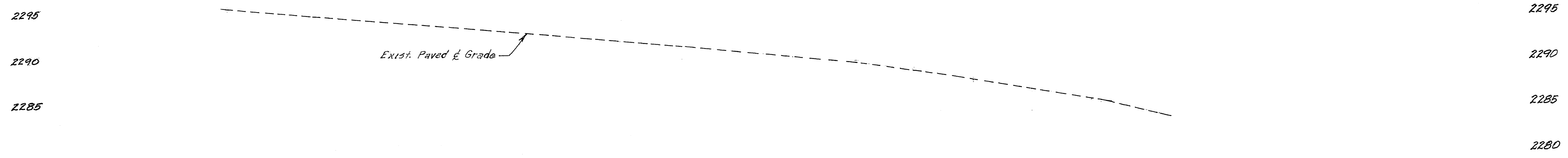

SCALE 1"=50'

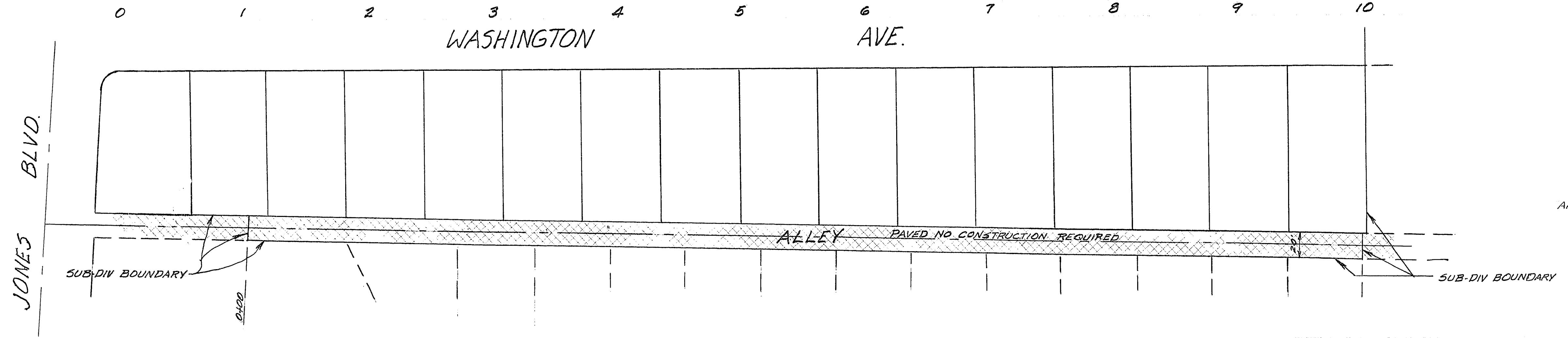

APPROVED J.B. Williams 4/19/06
 for CITY ENGINEER DATE
J.R. Johnson 4-14-06
 FIELD ENGINEER DATE

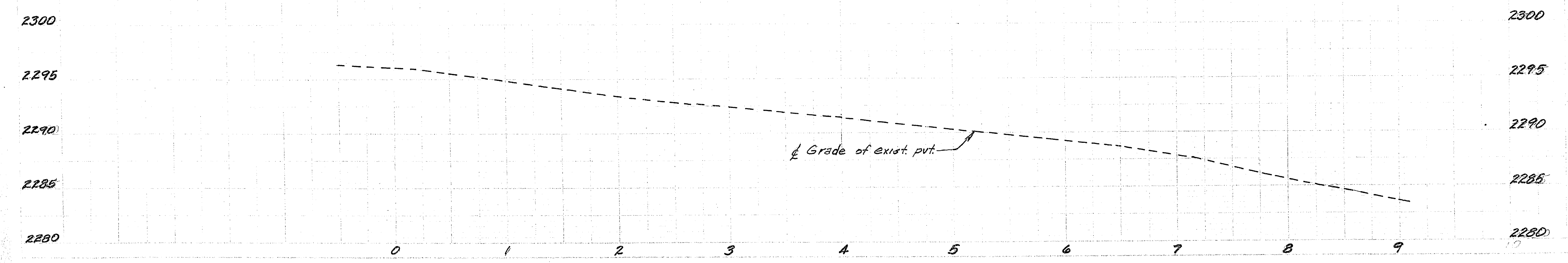

D				
C				
B				
A				
REV.	DATE	DESCRIPTION	BY	APPR.
CHARLESTON HEIGHTS NO. 45E STREET & ALLEY PLAN & PROFILE WASHINGTON AVE. JONES BLVD TO SAYLOR WAY				
DESIGNED	TROJAN ENGINEERING, INC.			SHEET
DRAWN	J.P.	LAS VEGAS	NEVADA	OF
CHECKED		APPROVED	DATE	