

BENCH MARK

NEVADA HIGHWAY DEPT. BRASS CAP IN TOP OF CURB AT THE SW CORNER OF LAS VEGAS BLVD. NORTH & WASHINGTON AVE.
 ELEVATION 1942.96.
 (ELEVATION ESTABLISHED BY G.C. WALLACE ENGINEERS DECEMBER 1980.
 DATUM UNKNOWN.
 T.B.M. - PANEL POINTS
 H.V. 4 ELEVATION 1883.00 LOCATED ON CENTERLINE OF SAGMAN AT WASHINGTON AVE.

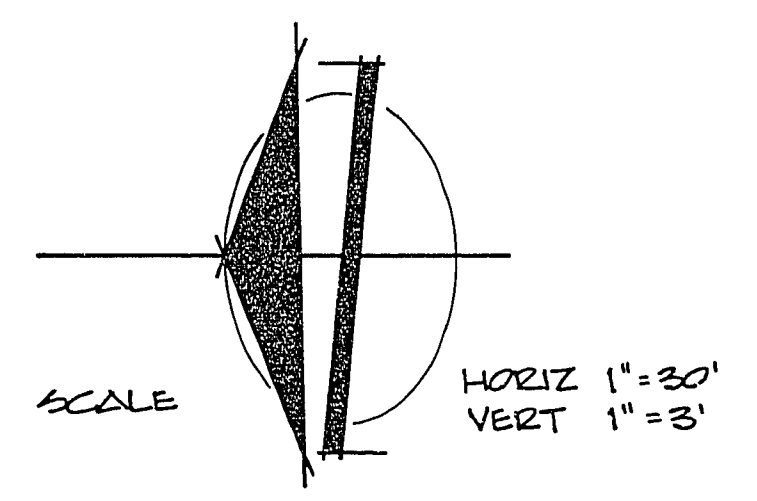

SEE SHEET C-13 FOR SAGMAN STREET SECTION

QUANTITIES - THIS SHEET (SAGMAN)

CONCRETE SIDEWALK	0 SQ. FT. (SEE SHT. C-13)
3" A.C. PAVEMENT	595 SQ. YARDS
4" TYPE II AGGREGATE	70 CUBIC YDS.
9" TYPE II CONCRETE "L" TYPE CURB & CUTTER	150 CUBIC YDS.
1" OVERLAY	421 L.F.
CONCRETE VALLEY CUTTER (SEE SHT. C-13)	150 SQ. YARDS
RELOCATE STOP SIGN	0 SQ. FT.
NEW SIGN	1 EA.

SAGMAN STREET

PC = 73.00'
 $\Delta = 89^\circ 51' 37''$
 L = 39.21'
 T = 24.94'

PC = 30.00'
 $\Delta = 89^\circ 51' 37''$
 L = 47.03'
 T = 29.93'

12-10-81
 Michael B. Tolson

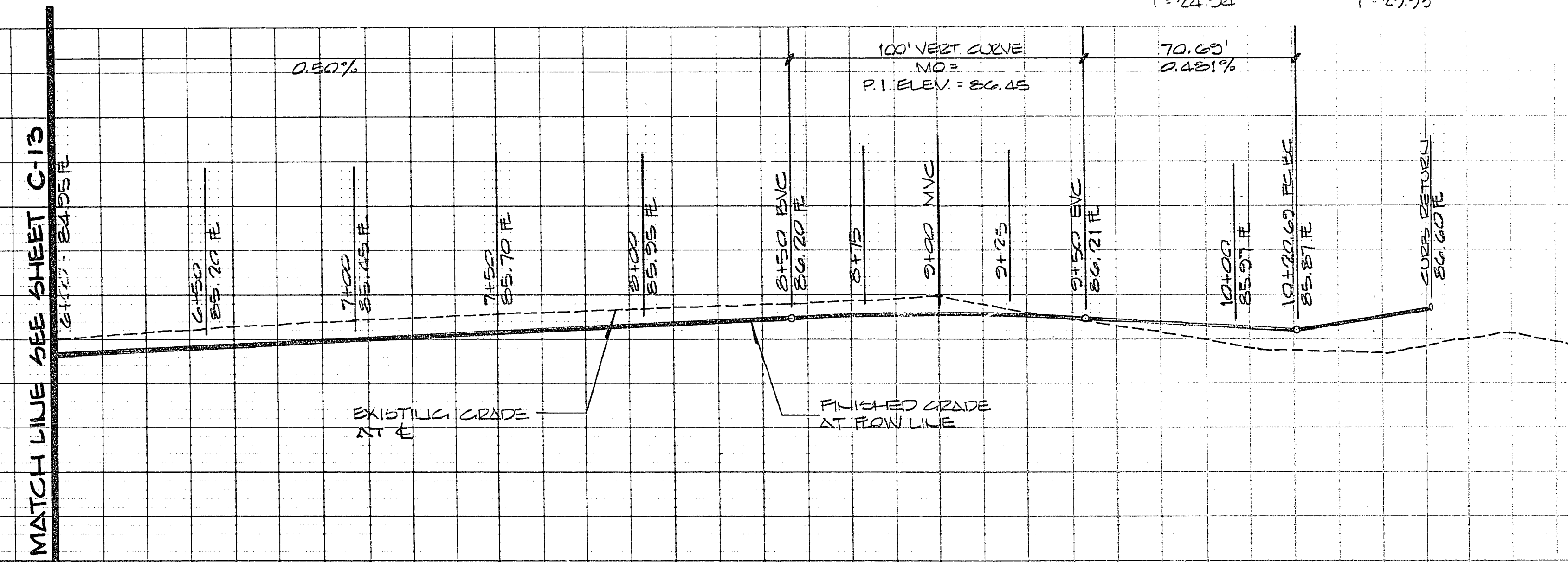

APPROVALS

Richard J. Roman CLV TRAFFIC ENGR.	12-18-81 DATE
M. Barber CLV FIRE MARSHALL	12-11-81 DATE
Tommy [unclear] CLV ELECTRICAL COORDINATOR	1/1/82 DATE
R.W. Bell CLV QUALITY CONTROL ENGR.	1/5/82 DATE
[unclear] CLV FIELD OPERATIONS ENGR.	DATE
William [unclear] CLV ENGINEER	1/26/82 DATE
Michael B. Tolson NEVADA POWER CO.	12-10-81 DATE

CONSTRUCTION NOTE

All construction and materials shall be in accordance with the "Uniform Standard Specifications for Public Works Construction Off-site Improvements, Clark County Area Nevada", issued 1978; the "Uniform Standard Drawings for Public Works Construction, Clark County Area"; any other applicable approved standards issued by the controlling agency; the Uniform Building Code; and all Local City Codes and Ordinances Applicable.

UTILITY NOTE

The location of underground utilities shown hereon has been determined from surface evidence of their existence or from information obtained from the utility companies. The Engineer accepts no liability for the existence or non-existence of utility lines. Contractors and others using this map must confirm the location of underground lines or structures with the utility companies prior to commencing any excavation.

APPROVED: [Signature]

REVISIONS: [Table]

DATE: [Table]

DESIGN: [Table]

DRAWN: [Table]

CHECK: [Table]

PREPARED FOR: **GEORGE TATE & ASSOC.**

DATE: [Table]

DESIGN: [Table]

DRAWN: [Table]

CHECK: [Table]

SCALE: 1/4" = 1' = 30"

BAUGHMAN & TURNER
 CIVIL ENGINEERS
 MINING ENGINEERS
 LAND SURVEYORS
 LAS VEGAS, NEVADA
 3235 WEST CHARLESTON BOULEVARD
 702-870-8771

STREET DESIGN
 SAGMAN STREET
 SECTION 22, TOWNSHIP 20 SOUTH, RANGE 61 EAST, M.D.B. 4 M.
 CITY OF LAS VEGAS
 SAGMAN SPORTS & CONVENTION COMPLEX

SHEET 14 OF 14

PROJ. NO. 107-V1206