

BENCH MARK
 NEVADA HIGHWAY DEPT. BRASS CAP IN TOP OF CURB AT THE SW CORNER OF LAS VEGAS BLVD. NORTH & WASHINGTON AVE.
 ELEVATION 1942.96.
 (ELEVATION ESTABLISHED BY G.C. WALLACE ENGINEERS DECEMBER 1980).
 DATUM UNKNOWN.
 TBM - PANEL POINTS HV-4 ELEVATION 1883.00 LOCATED ON CENTERLINE OF SAGMAN AT WASHINGTON AVE.

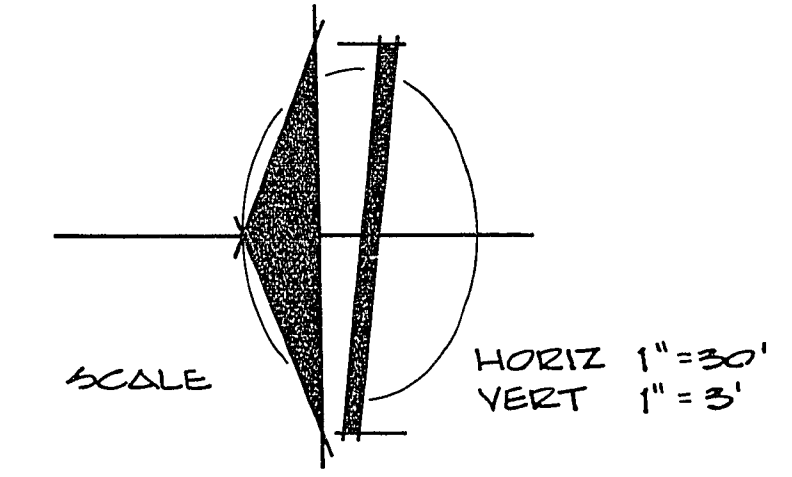

OFFSITE QUANTITIES-TTHIS SHEET

CONCRETE SIDEWALK	0 SQ. FT. (SEE SH'T. C-13)
3" A.C. PAVEMENT	736 SQ. YDS.
4" TYPE II AGGREGATE	82 CU. YDS.
9" TYPE I AGGREGATE	184 CU. YDS.
CONCRETE "L" TYPE CURB & CUTTER	525 L.F.
1" A.C. OVERLAY	1410 SQ. YDS.
ADJUST SEWER MANHOLE	1 EA.
SIDEWALK DRAIN	1 EA.

SAGMAN STREET SECTION
 N.T.S.

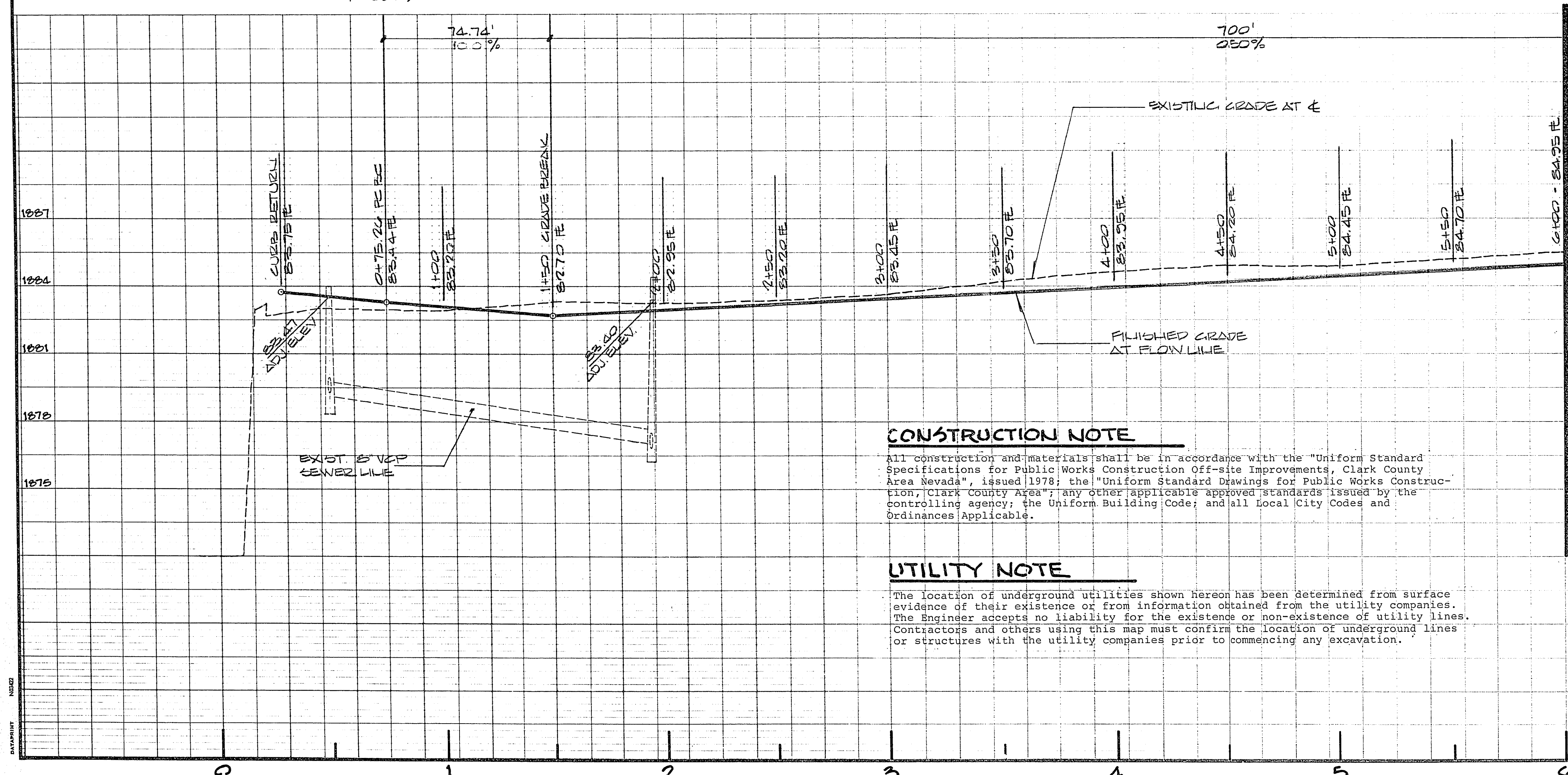

CONSTRUCTION NOTE

All construction and materials shall be in accordance with the "Uniform Standard Specifications for Public Works Construction Off-site Improvements, Clark County Area Nevada", issued 1978; the "Uniform Standard Drawings for Public Works Construction, Clark County Area"; any other applicable approved standards issued by the controlling agency; the Uniform Building Code; and all Local City Codes and Ordinances Applicable.

UTILITY NOTE

The location of underground utilities shown hereon has been determined from surface evidence of their existence or from information obtained from the utility companies. The Engineer accepts no liability for the existence or non-existence of utility lines. Contractors and others using this map must confirm the location of underground lines or structures with the utility companies prior to commencing any excavation.

APPROVALS

<i>Richard J. Roman</i> CLV TRAFFIC ENGR.	12-14-81 DATE
<i>W. Baker</i> CLV FIRE MARSHALL	12-11-81 DATE
<i>James A. ...</i> CLV ELECTRICAL COORDINATOR	1/15/82 DATE
<i>R.W. ...</i> CLV QUALITY CONTROL ENGR.	1/5/82 DATE
<i>R.G. ...</i> CLV SANITATION ENGR.	12-14-81 DATE
<i>Jan Williams</i> CLV ENGINEER	1/6/82 DATE
<i>Michael ...</i> NEVADA POWER CO.	12-10-81 DATE

APPROVED FOR: **BAUGHMAN & TURNER** MINING ENGINEERS
 CIVIL ENGINEERS
 3335 WEST CHARLESTON BOULEVARD
 LAS VEGAS, NEVADA 89102
 702-870-8771

DATE: 12-10-81
 DESIGN: [Signature]
 DRAWN: [Signature]
 CHECK: [Signature]

SCALE: 1" = 30' H, 1" = 3' V

PROJECT: **STREET DESIGN SAGMAN STREET**
 SECTION 26, TOWNSHIP 20 SOUTH, RANGE 41 EAST, M.D.B. & M. NEVADA
 CITY OF LAS VEGAS
CASHMAN SPORTS & CONVENTION COMPLEX

PREPARED FOR: **GEORGE TATE & ASSOC.**

DATE: 12-10-81