

CONSTRUCTION NOTE

All construction and materials shall be in accordance with the "Uniform Standard Specifications for Public Works Construction Off-site Improvements, Clark County Area Nevada", issued 1978; the "Uniform Standard Drawings for Public Works Construction, Clark County Area", any other applicable approved standards issued by the controlling agency; the Uniform Building Code; and all Local City Codes and Ordinances Applicable.

STREET LIGHT NOTE

All street lighting installation shall conform to the latest issue of the Standard Details and Specifications of the City of Las Vegas, and shall also conform to the Uniform Standard Specifications for Public Works Construction of Off-site Improvements, Clark County, Area, 1978, unless otherwise noted.

UTILITY NOTE

The location of underground utilities shown hereon has been determined from surface evidence of their existence or from information obtained from the utility companies. The Engineer accepts no liability for the existence or non-existence of utility lines. Contractors and others using this map must confirm the location of underground lines or structures with the utility companies prior to commencing any excavation.

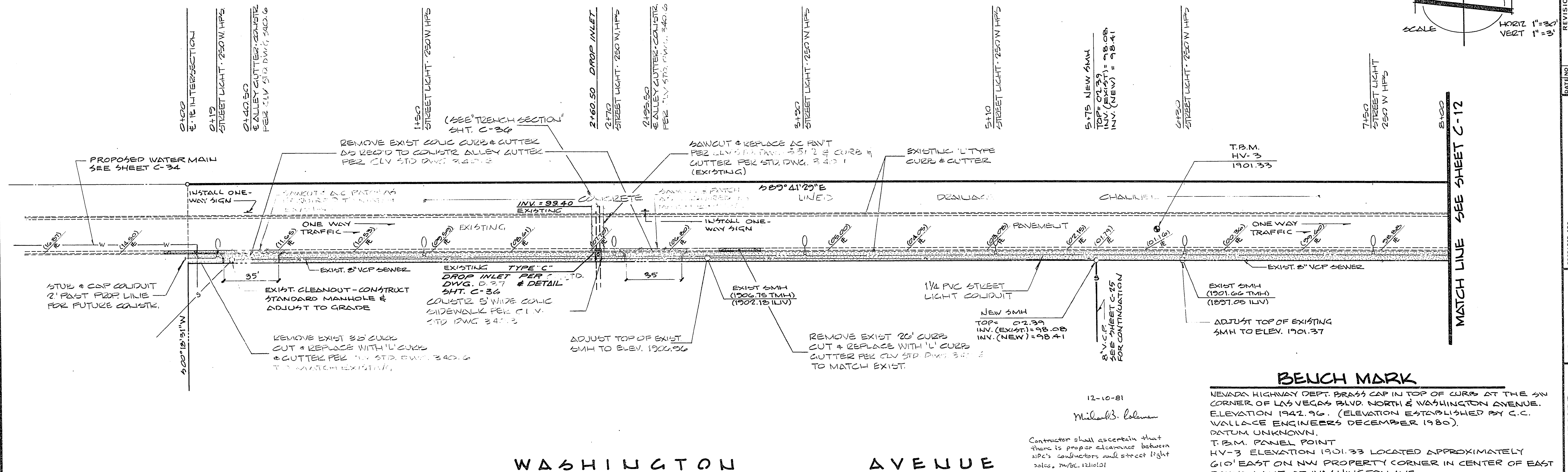
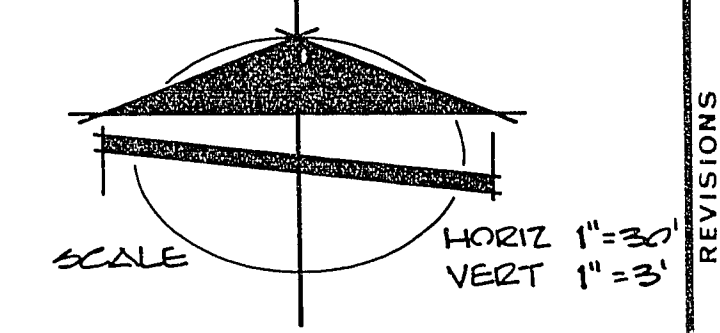

BENCH MARK

NEVADA HIGHWAY DEPT. BRASS CAP IN TOP OF CURB AT THE SW CORNER OF LAS VEGAS BLVD. NORTH & WASHINGTON AVENUE. ELEVATION 1942.96. (ELEVATION ESTABLISHED BY C.C. WALLACE ENGINEERS DECEMBER 1980). DATUM UNKNOWN. T.B.M. PANEL POINT HV-3 ELEVATION 1901.33 LOCATED APPROXIMATELY 610' EAST ON NW PROPERTY CORNER IN CENTER OF EAST BOUND LANE OF WASHINGTON AVE.

12-10-81
Michael B. Solomon

Contractor shall ascertain that there is proper clearance between N.P.C.'s conductors and street light poles. 7/4/82. 12/10/81

WASHINGTON AVENUE

NOTE:

DRIVEWAY WIDTH'S PENDING APPROVAL PER PARKING & TRAFFIC COMMISSION.

QUANTITIES- THIS SHEET

CONCRETE SIDEWALK (4" CONC. - 5" TYPE II)	3640 SQ. FT.
CONCRETE "L" TYPE CURBS - INSTALL NEW	62 LF
REMOVE "L" TYPE CURBS & CUTTER	148 LF
CONCRETE ALLEY CUTTER (VALLEY CUTTER)	500 SQ. FT.
STREET LIGHTS (250 HPS)	7 EA.
1 1/4" CONDUIT	802 LF
ADJUST SMH	3 EA.
NEW SMH	2 EA.
DROP INLET (TYPE C)	1 EA.
36" RCP STORM DRAIN	35 LF
A.C. PATCH (3" MIN.)	35 SQ. YDS.
EXCAVATION	75 CU. YDS.

APPROVALS

CLV TRAFFIC ENGR.	DATE
CLV FIRE MARSHALL	12-11-81
CLV ELECTRICAL COORDINATOR	11/4/82
CLV QUALITY CONTROL ENGR.	11/5/82
CLV SANITATION ENGR.	12-11-81
CLV ENGINEER	12-11-81
CLV ELECTRICAL SUPERVISOR	1-11-82
NEVADA POWER CO	12-10-81

SEWER NOTES

- All construction and materials shall be in accordance with the Design and Construction Standards of the City of Las Vegas and the Uniform Standard Specifications for Public Works' Construction Off-Site Improvements, Clark County Area, Nevada, 1978. In all cases, the City's Criteria shall supersede the Uniform Standard Specifications.
- City of Las Vegas drawings shall apply to all construction FOR SEWER OR AS SPECIFIED.
- Sewer mains only to be laid in sewer trenches.
- All 4" house laterals to be laid at not less than minimum slopes.
- Sewer laterals locations to be marked in accordance with Standard Drawing SD-11 in the District's Standards. (Clark County Sanitation District).
- It shall be the contractor's responsibility to perform construction as per plans. Any additions, deletions, or changes shall first meet with the approval of the City of Las Vegas.
- If a lateral is under a driveway, concrete sidewalk or other paved area, a cleanout shall be installed and raised to grade with a sloped brass cap or within a water meter box which has a metal cover marked "SR. (4.0)".
- Cut sheets must be submitted to the City before construction will be permitted to start.
- All contractors installing sewer mains which will be under the jurisdiction of the City of Las Vegas must be Class "A" contractors.
- Construct Concrete Collars per Standard Drawing No. 512.9. (COLLARS NOT REQUIRED WHERE MANHOLE IS LOCATED WITHIN SIDEWALK AREAS.)

APPROVALS: BAUGHMAN & TURNER (CIVIL ENGINEERS), MING ENGINEERS (MINING ENGINEERS), LAND SURVEYORS (2335 WEST CHARLESTON BOULEVARD, LAS VEGAS, NEVADA 89102). PROJECT: STREET DESIGN WASHINGTON AVENUE SECTION 20, TOWNSHIP 20 SOUTH, RANGE 61 EAST, M.D.B.M. LEVADA CITY OF LAS VEGAS CASHMAN SPORTS & COLLEGIATION COMPLEX. SHEET 11 OF 11. PREPARED FOR: GEORGE TATE & ASSOC. DATE: 12-10-81. SCALE: H 1"=50', V 1"=3'. PROJ. NO. 89-4-191 107-V 1206