

# BURNHAM AVENUE

SCALE  
1" = 20' HORIZONTAL

Call before you Dig.  
1-800-227-2600  
UNDERGROUND SERVICE USA

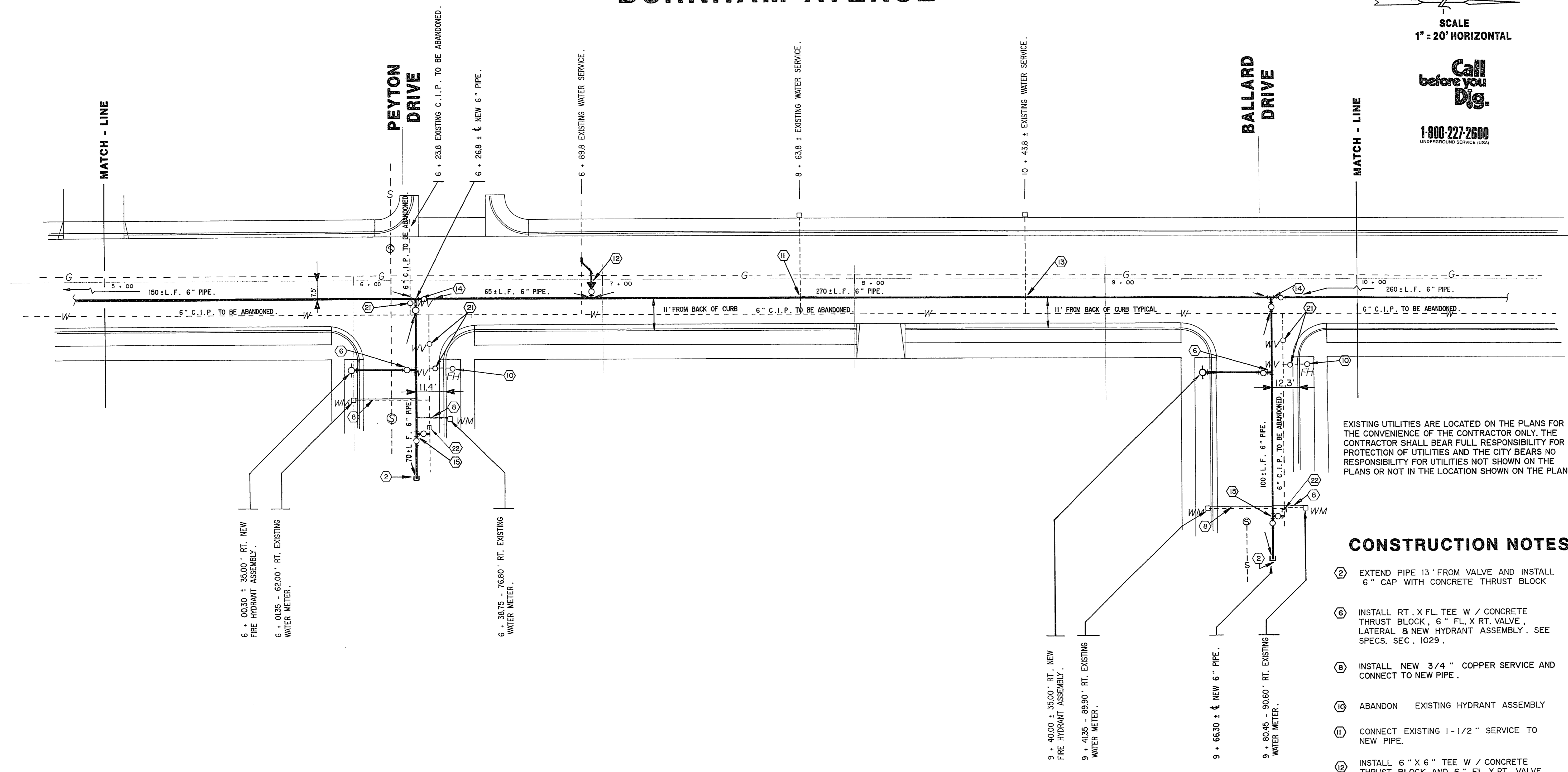

6 + 00.30 ± 35.00' RT. NEW FIRE HYDRANT ASSEMBLY.  
6 + 01.35 ± 62.00' RT. EXISTING WATER METER.  
6 + 39.75 ± 76.80' RT. EXISTING WATER METER.

9 + 40.00 ± 35.00' RT. NEW FIRE HYDRANT ASSEMBLY.  
9 + 41.35 ± 89.90' RT. EXISTING WATER METER.  
9 + 66.30 ± 6' NEW 6" PIPE.  
9 + 80.45 ± 90.60' RT. EXISTING WATER METER.

EXISTING UTILITIES ARE LOCATED ON THE PLANS FOR THE CONVENIENCE OF THE CONTRACTOR ONLY. THE CONTRACTOR SHALL BEAR FULL RESPONSIBILITY FOR PROTECTION OF UTILITIES AND THE CITY BEARS NO RESPONSIBILITY FOR UTILITIES NOT SHOWN ON THE PLANS OR NOT IN THE LOCATION SHOWN ON THE PLANS.

### CONSTRUCTION NOTES :

- ② EXTEND PIPE 13' FROM VALVE AND INSTALL 6" CAP WITH CONCRETE THRUST BLOCK
- ⑥ INSTALL RT. X FL. TEE W / CONCRETE THRUST BLOCK, 6" FL. X RT. VALVE, LATERAL & NEW HYDRANT ASSEMBLY. SEE SPECS. SEC. 1029.
- ⑧ INSTALL NEW 3/4" COPPER SERVICE AND CONNECT TO NEW PIPE.
- ⑩ ABANDON EXISTING HYDRANT ASSEMBLY
- ⑪ CONNECT EXISTING 1-1/2" SERVICE TO NEW PIPE.
- ⑬ INSTALL 6" X 6" TEE W / CONCRETE THRUST BLOCK AND 6" FL. X RT. VALVE WEST, 8" X 6" REDUCER, INSTALL 8" PIPE AND 45° ELLS AS NECESSARY TO CONNECT EXISTING LATERAL TO NEW PIPE.
- ⑬ CONNECT EXISTING 2" SERVICE TO NEW PIPE.
- ⑭ INSTALL 6" X 6" TEE W / CONCRETE THRUST BLOCK AND 6" FL. X RT. VALVE NORTH, & EAST.
- ⑮ INSTALL 6" X 6" TAPPING SLEEVE W / CONCRETE THRUST BLOCK AND 6" FL. X RT. VALVE SOUTH WITH 6" X 6" FL. X RT. TEE IN NEW PIPE, WITH FL. X RT. VALVE EAST, CUT AND CAP W / CONCRETE THRUST BLOCK EXISTING C.I.P.
- ⑰ ABANDON EXISTING VALVE, SEE SPEC'S SECTION 1026.
- ⑱ CUT AND CAP EXISTING MAIN

- NOTES:
- 1. EXISTING WATER MAIN TO REMAIN IN SERVICE UNTIL NEW MAIN IS TESTED AND EXISTING SERVICES AND CONNECTIONS ARE CONNECTED TO THE NEW MAIN.
  - 2. CONTRACTOR TO VERIFY EXISTING METER SIZE.

Scale (h)		Scale (v)		W.A.	
Fid. bk. no.		Date		Date	
Design by D. ANDERSON		Drawn by D. ANDERSON		Date	
Approved by				Revisions	
				Date	

Department of Public Works  
**BURNHAM AVENUE**  
**CAST IRON MAIN REPLACEMENT**

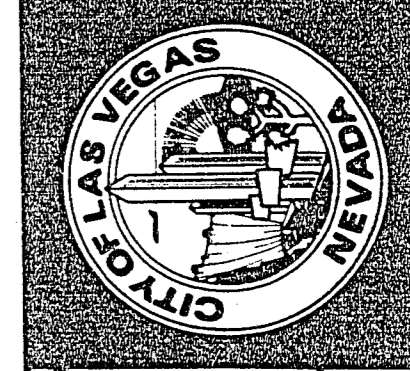

Drawing no.  
107 - VI632

1988 - 1989 STREET REHABILITATION PROJECT BURNHAM AVENUE CAST IRON MAIN REPLACEMENT