

CASHMAN DRIVE

CHARLESTON BLVD.

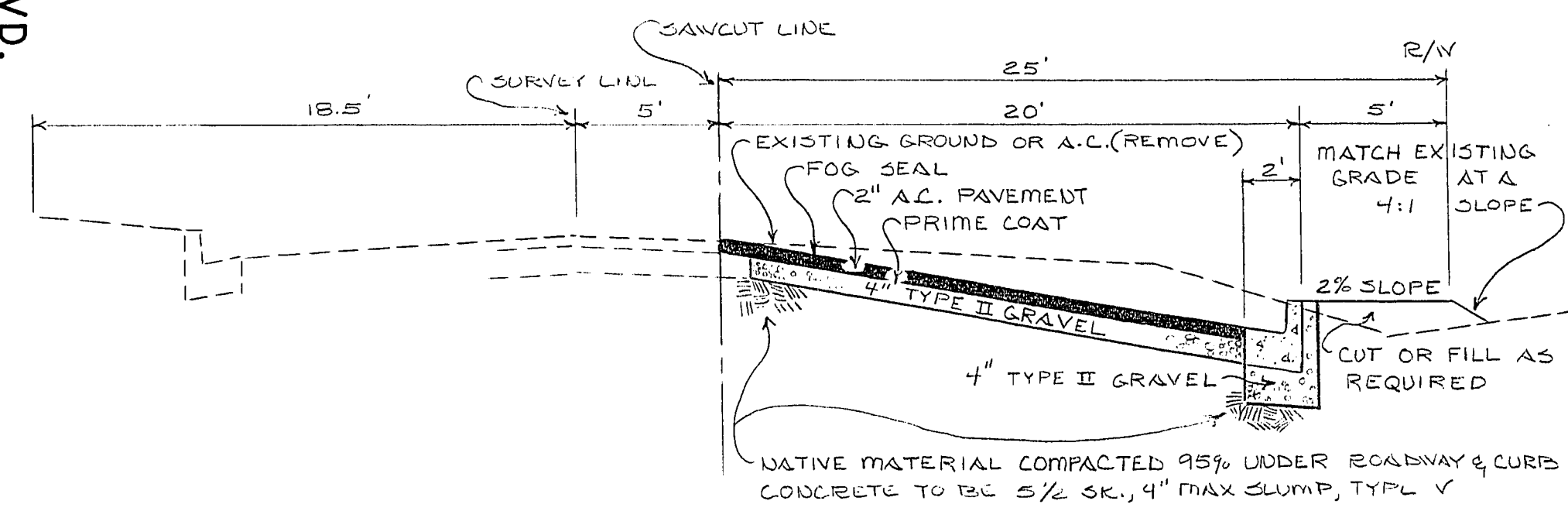
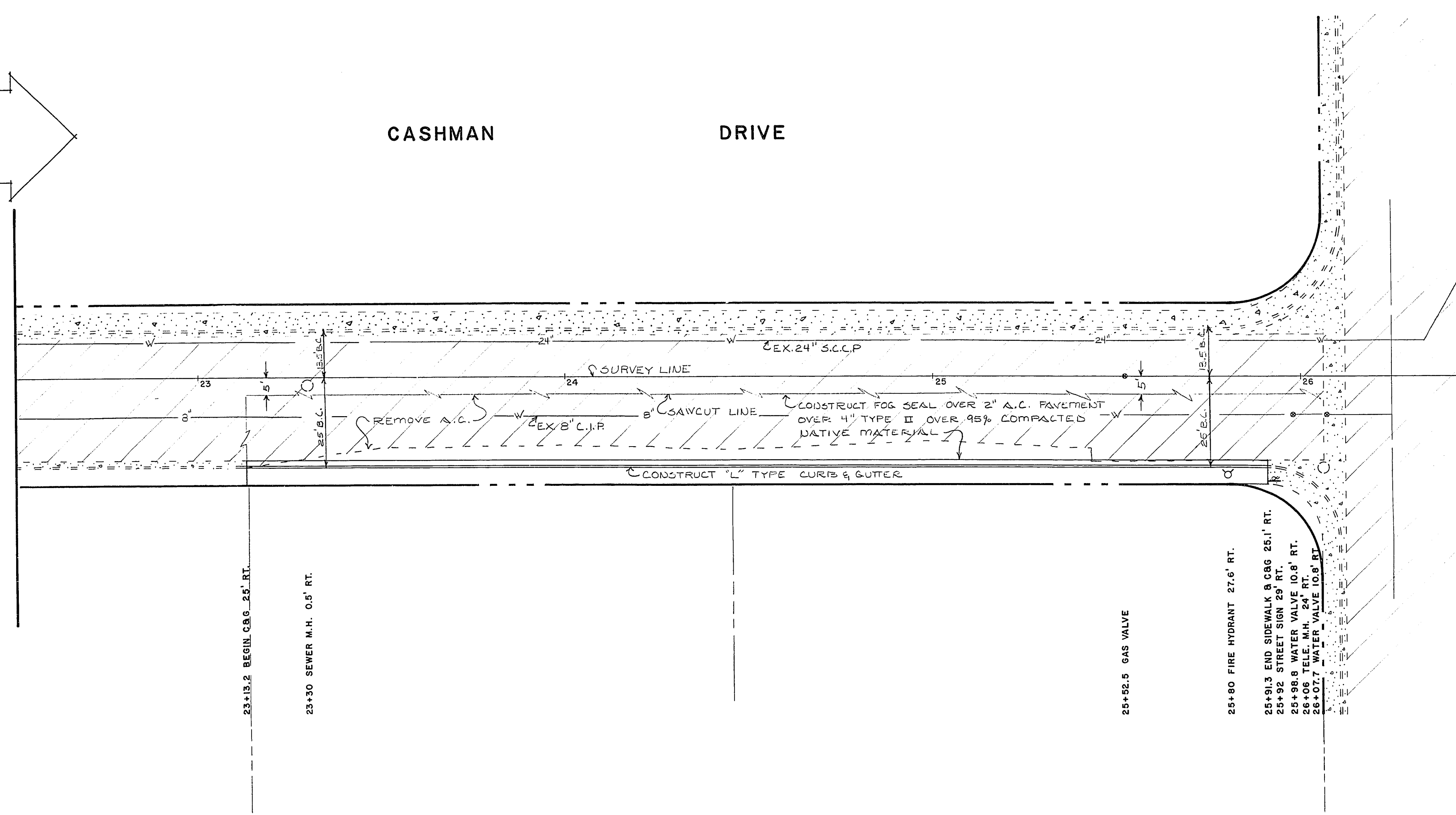

TYPICAL HALF SECTION STREET

STA. 23+13.2 TO 25+91.3
NO SCALE

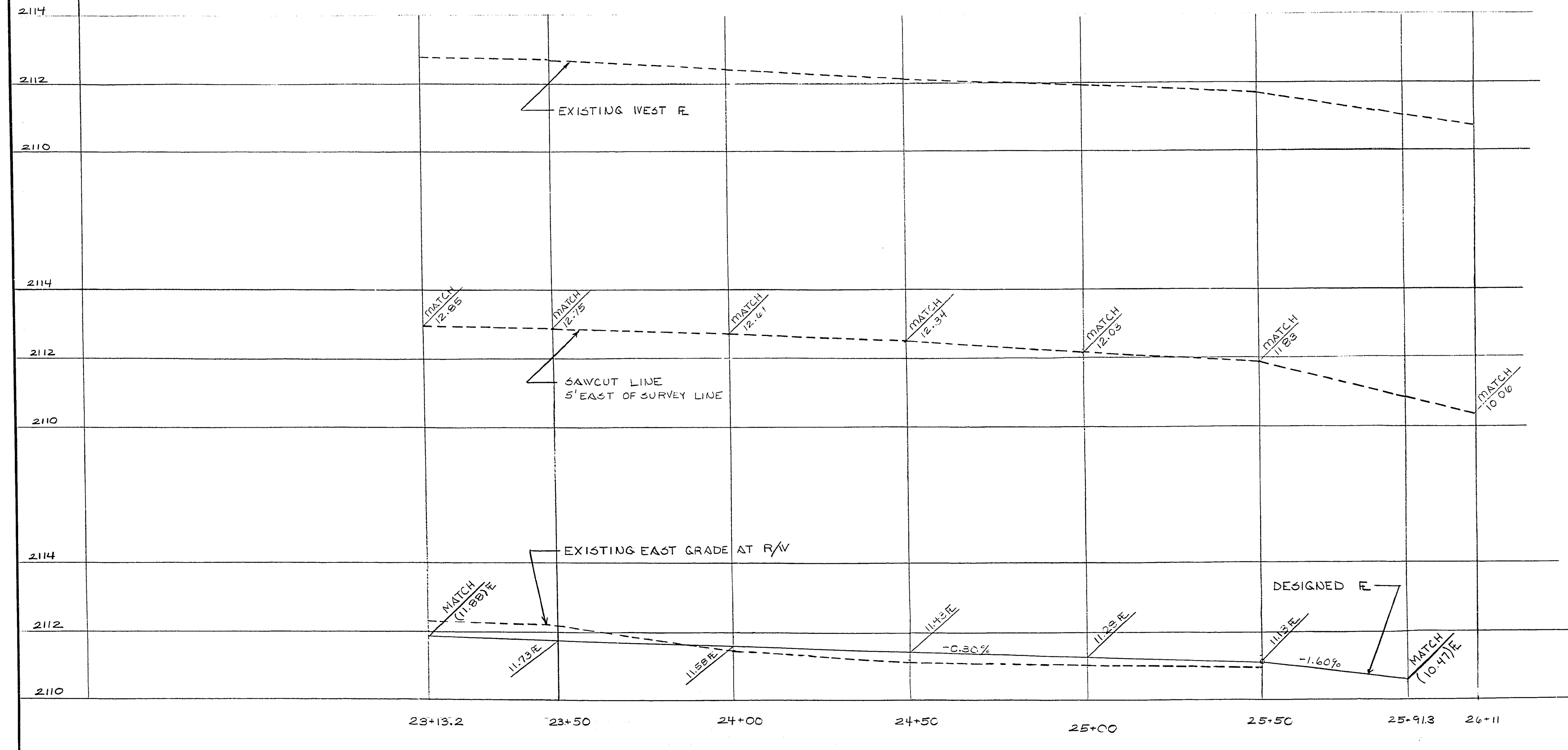

EXISTING UTILITIES ARE LOCATED ON THE PLANS FOR THE CONVENIENCE OF THE CONTRACTOR ONLY. THE CONTRACTOR SHALL BEAR FULL RESPONSIBILITY FOR PROTECTION OF UTILITIES AND THE CITY BEARS NO RESPONSIBILITY FOR UTILITIES NOT SHOWN ON THE PLANS OR NOT IN THE LOCATION SHOWN ON THE PLANS.

BENCH MARK
C.L.V. 1015 B6
S.W. CORNER @ CHARLESTON & CASHMAN
ELEVATION 2111.73



Department of Public Works
Engineering Division

CASHMAN DRIVE

23+13.2 TO CHARLESTON BLVD.

CONTRACT DRAWING
10-22-75

scale (h) 1" = 20'	scale (v) 1" = 2'	drawing no. 107-V964
w.o.no. 4193	f.bk.no. 75-3X	date 8-4-76
design by KAJKOWSKI	drawn by R.W. & P.M.	approved by Director of Public Works
date 10/24/75		sht. 3 of 3