

ESTIMATE OF QUANTITIES

Sawcut pave	660 l.f.
Curb & gutter	625 l.f.
Comm'l driveway	400 s.f.
Sidewalk	2725 s.f.
2" AC pave	1241 s.f.
Install 37" 8" VCP sewer	L.S.

GENERAL NOTES

- All construction to conform to standard plans & specs. of City of Las Vegas.
- Contractor responsible for damages to existing utilities.

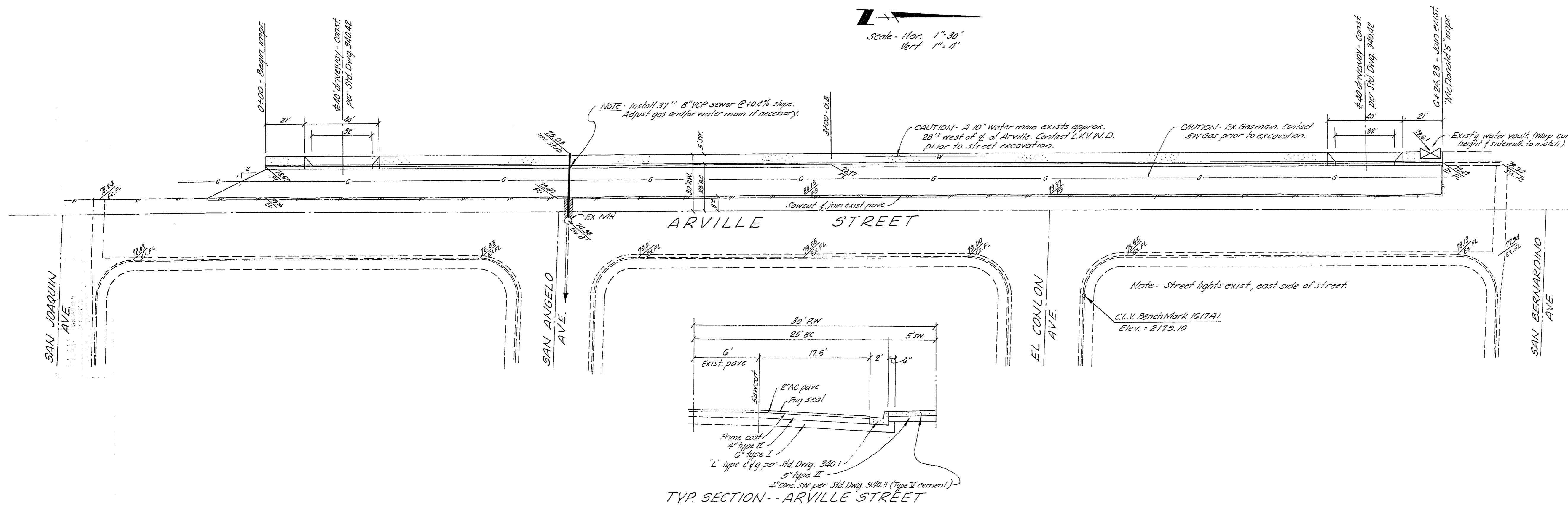

TYP. SECTION - ARVILLE STREET

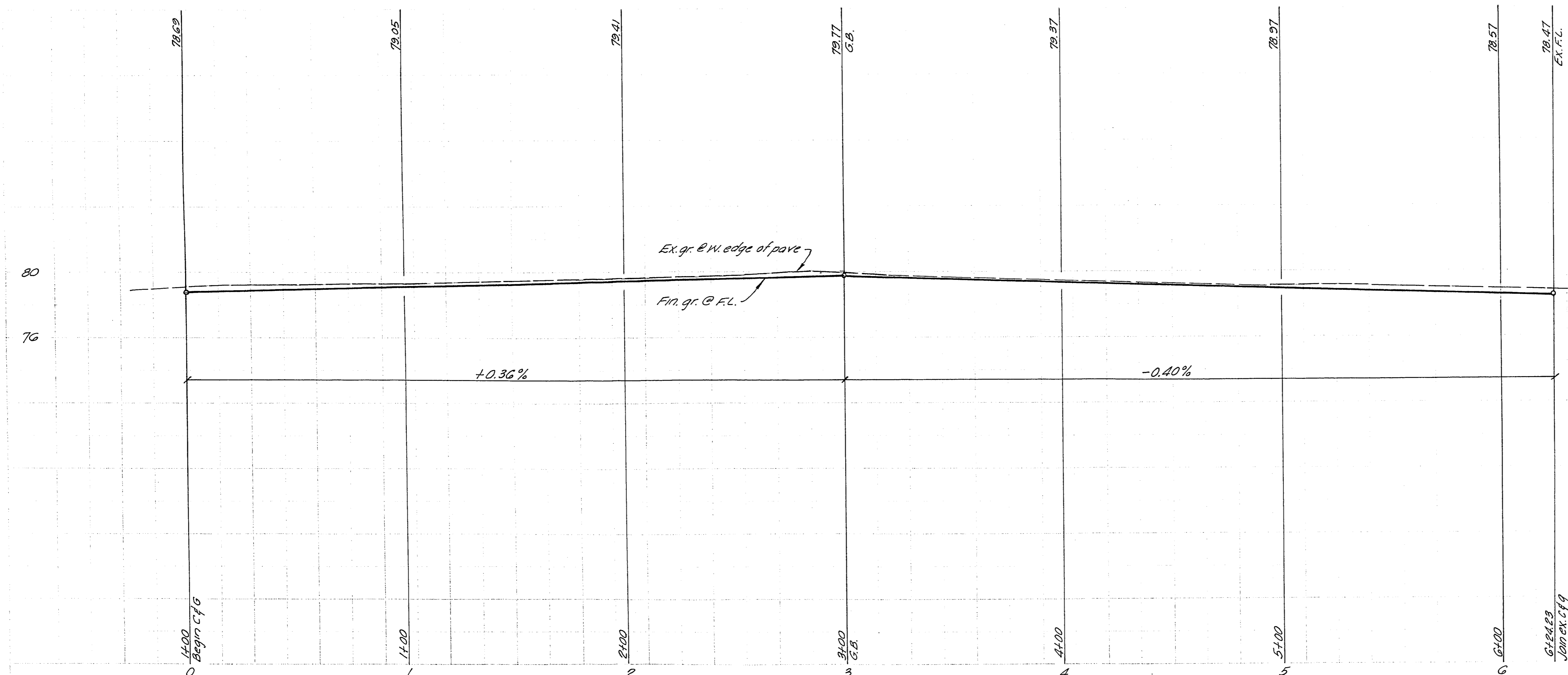

APPROVALS

<i>V.B. Williams</i>	3/16/75
City Engineer	Date
<i>J.D. Dushen</i>	3-15-75
Field Engineer	Date
<i>R. J. Ant...</i>	3-7-75
Supt. of Sanitation	Date

OFFSITE IMPROVEMENT DESIGNS
FOR NEVADA SAVINGS AND LOAN ASSOCIATION'S 140 UNIT APARTMENT PROJECT
Por. NW 1/4, Sec. 7, T. 215, R. 61E, M. 4M,
City of Las Vegas Nevada

by
Kraemer Engineering Co.
P.O. Box 2227
Las Vegas, Nev.
876-1724

