

3-51

12/16/77  
177/58  
DITTMER  
HURTADO

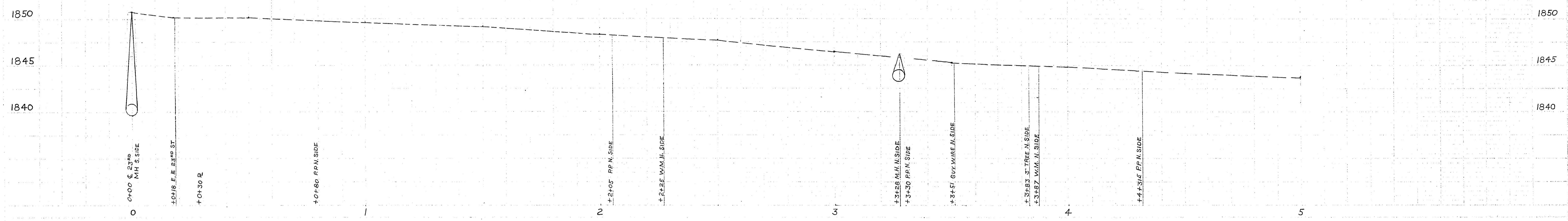

12/16/77  
177/58  
DITTMER  
HURTADO

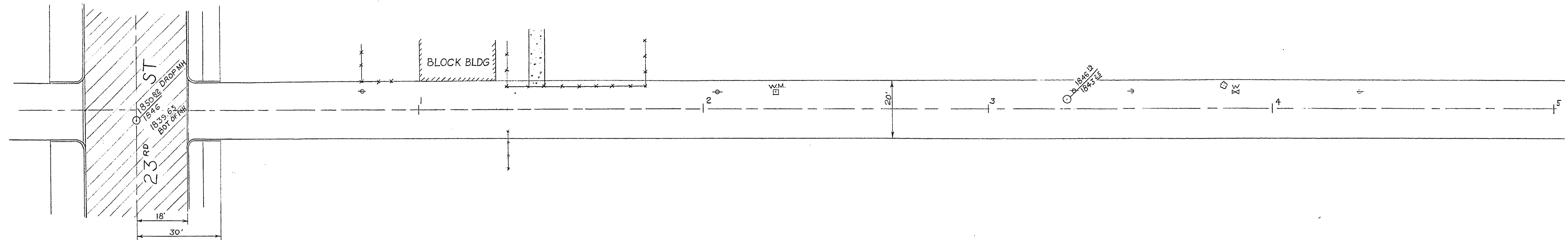
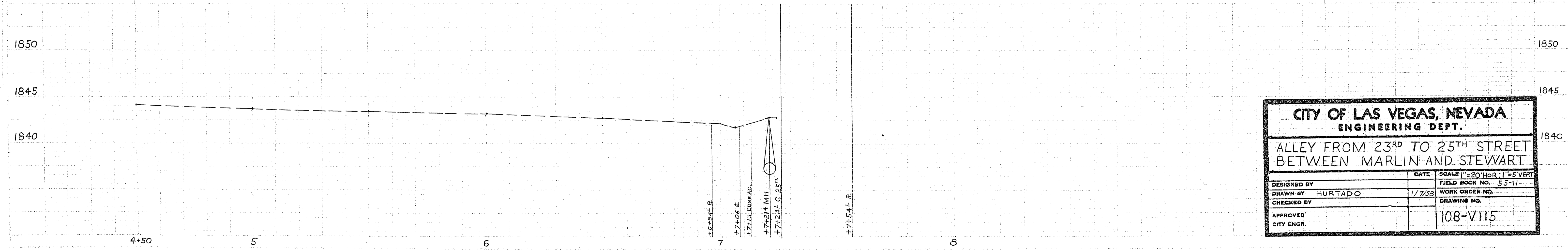
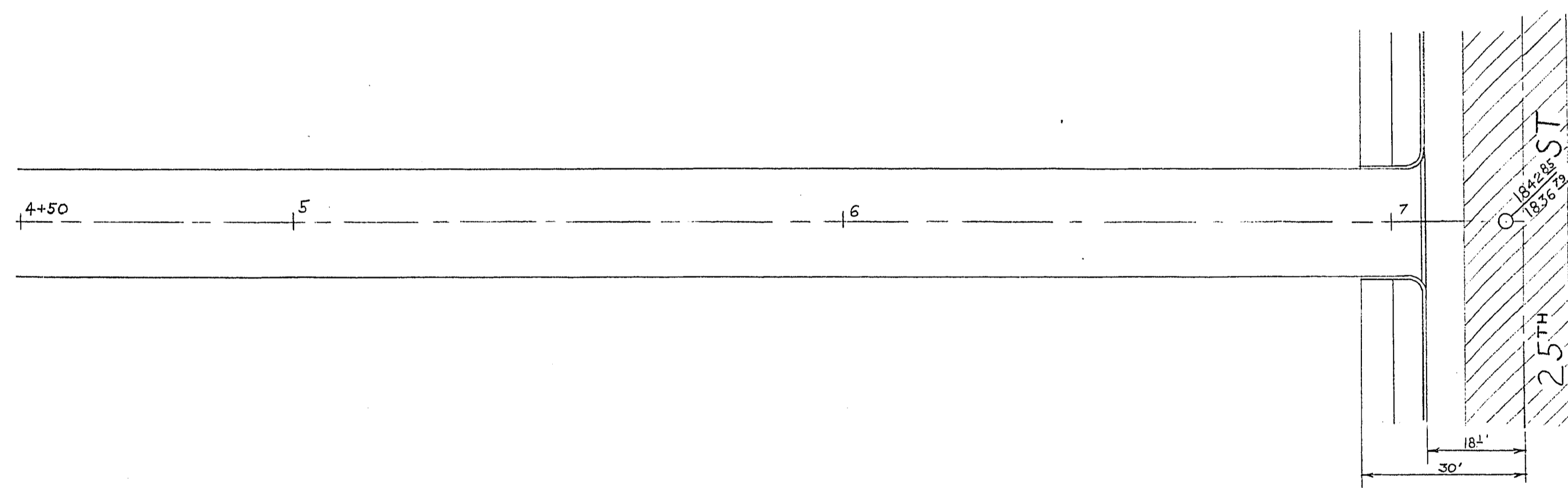

BM ELEVATION - 1840.498  
DISC. # 152 AT 25TH & POPLAR

**CITY OF LAS VEGAS, NEVADA**  
ENGINEERING DEPT.

ALLEY FROM 23<sup>RD</sup> TO 25<sup>TH</sup> STREET  
BETWEEN MARLIN AND STEWART

DESIGNED BY	DATE	SCALE 1" = 20' HOR. 1" = 5' VERT.
DRAWN BY HURTADO	1/7/78	FIELD BOOK NO. 55-11
CHECKED BY		WORK ORDER NO.
APPROVED CITY ENGR.		DRAWING NO. 108-V115